

SAW CUT AND REMOVE APPROX. 64.7 S.Y. OF EXIST. ASPHALT AND 12" CMP BENEATH THE STREET. FILL PLACED IN THIS AREA TO BE COMPACTED TO 95% STD. DENSITY. REPLACE SUBGRADE AND ASPHALT AT THE SAME DEPTHS AS ORIGINAL. COST SUBSIDIARY TO PROJECT.

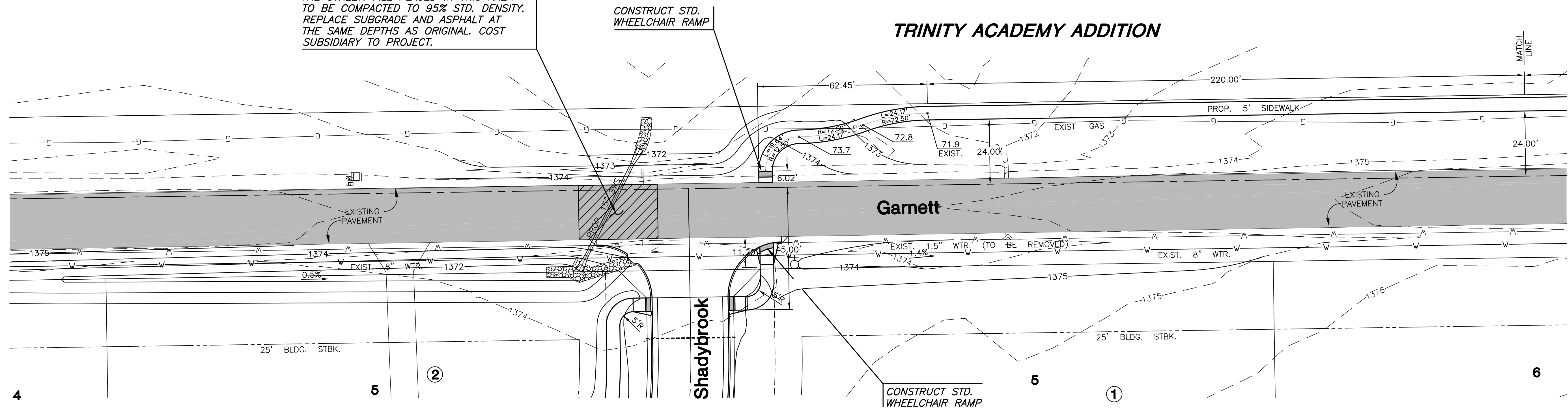

LEGEND

- XXXX --- - EXISTING CONTOURS
- XXXX — - PROPOSED CONTOURS
- XX.X - PROPOSED SPOT ELEVATIONS
- X.X% - PROPOSED SLOPE ARROWS

SIDEWALK NOTES

1. 4" CONCRETE SIDEWALK (5' WIDTH) SHALL BE CONSTRUCTED ALONG GARNETT IN THE LOCATIONS SHOWN ON THIS DRAWING.
2. THE CONTRACTOR SHALL CONSTRUCT THE PROPOSED SIDEWALK AT EXISTING GRADES WHERE CONTINUOUS SURFACE DRAINAGE IS POSSIBLE AFTER CONSTRUCTION.
3. THE CONTRACTOR SHALL ENSURE THAT TRANSVERSE SLOPES DO NOT EXCEED 5% AND CROSS SLOPES DO NOT EXCEED 2% IN ANY AREA. ADDITIONAL GRADING MAY BE NECESSARY TO COMPLY WITH THOSE MAXIMUM SLOPES, IN AREAS WHERE NO GRADING IS SHOWN ON THIS PLAN.
4. THE CONTRACTOR WILL BE RESPONSIBLE FOR CONSTRUCTING THE SIDEWALK WITH CROSS SLOPES THAT DO NOT ALTER EXISTING DRAINAGE PATTERNS ON SITE.

GRADING NOTE

MASS GRADING ON THIS SITE HAS TAKEN PLACE PRIOR TO THIS PROJECT. IT IS THE RESPONSIBILITY OF THE CONTRACTOR TO ENSURE THAT GRADING ALONG GARNETT COMPLIES WITH WHAT IS SHOWN ON THIS SHEET WHEN CONSTRUCTION IS COMPLETE.

TRINITY ACADEMY ADDITION

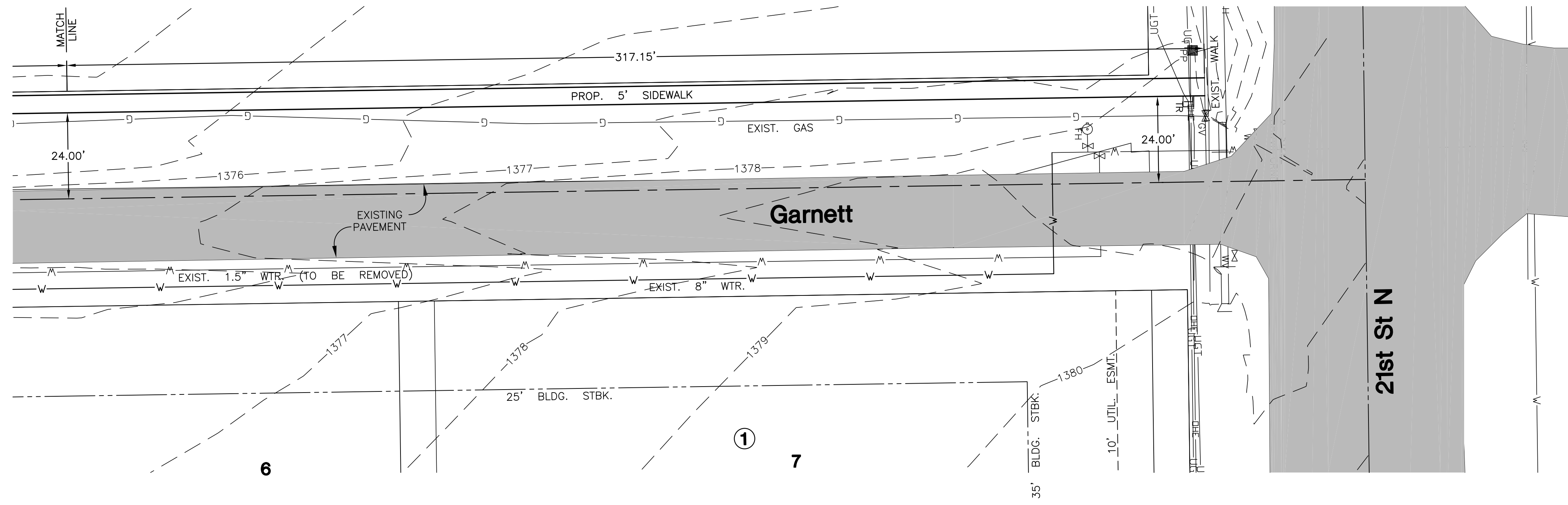

PAVING AND INCIDENTAL DRAINAGE PLANS
SUMMIT CROSSING
WICHITA, KANSAS

GARNETT SIDEWALK & GRADING PLAN

SHEET TITLE
472-84797
PROJECT NUMBER

DESIGN BY: DFL
DRAWN BY: DMU
CHECKED BY: GJA

ISSUED: April 2010
REVISED:

SHEET NO.
10 of 22