

DRAINAGE IMPROVEMENTS AT 119th STREET WEST TO LARK

(South of Abandoned BNSF RR)

CITY OF WICHITA, KANSAS

James L. Armour, P.E.

City of Wichita Engineer

April 2005

General Notes

- Contractor will be required to provide notice to utility companies a minimum of forty-eight (48) hours prior to any excavation, as follows:
 Kansas One-Call 687-2470
 The Contractor must notify the following in case of an emergency:
 Cox Communications 262-4270
 Kansas Gas Service Company 1-888-482-4950
 Westar Energy (Electric) 383-8650
 SBC Telephone Company 1-800-286-8313
 City of Wichita Water Department 262-6000
 City of Wichita Sewer Maint. (San, Sewer) 262-6000
 City of Wichita Storm Sewer Maint. 268-4090
 City of Wichita Traffic Maint. 268-4034
- All disturbed R/W areas not intended for pavement or sidewalk construction shall be seeded with Kansas Premium Fescue Blend at a rate of 8 lb./1000 Sq. Ft., fertilized with a 16-20-6 ratio at a rate of 4 lb./1000 Sq. Ft., and mulched with Prairie Hay at a rate of 92 lb./1000 Sq. Ft. Mulch shall be "patted" with forks or punched into soil to reduce loss due to wind.
- Utility service lines, poles, valve boxes, meters, et cetera are to be adjusted as necessary by others prior to construction unless the plans specifically call for their adjustment by the Contractor or unless the plans specifically identify a utility to be adjusted by its owner during construction. Existing utilities and their location, as shown on the plans represent the best information obtainable for design and shall be field verified. The contractor will be required to work around existing utilities within the right-of-way which do not conflict with proposed construction.
- Properties within the project limits may have underground sprinkler systems which may conflict with new construction. Contractor will be required to remove such improvements should they not be removed by their owner at the time of construction of the project. The Contractor will be required to replace/re-install all sprinkler heads and/or valves such that the sprinkler system is in operational order. Portions of underground sprinkler systems not in conflict with new construction shall be protected from damage and shall remain in place. All work in connection with underground sprinkler systems shall be considered as subsidiary to the contract pay items of work.
- Rubble from the removal of miscellaneous structures and excess excavation which is to be wasted shall be disposed of on sites to be provided by the Contractor. These sites shall be approved by the Engineer as to suitability, appearance and site location. Locations that, in the opinion of the Engineer, will leave an unsightly appearance will not be approved. All disposal sites must be approved by the Kansas Department of Health and Environment. Material either stockpiled or disposed of in a flood plain would require a Kansas State Board of Agriculture permit. Any material dumped in waters of the United States or wetlands is subject to U.S. Corps. of Engineers permitting regulations. Any material buried or stockpiled beyond approved construction limits would require additional archaeological investigations unless buried in a previously approved borrow location.
- The Contractor shall give all property owners/or tenants of developed property directly abutting the construction of this project a minimum of ten (10) days notice prior to start of construction.

Index

| | |
|-----------------|-----|
| Cover Sheet | 1 |
| Plan & Profile | 2-5 |
| Erosion Control | 6 |

Bench Mark:

- City of Wichita Disk at SE Corner of 119th Street West and Kellogg Elev. = 145.96 (City Datum)
- City of Wichita Disk at 119th Street West and 0.5 mile South of Kellogg 42.2' East of CL 119th Street and 6.4' South of PP Elev. = 144.69 (City Datum)
- City of Wichita Disk at North End of West Headwall of RCB at Lark and May Elev. = 139.20 (City Datum)
- "D" Top of Curb Adjacent to NW Corner of Lot 17, Block A, Lark Addition Elev. = 144.89 (City Datum)

KELLOGG AVENUE (U S HIGHWAY 54)

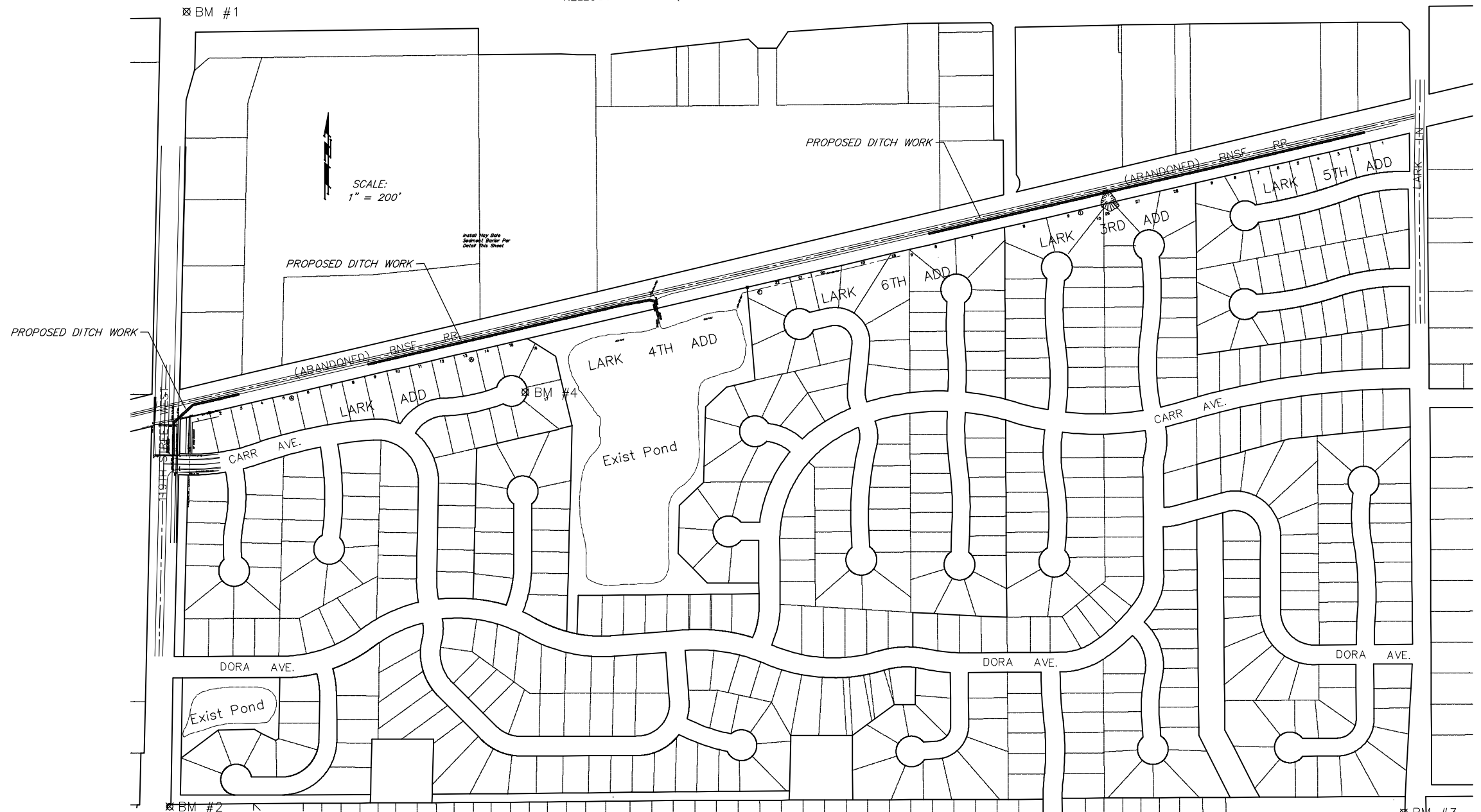

Location Map

