

STATE	PROJECT NO.	YEAR	SHEET NO.	TOTAL SHEETS
KANSAS	87 N-0187-01	2006	17	47

GENERAL NOTES

ABUTMENT STRIP DRAIN: The Bridge Contractor shall excavate to the limits shown on the Bridge Excavation sheet, grade the bottom of the backfill area, place the strip drain, and place the perforated pipe, the outlet pipe, the CMP, and the backfill. Guide post and coarse aggregate are subsidiary to this bid item. Guide post and coarse aggregate are not required if the CMP empties onto riprap.

BRIDGE BACKWALL PROTECTION SYSTEM: Apply a Bridge Backwall Protection System to the approach side of the abutments and the wings in accordance with KDOT Specifications and the manufacturer's recommendations. Cover the abutments and wings to the limits shown on the details. Prior to backfilling, repair any damage done to the system at no charge to the city.

Place perforated pipe next to the strip drain. Use non-perforated pipe outside the limits of the strip drain. Enclose the perforated pipe with the extension of the filter fabric.

Compact the abutment backfill. See the KDOT Specifications.

Perforated pipe and non-perforated outlet pipe shall be corrugated polyethylene tubing conforming to the KDOT Specifications.

Fit the CMP end section with 6 mm galvanized mesh screen to prevent the entrance of rodents. Seal the joint between the outlet pipe and the end section with a joint sealer.

Place the outlet pipe on the downstream side of structures over streams and as shown or noted on other crossings (See the "Construction Layout" sheet).

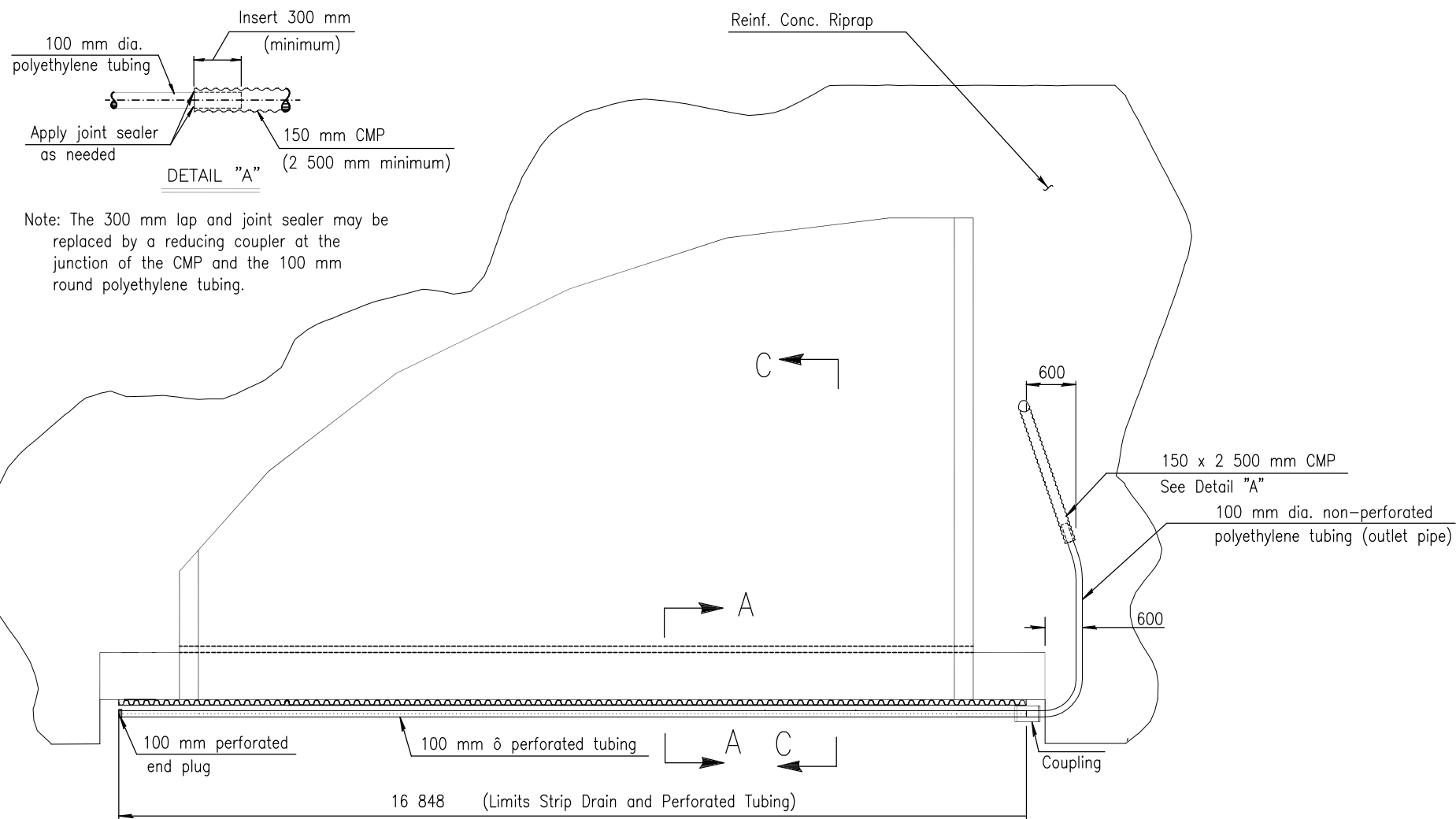

PLAN

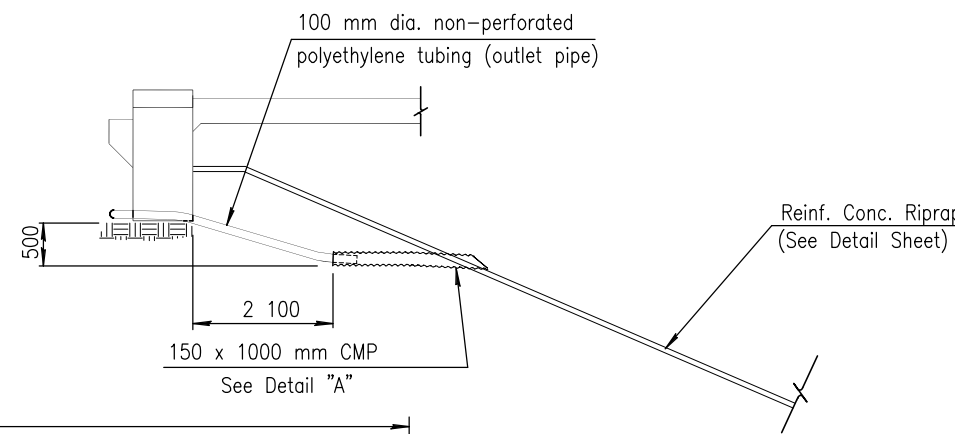

SECTION C-C

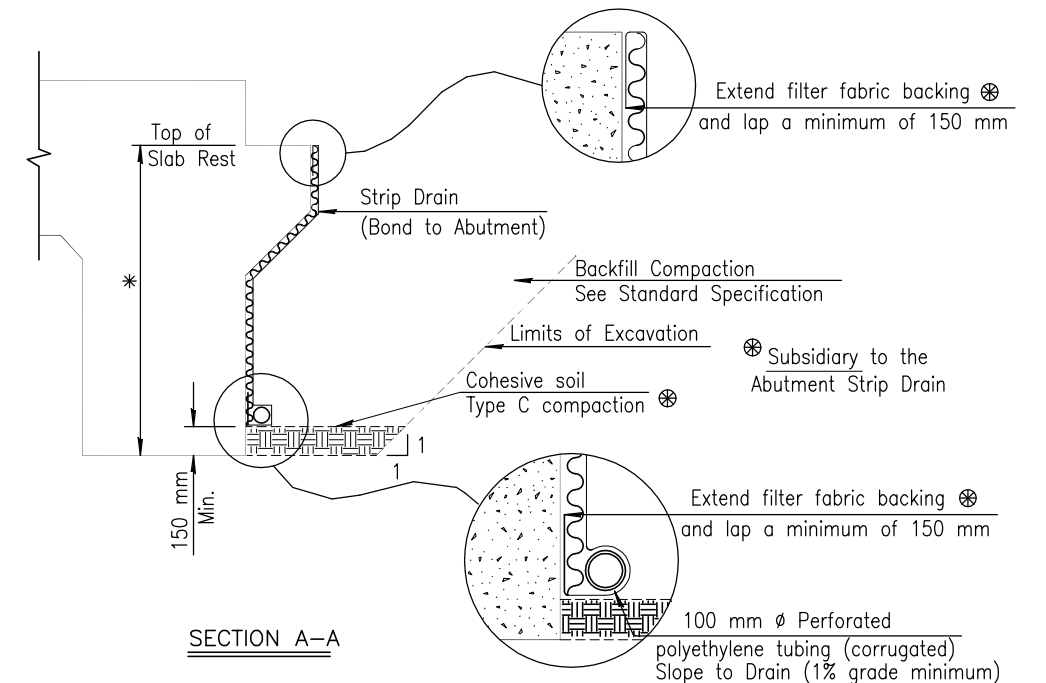

SECTION A-A

* Limits of Bridge Backwall Protection System (by Bridge Contractor)

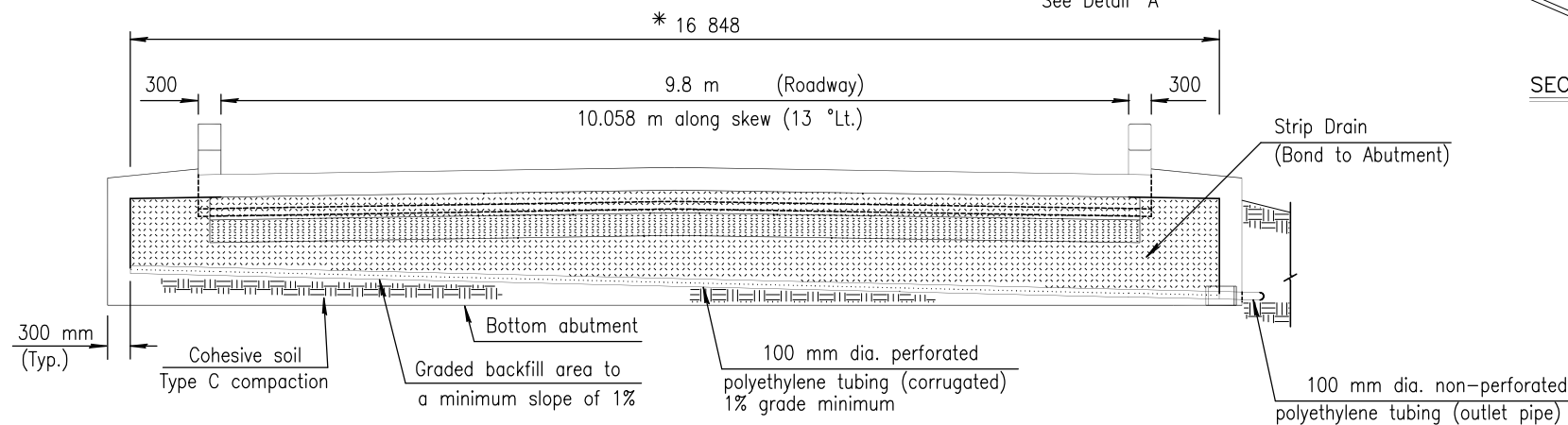

ELEVATION

SUMMARY OF QUANTITIES (2 Abutments)	
Abutment Strip Drain	44.3 m ²
Bridge Backwall Protection System	47.2 m ²
Items Subsidiary to Strip Drain	
100 mm ϕ Perforated Pipe	34 m
100 mm ϕ Outlet Pipe	9 m
150 mm ϕ CMP	5.0 m

G:\CIVIL\08169\05693\BRIDGE\BR104H3.DWG 02/10/2006 09:08:56 AM CST				
3				
2				
1				
NO.	DATE	REVISIONS	BY	APP'D
KANSAS DEPARTMENT OF TRANSPORTATION				
BR. NO. 53040087WDC150		STA. 10+00.00		
ABUTMENT STRIP DRAIN				
PROJECT NO. 87 N-0187-01			SEDGWICK CO.	
SHEET NO.	OF	SCALE	APP'D	
DESIGNED		DETAILED	QUANTITIES	CADD
DESIGN CK.		DETAIL CK.	QUAN. CK.	CADD CK.