

BILL OF REINFORCING STEEL
Epoxy Coated - Grade 420

Straight Bars				Bent Bars			
Mark	Size	Number	Length	Mark	Size	Number	Length
S4	32	52	17 950	S1	25	44	3660
S5	32	44	11 000	S2	25	44	4160
S6	32	44	5700	S3	25	52	6360
S8	32	44	14 710				
S9	32	32	14 410	R1	22	24	2830
S11	32	32	6800	R2	22	4	1700
S15	32	22	18 000	R3	22	236	2380
S10	29	32	8600	A2	16	70	1220
S16	29	16	18 000	A8	16	16	4000
S17	29	16	9600	R5	16	8	1990
S18	29	16	7200	R6	16	8	3250
				S21	16	590	3210
A1	25	16	17 350				
P1	25	10	6850				
				A4	13	236	2810
R11	19	24	2470	A5	13	84	1880
R12	19	156	2900	A7	13	28	1320
S7	19	16	10 570	R4	13	236	1020
				R7	13	4	3240
A3	16	20	17 350				
T1	16	120	10 570	R8	10	410	1340
				R9	10	112	1340
				R10	10	56	1340
S20	16	56	11 780				
				T3-T20			*
A6	13	2	10 575				
C2	13	16	11 750				
A9	13	4	1750				
SC1	13	84	2000				
T2	13	84	10 570				
PH1	16	6	10 570				
PH2	13	4	10 570				

SUPERSTRUCTURE

Abutment - Deck - Rail

Pier Head

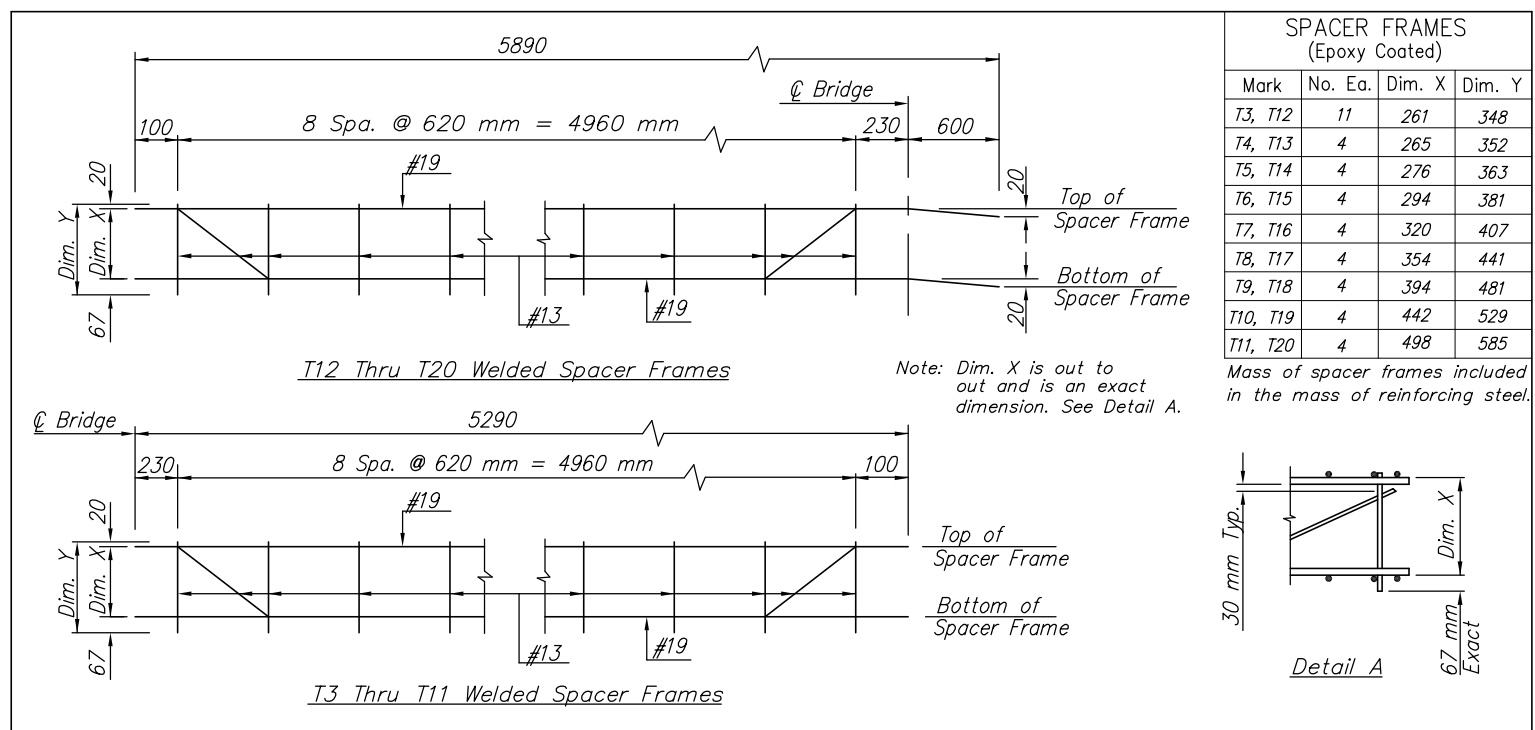
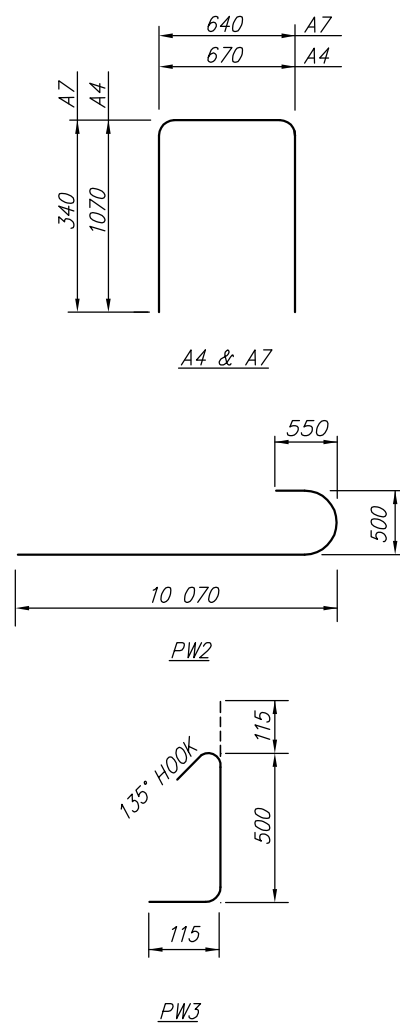

SPACER FRAMES (Epoxy Coated)			
Mark	No. Ea.	Dim. X	Dim. Y
T3, T12	11	261	348
T4, T13	4	265	352
T5, T14	4	276	363
T6, T15	4	294	381
T7, T16	4	320	407
T8, T17	4	354	441
T9, T18	4	394	481
T10, T19	4	442	529
T11, T20	4	498	585

Mass of spacer frames included in the mass of reinforcing steel.

BENDING DIAGRAMS
(All dimensions are out to out of bars.)

Non-Epoxy			
PW1	13	108	6630
PW2	13	56	10 900
PW3	13	252	730

* See Bending Diagrams