

STATE	PROJECT NO.	YEAR	SHEET NO.	TOTAL SHEETS
KANSAS	54-87 K-8258-04	2004	47	60

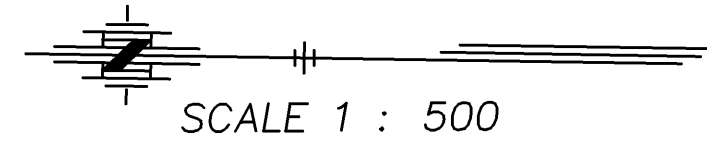



DATE	
BY	
REFERENCE NOTED	
REFERENCE CHECKED	

CONSTRUCTION SEQUENCE NORTH ARMOUR ROAD

PHASE II

1. Shift Southbound Traffic To Western Lane That Was Constructed In Phase I.
2. Construct Pavement Lane Adjacent To Western Lane Constructed In Phase I.
3. Continue Utility Construction On East Side Of Armour Road.

LEGEND

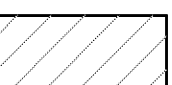
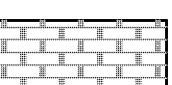
-  TYPE III BARRICADE
-  CONSTRUCTION AREA THIS PHASE
-  EXISTING PAVEMENT TO BE REMOVED
-  TEMPORARY ASPHALT PAVEMENT (TO BE REMOVED THIS PHASE)

STA. 49+718 TO STA. 49+767
REMOVE TEMPORARY ASPHALT
& CONST. REMAINING CURB &
GUTTER DURING OFF PEAK
HOURS LT. & RT.

REFER TO STD. T744SI FOR
CHANNELIZING DEVICES AND
PAVEMENT MARKINGS.

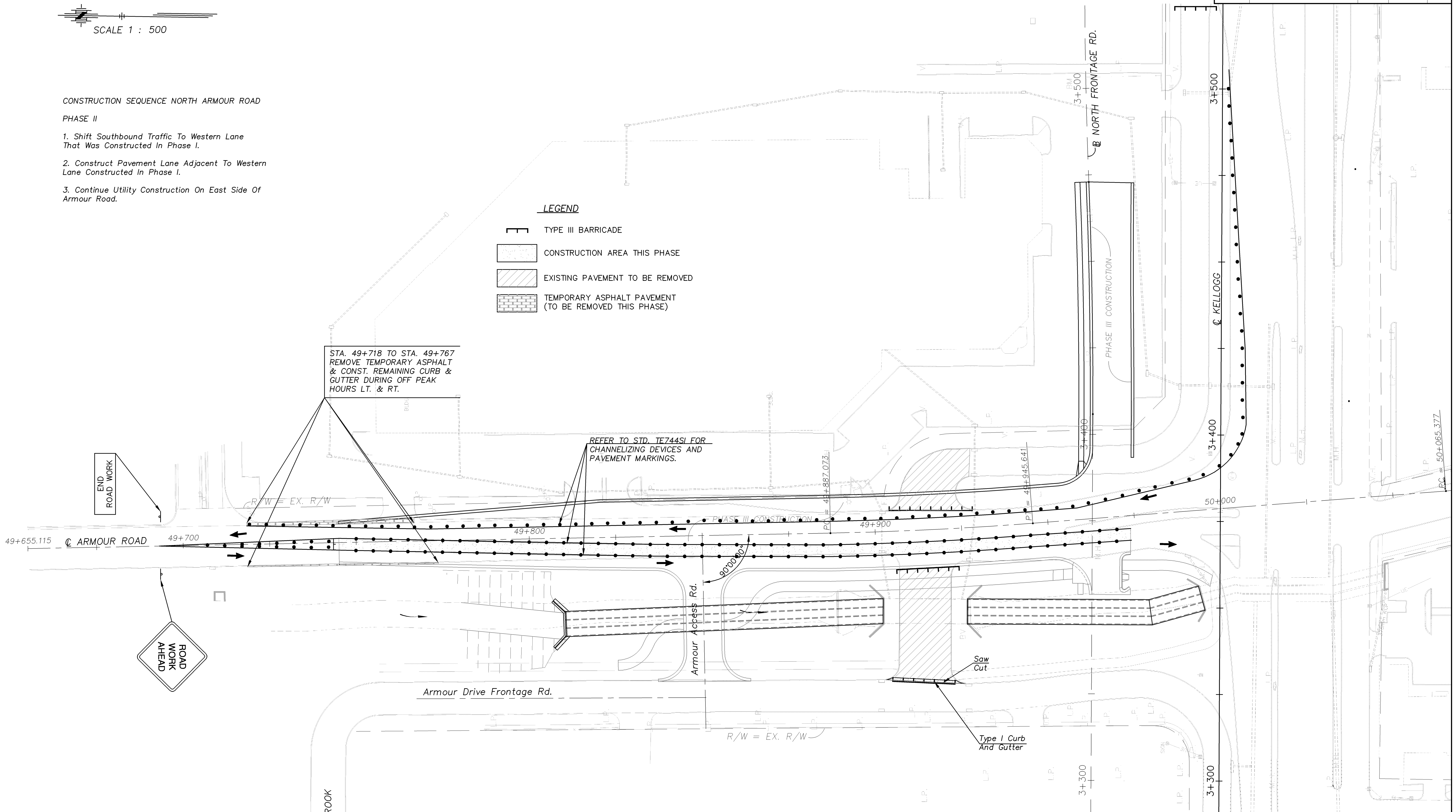

END ROAD WORK

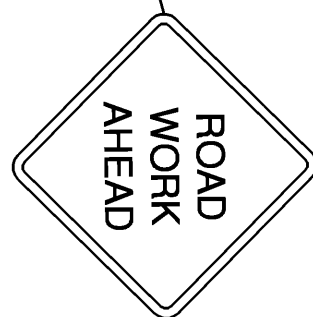

Drawn by: SCALE
Plotted:



KANSAS DEPARTMENT OF TRANSPORTATION
TRAFFIC CONTROL PLAN
NORTH ARMOUR ROAD
PHASE II