

STATE OF KANSAS
CITY OF WICHITA
SEDGWICK COUNTY

PROJECT NUMBER	Sheet No.	Total Sheets
87 N-0306-01	1	111

KANSAS DEPARTMENT OF TRANSPORTATION PROJECT NUMBER 87 N-0306-01
29TH STREET NORTH FROM TYLER ROAD TO RIDGE ROAD

INDEX OF SHEETS

- 1 _____ TITLE SHEET
- 2-3 _____ TYPICAL SECTIONS
- 4-13 _____ PLAN & PROFILE SHEETS
- 14-15 _____ PAVING PLANS
- 16-17 _____ INTERSECTION DETAILS
- 18-20 _____ PAVING DETAILS
- 21 _____ SCHEDULE OF INLETS AND MANHOLES
- 22-26 _____ DRAINAGE DETAILS
- 27-38 _____ CULVERT DETAILS
- 39 _____ SUMMARY OF QUANTITIES
- 40-45 _____ EROSION CONTROL PLANS
- 46-52 _____ SIGNAL PLANS
- 53-55 _____ PAVEMENT MARKING PLANS
- 56-61 _____ TRAFFIC CONTROL PLANS
- 62-70 _____ LANDSCAPE PLANS
- 71-111 _____ CROSS SECTIONS

2004 TRAFFIC CENSUS 8,500 VEHICLES PER DAY
DESIGN SPEED 40 MPH

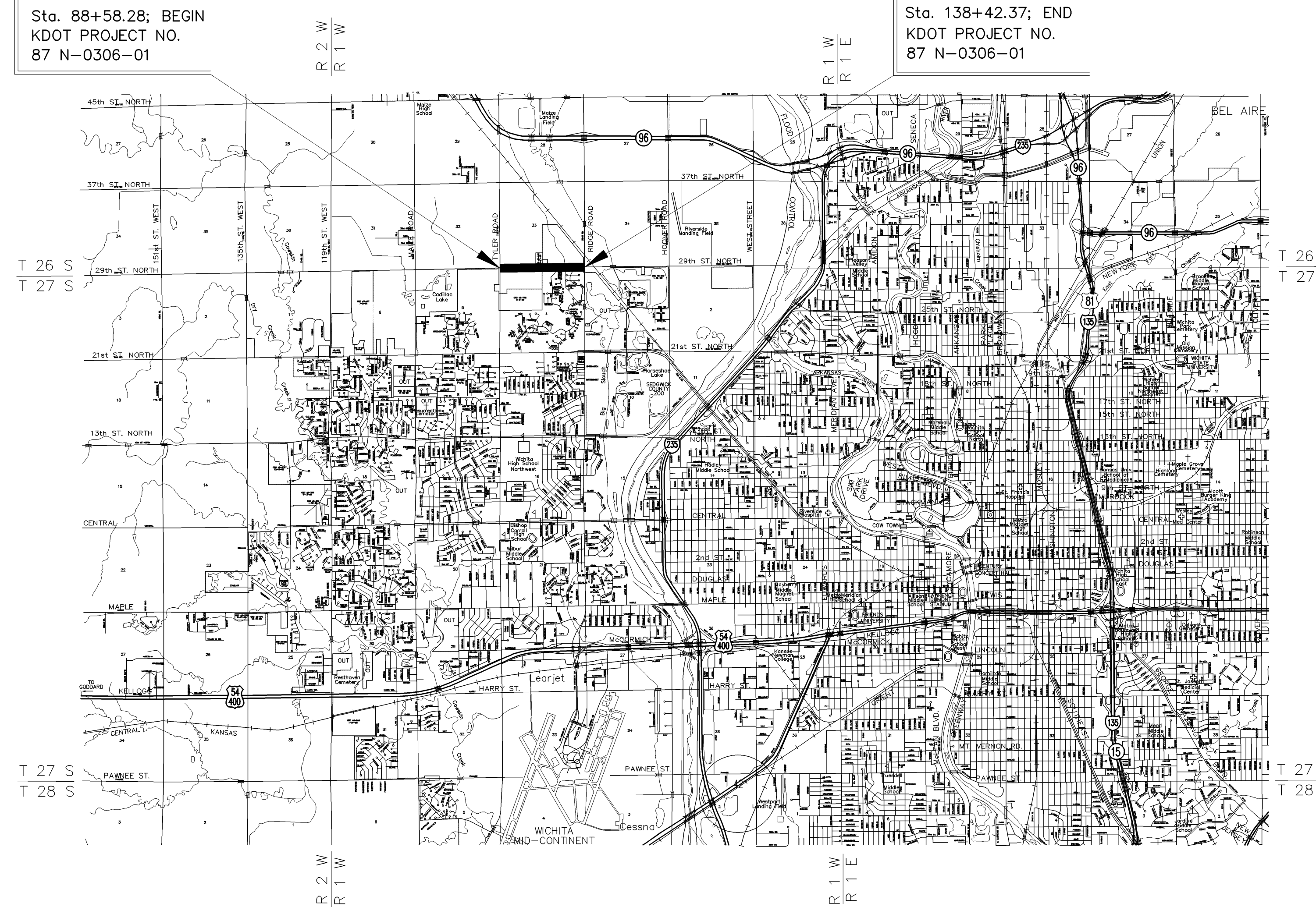

GRADING
PAVEMENT
STORM SEWER
TRAFFIC SIGNAL
LANDSCAPE
PAVEMENT MARKING

CITY OF WICHITA
PROJECT NO.
472-83903
O.C.A. No. 706914

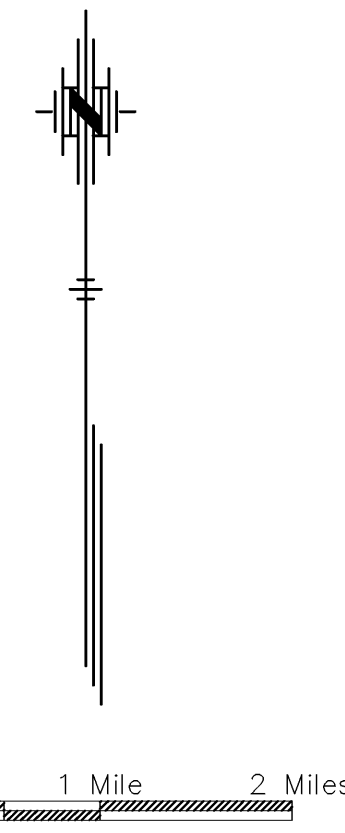

Utility Locate Contacts

Call BEFORE you dig
1-800-344-7233
STATEWIDE (DIG SAFE)

NOTE: ROAD SHALL REMAIN OPEN TO THRU TRAFFIC DURING CONSTRUCTION.

GENERAL NOTE

ALL CONSTRUCTION METHODS AND MATERIALS USED IN THE CONSTRUCTION OF THE IMPROVEMENTS COVERED BY THESE PLANS SHALL BE IN ACCORDANCE WITH THE STANDARD TECHNICAL SPECIFICATIONS AND CURRENT REVISIONS ON FILE IN THE OFFICE OF THE CITY ENGINEER, CITY OF WICHITA, KANSAS. THE CITY ENGINEERS DECISIONS ON QUESTIONS REGARDING THESE PLANS SHALL GOVERN.

CONVENTIONAL SIGNS

COUNTY LINE	-----	CENTER LINE OF PROJECT	-----	50	1
CITY LIMITS	-----	TERRACE	-----	[Symbol]	
STATE OR NATIONAL LINE	-----	CULVERTS	-----	[Symbol]	
TOWNSHIP, SECTION or GRANT LINE	-----	DROP INLET & STORM SEWER	-----	[Symbol]	
PROPERTY LINE	-----	ACCESS CONTROL	-----	[Symbol]	
HIGHWAY FENCE	-----	POWER POLE	-----	[Symbol]	
EXISTING FENCE	-----	TELEPHONE POLE	-----	[Symbol]	
GUARD FENCE	-----	MARSH	-----	[Symbol]	
CONSTRUCTION LIMITS	-----	HEDGE	-----	[Symbol]	
RIGHT OF WAY LINE	-----	TREES	-----	[Symbol]	
TRAVELED WAY	-----	PROFILE ELEVATION	-----	[Symbol]	
RAILROADS	-----	STREAM or CREEK	-----	[Symbol]	

GROSS LENGTH OF PROJECT	-----	4884.09 ft.
EXCEPTIONS	-----	ft.
NET LENGTH OF PROJECT	-----	4884.09 ft.
NET LENGTH OF BRIDGES	-----	ft.
NET LENGTH OF ROAD	-----	4884.09 ft.

CITY OF WICHITA, KANSAS
DEPARTMENT OF PUBLIC WORKS - ENGINEERING DIVISION

RELEASED FOR CONSTRUCTION: _____ DATE
CITY ENGINEER

ATTESTED: _____ DATE
CITY CLERK

PLANS PREPARED BY: