

DSNR: OPER: JGP SCALE: 1"=5'  
 I:/2004/04219/TYPICALS4.DGN 10-29-2004 14:38:36 LAST REV: 9-27-2005 BY: RJM

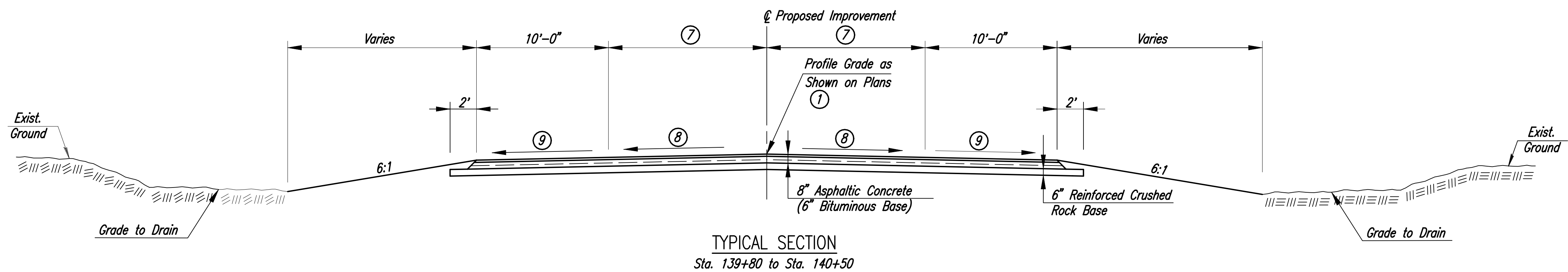

TYPICAL SECTION  
 Sta. 139+80 to Sta. 140+50

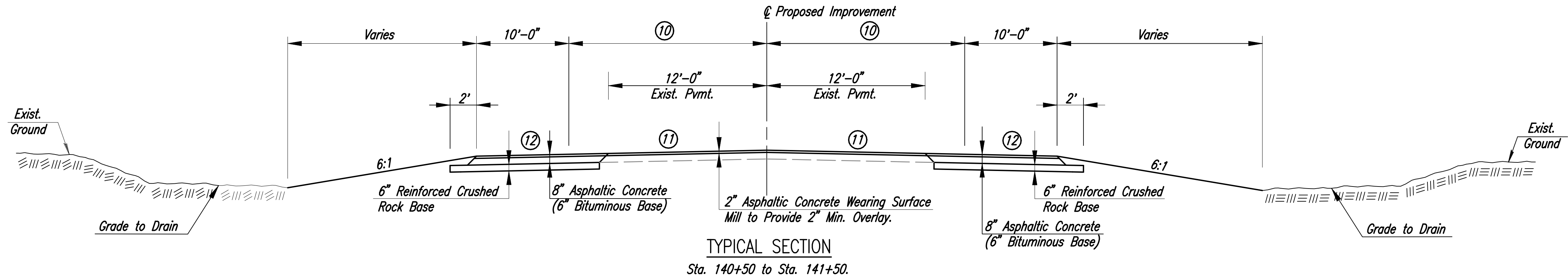

TYPICAL SECTION  
 Sta. 140+50 to Sta. 141+50.

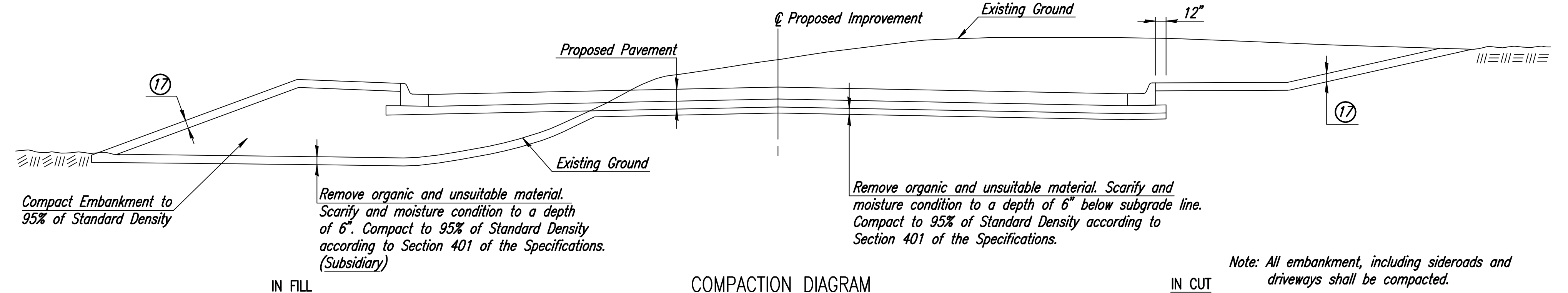

COMPACTION DIAGRAM

- ① Profile Grade is the theoretical top of pavement elevation at  $\mathcal{C}$
- ⑦ Varies from 18.00' at Sta. 139+80 to 15.38' at Sta. 140+50.
- ⑧ Cross Slope Varies From 3/8" / ft. at Sta. 139+80 to 2.70% at Sta. 140+50.
- ⑨ Cross Slope Varies from 3/8" / ft. at Sta. 139+80 to 3.55% at Sta. 140+50.
- ⑩ Varies from 15.38' at Sta. 140+50 to 12.00' at Sta. 141+40.
- ⑪ Cross Slope Varies from 2.70% at Sta. 140+50 to 1/4" / ft. at Sta. 141+50
- ⑫ Cross Slope Varies from 3.55% at Sta. 140+50 to 1/2" / ft. at Sta. 141+50
- ⑬ Backfill behind curb. Quantities for this work are included in the Earthwork Summary Table.

⑰ The top 6" of all areas to be seeded shall be topsoiled with material suitable for growth of vegetation. Thru cuts, over excavate 6" for placement of topsoil. This work shall be Subsidiary to other earthwork items. In fill, the top 6" of embankment shall be topsoil. Quantities for this work are included in the contract bid items for earthwork. No measurement or payment will be made for material required to replace material excavated during stripping operations.

Note: All embankment, including sidewalks and driveways shall be compacted.

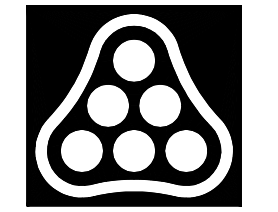
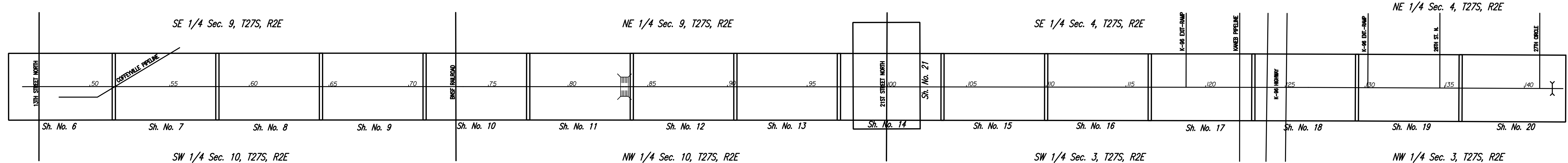

No.	Revision	By	Date
GREENWICH ROAD			
TYPICAL SECTIONS			
JAMES L. ARMOUR, P.E.-CITY ENGINEER CITY OF WICHITA PROJECT NO. 472-84004			
Professional Engineering Consultants, P.A. 303 S. TOPEKA • WICHITA, KANSAS 67202 316-262-2691 • FAX 316-262-3003			
Designed by	Job No. 04219	Sht. 5 of 215	
Drawn by	Date AUGUST, 2004		