

*Wichita Public Pool Site  
Lighting Improvements*

*PROJECT NO.: 472 84002*

*OCA: 785041 and 785042*

*CITY OF WICHITA, KANSAS*

*Jim Armour, P.E., Acting City Engineer*

INDEX OF SHEETS

- 1 Cover Sheet
- 2 Details/General Notes
- 3 Orchard Pool/Linwood Pool
- 4 Boston Pool/Edgemoor Pool
- 5 Aley Pool/Country Acres Pool
- 6 Harvest Pool/Evergreen Pool
- 7 McAdams Pool/Light Fixture Schedule

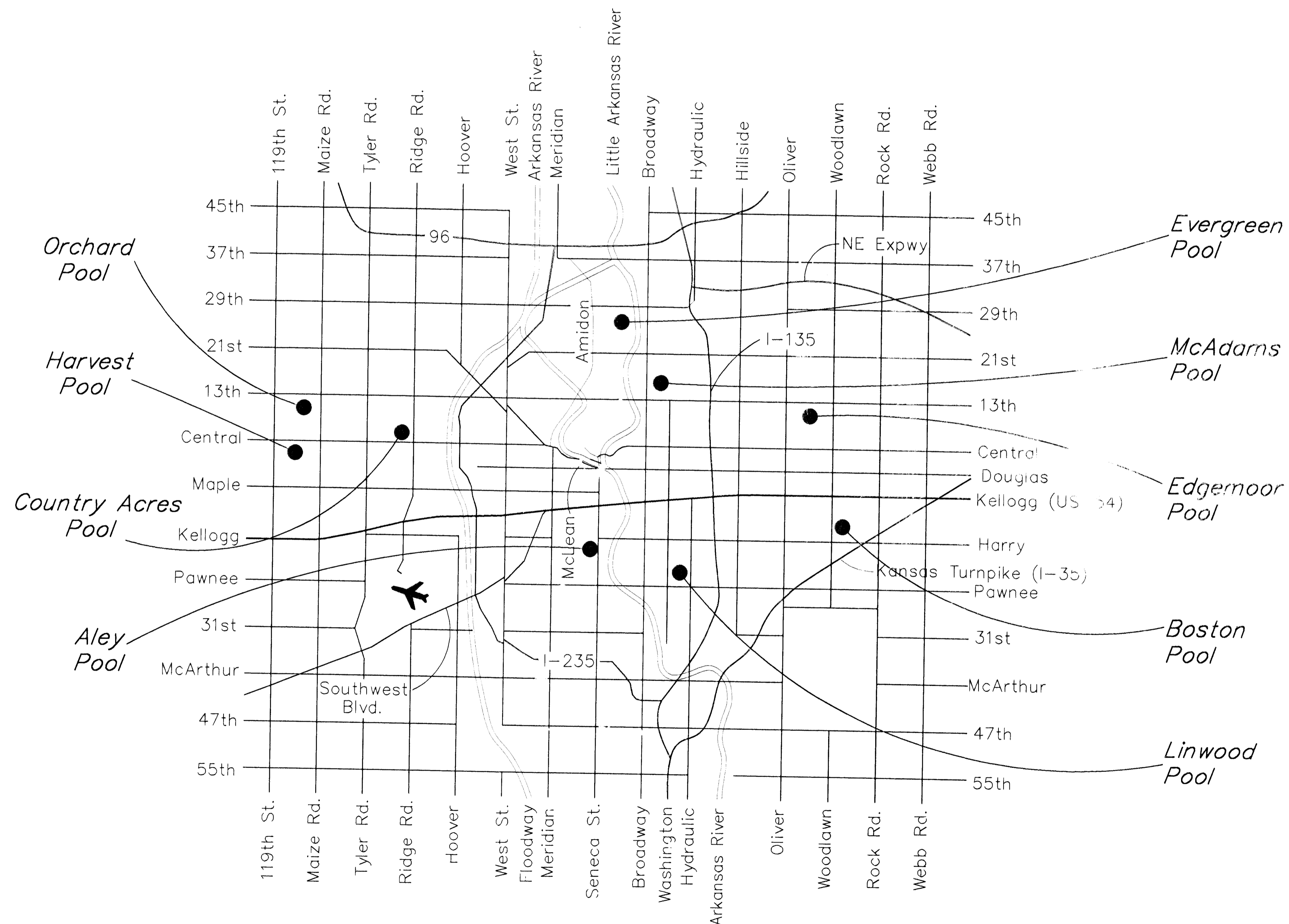

*October 2004*

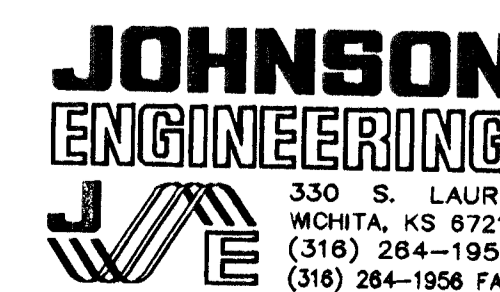

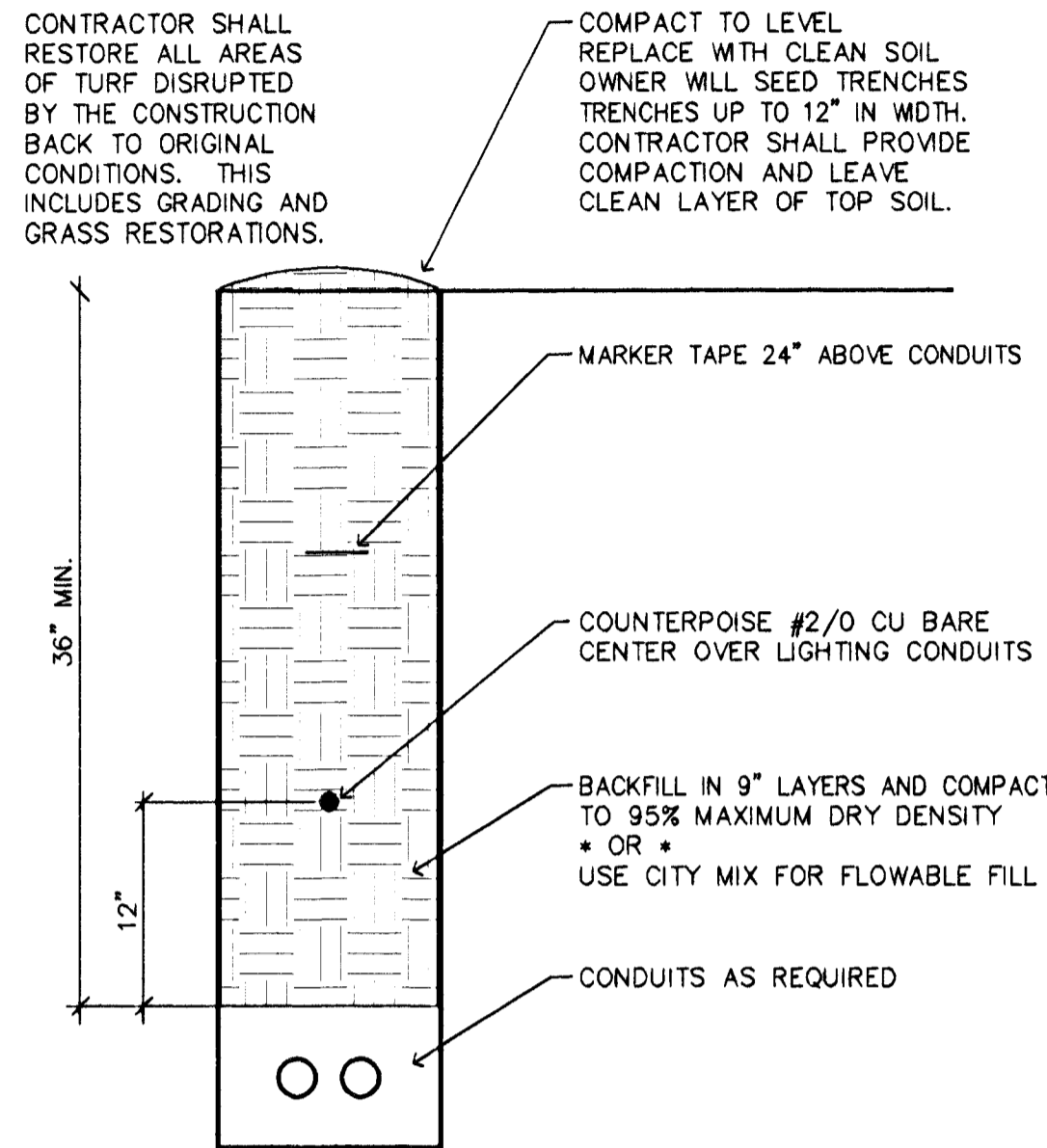

**TRENCH IN SOIL DETAIL**  
N.T.S.

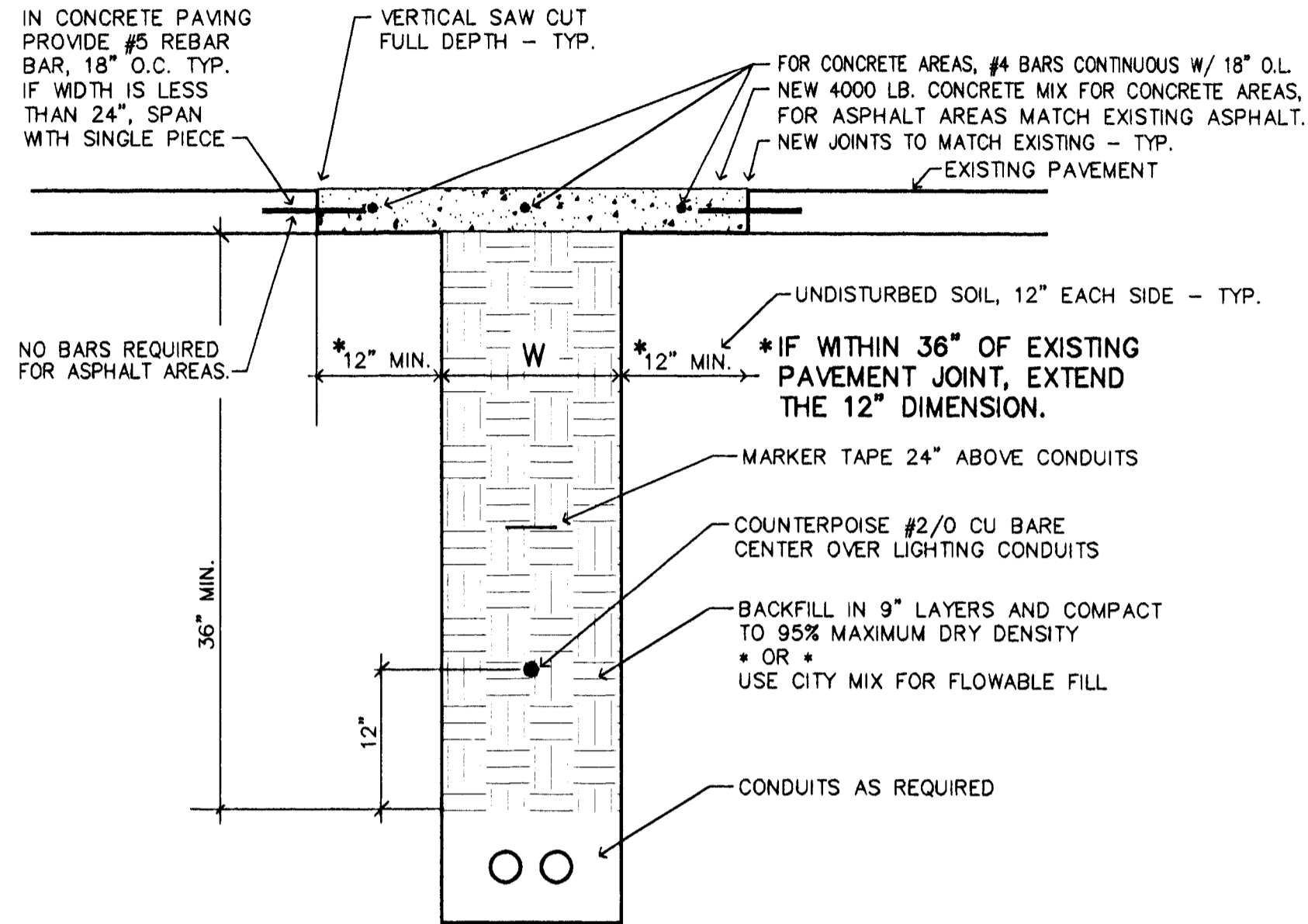

**TRENCH BELOW PAVEMENT DETAIL**  
N.T.S.

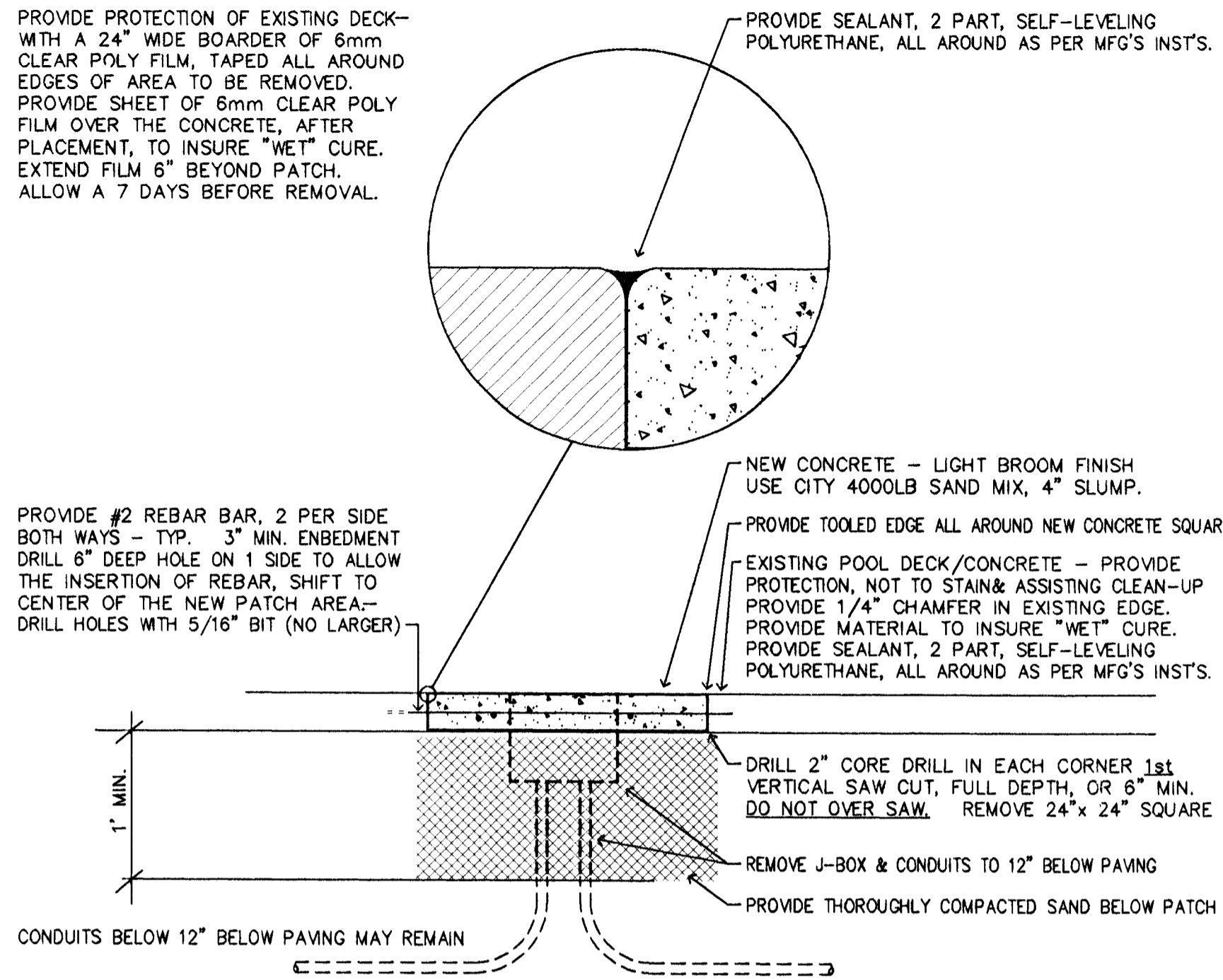

**POOL DECK/CONCRETE PATCH DETAIL**  
TYPICAL FOR ALL BOXES &/OR POLES REMOVED

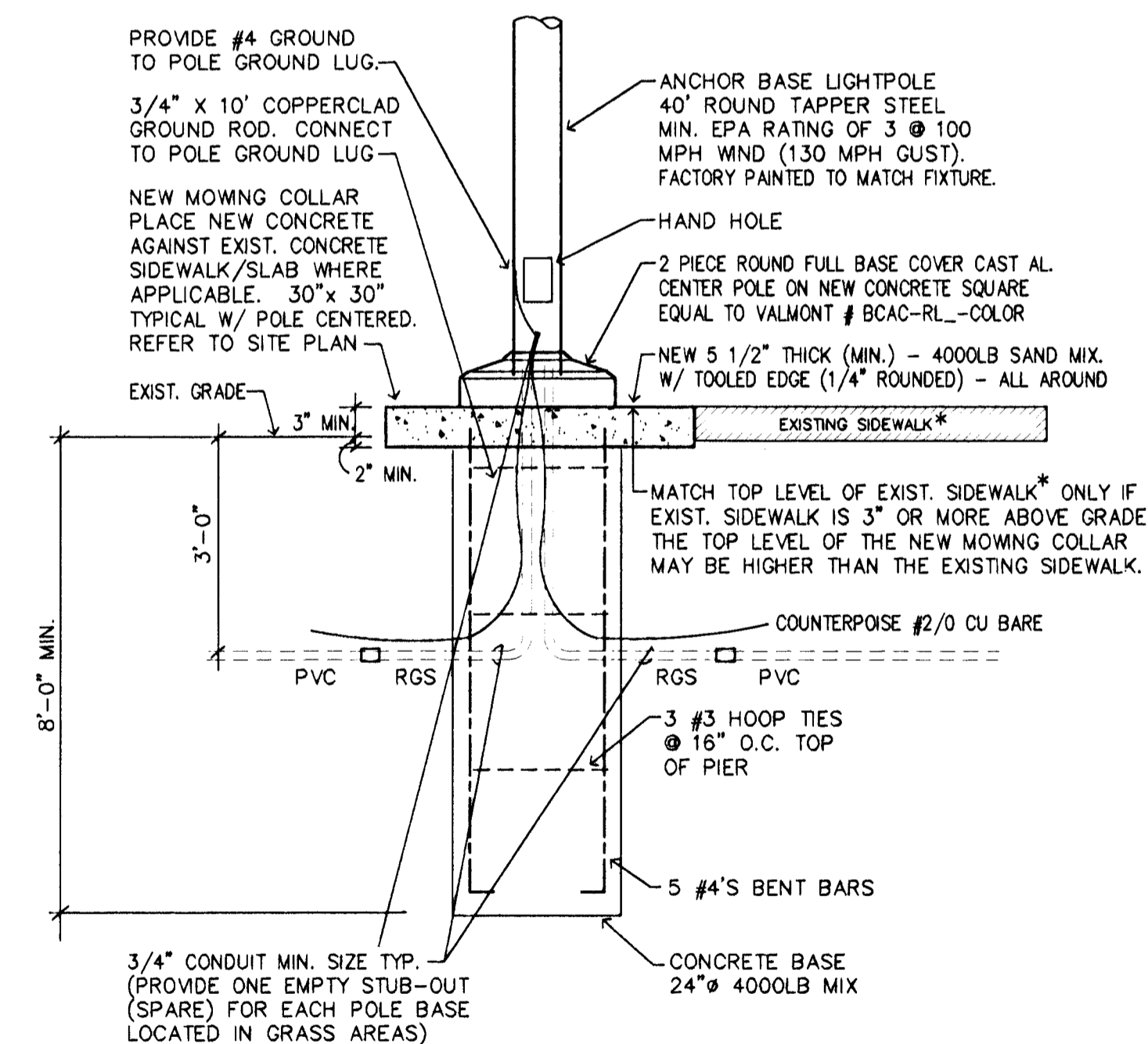

**POLE 2 - BASE DETAIL**  
TYPICAL FOR FIXTURE: A

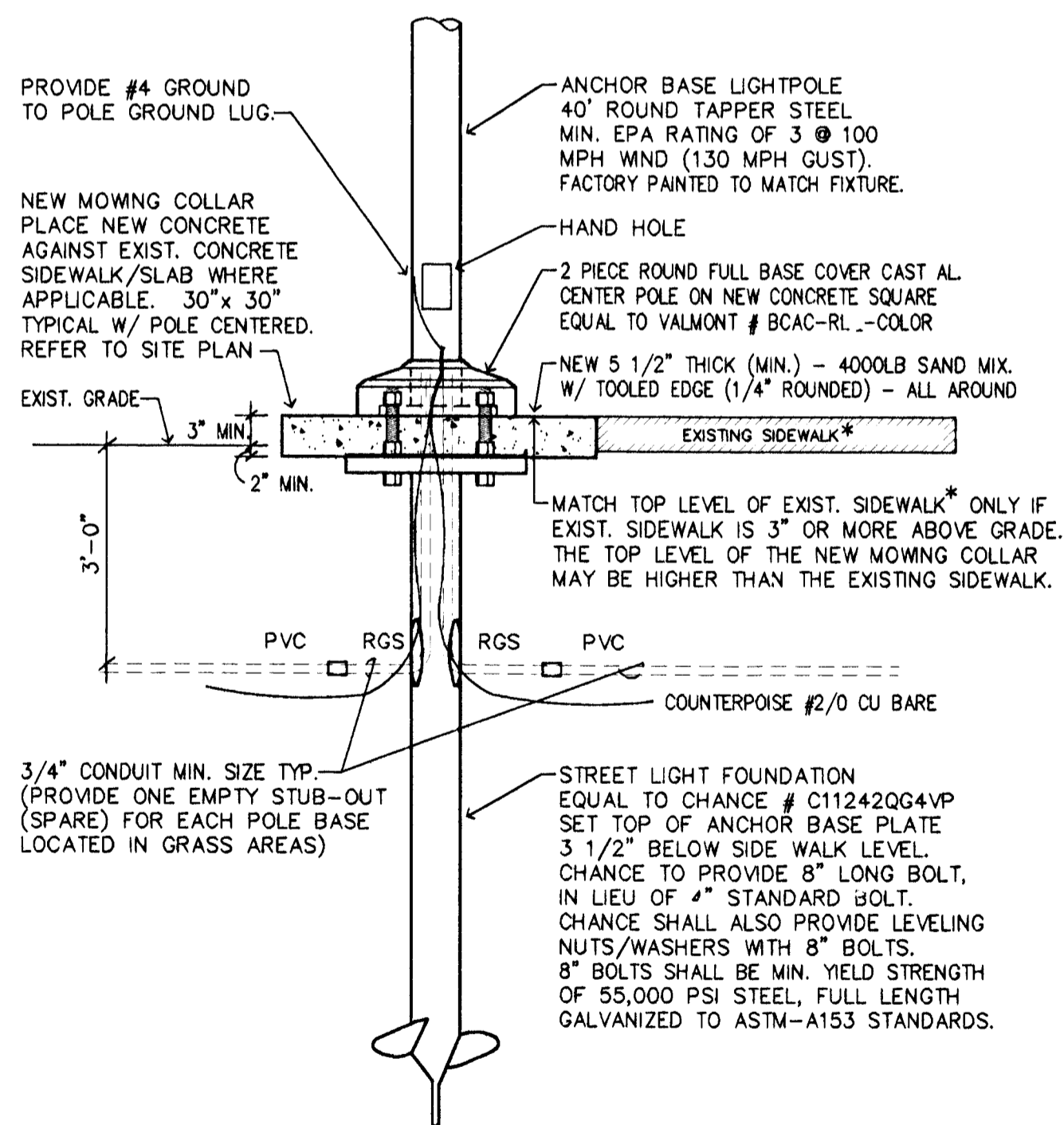

**POLE 2 - BASE DETAIL**  
CONTRACTORS OPTION: USE SCREW-IN BASE FOR FIXTURE: A

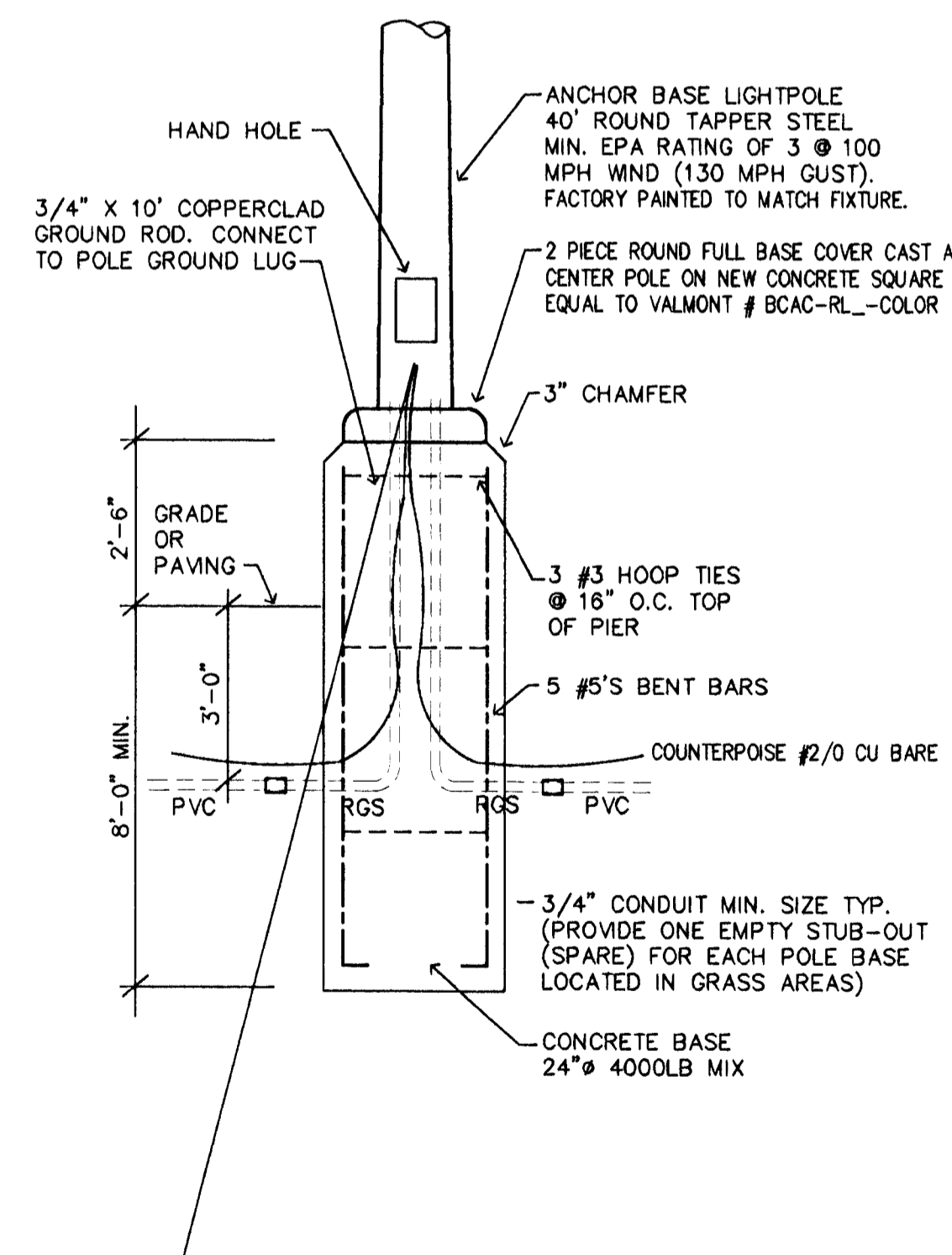

**POLE 1 - BASE DETAIL**  
TYPICAL FOR FIXTURE: C

**GENERAL NOTES**

1. THE INSTALLING CONTRACTOR IS RESPONSIBLE TO REVIEW ALL ARCHITECTURAL, STRUCTURAL, MECHANICAL PLANS AND SPECIFICATIONS/ADDENDA FOR ADDITIONAL INFORMATION AND/OR COORDINATION. ADDITIONAL ELECTRICAL REQUIREMENTS MAY BE INCLUDED IN THE ABOVE REFERENCED DOCUMENTS THAT THE E.C. IS RESPONSIBLE FOR PROVIDING AND/OR INSTALLING.
2. REFER TO MECHANICAL PLANS AND SPECIFICATIONS FOR EXACT LOCATION OF MECHANICAL EQUIPMENT AND T-STAT LOCATIONS. FUSING OF MECHANICAL EQUIPMENT AS PER NAME PLATE DATA ON EQUIPMENT.
3. ALL LINE VOLTAGE WIRING SHALL BE COPPER IN STEEL CONDUIT & STEEL BOXES, UNLESS SPECIFICALLY NOTED OTHERWISE. EACH CONDUIT CONTAINING LINE VOLTAGE SHALL CONTAIN A GREEN, INSULATED GROUND CONDUCTOR. THIN WALL CONDUIT SHALL NOT BE INSTALLED FOR EXTERIOR USE. ALL CONDUITS ROUTING SHALL BE INSTALLED PARALLEL AND PERPENDICULAR. ALL CONDUIT PENETRATIONS OF BUILDING WALLS SHALL BE SEALED/CAULKED WITH AN APPROPRIATELY MATERIAL, FIRE RATED.
4. STRAIGHT RUNS UNDERGROUND / IN SLAB CONDUIT MAY BE SCHEDULE 40 PVC, 3/4" MINIMUM WITH STEEL ELLS, BENDS AND RISERS. ALL RISERS PENETRATING SLAB OR EXITING FROM EARTH SHALL BE RIGID STEEL. NO EXCEPTIONS.
5. ALL RACEWAYS FOR BUILDING MOUNTED LIGHTING FIXTURES, SHALL BE ROUTED INSIDE THE BUILDING. EXTERIOR, EXPOSED RACEWAYS IS NOT ACCEPTABLE.
6. VERIFY ALL OUTLET LOCATIONS ON JOB, PRIOR TO ROUGH-IN.
7. EXTERIOR EXPOSED CONDUIT RUNS WILL NOT BE PERMITTED, (EXCEPT WHERE SPECIFICALLY NOTED ON PLAN OR SPECIFICALLY INDICATED & APPROVED IN WRITING.)
8. ALL NEW CONDUIT INSTALLED INSIDE THE BUILDING SHALL BE SCH 80 PVC. ANY SCH 40 PVC FOUND INSTALLED INSIDE THE BUILDING, WILL BE REMOVED AND REPLACED WITH SCH 80, BY THE CONTRACTOR AT NO ADDITIONAL EXPENSE TO THE OWNER. ALL BUILDING PENETRATIONS SHALL BE MADE ±12" ABOVE GRADE. CONDUIT INSTALLED EXTERIOR AND EXPOSED, SHALL BE RGS (GAL. RIDGED STEEL). UNDERGROUND RUNS SHALL RISE UP WITH RGS AND GO INTO AN IRON LB. ON EXTERIOR OF BUILDING. EXPOSED INTERIOR AND EXTERIOR CONDUIT RUNS SHALL BE PARALLEL/PERPENDICULAR TO BUILDING STRUCTURE. REFER TO EACH SITE FOR ADDITIONAL ROUTING INFORMATION.
9. RACEWAYS, OUTLET BOXES, PANELBOARDS, ETC. SHALL NOT UTILIZE PLASTIC ANCHORS FOR ATTACHMENT TO BUILDING ELEMENTS. PLASTIC ANCHORS WILL NOT BE PERMITTED FOR USE AT ANY LOCATION. EACH OUTLET BOX SHALL BE SECURED TO THE BUILDING STRUCTURE SUCH THAT THE ATTACHMENT WILL SAFELY SUPPORT A MINIMUM LOAD OF 50 POUNDS. ANCHORS SHALL BE STEEL SLEEVE EXPANSION TYPE, 1/4" MINIMUM.
10. E.C. SHALL VISIT SITE TO DETERMINE: 1) EXISTING CONDITIONS, 2) THE EXTENT OF DEMOLITION. ANY CONFLICTS BETWEEN PLANS/SPECIFICATIONS AND EXISTING CONDITIONS THAT AFFECT CONSTRUCTABILITY, SHALL BE BROUGHT TO THE ATTENTION OF THE ENGINEER PRIOR TO BID. NO EXCEPTIONS.
11. ALL PANELS SHALL BE PANELBOARD CONSTRUCTION WITH BOLT-IN CIRCUIT BREAKERS, COPPER BUS AND ISOLATED GROUND BUS. REFER TO THE PANEL SCHEDULES FOR ADDITIONAL INFORMATION. TANDEM STYLE BREAKERS ARE NOT ALLOWED. IF ADDITIONAL POLE SPACE IS REQUIRED, INFORM THE ENGINEER OF CONDITIONS PRIOR TO INSTALLATION.
12. PROVIDE INTERMATIC # K1121 PHOTOCELL AND INTERMATIC # ET70115C TIME CLOCK TO CONTROL EXTERIOR LIGHT FIXTURES. PHOTO CELL ON / TIME CLOCK OFF OPERATION.
13. E.C. SHALL INCLUDE IN THE ELECTRICAL BID: ALL ASSOCIATED CHARGES FOR THE ELECTRICAL SERVICES FROM THE LOCAL UTILITIES. (POWER, TELEPHONE, CABLE TELEVISION, ETC.)
14. ALL WORK SHALL COMPLY WITH LOCAL, STATE AND NATIONAL CODES. THE ELECTRICAL CONTRACTOR SHALL SECURE AND PAY FOR ALL PERMITS, FEES, INSPECTIONS AND CERTIFICATES REQUIRED.
15. THE ELECTRICAL CONTRACTOR SHALL FURNISH ALL LABOR, MATERIAL, TOOLS, TRANSPORTATION, AND EQUIPMENT REQUIRED FOR THE COMPLETE, PROPER AND SUBSTANTIAL INSTALLATION OF ALL ELECTRICAL WORK INDICATED OR REQUIRED FOR A COMPLETE WORKING INSTALLATION OF ALL ELECTRICAL SYSTEMS.
16. CONTRACTOR SHALL PROVIDE DIGITAL (pg) PICTURES OF ALL WORK INCLUDED IN EACH PAY APPLICATION. PICTURES FOR UNDERGROUND WORK SHALL INCLUDE TAPE MEASURE TO INDICATE DEPTH. UNDERGROUND PICTURES SHALL ALSO SHOW ALL RGS-TO-PVC RISERS. PICTURES SHALL SHOW DEPTH OF ALL UTILITY CROSSINGS. PROVIDE A MINIMUM OF 15 PICTURES PER SITE. PHOTO'S PER POLE AND BUILDING RISER LOCATION ARE REQUIRED, #1 TO READ TAPE MEASURE, #2 THE SAME SHOT AT A WIDER ANGLE (SHOWING ENOUGH BACKGROUND) TO IDENTIFY SITE.

**SITE LIGHTING SCOPE OF WORK**

1. CONTRACTOR (E.C.) IS RESPONSIBLE FOR GETTING ALL UNDERGROUND UTILITIES FLAGGED. THIS INCLUDES, BUT IS NOT LIMITED TO THE FOLLOWING: GAS, ELECTRIC, TELEPHONE, CABLE, FIBER OPTIC CABLE, WATER, AND IRRIGATION LINES. THE CONTRACTOR SHALL COORDINATE WITH THE OWNER TO GET FLAGGED ANY OWNER INSTALLED UNDERGROUND UTILITIES.
2. E.C. SHALL PROVIDE AND INSTALL NEW SITE LIGHTING, INCLUDING BUT NOT LIMITED TO POWER/CONTROL CONDUIT, TRENCH, AND BACKFILL, AS DIRECTED BY THE WORK AND THE CITY OF WICHITA ENGINEER. CONTRACTOR SHALL FULLY FAMILIARIZE HIMSELF WITH THE PLANS AND SPECIFICATIONS OF ALL NEW WORK UNDER THIS CONTRACT.
3. E.C. SHALL HAVE THE NEW LIGHTING SYSTEM UP AND RUNNING, BEFORE ANY REMOVAL/DEMO OF EXISTING OPERATIONAL ELECTRICAL SYSTEMS AND/OR LIGHTING.
4. E.C. SHALL REMOVE/DISPOSE THE EXISTING POLE/CONDUITS/LIGHTS INDICATED, OFF SITE. E.C. SHALL REMOVE ALL OF THE EXISTING CONCRETE POLE BASES, WHEN FOUND IN SOIL. REFER TO DETAIL FOUND THE REMOVAL OF POLES/CONDUITS IN POOL DECK AREA.
5. E.C. SHALL RESTORE ALL AREAS OF TURF DISRUPTED BY THE CONSTRUCTION BACK TO THE ORIGINAL CONDITION. PHOTO'S OF ORIGINAL CONDITION ON FILE. THIS RESTORATION INCLUDES GRADING AND GRASS ESTABLISHMENT.
6. ALL OF THE REQUIRED ELECTRICAL WORK IS NOT NECESSARILY SPECIFIED OR SHOWN ON PLANS. ALL REQUIREMENTS OF THE LIGHTING SYSTEM SHALL BE COORDINATED AND VERIFIED WITH THE EQUIPMENT SUPPLIER.
7. THE COMPLETION OF ALL WORK REQUIRED BY THIS PLAN/SPEC SHALL BE AS PER THE TIME SCHEDULE PRESCRIBED IN THE PLAN/SPEC. CONTRACTOR IS RESPONSIBLE FOR ALL PLAN & SPEC SECTIONS OF THE CONSTRUCTION DOCUMENTS.

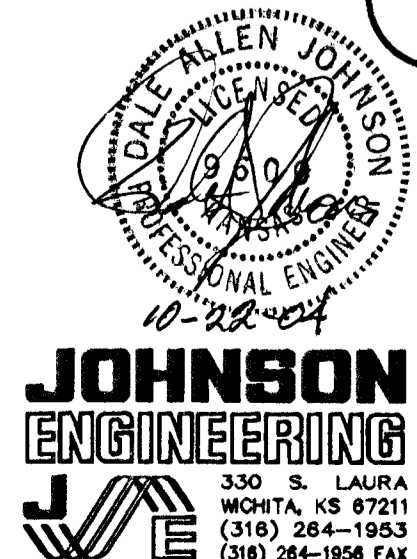

**JOHNSON ENGINEERING**  
330 S. LAURA  
WICHITA, KS 67211  
(316) 264-1953  
(316) 264-1958 FAX

**kemiller engineering**  
516 S. Market,  
Wichita, KS 67202

CITY OF WICHITA  
**NEW SITE LIGHTING**  
WICHITA PUBLIC POOLS

PROJECT NUMBER		SHEET	
# 472 84002		2	
J/E PRO. #	FILE	DATE	
#04042		10-22-04	
DESIGN	DRAWN	REMOVED	OF
DAJ	DAJ		7

Clara Street

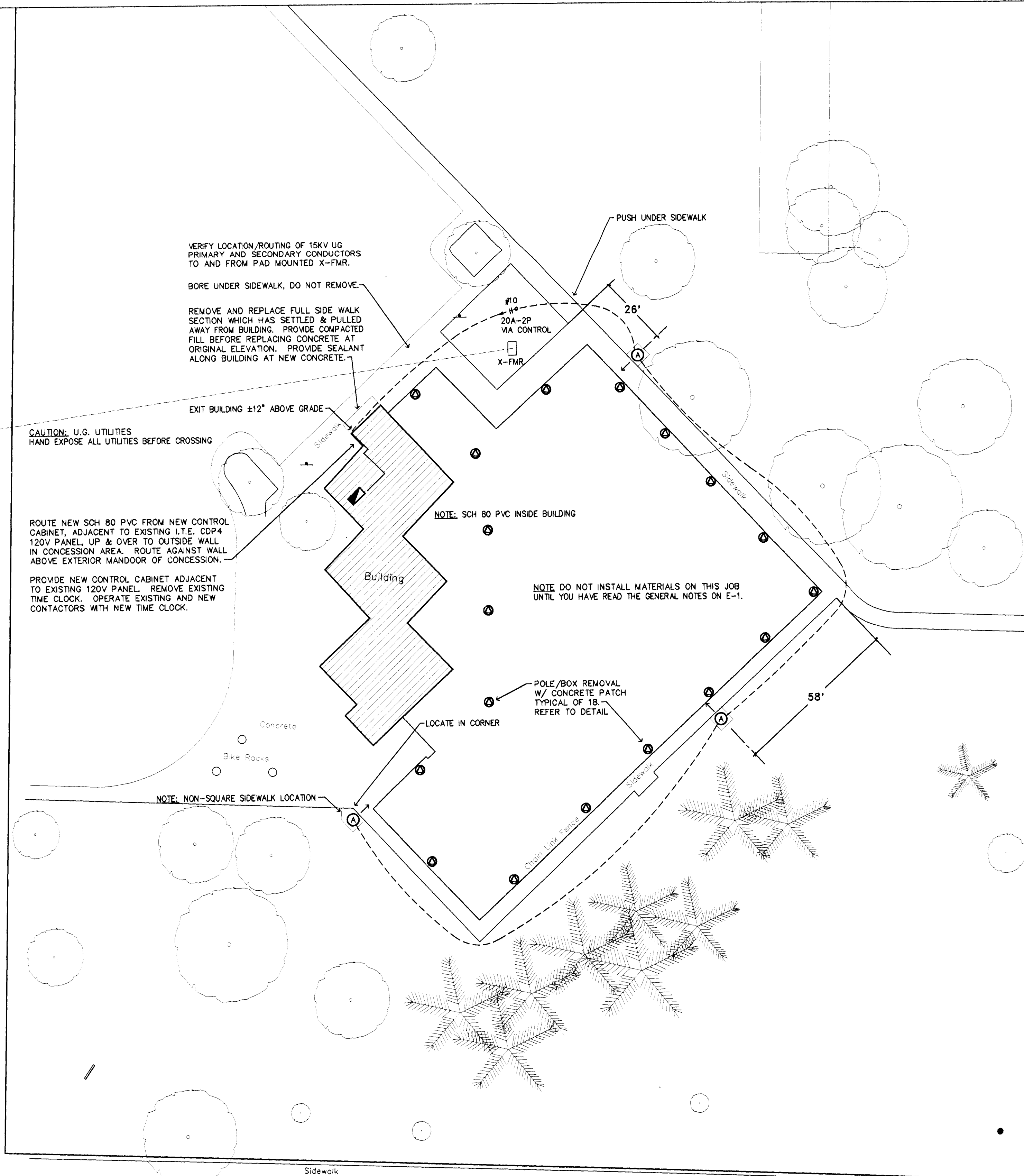

**ORCHARD SWIMMING POOL  
SITE LIGHTING PLAN**

SCALE: 0 15 30 45 60 75 90

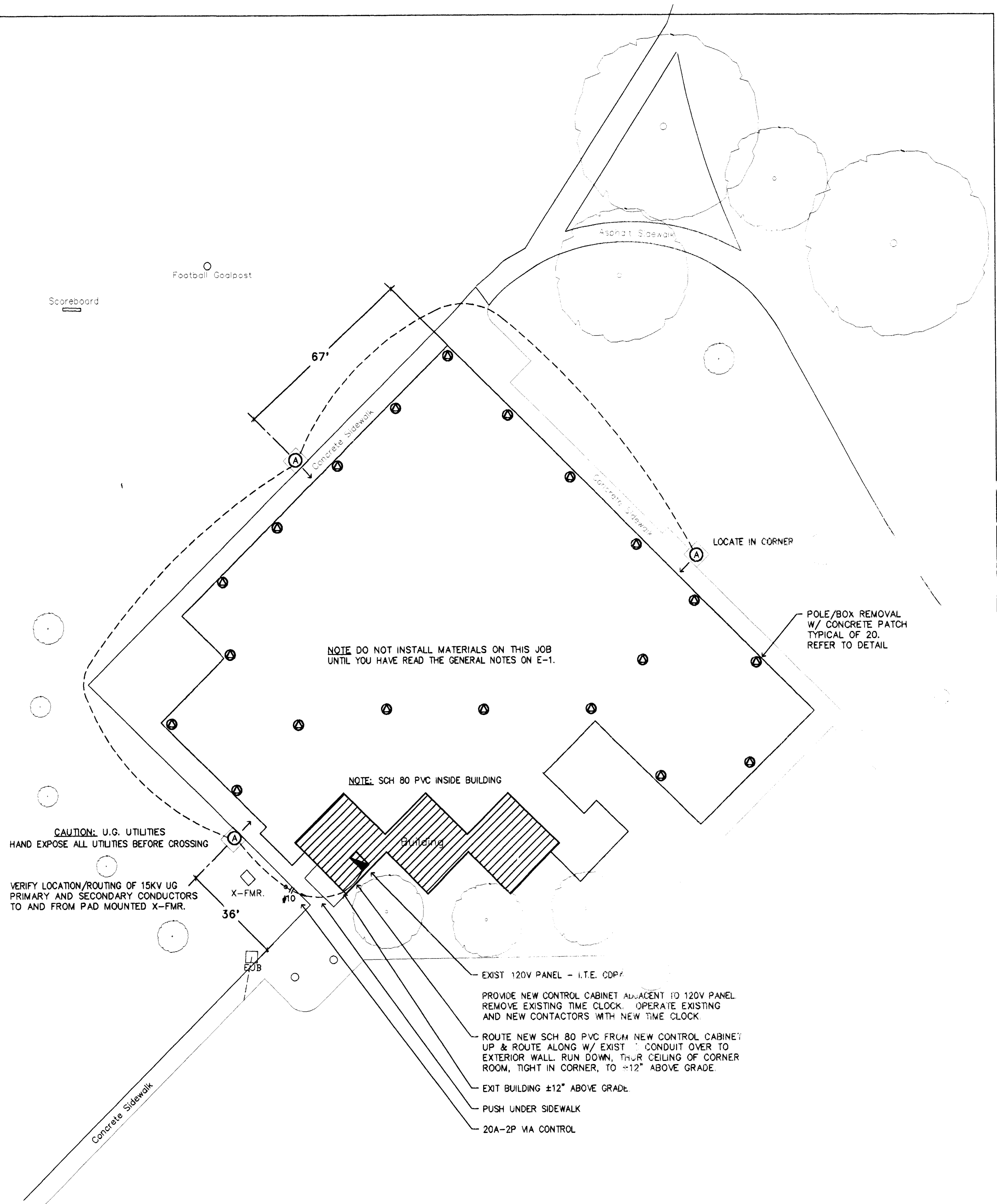
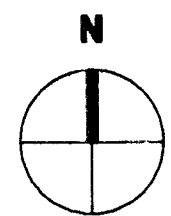

**LINWOOD SWIMMING POOL  
SITE LIGHTING PLAN**

SCALE: 0 15 30 45 60 75 90

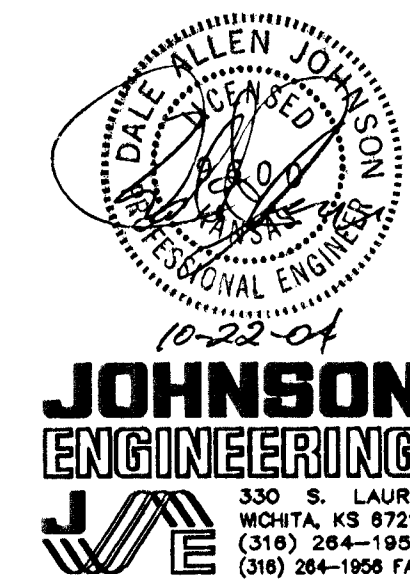
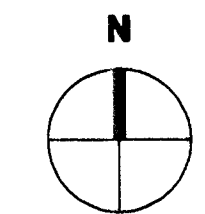

**JOHNSON  
ENGINEERING**  
330 S. LAURA  
WICHITA, KS 67211  
(316) 284-1953  
(316) 284-1958 FAX

CITY OF WICHITA <b>NEW SITE LIGHTING</b> WICHITA PUBLIC POOLS			
PROJECT NUMBER <b># 472 84002</b>			
J/E PRO. # #04042	FILE WP9-E2	DATE 10-22-04	SHEET <b>3</b>
DESIGN DAJ	DRAWN DAJ	REVISED	OF <b>7</b>

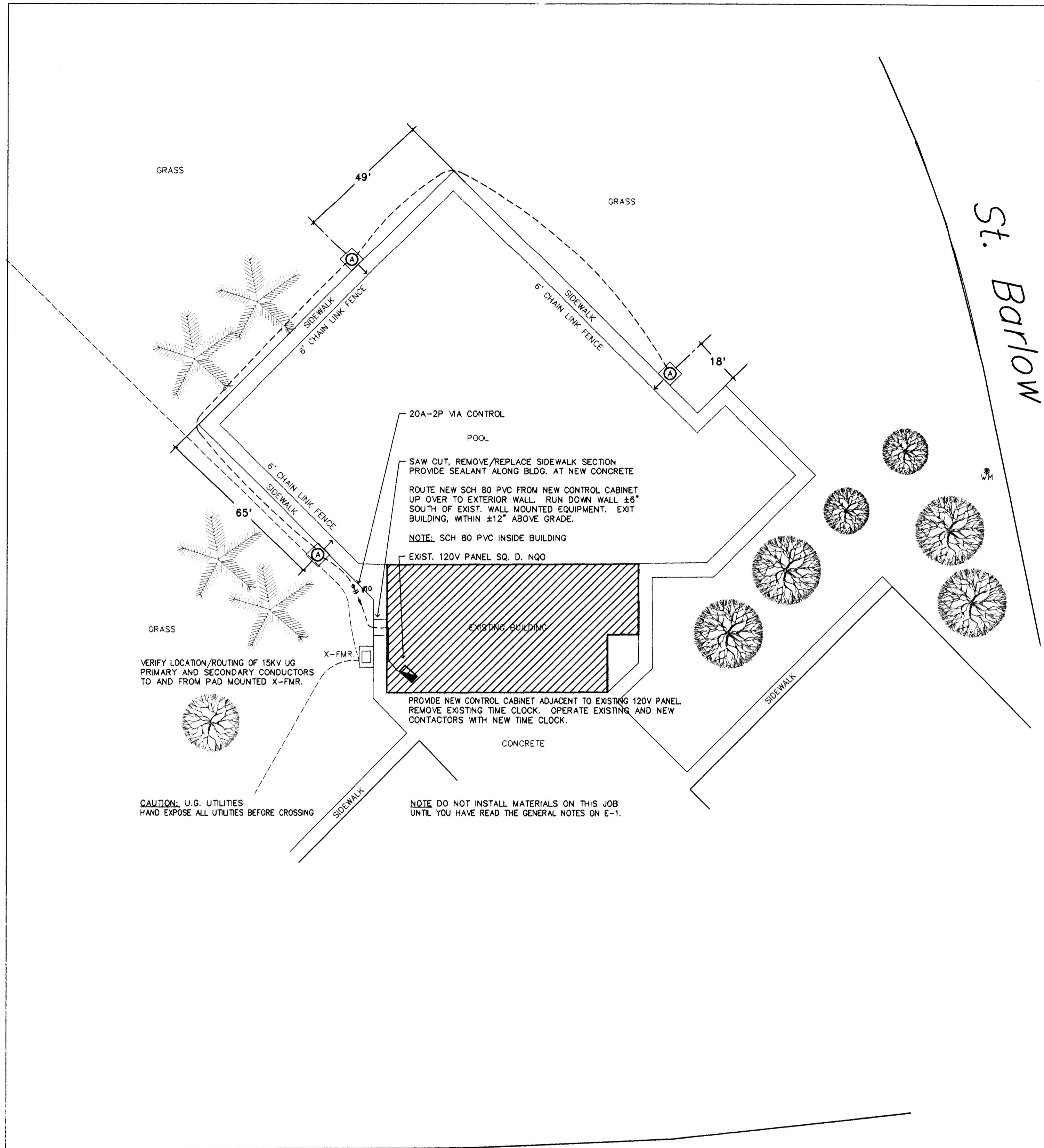

Boston Street

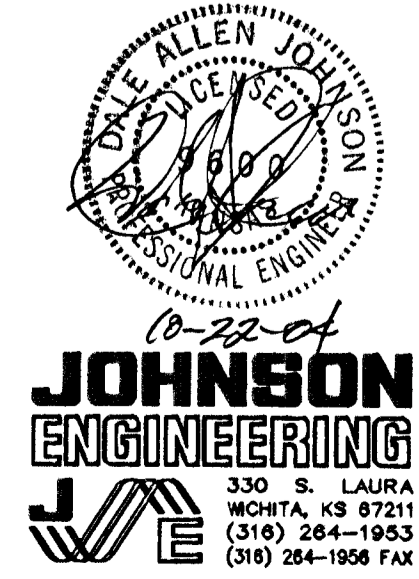
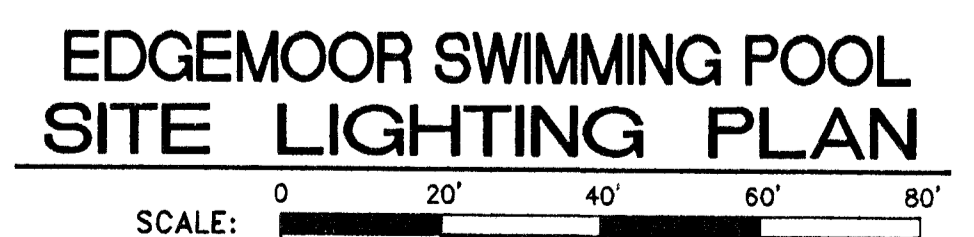
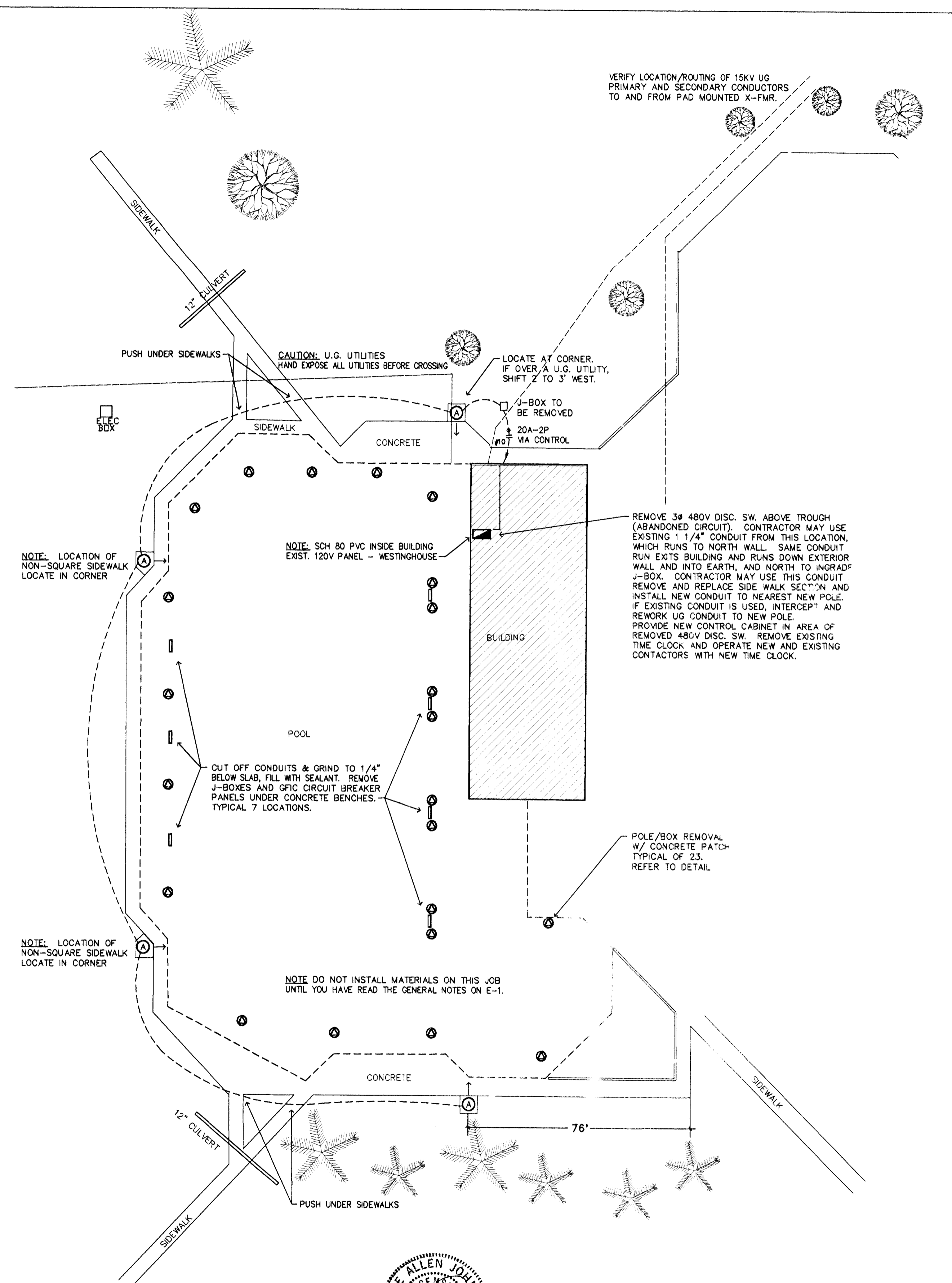
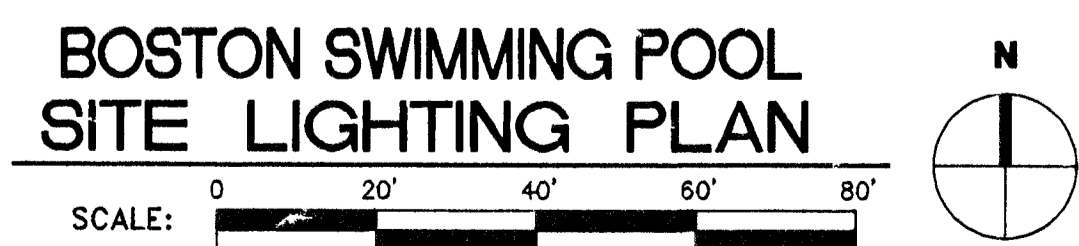

CITY OF WICHITA			
NEW SITE LIGHTING			
WICHITA PUBLIC POOLS			
PROJECT NUMBER # 472 84002			
J/E PRO. # #04042	FILE WP9-E3	DATE 10-22-04	SHEET 4
DESIGN DAJ	DRAWN DAJ	REVISED	OF 7

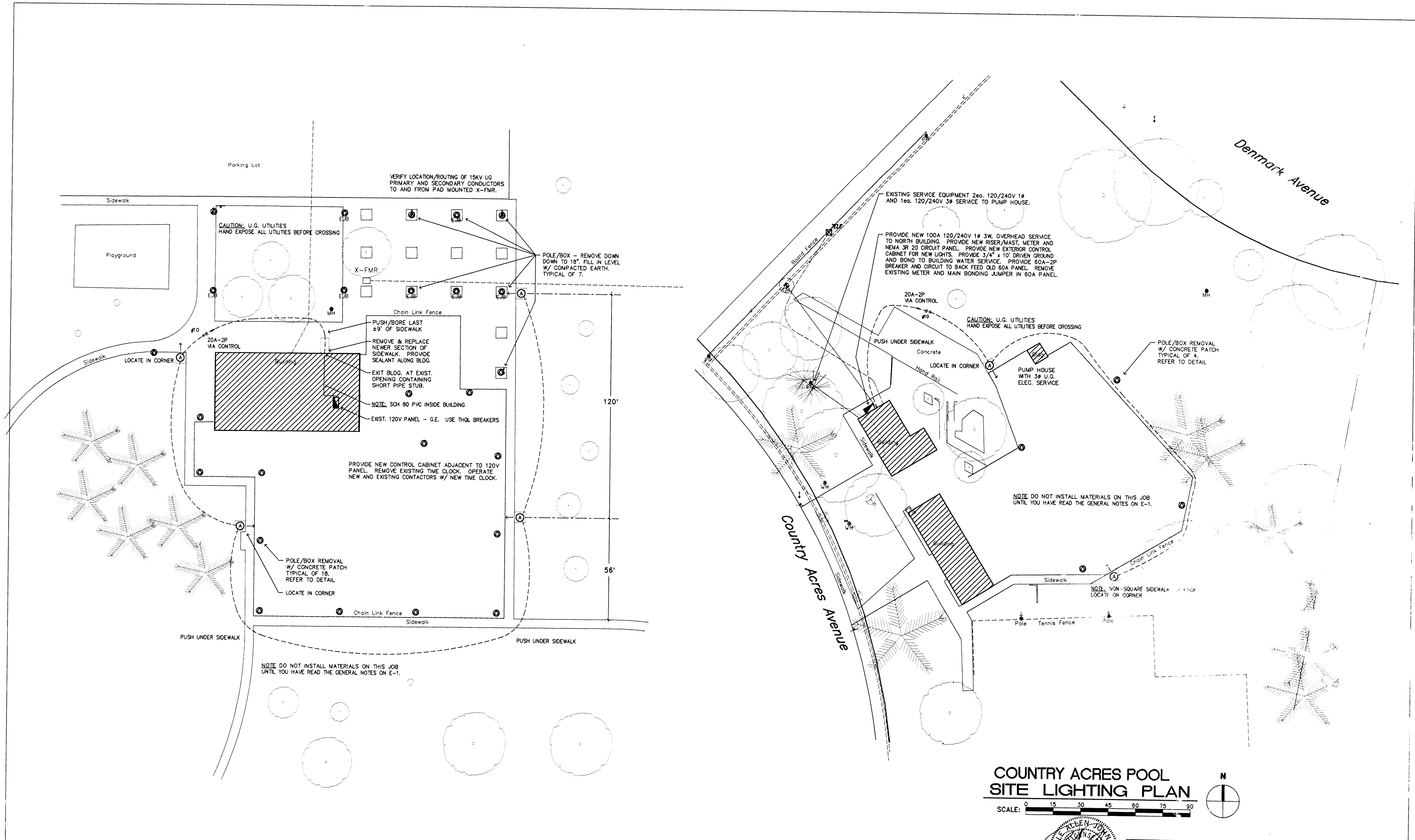

**ALEY SWIMMING POOL  
SITE LIGHTING PLAN**

SCALE: 0 15 30 45 60 75 90

N

**COUNTRY ACRES POOL  
SITE LIGHTING PLAN**

SCALE: 0 15 30 45 60 75 90

N

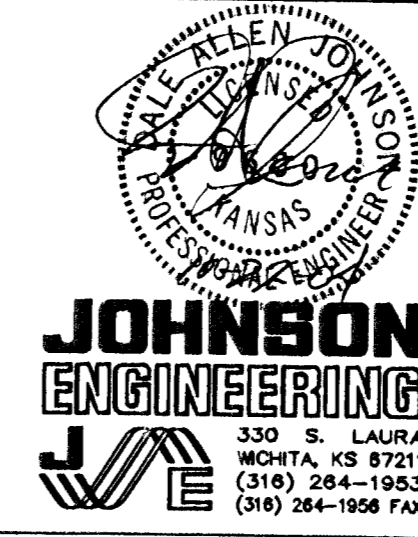

CITY OF WICHITA			
NEW SITE LIGHTING			
WICHITA PUBLIC POOLS			
PROJECT NUMBER # 472 84002			
J/E PRO. #	FILE	DATE	SHEET
#04042	WP9-E4	10-22-04	5
DESIGN	DRAWN	REVISION	OF
DAJ	DAJ		7

**Johnson Engineering**  
330 S. LAURA  
WICHITA, KS 67211  
(316) 264-1953  
(316) 264-1956 FAX

**kemiller engineering**  
518 S. Market,  
Wichita, KS 67202  
316/264-0242

**HARVEST SWIMMING POOL  
SITE LIGHTING PLAN**

SCALE: 0 20' 40' 60' 80' 100'

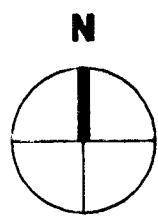

Westlink

Provincial

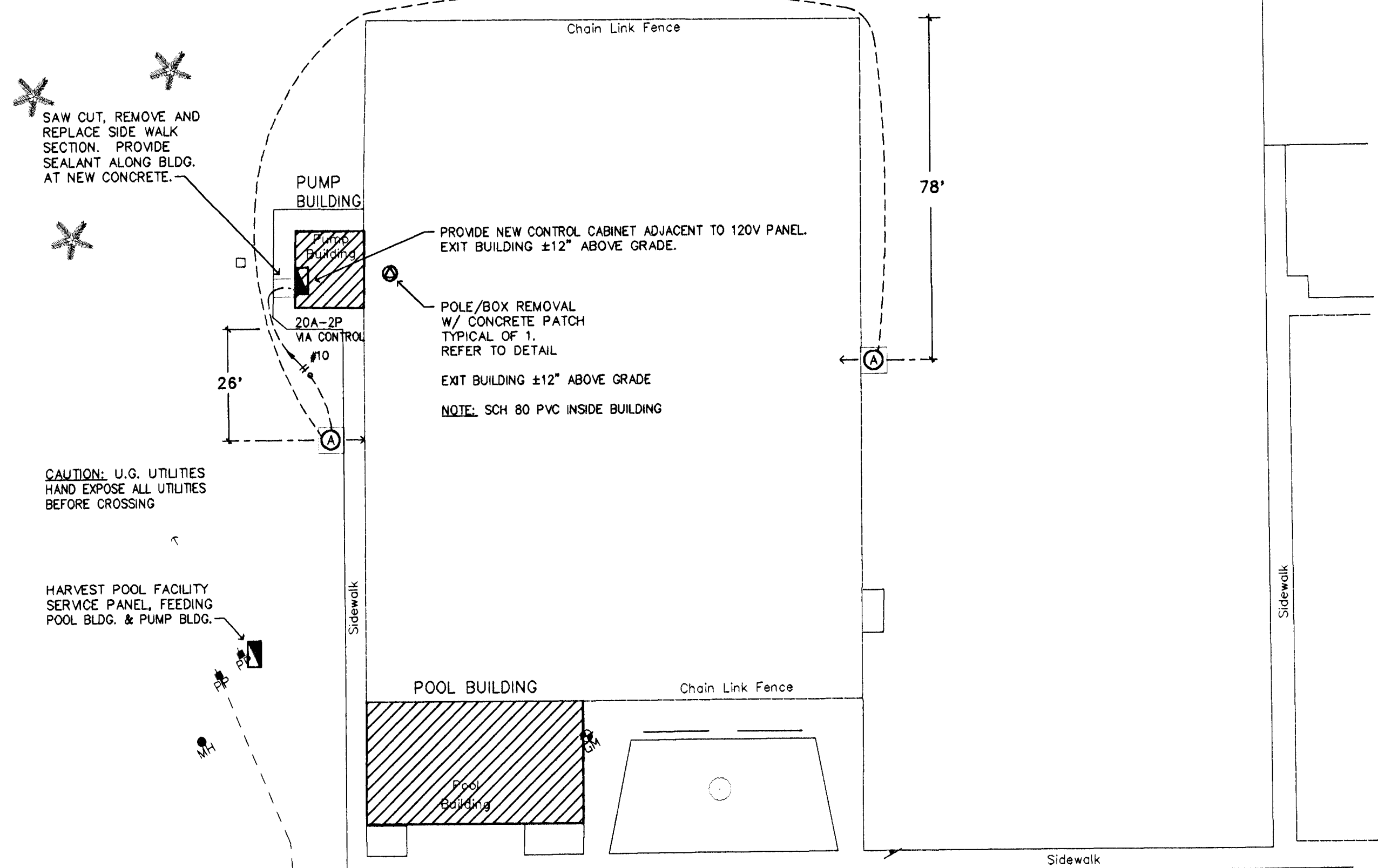

NOTE DO NOT INSTALL MATERIALS ON THIS JOB UNTIL YOU HAVE READ THE GENERAL NOTES ON E-1.

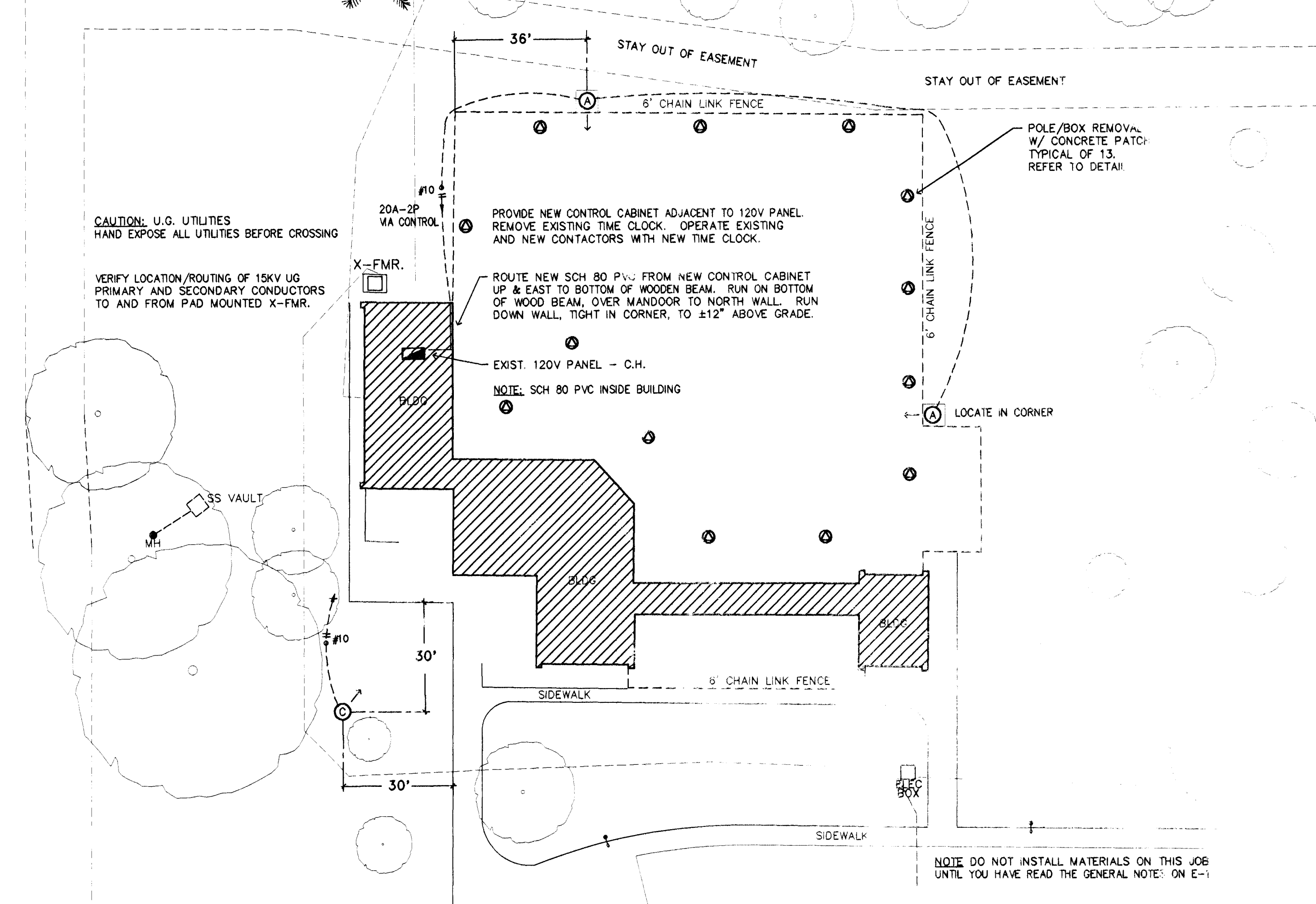

NOTE DO NOT INSTALL MATERIALS ON THIS JOB UNTIL YOU HAVE READ THE GENERAL NOTES ON E-1

**EVERGREEN POOL  
SITE LIGHTING PLAN**

SCALE: 0 20' 40' 60' 80' 100'

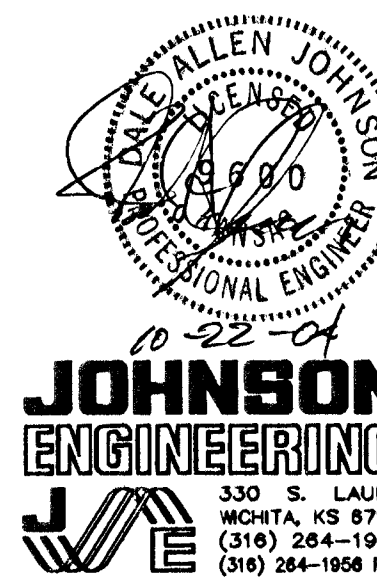
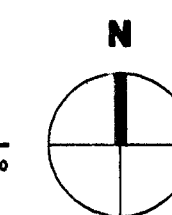

**JOHNSON ENGINEERING**  
330 S. LAURA  
WICHITA, KS 67211  
(316) 264-1953  
(316) 264-1956 FAX



518 S. Market,  
Wichita, KS 67202 316/264-0242

**CITY OF WICHITA  
NEW SITE LIGHTING  
WICHITA PUBLIC POOLS**

PROJECT NUMBER <b># 472 84002</b>			
J/E PRO. # #04042	FILE WP9-E4	DATE 10-22-04	SHEET <b>6</b>
DESIGN DAJ	DRAWN DAJ	REVISED	OF <b>7</b>

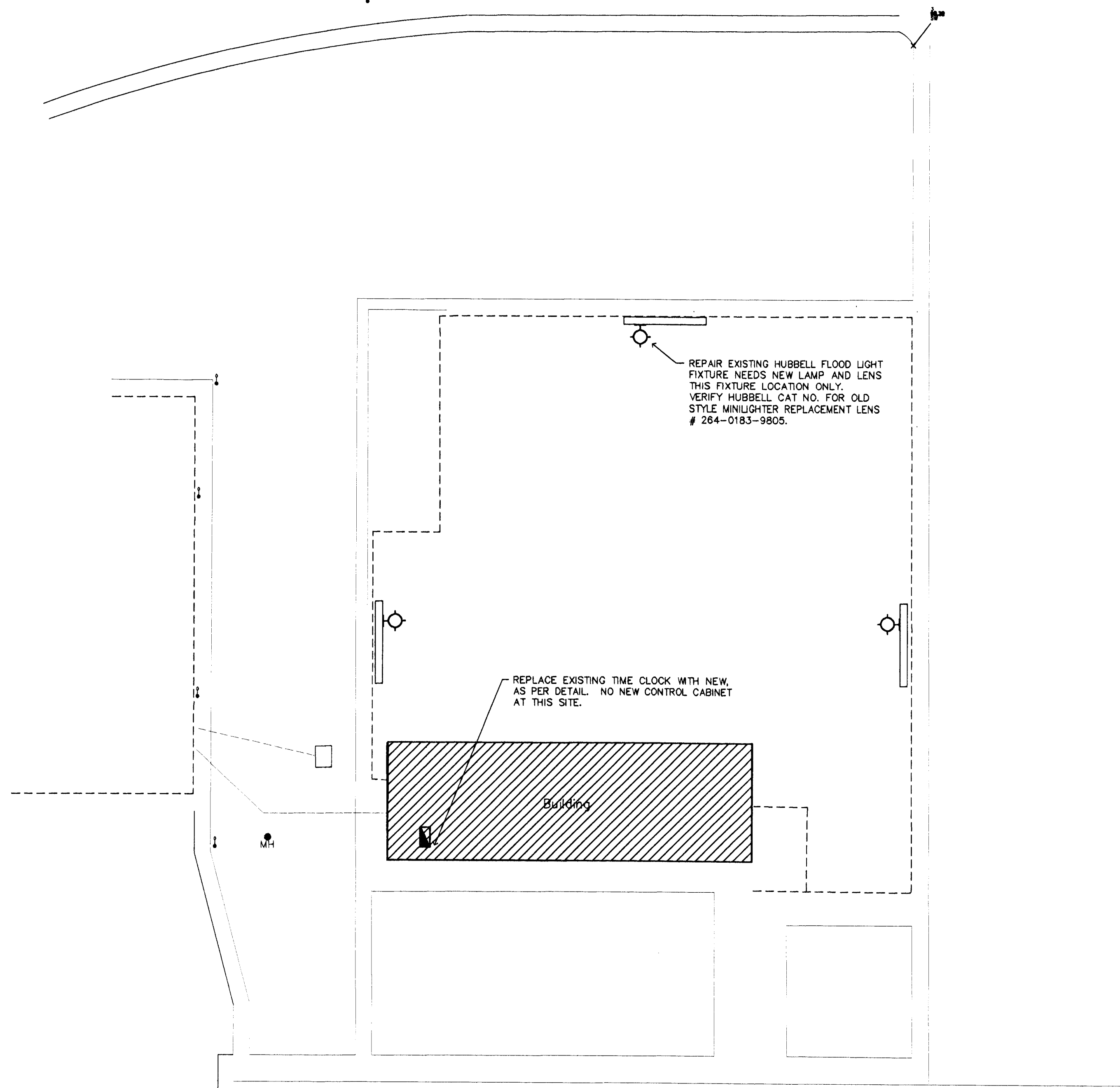

**McADAMS SWIMMING POOL  
SITE LIGHTING PLAN**  
SCALE:

WICHITA PUBLIC POOLS - LIGHT FIXTURE SCHEDULE					
GENERIC DESCRIPTION	MFG. & CATALOG NUMBER	VOLT	LAMPS	MOUNTING	
A ARCHITECTURAL POST TOP	SPAULDING # PFI-XL-SM-SF-M400PS-III-MT-DBZ-VERIFY STRIPE	208	1 - M400PS	POLE 2	
B					
C ARCHITECTURAL POST TOP	SPAULDING # PFI-XL-SM-SF-M400PS-III-MT-DBZ-VERIFY STRIPE	208	1 - M400PS	POLE 1	
D					
E					
F					
G					

- LIGHT FIXTURE NOTES:**  
 ALL SUBSTITUTIONS SHALL BE REVIEWED AT SHOP DRAWINGS FOR ACCEPTANCE OR REJECTION. ATTENTION SHALL BE GIVEN TO LAMPS, VOLTAGE, MOUNTING, PHYSICAL DIMENSIONS, FINISHES, PHOTOMETRICS, ETC.  
 CAUTION: IN "OPEN" METAL HALIDE FIXTURES, PROVIDE AND INSTALL PROPER SAFE LAMP.
- ALTERNATE FIXTURE MANUFACTURERS:  
 ALTERNATE MFG FOR TYPE "A"  
 TYPE "AM" MCGRAW-EDISON #GMC SERIES  
 ALTERNATE MFG FOR TYPE "C"  
 TYPE "CM" MCGRAW-EDISON #GMC SERIES
  - ALL HID FIXTURES SHALL BE "BURNED-IN" AS PER LAMP MANUFACTURER'S RECOMMENDATIONS TO INSURE PROPER LAMP LIFE.
  - EC SHALL FAMILIARIZE HIMSELF WITH CHARACTERISTICS OF THE FIXTURES BEING SPECIFIED AND SHALL BE RESPONSIBLE FOR COORDINATING ANY SPECIAL INSTALLATION REQUIREMENTS SUCH AS MOUNTING HEIGHTS, BACKBOXES, ETC. PRIOR TO ROUGH-IN.
  - EC SHALL PROVIDE MOUNTING TO ALLOW THE FIXTURE TO BE AIMED UP TO 60° ABOVE STRAIGHT DOWN.

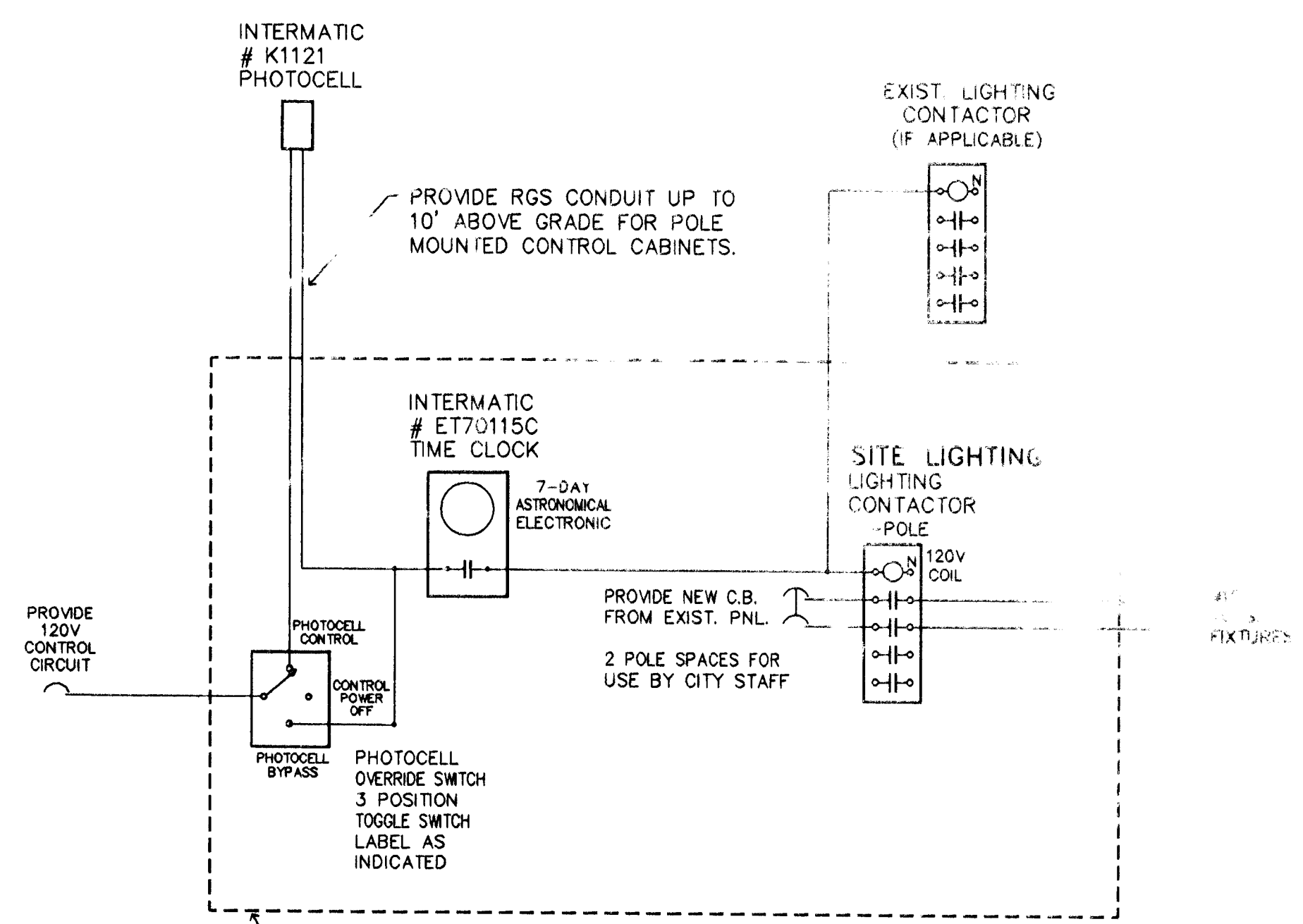

PROVIDE HINGED COVER ENCLOSURE, PROVIDE 2" CLEARANCE AROUND EACH CONTROL DEVICE. INTERIOR ENCLOSURES EQUAL TO HOFFMAN # RH-1614H-WPL2\* WITH WINDOWED DOOR. EXTERIOR ENCLOSURES EQUAL TO HOFFMAN # A16R126-HRC.\*\*PROVIDE ATTACHMENT HARDWARE. NEMA 4X FOR INDOOR CONTROL PANEL LOCATIONS, \*VERIFY SIZE FOR TO EACH SITE NEMA 12/3R FOR EXTERIOR CONTROL PANEL LOCATIONS, \*\*VERIFY SIZE FOR EACH SITE

**TYPICAL SITE LIGHTING CONTROL**

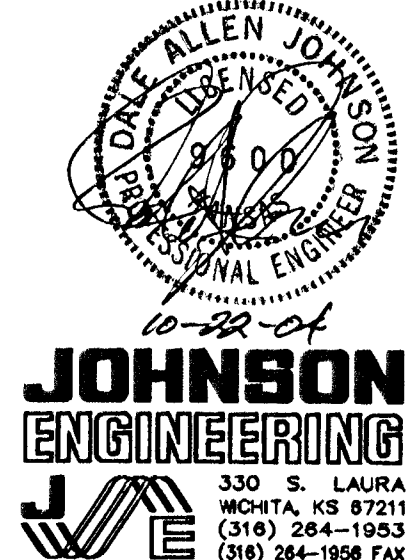

**CITY OF WICHITA  
NEW SITE LIGHTING  
WICHITA PUBLIC POOLS**

PROJECT NUMBER  
**# 472 84002**

J/E PRO. #	FILE	DATE	SHEET
#04042	WP9-E4	10-22-04	7
DESIGN	DRAWN	REVISED	OF
DAJ	DAJ		7

10-01-05-04

**JOHNSON ENGINEERING**  
 330 S. LAURA  
 WICHITA, KS 67211  
 (316) 284-1933  
 (316) 284-1938 FAX

**kemiller engineering**  
 518 S. Market,  
 Wichita, KS 67202  
 316/284-0222