

WATER VALVE BOX ELEVATIONS			
STREET	STATION	OFFSET	PROPOSED ELEVATION
LAKE RIDGE COURT	41+56.27	39.73' Lt.	151.3
LAKE RIDGE COURT	46+62.73	39.73' Lt.	150.4

SCALE: 1"=20'

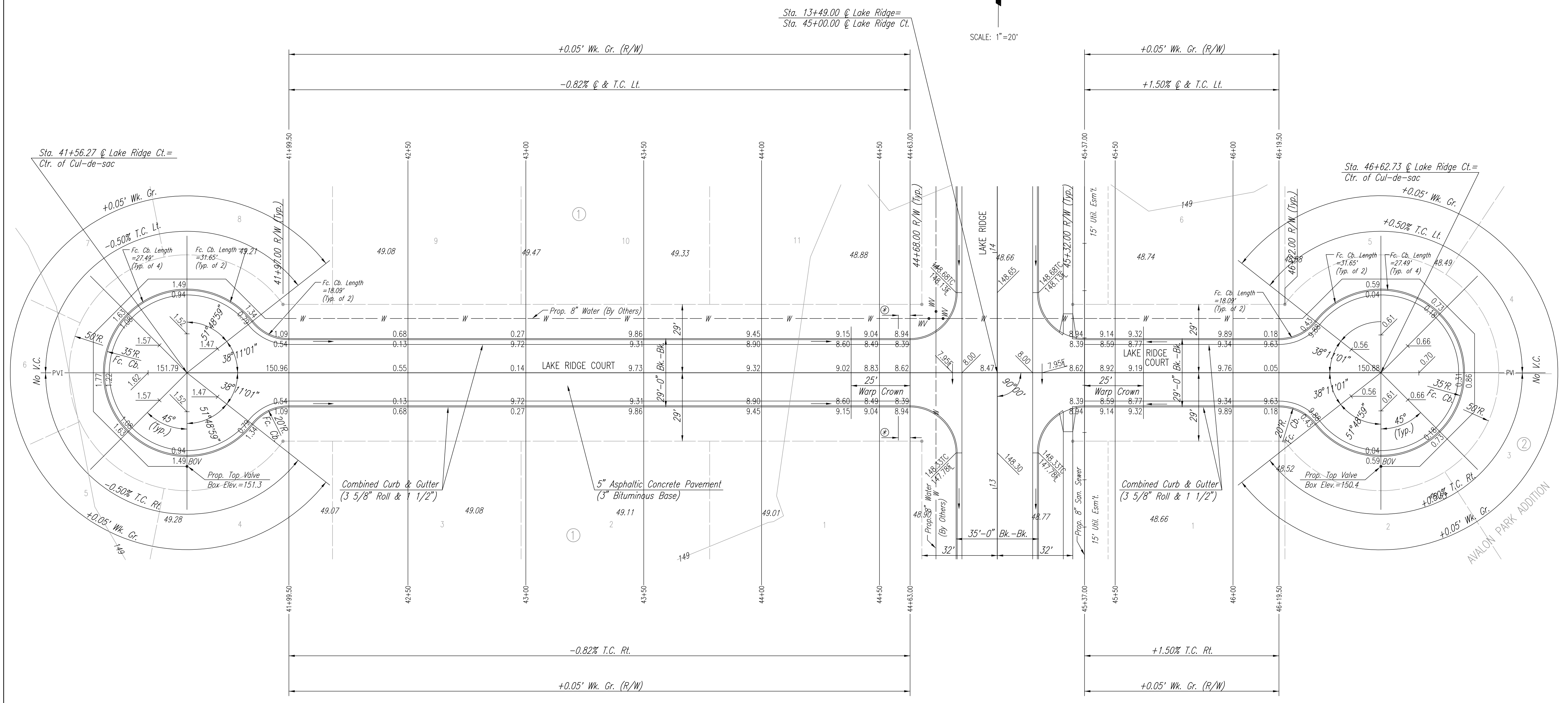
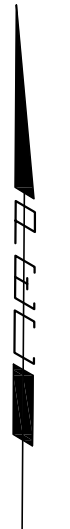

Sta. 13+49.00 @ Lake Ridge =  
Sta. 45+00.00 @ Lake Ridge Ct.

Sta. 41+56.27 @ Lake Ridge Ct. =  
Ctr. of Cul-de-sac

Sta. 46+62.73 @ Lake Ridge Ct. =  
Ctr. of Cul-de-sac

Ⓢ 5' TRANSITION FROM COMBINED CURB AND GUTTER (3 5/8" ROLL & 1 1/2") TO COMBINED CURB AND GUTTER (6 5/8" & 1 1/2"). TO BE BID AND PAID FOR AS "COMBINED CURB AND GUTTER (3 5/8" ROLL & 1 1/2)".

NOTE: THIS STREET TO BE CONSTRUCTED WITH ROLL-TYPE CURB. TOP OF CURB ELEVATIONS GIVEN ARE FOR FULL HEIGHT CURB.

DSNR: BDB OPER: BJS SCALE: 1"=20.00  
 Q:\2003\03345\000\STR41-47 02-10-2004 08:32:57 am

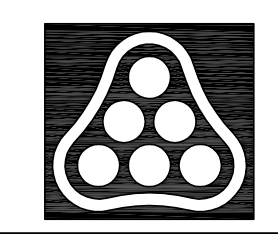

No.	Revision	By	Date
AVALON PARK-PHASE 1			
<b>LAKE RIDGE COURT</b>			
STA. 41+56.27 TO STA. 46+62.73			
JAMES L. ARMOUR, P.E.-ACTING CITY ENGINEER CITY OF WICHITA PROJECT NO. 472-83835			
<b>Professional Engineering Consultants, P.A.</b>			
303 S. TOPEKA • WICHITA, KANSAS 67202 316-262-2691 • FAX 316-262-3003			
Designed by	BDB	Job No.	35-03345
Drawn by	BJS	Date	JUNE 2002
			Sht. 8 of 43