

STATE	PROJECT NO.	YEAR	SHEET NO.	TOTAL SHEETS
KANSAS	54-87 K-8258-08	2005	10	223

DATE	
BY	
REFERENCE NOTED	
REFERENCE CHECKED	

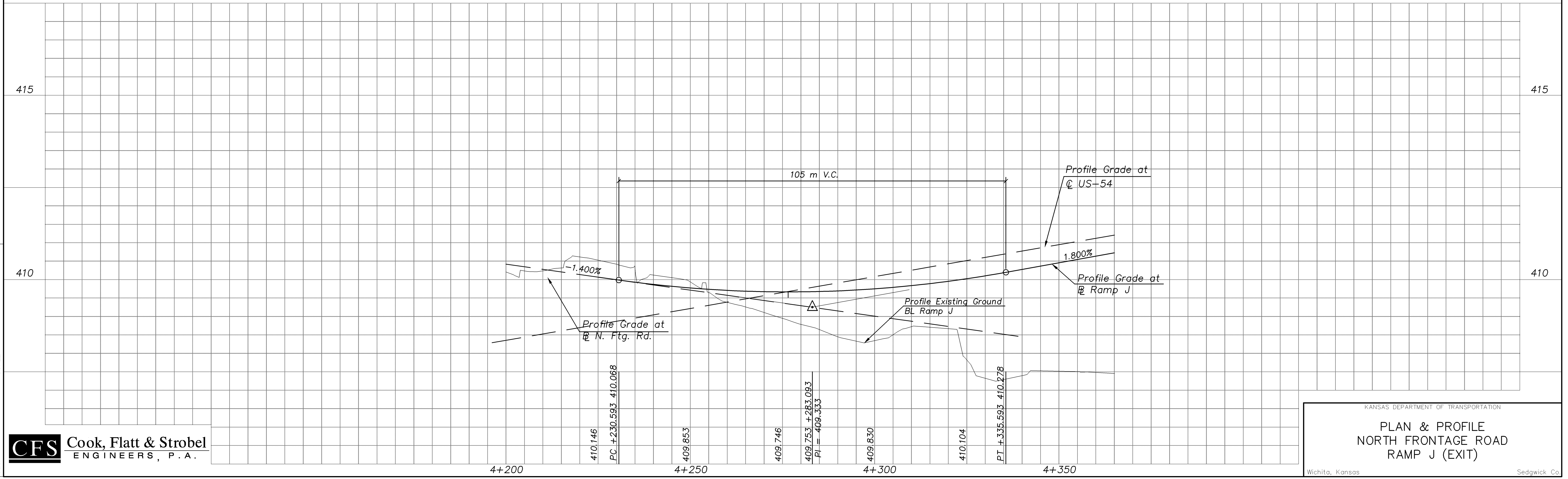
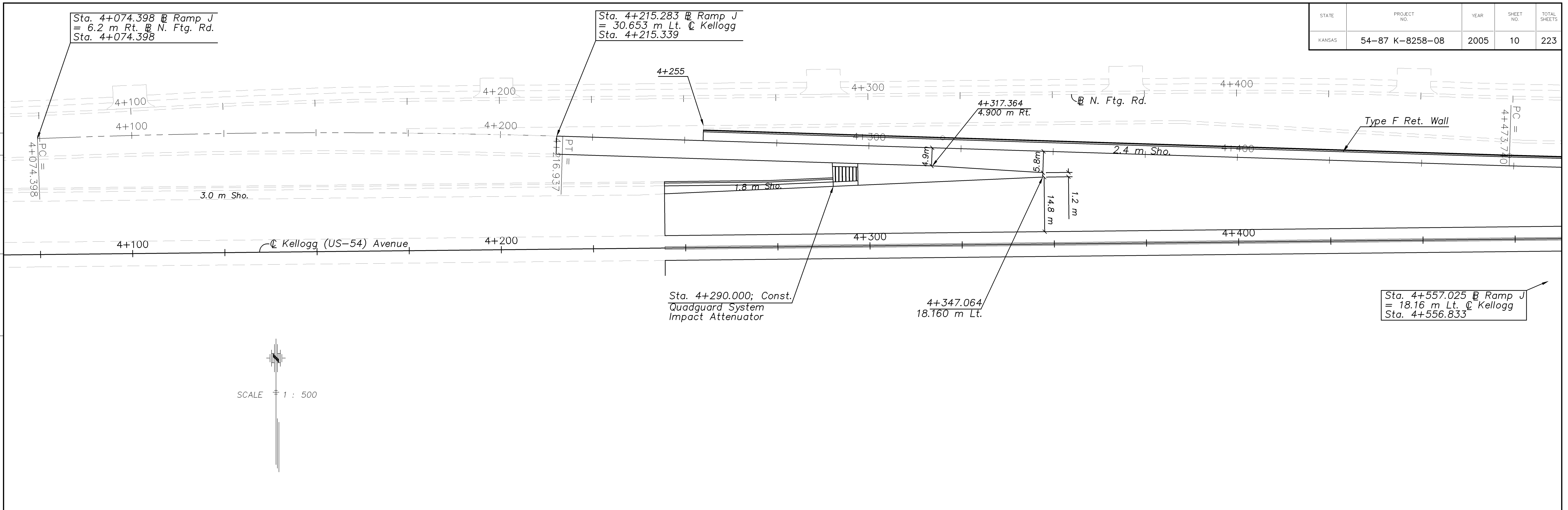

CFS Cook, Flatt & Strobel
ENGINEERS, P.A.

KANSAS DEPARTMENT OF TRANSPORTATION
PLAN & PROFILE
NORTH FRONTAGE ROAD
RAMP J (EXIT)
Wichita, Kansas Sedgwick Co.