

CURVE DATA - WEST END CENTERLINE TRANSITION							
Curve No.	P.I. Sta. (Bk.)	Delta (DMS)	Radius (m)	Tangent (m)	Length (m)	External (m)	Super
1	3+967.961	08°34'27" Lt.	1 000.000	74.964	149.649	2.806	N.C.
2	4+117.609	08°34'27" Rt.	1 000.000	74.964	149.648	2.806	"
EB1	3+948.711	06°19'51" Lt.	1 007.400	55.714	111.314	1.539	N.C.
EB2	4+087.268	06°19'51" Rt.	1 500.000	82.957	165.744	2.292	"
WB1	3+984.871	06°56'18" Lt.	1 400.000	84.8712	169.5349	2.5702	N.C.
WB2	4+154.855	06°56'18" Rt.	1 407.400	85.3198	170.4310	2.5838	"

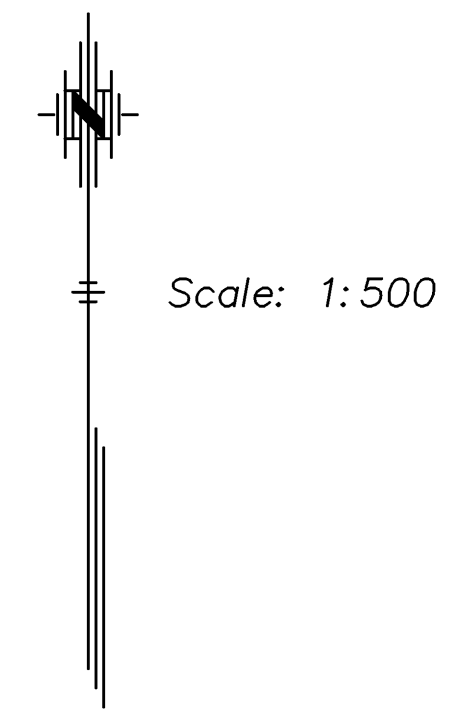

BY	DATE
REFERENCE NOTED	
REFERENCE CHECKED	

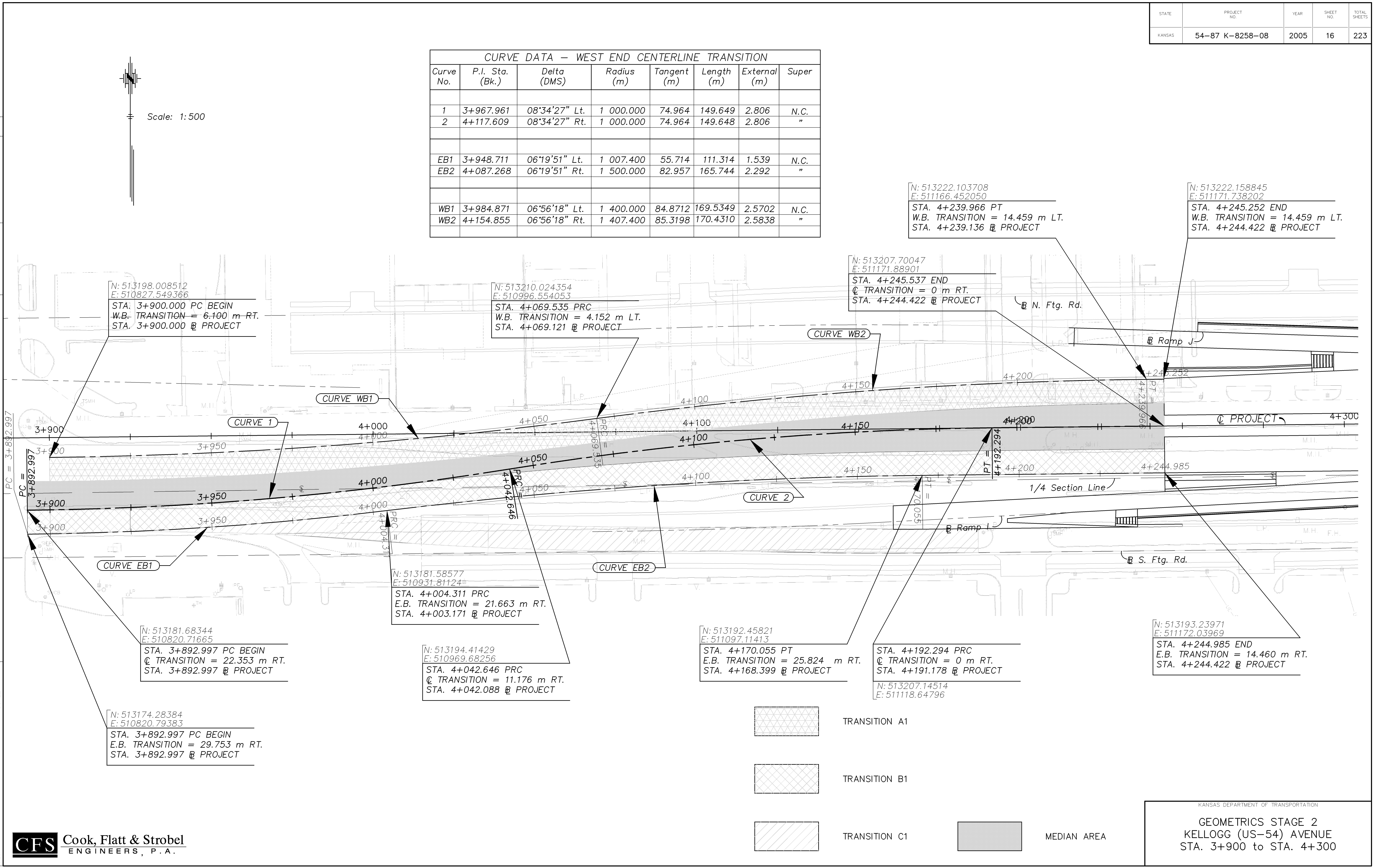

N: 513198.008512
E: 510827.549366
STA. 3+900.000 PC BEGIN
W.B. TRANSITION = 6.100 m RT.
STA. 3+900.000 @ PROJECT

N: 513210.024354
E: 510996.554053
STA. 4+069.535 PRC
W.B. TRANSITION = 4.152 m LT.
STA. 4+069.121 @ PROJECT

N: 513207.70047
E: 511171.88901
STA. 4+245.537 END
C TRANSITION = 0 m RT.
STA. 4+244.422 @ PROJECT

N: 513222.158845
E: 511171.738202
STA. 4+245.252 END
W.B. TRANSITION = 14.459 m LT.
STA. 4+244.422 @ PROJECT

N: 513181.68344
E: 510820.71665
STA. 3+892.997 PC BEGIN
C TRANSITION = 22.353 m RT.
STA. 3+892.997 @ PROJECT

N: 513181.58577
E: 510931.81124
STA. 4+004.311 PRC
E.B. TRANSITION = 21.663 m RT.
STA. 4+003.171 @ PROJECT

N: 513192.45821
E: 511097.11413
STA. 4+170.055 PT
E.B. TRANSITION = 25.824 m RT.
STA. 4+168.399 @ PROJECT

N: 513207.14514
E: 511118.64796
STA. 4+192.294 PRC
C TRANSITION = 0 m RT.
STA. 4+191.178 @ PROJECT

N: 513193.23971
E: 511172.03969
STA. 4+244.985 END
E.B. TRANSITION = 14.460 m RT.
STA. 4+244.422 @ PROJECT

N: 513174.28384
E: 510820.79383
STA. 3+892.997 PC BEGIN
E.B. TRANSITION = 29.753 m RT.
STA. 3+892.997 @ PROJECT

N: 513194.41429
E: 510969.68256
STA. 4+042.646 PRC
C TRANSITION = 11.176 m RT.
STA. 4+042.088 @ PROJECT

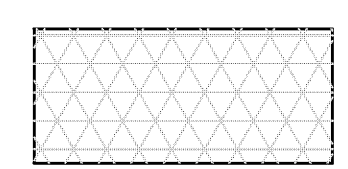

TRANSITION A1

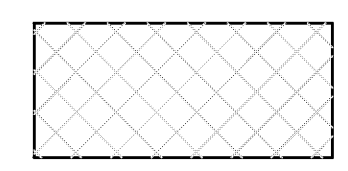

TRANSITION B1

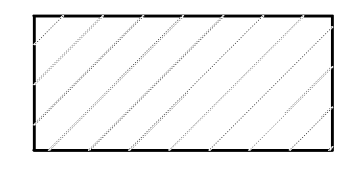

TRANSITION C1

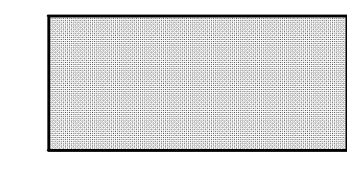

MEDIAN AREA

KANSAS DEPARTMENT OF TRANSPORTATION
GEOMETRICS STAGE 2
KELLOGG (US-54) AVENUE
STA. 3+900 to STA. 4+300