

PROJECT NO.	SHEET NO.	TOTAL SHEETS
468-83473	4	60

CP 4035 POT @ Sta. 47+14.54
 Set PK Nail at Point
 N 1691169.7990 E 1650641.0852
 1. @ 9th Street
 2. @ Santa Fe
 3. Chiseled "□" on Top of Concrete Light Base
 4. NW Corner of Concrete Sign Base
 5. NW Corner Parking Garage

E-W
 228.07' E
 29.00' N
 44.89' SE
 94.58' WSW

CP 4034 POT @ Sta. 48+69.04
 Set PK Nail at Point
 N 1691173.5759 E 1650795.5435
 1. @ 9th Street
 2. @ Santa Fe
 3. SW Corner of Curb Inlet
 4. Center of Manhole Lid
 5. SW Corner of 8" Concrete Retaining Wall

E-W
 71.57' E
 34.80' SE
 29.20' ESE
 58.33' N

CP 108 POT @ Sta. 49+42.61
 Set BDA Nail at Point
 N 1691173.0791 E 1650869.0936
 1. @ Intersection 9th St. & Santa Fe
 2. No other Ties

CP 4036 POT @ Sta. 53+80.81
 Set PK Nail at Point
 N 1691191.2575 E 1651307.0696
 1. @ 9th Street
 2. @ Mead Ave
 3. 1/2" Pipe at Back of Sidewalk
 4. @ of West Roll of Track
 5. SE Corner of Brick Building

E-W
 438.28' W
 30.00' N
 26.50' E
 33.93' NW

CP 3800 Found 1/2" Iron Pipe in Thimble at Point
 N 1691203.6614 E 1651995.2961
 1. @ 9th Street
 2. West R/W of Washington Ave.
 3. No other Ties

E-W
 N-S

DATE	
BY	

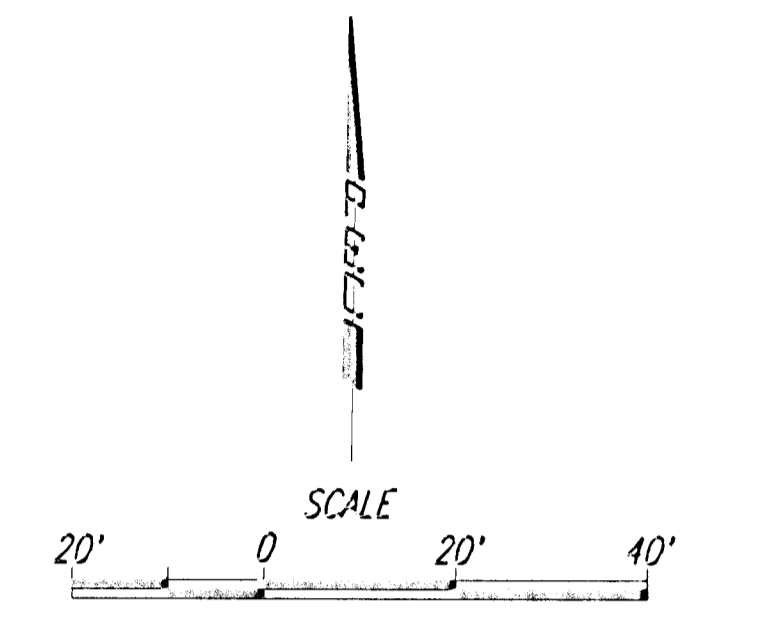
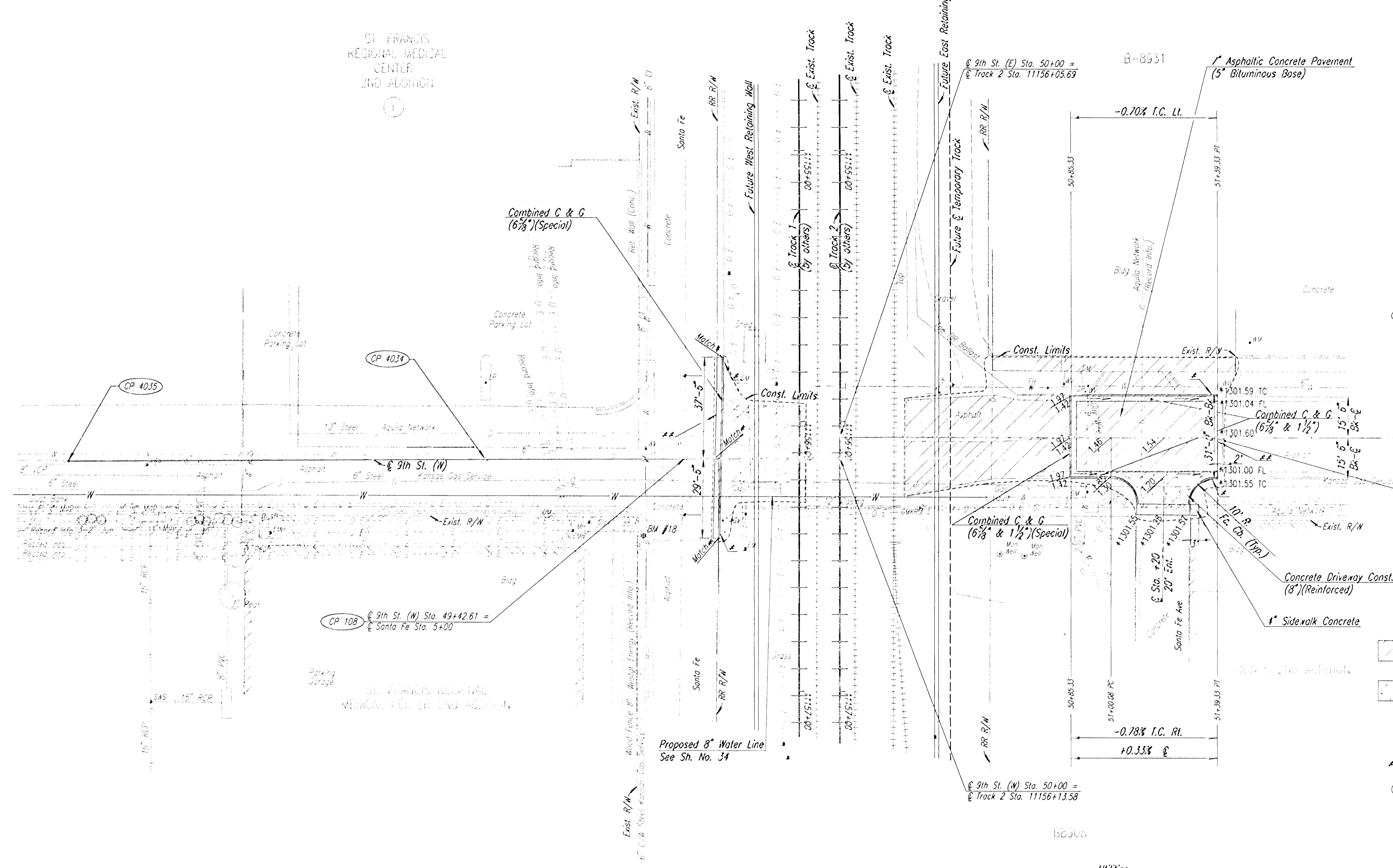

Sawcut, Remove and Replace Surface Course as necessary to provide a neat line. This work to be subsidiary to Asphalt Pavement.

- Legend**
- * Match Existing
 - ▨ Pavement Removal. The Bid Item "Pavement Removal" shall include the Removal of all Indicated Asphalt, Concrete, and Brick Pavements and Curb & Gutter.
 - ▨ 8" Reinforced Concrete Pavement
 - * 5' Transition from Combined Curb & Gutter (6 3/8") to Existing Curb & Gutter. To be bid and paid for as "Combined Curb & Gutter (6 3/8" & 1 1/2)".
 - Saw Cut Line
 - ⊙ 4' Transition from Curb to No Curb
 - ⊗ To be Relocated by others

3				
2				
1				
NO.	DATE	REVISIONS	BY	APP'D
CITY OF WICHITA				
WICHITA CENTRAL CORRIDOR				
9th Street				
DESIGNED	SCALE	1"=20'	APP'D	
DESIGN CK.	RAW	DETAILED	SVB	QUANTITIES
		DETAL CK.	QUANCK.	THALE CK.

- Utilities**
- Water City of Wichita
 - Storm Sewer City of Wichita
 - Sanitary Sewer City of Wichita
 - Telephone Southwestern Bell Telephone
 - Gas Aquila Network
 - Electric Kansas Gas Service
 - TV Westor Energy
 - Cox Communications

This sheet designed by:



BM #18 - Chiseled "□" on Northeast Corner of Concrete Sign Base, Southwest Corner of Intersection of Santa Fe & 9th Street Elevation=1304.60

BM #17 - Chiseled "□" on Top of East Curb on Santa Fe, @ of East Entrance to St. Francis Medical Center, Just South of Parking Garage Elevation=1302.81

DSNR: DSB OPER: SVB SCALE: 1"=20' 10-16-2000 15:12:18 LAST REV: 4-28-03 BY: drp