

PROJECT NO.	SHEET NO.	TOTAL SHEETS
468-83473	5	60

**CP 4321** Found 3/4" Iron Pin at Point  
 N 1691849.3205 E 1650099.0008  
 1. North R/W of 10th Street  
 2. West R/W of Emporia Avenue  
 3. No other Ties

**CP 4320** POT Sta. 45+98.03  
 Set PK Nail at Point  
 N 1691836.4632 E 1650512.1186  
 1. Intersection of @ 10th Street & @ St. Francis Avenue  
 2. in Asphalt Island  
 3. No other Ties

**CP 4319** PI Sta. 47+88.95 Deflection Angle = 0°23'51" Rt.  
 Set Chiseled "□" on Top of Curb at Point  
 N 1691839.7998 E 1650703.0080  
 1. @ 10th Street  
 2. West Side of Alley between St. Francis & Santa Fe Avenues  
 3. Back of Island Curb  
 4. Back of Island Curb  
 5. Back of Island Curb

**CP 4318** PI Sta. 52+32.07 Deflection Angle = 0°57'54" Lt.  
 Set PK Nail at Point  
 N 1691844.3380 E 1651146.1073  
 1. @ 10th Street  
 2. @ Alley West of Wood Ave.  
 3. Corner of Brick Building  
 4. NW Corner of Brick Security Building  
 5. NE Corner of Brick Fence Column

**CP 4317** POT Sta. 58+02.42  
 Found 1/2" Iron Pin in Thimble at Point  
 N 1691859.8342 E 1651716.2488  
 1. @ 10th Street  
 2. East R/W of Mosley Ave.  
 3. No other Ties

DATE	
BY	

BURLEIGH'S ADDITION

ARNOLD & CLARK'S ADDITION

DEPOT ADDITION

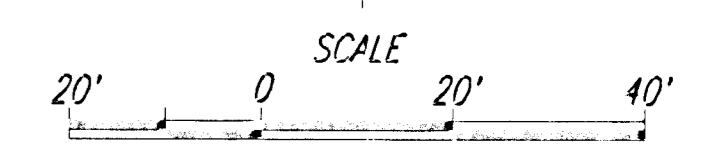
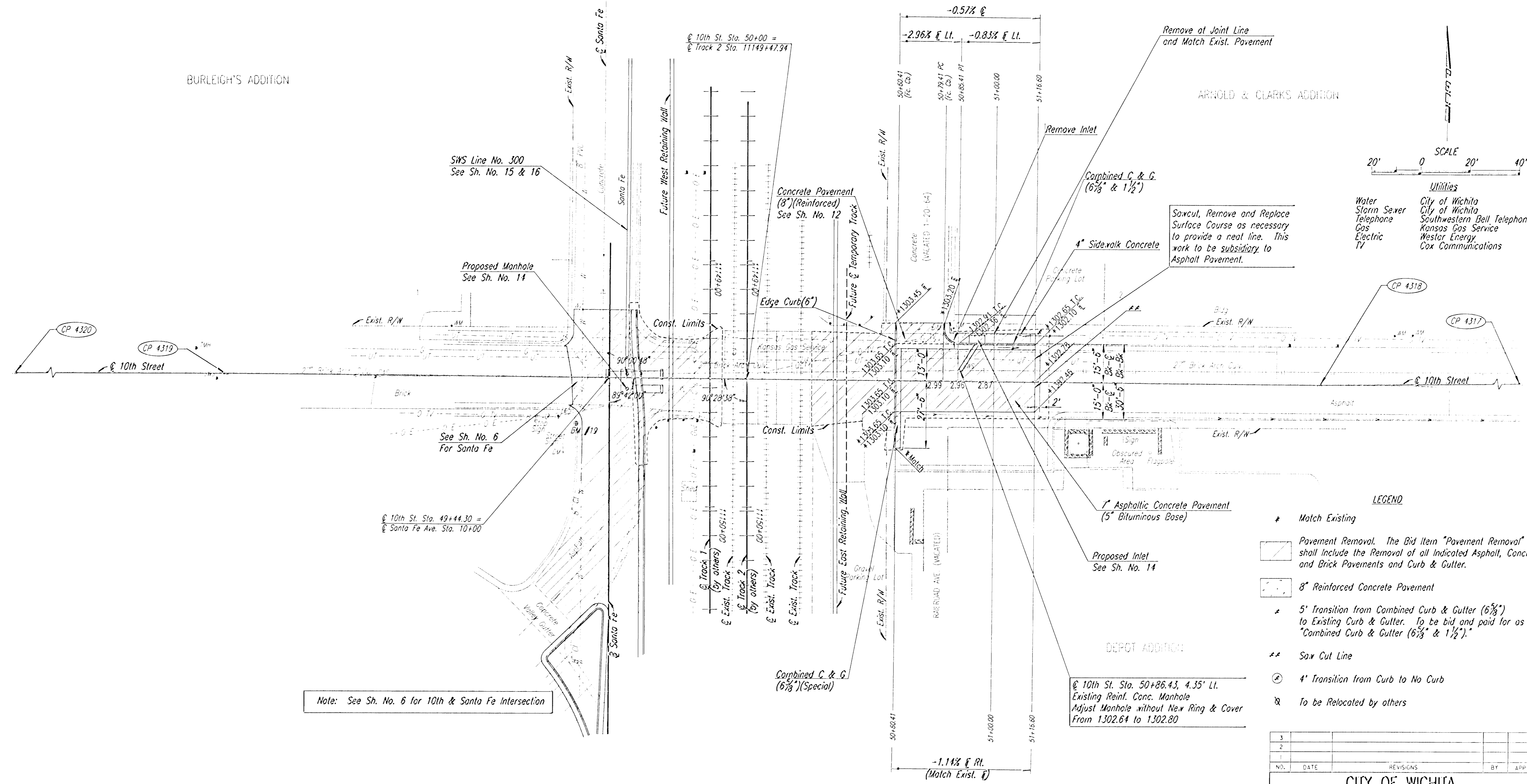

- Utilities**
- Water
  - Storm Sewer
  - Telephone
  - Gas
  - Electric
  - TV
- City of Wichita  
 City of Wichita  
 Southwestern Bell Telephone  
 Kansas Gas Service  
 Westar Energy  
 Cox Communications

**LEGEND**

- \* Match Existing
- Pavement Removal. The Bid Item "Pavement Removal" shall include the Removal of all Indicated Asphalt, Concrete, and Brick Pavements and Curb & Gutter.
- 8" Reinforced Concrete Pavement
- \* 5' Transition from Combined Curb & Gutter (6 5/8") to Existing Curb & Gutter. To be bid and paid for as "Combined Curb & Gutter (6 5/8" & 1 1/2)".
- \*\* Saw Cut Line
- 4' Transition from Curb to No Curb
- To be Relocated by others

Note: See Sh. No. 6 for 10th & Santa Fe Intersection

Proposed Inlet  
 See Sh. No. 14

BM #19 - Chiseled "□" on Top of Curb, South Curb Return, Southwest Corner of Intersection of Santa Fe Avenue & 10th Street  
 Elevation=1302.83

This sheet designed by:



DSNR: RWM OPER: SVB SCALE: 1"=20' APPD: 10/1999/99189/Bidset2/PLAN\_10TH.DGN 10-13-2000 16:41:02 LAST REV: 4-28-03 BY: drp

CITY OF WICHITA				
WICHITA CENTRAL CORRIDOR				
10th Street				
NO.	DATE	REVISIONS	BY	APPD
3				
2				
1				

DESIGNED	RWM	SCALE	1" = 20'	APPD	
DETAIL	SVB	QUANTITIES		TRACE	
DESIGN	DRP	QUANCK		TRACE	