

UTILITIES SHOWN REPRESENT THE BEST INFORMATION AVAILABLE FOR DESIGN. ADDITIONAL UTILITIES MAY BE PRESENT ON THIS PROJECT. THE CONTRACTOR SHALL BE RESPONSIBLE FOR DETERMINING THE EXACT LOCATION, DEPTH AND SIZE OF ALL UNDERGROUND UTILITIES PRIOR TO CONSTRUCTION. THE CONTRACTOR SHALL BE LIABLE FOR ANY DAMAGE CAUSED BY THE FAILURE TO DO SO.

SURVEY DISCLAIMER:
 TOPOGRAPHIC SURVEY AND CONTOUR MAP USED IN PREPARING PLANS WAS PROVIDED BY BAUGHMAN COMPANY P.A., 315 ELLIS, WICHITA, KS (316)262-7271. ENGINEER DOES NOT GUARANTEE SURVEY ELEVATIONS FOR ACCURACY. CONTRACTOR SHALL VERIFY ELEVATIONS AND NOTIFY ENGINEER OF ANY DISCREPANCIES.

ON SITE BENCHMARK #1: BM#1
 Top of Rim - Sanitary Sewer Manhole along Ohio Street. N 3991.30 4387.90 Elev.=132.87 (Per Survey)
ON SITE BENCHMARK #2: BM#2
 Top of Rim - Sanitary Sewer Manhole along Ohio Street. N 3668.53 E 4390.53 Elev.=131.88 (Per Survey)

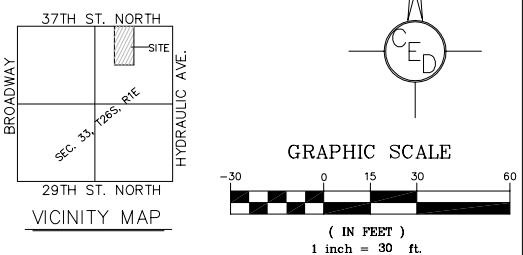

SURVEY CONTROL MONUMENTS	
CM #1	N 4950.00 E 5000.46 W 1/2, NE 1/4, Sec. 33, T-26-S, R-1-E
CM #2	N 4195.94 E 5007.51 NE Cor. Lot 1, Block 2 Bridgeport 3rd Industrial
CM #3	N 4198.55 E 4380.89 NW Cor. Lot 1, Block 2 Bridgeport 3rd Industrial
CM #4	N 3678.57 E 4385.42 SW Cor. Lot 1, Block 2 Bridgeport 3rd Industrial
CM #5	N 3675.96 E 5012.38 SE Cor. Lot 1, Block 2 Bridgeport 3rd Industrial

CONSTRUCTION CONTROL POINTS	
CP #1	N 4161.40 E 4518.00 NE Corner of Proposed Parking Lot
CP #2	N 4160.25 E 4386.04 NW Corner of Proposed Parking Lot
CP #3	N 3716.60 E 4416.10 SW Corner of Proposed Parking Lot
CP #4	N 3717.42 E 4521.86 SE Corner of Proposed Parking Lot

- LEGEND**
- = #4 REBAR W/ "BAUGHMAN" CAP (FOUND)
 - = #4 REBAR W/ "BAUGHMAN" CAP (SET)
 - △ = 1 1/4" IRON PIPE (FOUND)
 - △ = 1/2" IRON PIPE IN THIMBLE (FOUND)
 - (M) = MEASURED
 - (P) = PLATTED
 - CB = Catch Basin
 - o-FH = Fire Hydrant
 - ← Guy = Guy Anchor
 - FOM = Fiber Optic Marker
 - PP = Power Pole
 - SSMH = Sanitary Sewer Manhole
 - SWSMH = Stormwater Sewer Manhole
 - = 18"x24" Area Inlet for Soccer Field (by others)
 - = Existing Spot Elevation
 - = Proposed Spot Elevation for Soccer Field (by others)
 - = Existing Tree
 - = Gas Line
 - = Electric Line
 - = Sanitary Sewer Line
 - = Stormwater Sewer Line
 - = Telephone Line
 - = Water Line
 - - - - - = Existing Contour
 - - - - - = Proposed Contour for Soccer Field (by others)
 - - - - - = Proposed Contour (Parking Lot)
 - - - - - = 12" SDR 35 Pipe

- DRAINAGE LEGEND**
- = TOP OF CURB ELEVATION
 - = FLOWLINE OF CURB ELEVATION
 - = TOP OF RIM ELEVATION (INLET)
 - = TOP OF RIM ELEVATION (INLET)
 - = TOP OF SIDEWALK ELEVATION
 - = TOP OF PAVEMENT ELEVATION
 - = DIRT GRADE ELEVATION
 - = FLOW GRADE Revised by City of Wichita 8/14/03

SITE GRADING PLAN FOR
37TH & OHIO PARKING LOT
 WICHITA, SEDGWICK CO., KANSAS
 PROJ. NO.: 20031014
CERTIFIED ENGINEERING DESIGN, P.A.
 810 WEST DOUGLAS, SUITE C
 WICHITA, KANSAS 67203
 PH.(316)262-8808 FAX.(316)262-1669

DESIGNED: HDF SCALE: 1"=30' SHEET: 4
 DRAWN: DPJ DATE: 4/03
 CHECKED: HDF CED FILE: 37TH&OHIO_BASE TOTAL: 11

CAUTION!!!
Existing Sanitary Sewer Line

CAUTION!!!
Existing Ovhd. Electric Line

Construct 2x4 Area Inlet
See Site Plan for Location
Install 55 l.f. @ 0.4% of 15"
RCP from existing Catch Basin to Area Inlet
TR = 132.00
15" FL Out = 128.52
15" FL In = 128.30
See Sheet 5 for Inlet Details

CAUTION!!!
Existing Sanitary Sewer Line

Construct 2x4 Area Inlet
See Site Plan for Location
Install 55 l.f. @ 0.4% of 15"
RCP from existing Catch Basin to Area Inlet
TR = 131.15
15" FL Out = 127.78
15" FL In = 127.56
See Sheet 5 for Inlet Details

PROPOSED SOCCER FIELD
 Site Layout and Grading by Others

Bridgeport 3rd Industrial
 Part of Lot 1, Block 2
 Zoned "G1"
 (General Industrial)

SITE GRADING PLAN