

K:\ELEC\2005\COW Parks\MCADAMS\ELEC\05619M1-2.dwg, 4/11/2006 2:58:25 PM, 1:2.16998

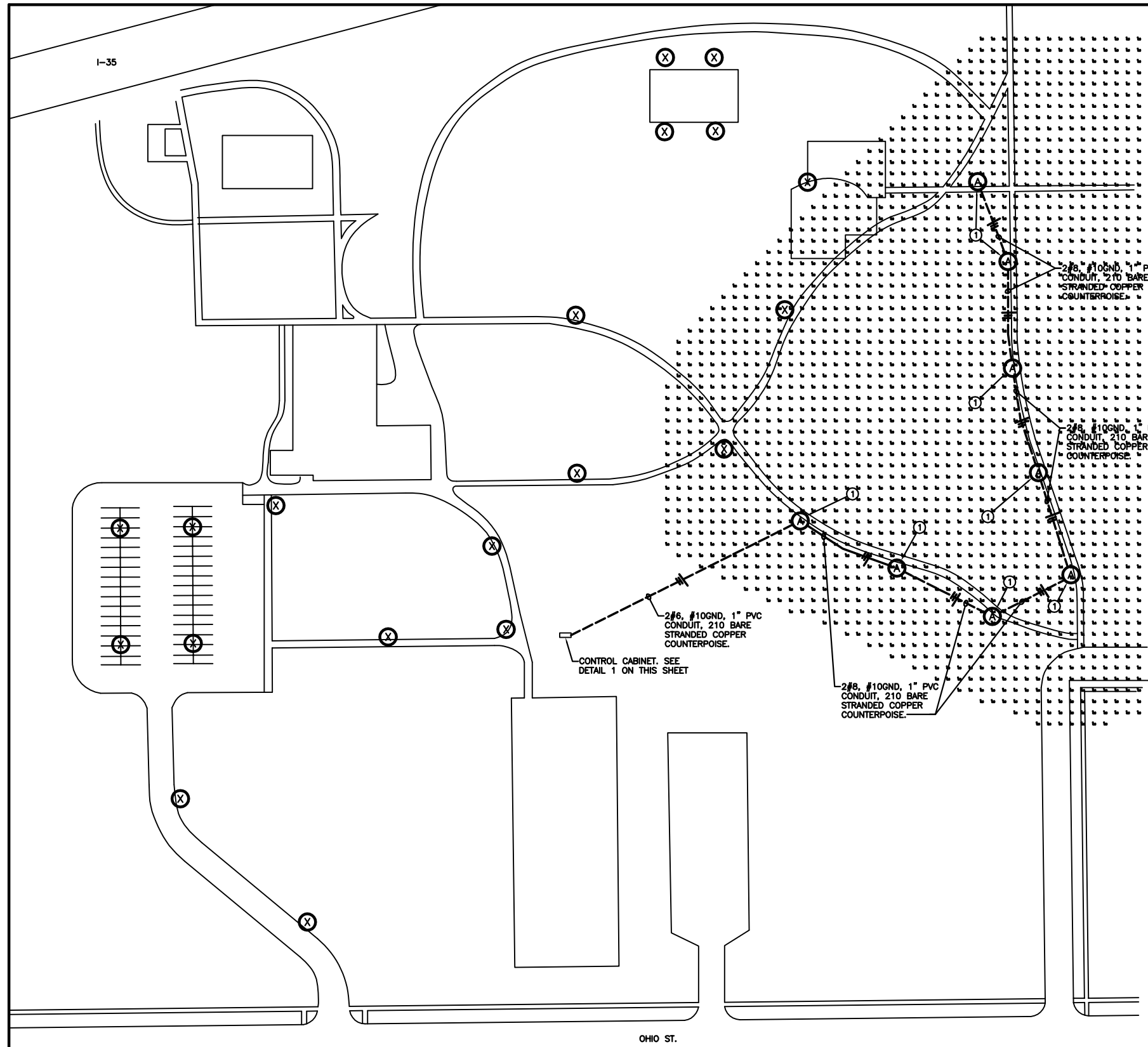

**1** **SITE RECONSTRUCTION PLAN**  
 SCALE: 1"=50'-0"  
 SCALE: 1"=50'

- SITE ELECTRICAL NOTES:**
1. CONTRACTOR IS RESPONSIBLE FOR COORDINATING ALL UTILITY SERVICES. FAILURE TO DO SO WILL NOT RESULT IN ANY EXTRA FINANCIAL COMPENSATION FROM THE OWNER. CONTRACTOR SHALL HAVE ALL UTILITY SERVICE REQUIRED EXPENSES IN THE BASE BID.
  2. MIN. CONDUCTOR SIZE #10. MIN CONDUIT SIZE 1"
  3. THE CONTRACTOR SHALL COORDINATE POLE BASE INSTALLATION WITH ALL UTILITIES IN THE AREA. COORDINATE TRENCHING WITH PARK DEPARTMENT.
  4. CUTTING OF PAVEMENT OR CONCRETE IS NOT ALLOWED. DIRECTIONAL BORE AS REQUIRED. REQUIRED BORING SHALL BE SUBSIDIARY TO TRENCHING.
  5. EXISTING TREES ARE AN IMPORTANT ASSET TO THIS PARK. CONTRACTOR SHALL NOT TRENCH UNDER TREE DRILINES. COORDINATE CONFLICTS W/ PARK DEPARTMENT.
  6. REMOVE FIXTURES & PREPARE FOR TRANSPORT BY CITY OF WICHITA PARK DEPT. CONTACT: JOAQUIN ESPINOZA AT 316-268-4122

**KEYED NOTES:**

① SEE DETAIL 2 ON SHEET G2 FOR POLE BASE INSTALLATION REQUIREMENTS.

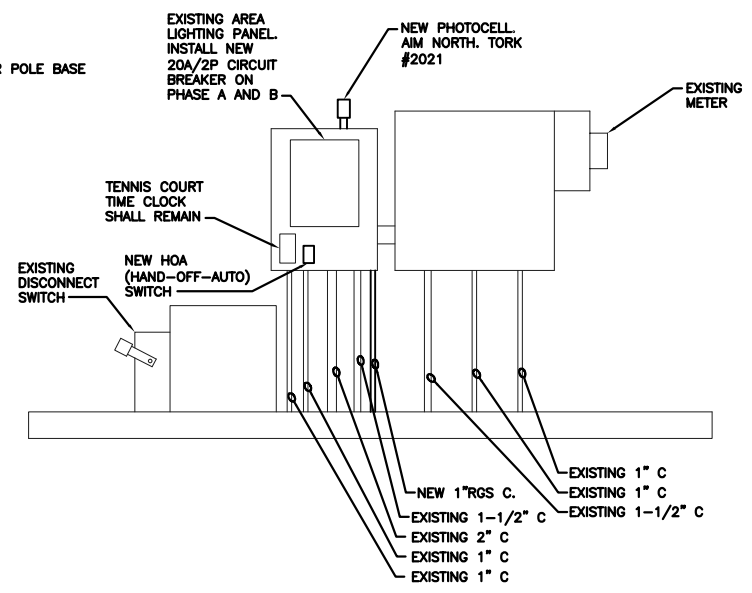

NOTE: BOND 210 BARE STRANDED CU COUNTERPOISE TO SERVICE GROUND ROD.

**1** **CONTROL CABINET RECONSTRUCTION ELEVATION**

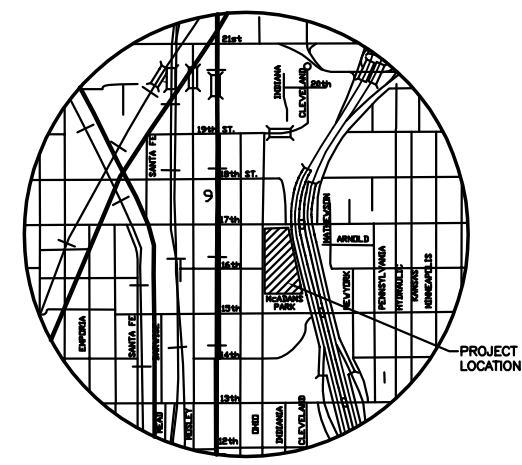

**LOCATION MAP**  
**McADAMS PARK**



**MKEC**  
 ENGINEERING CONSULTANTS  
 411 N. WEBB ROAD  
 WICHITA, KS. 67206  
 316 - 684 - 9600

**CITY OF WICHITA**  
**PARK McADAMS LIGHTING**  
 PROJECT NAME  
**McADAMS PARK**  
**AREA LIGHTING RECONSTRUCTION**  
 SHEET TITLE

DESIGN BY: <b>JAF</b>	DRAWN BY: <b>ADG</b>	CHECKED BY: <b>BWB</b>
DATE: <b>APRIL 11, 2006</b>	JOB NO.: <b>05619</b>	SHEET/OF: <b>M12/5</b>