

STATE OF KANSAS
DEPARTMENT OF TRANSPORTATION

STATE	PROJECT NO.	YEAR	SHEET NO.	TOTAL SHEETS
KANSAS	87 N-0353-01	2005	1	162

STP-N035(301)



PLAN AND PROFILE OF PROPOSED
PAWNEE AVENUE
119TH TO MAIZE

FEDERAL AID PROJECT
SEDGWICK COUNTY

CITY OF WICHITA
POPULATION 354,617

CITY OF WICHITA PROJECT NO. 472 84357

OCA NO. 708951

R 2 W
R 1 W

PROJECT NO. 87 N-0353-01
F.A. NO. STP-N035(301)

GRADING
SURFACING
TRAFFIC SIGNALIZATION
SIGNING AND PAVEMENT MARKINGS

INDEX OF SHEETS

- 1 TITLE SHEET
- 2-3 TYPICAL SECTIONS & GENERAL NOTES
- 4-24 PLAN SHEETS
- 25-33 INTERSECTION DETAILS
- 34-36 PAVEMENT DETAILS
- 37 MISCELLANEOUS DETAILS
- 38-52 INLET & MANHOLE DETAILS
- 53-65 STORM SEWER PLAN & PROFILE
- 66 SCHEDULE OF INLETS AND MANHOLES
- 67-68 CONCRETE END SECTIONS
- 69 DRAINAGE CALCULATIONS
- 70-71 CULVERT DETAILS
- 72-80 RCB DETAILS
- 81 SUMMARY OF QUANTITIES
- 82-87 EROSION CONTROL
- 88-89 TRAFFIC SIGNALS
- 90-98 PAVEMENT MARKING & SIGNING
- 99 CONSTRUCTION SEQUENCE
- 100-117 TRAFFIC CONTROL
- 118 DRAINAGE MAP
- 119-158 CROSS SECTIONS
- 159-162 WATERLINE PLANS
- LS1-LS14 LANDSCAPING PLANS

BY	DATE
SURVEY	
CADD TECHNICIAN	
DESIGNERS	
SQUAD	

STA. 5+63.26, BEGIN CONSTRUCTION
PROJ. 87 N-0353-01

STA. 10+71.44, BEGIN PROJECT
PROJ. 87 N-0353-01

STA. 54+55.22, END CONSTRUCTION
PROJ. 87 N-0353-01

STA. 54+27.97, END CONSTRUCTION
PROJ. 87 N-0353-01

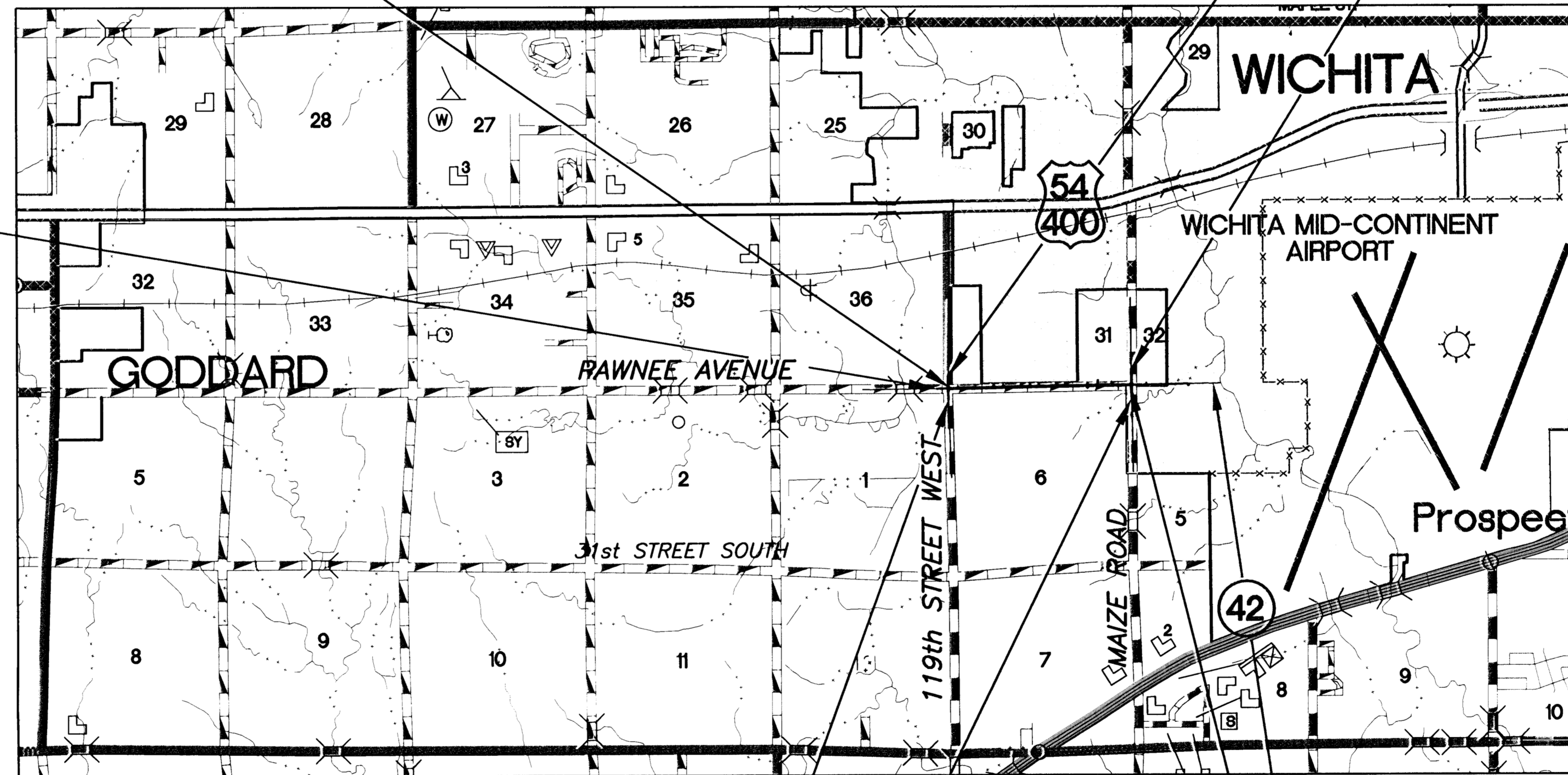

PAWNEE AVENUE
DESIGN DESIGNATION

AADT (2006)	600
AADT (2030)	5,000
DHV	11%
V	40 mph
C of A	Partial
Clear Zone	6 ft.

Scale: 1" = 2500'

NOTE:
Local traffic to be carried
through construction.

REVISED:
FEBRUARY 14, 2007

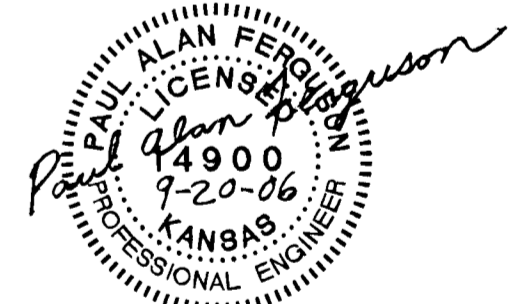

POE and ASSOCIATES, INC.
CONSULTING ENGINEERS
5940 E. Central, Suite 200 ■ Wichita, KS 67208-4242
Phone 316/685-4114 ■ FAX 316/685-4444

CONVENTIONAL SIGNS

COUNTY LINE	CENTER LINE OF PROJECT
CITY LIMITS	TERRACE
STATE OR NATIONAL LINE	CULVERTS
TOWNSHIP, SECTION or GRANT LINE	DROP INLET & STORM SEWER
PROPERTY LINE	ACCESS CONTROL
HIGHWAY FENCE	POWER POLE
EXISTING FENCE	TELEPHONE POLE
GUARD FENCE	MARSH
CONSTRUCTION LIMITS	HEDGE
RIGHT OF WAY LINE	TREES
TRAVELED WAY	PROFILE ELEVATION
RAILROADS	STREAM or CREEK

GROSS LENGTH OF PROJECT	5,349.26	ft.
EXCEPTIONS	-	ft.
NET LENGTH OF PROJECT	5,349.26	ft.
NET LENGTH OF BRIDGES	-	ft.
NET LENGTH OF ROAD	5,349.26	ft.

STA. 89+55.64, END CONSTRUCTION
PROJ. 87 N-0353-01

STA. 64+20.70, END PROJECT
PROJ. 87 N-0353-01

STA. 45+72.32, BEGIN CONSTRUCTION
PROJ. 87 N-0353-01

STA. 45+46.06, BEGIN CONSTRUCTION
PROJ. 87 N-0353-01

APPROVED - DATE 2-21-07

JAMES L. ARMOUR, P.E.
CITY ENGINEER
CITY OF WICHITA PROJECT NO. 472 84357

RECOM. FOR APPROVAL - DATE

CHIEF, BUREAU OF LOCAL PROJECTS
KANSAS DEPARTMENT OF TRANSPORTATION

APPROVED - DATE

STATE TRANSPORTATION ENGINEER
KANSAS DEPARTMENT OF TRANSPORTATION