

STATE	PROJECT NO.	YEAR	SHEET NO.	TOTAL SHEETS
KANSAS	87 N-0340-01	2004	1	35

BRO-034(001)

BRIDGE
CONCRETE PAVEMENT
SODDING

INDEX OF SHEETS

- 1 Title Sheet
- 2 Typical Section
- 3 Plan & Profile
- 4 Intersection West
- 5 Intersection East
- 6 Concrete Pavement (Dowel Jointed, Non-Reinforced)
- 7 Contraction & Expansion Joint Dowel Assemblies
- 8 Valley Gutter Detail
- 9 Flume Details
- 10 Riprap Detail
- 11 Contour Map
- 12 Construction Layout
- 13 RCB Standard Box Sheet
- 14 RCB Standard Wingwall Sheet
- 15 RCB Auxiliary Details
- 16 Bridge Excavation
- 17 Supports and Spacers for Reinforcing Steel
- 18 Waterline Adjustment Details - *Removed from set & filed w/ Water & Sewer Dept. 3/11/04 JD*
- 19 Pedestrian Handrail Details
- 20 Summary of Quantities
- 21 Temp. Erosion and Pollution Control
- 22 BMP#1
- 23 BMP#2
- 24 BMP#3
- 25 Erosion Control
- 26 Traffic Control General Plan
- 27 Traffic Control Stage I
- 28 Traffic Control Stage II
- 29 General Traffic Control
- 30 Channelizing Devices
- 31 Typical Traffic Control Road Closures
- 32 Traffic Control Signs
- 33 Drainage Map
- 34 X-section 1
- 35 X-Section 2

STATE OF KANSAS
DEPARTMENT OF TRANSPORTATION

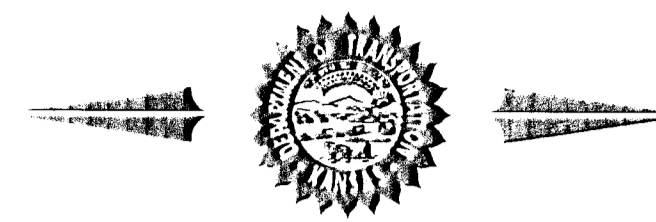

PLAN AND PROFILE OF PROPOSED
9TH STREET NORTH BRIDGE REPLACEMENT
OVER WESTLINK TRIBUTARY

FEDERAL AID PROJECT

CITY OF WICHITA
SEDGWICK COUNTY

POPULATION 344,631

CITY OF WICHITA PROJECT NO. 472-84021 OCA NO. 715702
CITY OF WICHITA PROJECT NO. 448-90010 OCA NO. 636139

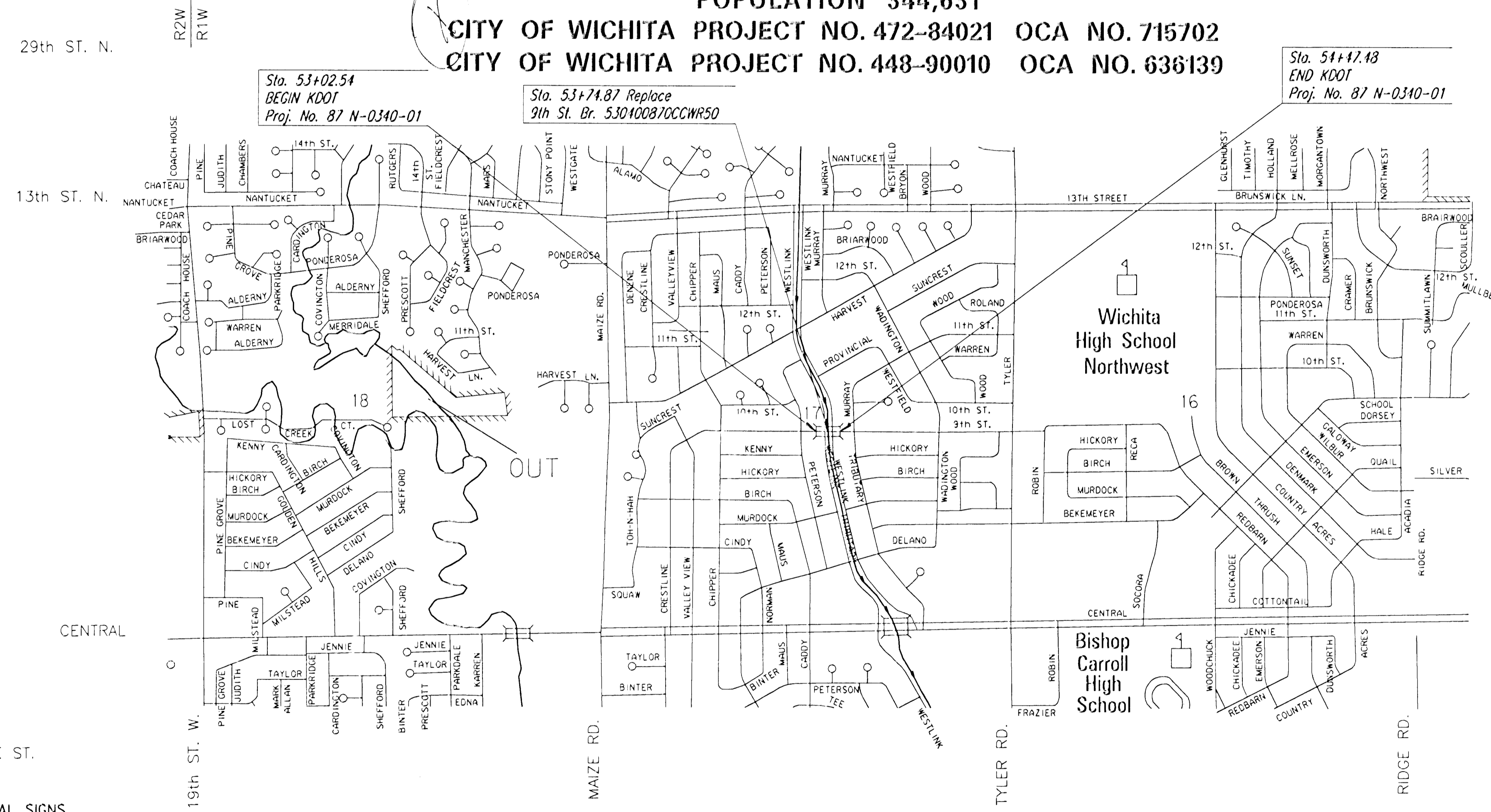

Scale: 1" = 1000'

Sta. 51+47.43
END KDOT
Proj. No. 87 N-0340-01

Sta. 53+02.54
BEGIN KDOT
Proj. No. 87 N-0340-01

Sta. 53+74.87 Replace
9th St. Br. 530100870CCWR50

DESIGN DESIGNATION

AADT (2004) 575
AADT (2024) 785
T 2 %
V 30 MPH
C of A None
Clear Zone 35 feet

T27S PAWNEE ST.
T28S

CONVENTIONAL SIGNS

COUNTY LINE	CENTER LINE OF PROJECT
CITY LIMITS	TERRACE
STATE OR NATIONAL LINE	CULVERTS
TOWNSHIP, SECTION or GRANT L.	DROP INLET & STORM SEWER
PROPERTY LINE	ACCESS CONTROL
HIGHWAY FENCE	POWER POLE
EXISTING FENCE	TELEPHONE POLE
GUARD FENCE	MARSH
CONSTRUCTION LIMITS	HEDGE
RIGHT OF WAY LINE	TREES
TRAVELED WAY	PROFILE ELEVATION
RAILROADS	STREAM or CREEK

GROSS LENGTH OF PROJECT	144.94	FT.
EXCEPTIONS		
ADDITIONS		
NET LENGTH OF PROJECT	144.94	FT. 0.027 MILES
NET LENGTH OF BRIDGES	00.00	FT. 0.000 MILES
NET LENGTH OF ROAD	144.94	FT. 0.027 MILES

Note:
9th shall be closed locally during construction.
Westlink Avenue will be closed locally in stages during construction.

PLANS PREPARED BY

Professional Engineering Consultants, P.A.
303 S. TOPEKA • WICHITA, KANSAS 67202
316-262-2691 • FAX 316-262-3003

APPROVED - DATE 10-7-04

JAMES L. ARMOUR ACTING CITY ENGINEER
CITY OF WICHITA, SEDGWICK COUNTY, KANSAS
CITY NO. 472-84021

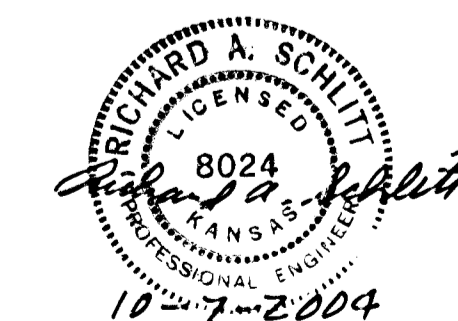

Drawn by: RAS
 Plotted by: DTP 9-8-2004
 I:\2004\04330\off\tochresk\04330-C T\title.Plot.dgn