

Carol Jean 2nd Addition

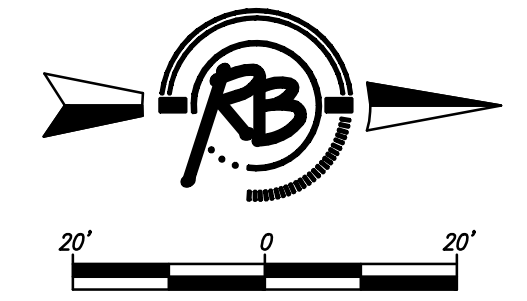

NOTE: ROLL TYPE CURB AND GUTTER TO BE CONSTRUCTED ALONG PAVEMENT DEPICTED ON THIS SHEET

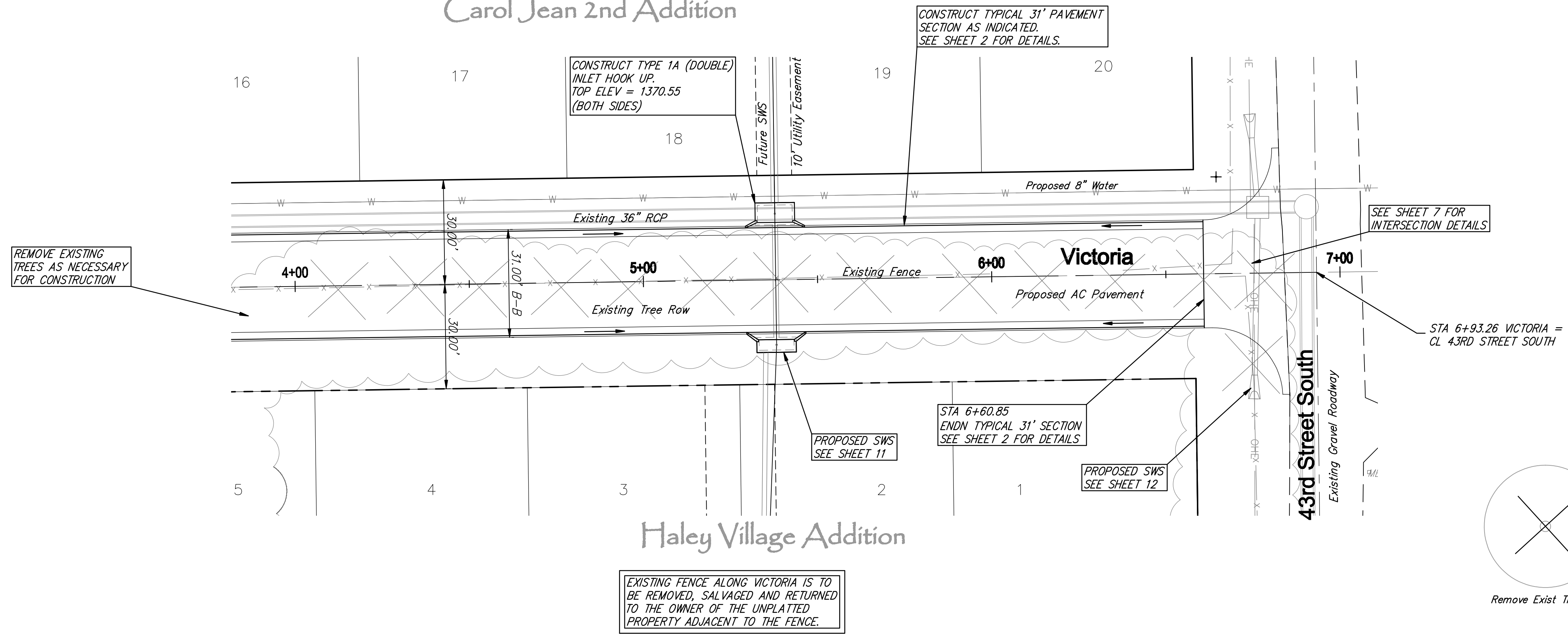
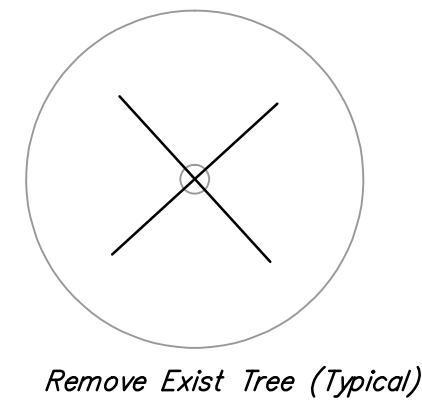

EXISTING FENCE ALONG VICTORIA IS TO BE REMOVED, SALVAGED AND RETURNED TO THE OWNER OF THE UNPLATTED PROPERTY ADJACENT TO THE FENCE.

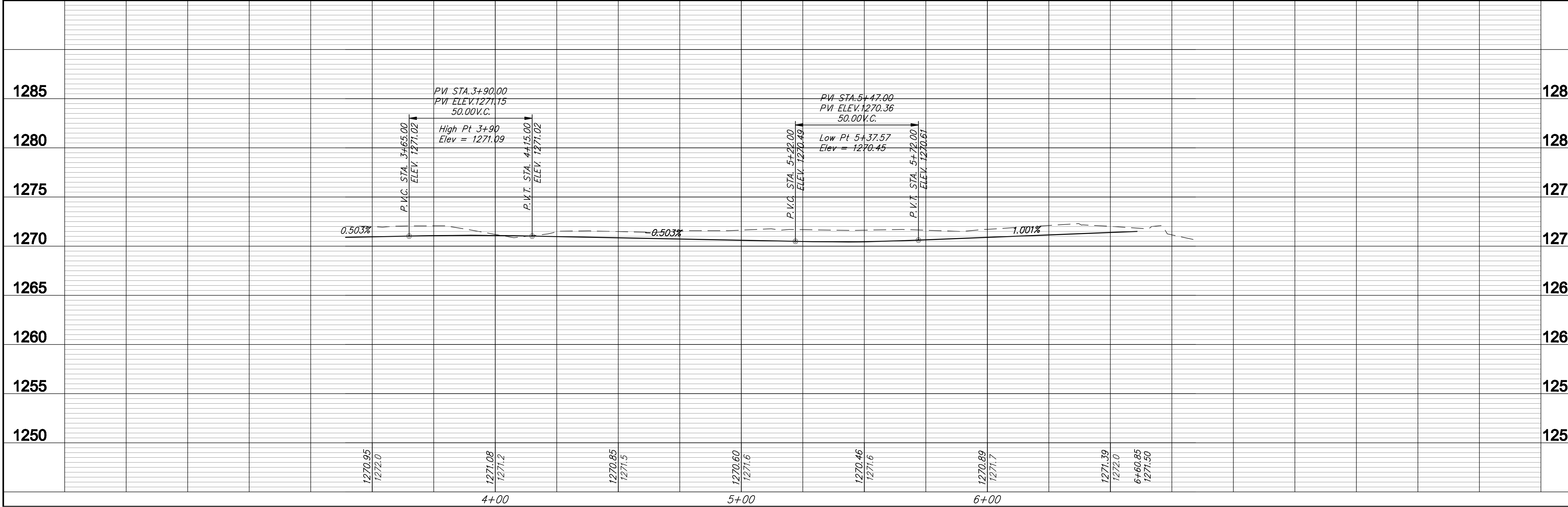

**Rough & Pollock, P.A.**  
 Engineers & Surveyors  
 License No. 0000000000  
 Dec. 29, 2009  
 PROJECT NUMBER: 202PPP  
 DRAWING FILE: Engineering Base (Victoria)  
**PAVING IMPROVEMENTS**  
**VICTORIA**  
**WICHITA, KANSAS**  
 331E  
 25