

EXISTING SWSMH
EXISTING TOP ELEV = 1270.01
ADJUST TOP TO ELEV = 1270.30

STA 0+44.35 VICTORIA
BEGIN TYPICAL 31' SECTION
SEE SHEET 4

EXISTING SSMH
EXISTING TOP ELEV = 1270.24
ADJUST TOP TO ELEV = 1269.85

CONSTRUCT VALLEY GUTTER PAVEMENT.
7" REINFORCED CONCRETE W/ 5"
CRUSHED ROCK BASE AND MONOLITHIC
EDGE CURB (3 5/8")

STA 0+26, 30' RT
INSTALL SNS
'44th St. S.'
'Victoria'

Carol Jean 2nd Addition

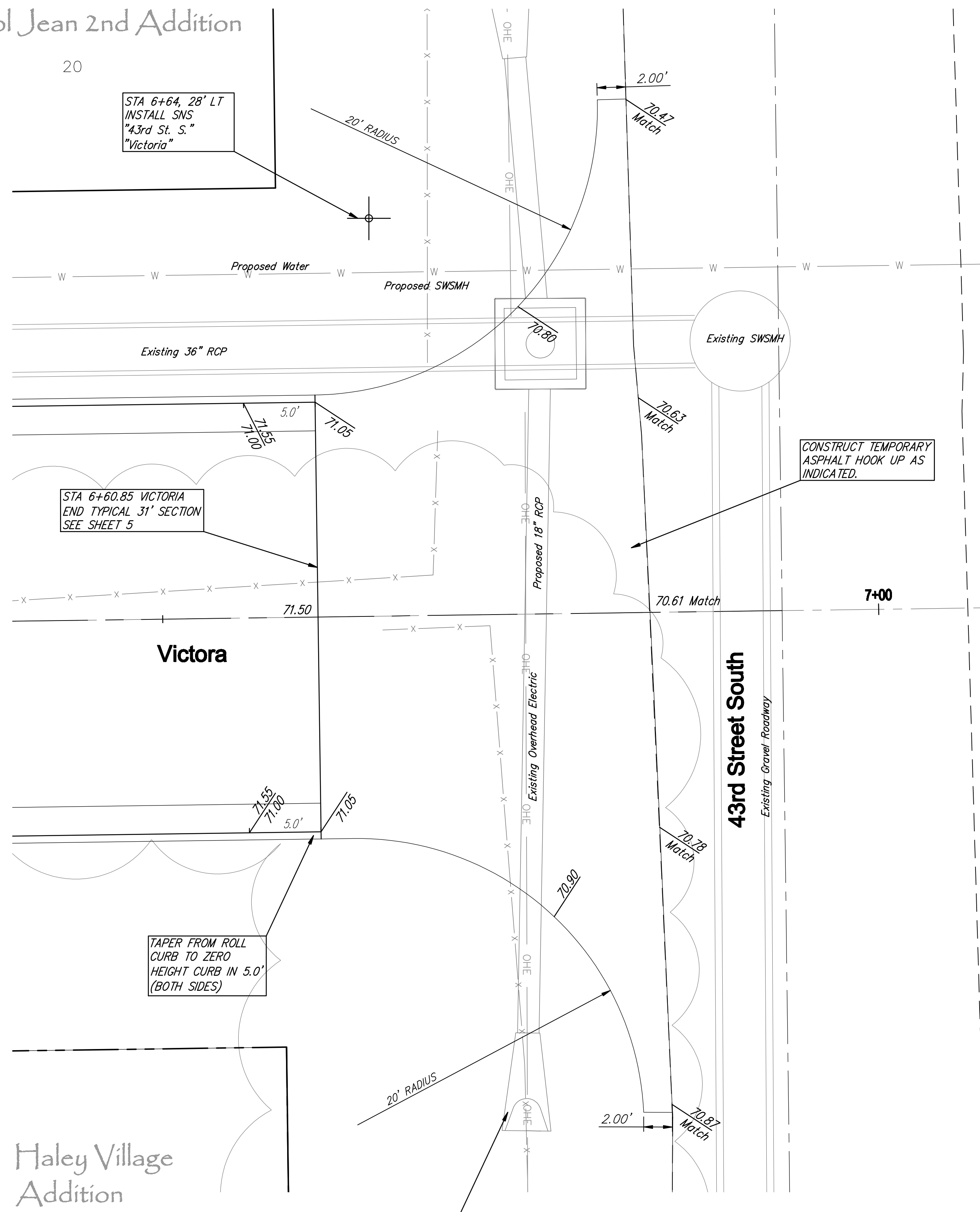

STA 6+64, 28' LT
INSTALL SNS
'43rd St. S.'
'Victoria'

STA 6+60.85 VICTORIA
END TYPICAL 31' SECTION
SEE SHEET 5

TAPER FROM ROLL
CURB TO ZERO
HEIGHT CURB IN 5.0'
(BOTH SIDES)

PROPOSED STORM SEWER
SEE SHEET 12

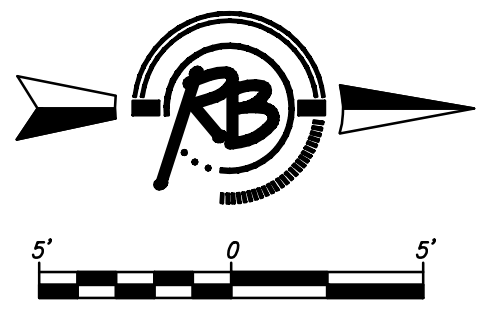

Carol Jean 2nd/ Hobbs Village/Haley Village Addition Intersection Details WICHITA, KANSAS			
	Ruggles & Bohm, P.A. Engineering, Surveying, Land Planning		EJG EJG 7 25
	824 North Main Wichita, Kansas 67203 www.rbgkansas.com		
(913) 264-8999 (913) 264-4821 fax E-mail: info@rbkansas.com		PROJECT NUMBER: 202PPP DATE: Dec. 29, 2009	