

STATE	PROJECT NO.	YEAR	SHEET NO.	SHEETS
KANSAS	87 N-0235-01	2006	81	120

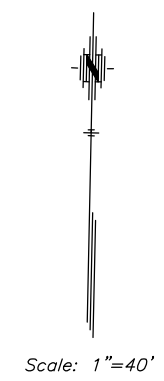

LEGEND

- ☐ Relocate Existing Sign and Post to This Approximate Location. Bus Signs to be Set at an Angle as Directed by the City.
- * Existing Sign to Remain (Not in Contract)

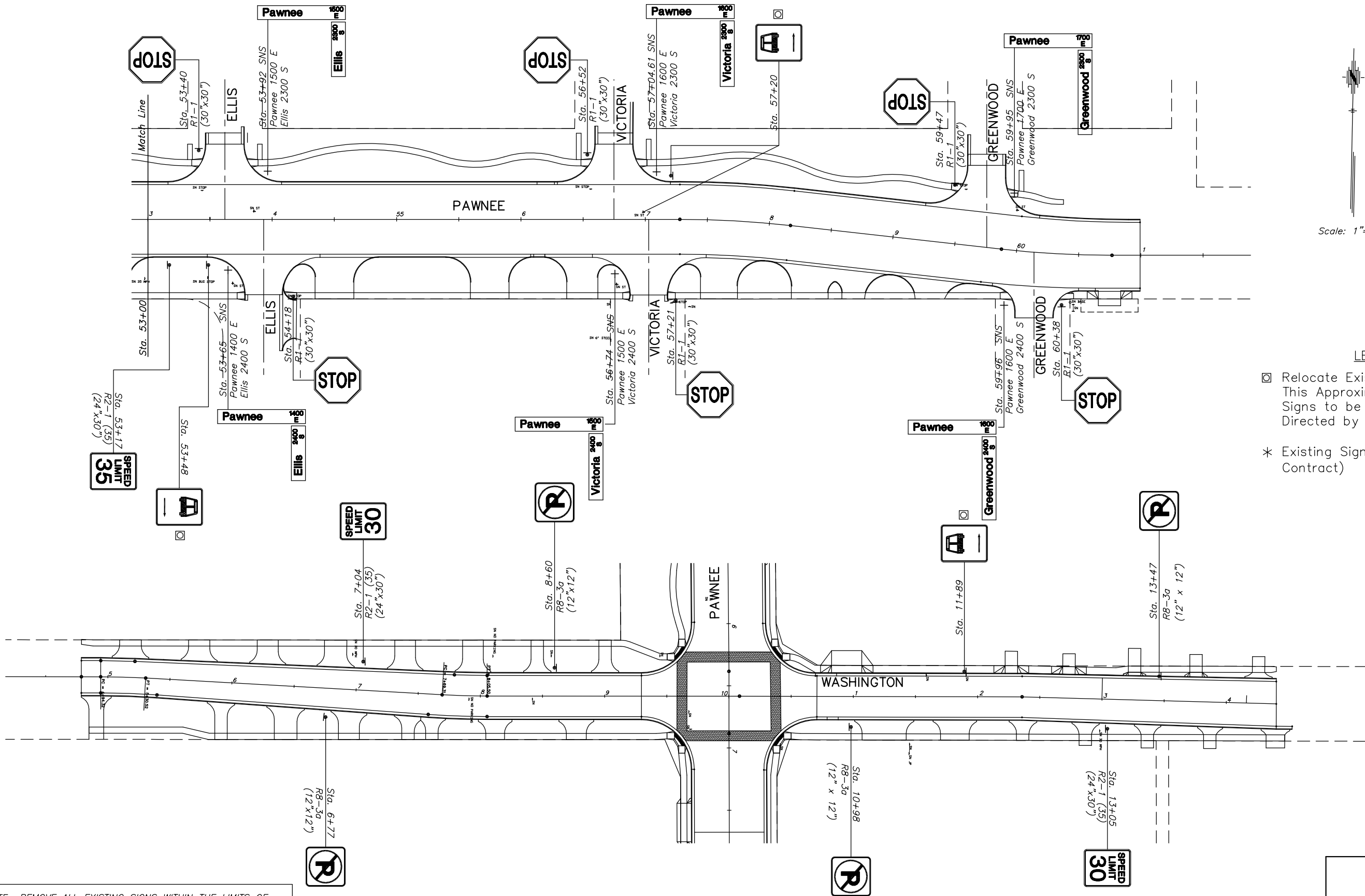
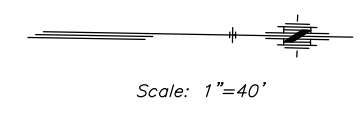

NOTE: REMOVE ALL EXISTING SIGNS WITHIN THE LIMITS OF CONSTRUCTION UNLESS NOTED OTHERWISE ON THE PLAN. ALL SIGNS SHOWN ON THE PLAN ARE TO BE NEW SIGNS ON NEW POSTS UNLESS NOTED OTHERWISE.

KANSAS DEPARTMENT OF TRANSPORTATION
PAWNEE IMPROVEMENTS
SIGNING PLAN

PROJECT NO. 87 N-0235-01 SEDGWICK CO.
M K E C ENGINEERING CONSULTANTS, INC.
WICHITA, KANSAS

DESIGNED BY: JRA	CHECKED BY: JRA
DRAWN BY: WNJ	DATE: JULY 2004 SHEET 81 OF 120