

PHASING	HANDLING OF TRAFFIC	MAJOR CONSTRUCTION ITEMS	REMARKS
1	Pawnee: Fully Open Washington: Closed to through traffic south of Pawnee between stations 4+78 to 7+84. Pedestrian access to be maintained to residences within closure area. Vehicular access to be maintained to other properties.	Demolition, grading and surfacing of Washington from Sta. 4+78.95 to Sta. 7+84.38. Do not construct curb & gutter lt. from Sta. 6+53.73 to Sta. 7+84.38, during this phase. Construct driveways from Sta. 4+90.91 to, and including, Sta. 6+27.54.	Contractor must complete Phase 1 within 30 days. Construct temporary asphalt pavement to provide a transition between existing and new pavement. A minimum lane width of 11 feet shall be provided in each direction.
2	Pawnee: From Sta. 30+46.87 to Sta. 39+60, 2-way traffic on north most set of existing lanes. From Sta. 41+10 to Sta. 61+00, 2-way traffic on south most set of existing lanes. Washington: 2-way traffic on east most set of lanes north of Pawnee and 2-way traffic on west most set of lanes south of Pawnee. Side Streets: Only to be closed to traffic for the purpose of construction of the side street.	Demolition, grading, drainage and surfacing of Pawnee from Sta. 30+46.87 to Sta. 36+50.00, from Sta. 36+78.24 to Sta. 4+70.21, Rt. of centerline. Demolition, grading, drainage and surfacing of Pawnee from Sta. 40+80.72 to Sta. 60+99.36, Lt. of centerline. Demolition, grading, drainage and surfacing of Washington from Sta. 7+84.38 to Sta. 9+66.17, from 5.50' Lt. of centerline to the Rt. of centerline, except in areas that would disrupt traffic movement. Demolition, grading, drainage and surfacing of Washington from Sta. 10+33.65 to Sta. 14+40.19, from 1/4 Section line to the Lt. except in areas that would disrupt traffic movement. Construct driveways and sidewalks to the Rt. of centerline in the area constructed during Phase 1 and in the construction areas listed in this phase.	No two consecutive side streets are to be closed at the same time. Contractor will maintain access to adjacent properties with private entrances onto Pawnee, Washington and Side Streets. Sidewalks to be closed when under construction. Left turns not allowed within project limits.
3	Pawnee: 2-way traffic Rt. of centerline. Washington: 2-way traffic on west most set of lanes. Side Streets: Only to be closed to traffic for the purpose of construction of the side street.	Demolition, grading, drainage and surfacing of Pawnee from Sta. 30+46.87 to Sta. 36+41.13, from Sta. 36+63.36 to Sta. 40+80.72, Lt. of centerline. Demolition, grading, drainage and surfacing of Washington from Sta. 9+29.53 to Sta. 9+66.17, from 5.50' Lt. of centerline to the 1/4 Section line, except in areas that would disrupt traffic movement. Demolition, grading, drainage and surfacing of Washington from Sta. 10+00.00 to Sta. 14+40.19, from 1/4 Section line to the Rt. Construct driveways and sidewalks in construction areas listed in this phase.	No two consecutive side streets are to be closed at the same time. Contractor will maintain access to adjacent properties with private entrances onto Pawnee, Washington and Side Streets. Sidewalks to be closed when under construction. Left turns not allowed within project limits. Phase 3 may be constructed as a sub-phase of Phase 2. The traffic control plan between Laura and the east project limits is identical for both phases.
4	Pawnee: From Sta. 30+46.87 to Sta. 38+80.00, 2-way traffic on south mos: set of lanes. From Sta. 39+85.00 to Sta. 61+00, 2-way traffic on north most set of lanes. Washington: 2-way traffic on east most set of lanes north and south of Pawnee and 2-way traffic to the Rt. of 1/4 Section line through intersection with Washington. Side Streets: Only to be closed to traffic for the purpose of construction of the side street.	Demolition, grading, drainage and surfacing of the remainder of Pawnee east of Washington and within the intersection of Washington, except in areas that would disrupt traffic movement. Demolition, grading, drainage and surfacing of the remainder of Washington south of Pawnee, except in areas that would disrupt traffic movement.	No two consecutive side streets are to be closed at the same time. Contractor will maintain access to adjacent properties with private entrances onto Pawnee, Washington and Side Streets. Sidewalks to be closed when under construction. Left turns not allowed within project limits.
5	Pawnee: 2-way traffic on north most set of lanes. Washington: Traffic to remain as discribed in Phase 4. Side Streets: Open	Demolition, grading, drainage and surfacing of a portion of the intersection of Pawnee and Washington, as shown.	Contractor will maintain access to adjacent properties with private entrances onto Pawnee, Washington and Side Streets. Left turns not allowed within project limits. Phase 5 may be constructed as a sub-phase of Phase 4. The traffic control plan between Laura and the east project limits is identical for both phases.
6	Pawnee: 2-way traffic on north most set of lanes. Washington: 2-way traffic on west most set of lanes. Side Streets: Open	Demolition, grading, drainage and surfacing of a portion of the intersection of Pawnee and Washington, as shown.	Contractor will maintain access to adjacent properties with private entrances onto Pawnee, Washington and Side Streets. Left turns not allowed within project limits. Phase 6 may be constructed as a sub-phase of Phase 4. The traffic control plan between Laura and the east project limits is identical for both phases.
7	Perform all construction activities one lane at a time. Close traffic on lane being constructed. Switch traffic control from one lane to the next as required. Refer to standard traffic control sheets.	Construct asphalt surface course over entire project. Install permanent pavement markings.	

General Notes
All signs and pavement markings conflicting with construction traffic control shall be covered or removed as directed by the Engineer.

As the various construction activities progress, certain situations may arise that will preclude adhering to the original construction sequence or which, in the opinion of the Contractor, would readily adapt themselves to a more efficient phasing operation. Should this occur, the Contractor may submit to the Engineer an alternative plan for approval.

Contractor shall maintain existing drainage system during construction and address local drainage issues as necessary during construction. Temporary drainage measures will be subsidiary to other items in the contract. Contractor shall provide for drainage in milled areas opened to traffic. Ponded stormwater in milled areas will not be allowed.

Driveways 16' wide and wider shall be constructed half at a time with the other half remaining open. Driveways less than 16' may be closed completely during construction. Driveways on properties with multiple drives may be constructed in their entirety

Temporary asphalt paving shall be used to construct wedges between two pavements with a grade differential. Temporary asphalt pavement will not be measured and is subsidiary to "Traffic Control".

* Use Sign Only If Distance "X" Is Greater Than 1000 Feet.

STATE	PROJECT NO.	YEAR	SHEET NO.	SHEETS
KANSAS	87 N-0235-01	2006	84	120

Note: Kansas Gas Service (KGS) will be relocating an existing gas line under Pawnee during construction. The Contractor shall coordinate work with KGS. In general, KGS will relocate the line after existing pavement has been removed and prior to construction of new Pawnee pavement. During construction phase 2, pavement removal should extend far enough south to clear the existing gas line as shown on the plans (3 feet north of existing center line). In construction phase 2, pavement demolition should proceed from east to west. In construction phase 3, pavement demolition should proceed from west to east.

LEGEND

- Type III Barricades with lights
- Mount On Type III Barricade
- Type B Warning Light
- One Post Sign
- Two Post Sign
- Traffic Lane
- Work Area
- Reflectorized Drum
- Tubular Marker
- Vertical Panel

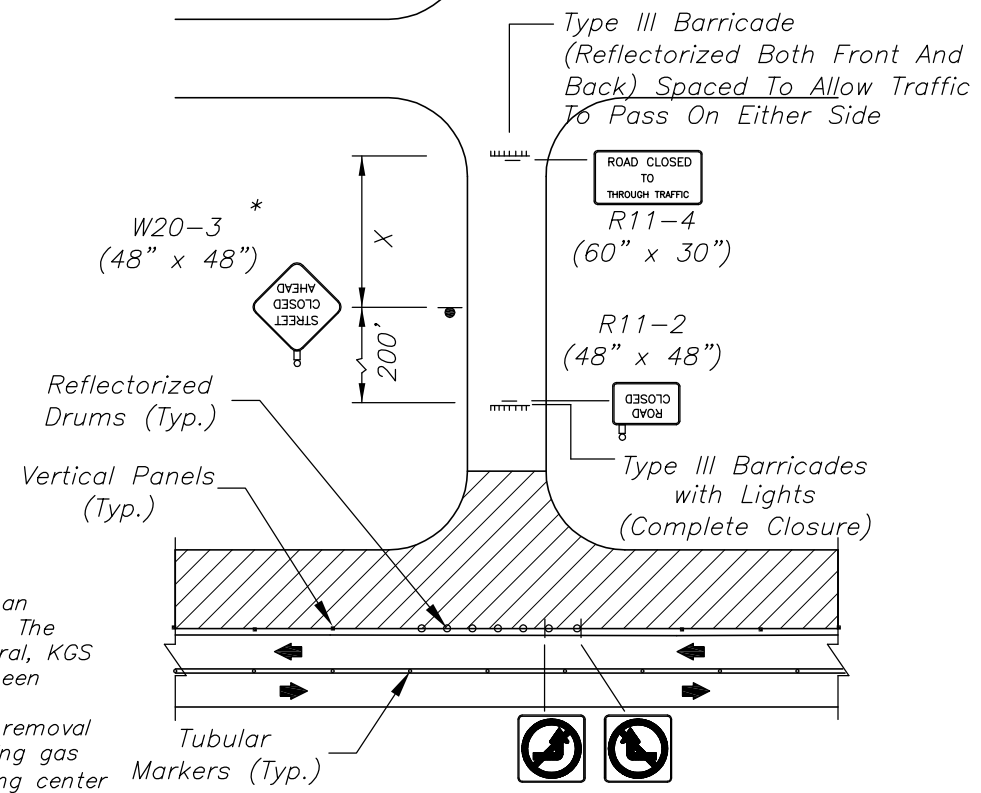

TYPICAL CLOSED SIDE STREET

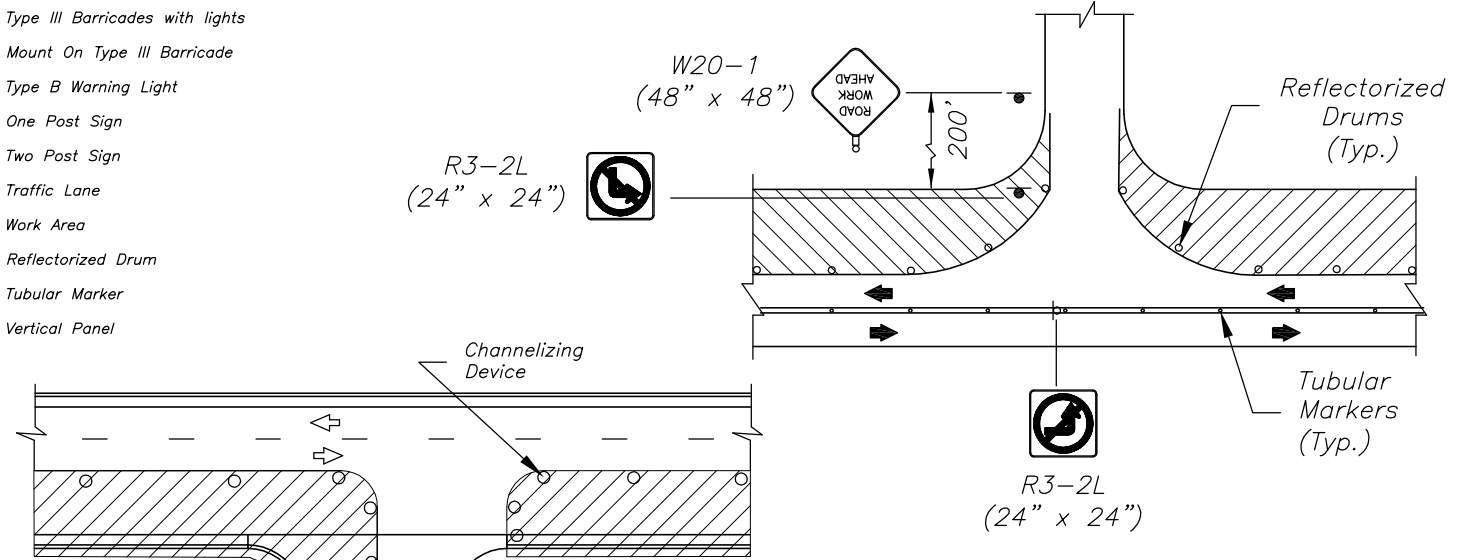

TYPICAL ENTRANCE AND SIDE STREET

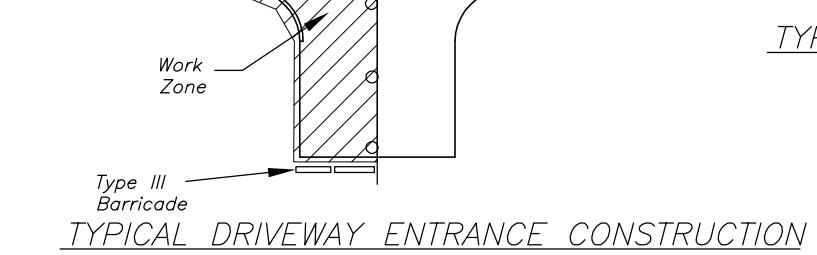

TYPICAL DRIVEWAY ENTRANCE CONSTRUCTION

Maintain access to businesses at all times. If a single property has multiple entrances, one entrance at a time may be closed for construction.

C:\Civil\04222\dwg\Details\CONST_SEQ.dwg 07/06/2006 03:57:52 PM CST
KANSAS DEPARTMENT OF TRANSPORTATION

PAWNEE IMPROVEMENTS
CONSTRUCTION SEQUENCE

PROJECT NO. 87 N-0235-01 SEDGWICK CO.
M K E C ENGINEERING CONSULTANTS, INC.
WICHITA, KANSAS

DESIGNED BY: JRA	CHECKED BY: JRA
DRAWN BY: WNJ	DATE: JULY 2004

SHEET 84 OF 120