

BENCHMARKS:
 BM #1: ARKANSAS RIVER BRIDGE & 63RD ST. S. CITY OF WICHITA
 BENCHMARK DISC. SW COR. OF BRIDGE, TOP OF HUBGUARD. 500'± E. OF GROVE.
 ELEV. = 1269.95 MSL

BM #2: BRASS PLATE ON THE NE WINGWALL OF ARKANSAS RIVER BRIDGE & 63RD ST. S.
 ELEV. = 1267.48 MSL

Scale: 1" = 20'
 •• Iron

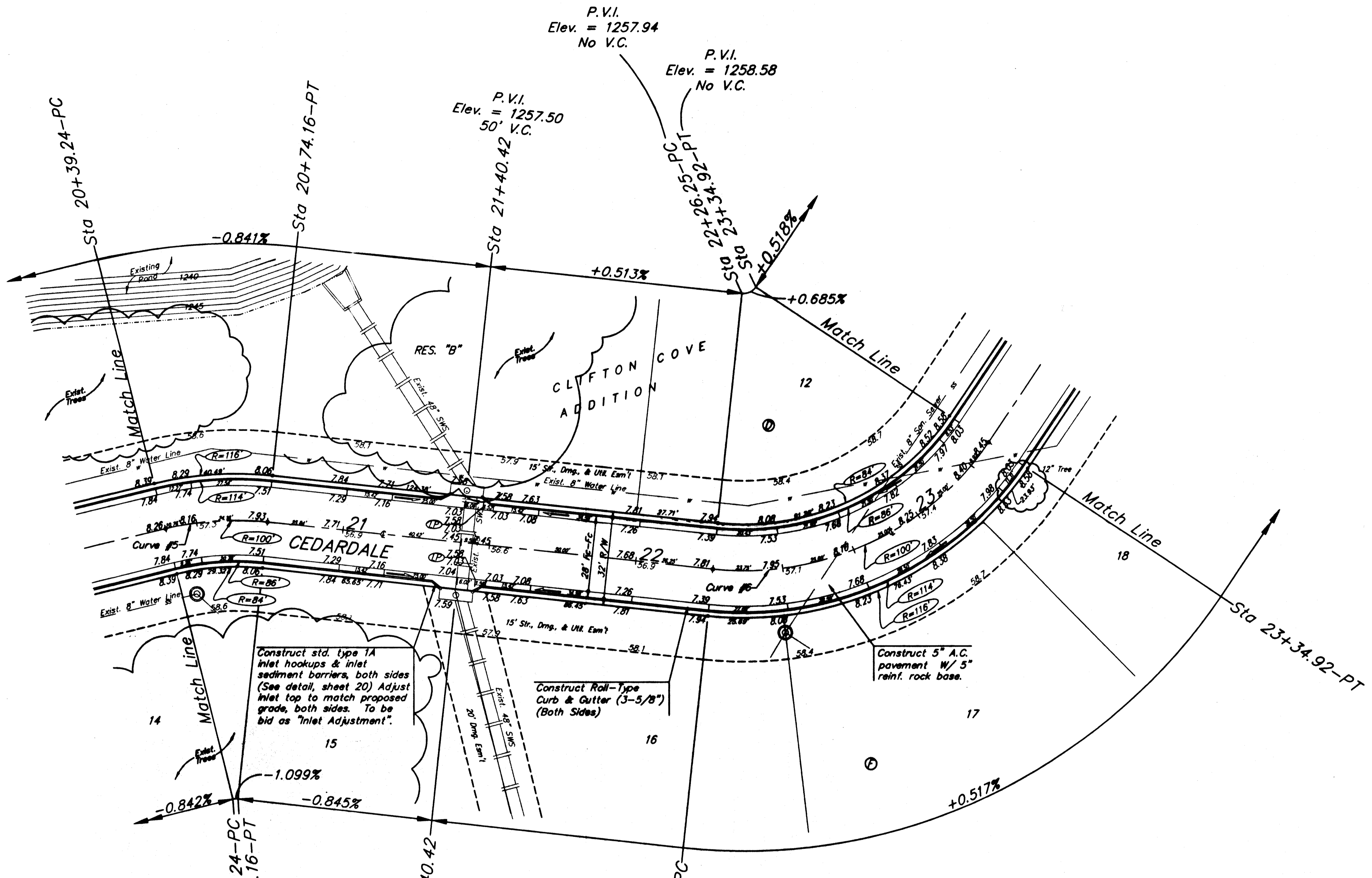

Construct std. type 1A inlet hookups & inlet sediment barriers, both sides (See detail, sheet 20) Adjust inlet top to match proposed grade, both sides. To be bid as "Inlet Adjustment".

Construct Roll-type Curb & Gutter (3-5/8") (Both Sides)

Construct 5" A.C. pavement w/ 5" reinf. rock base.

Existing Trees Shall be removed ONLY with approval of the Engineer. Trees Not in Direct Conflict With Proposed New Construction Shall Remain And Be Protected From Damage. Cost to be Included in Bid Item "Site Clearing & Restoration"

Curve #5
 Curve Data Based on Centerline
 Rad. = 100' Delta = 20'00" Tangent = 17.63'
 Arc = 34.92' L.C. = 34.73' Def/Fl. = 17.18213 Min.

Station	Arc	FACE CHORD LENGTHS		Def.	T. Def.
		B' Lt.	B' Rt.		
20+39.24	-	-	-	0'00"00"	0'00"00"
20+50.00	10.76'	13.12'	8.39'	3'04'53"	3'04'53"
20+74.18	24.16'	29.39'	18.79'	6'55'07"	10'00"00"

Curve #6
 Curve Data Based on Centerline
 Rad. = 100' Delta = 62'15'41" Tangent = 60.40'
 Arc = 108.67' L.C. = 103.40' Def/Fl. = 17.18820 Min.

Station	Arc	FACE CHORD LENGTHS		Def.	T. Def.
		B' Lt.	B' Rt.		
22+26.25	-	-	-	0'00"00"	0'00"00"
22+50.00	23.75'	18.48'	28.91'	6'48'13"	6'48'13"
22+75.00	25.00'	19.45'	30.42'	7'09'42"	13'57'55"
23+00.00	25.00'	19.45'	30.42'	7'09'42"	21'07'38"
23+25.00	25.00'	19.45'	30.42'	7'09'42"	28'17'20"
23+34.92	9.92'	7.73'	12.10'	2'50'31"	31'07'51"

A-5 Built +/- 7/11/06
 Roll type curb & gutter to be constructed on the pavement on this sheet. Top of curb elevation are given for full height curb.

Baughman Clifton Cove Addition - Phase I
CEDARDALE AVE.
 STA 20+39.24 TO STA 23+34.92

Engineering | Surveying | Planning | Landscape Architecture

PROJECT NUMBER: 472-04127
 DESIGNER: MWS/JAK
 DRAWN: TMS
 APPROVED: DATE: 5/17/06

SCALE: Noted
 SHEET: **11 of 31**

Clifton Cove Add Phase I V04d 05-08-E130