

PAVING AND INCIDENTAL DRAINAGE PLANS FOR
BOTANICA - THE WICHITA GARDENS
STREETS AND UTILITIES IMPROVEMENTS

PAVING PLAN
SHEET TITLE
472-84758
PROJECT NUMBER

DMU
DESIGN BY
DMU
DRAWN BY
GJA
CHECKED BY

ISSUED
July 2010
REVISED

SHEET NO.
11 of 23

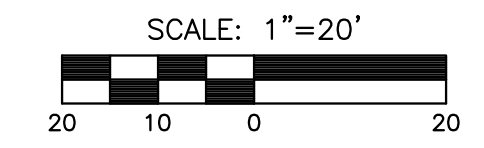
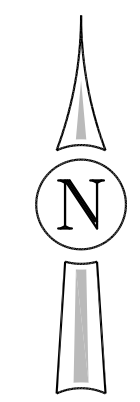

CURVE TABLE - C4
 $\Delta = 17'41.44"$ R = 370.00' T = 57.59' L = 114.27' LC = 113.82'
 CURVE DATA BASED ON CENTERLINE $\Delta/2 = 08'50'52"$

STATION	ARC	CHORD LENGTH		DEFLECTION	TOTAL DEFLECTION
		8'Off LtCb	8'Off RtCb		
23+70.79	-	-	-	00°00'00"	00°00'00"
24+00.00	29.21'	27.39'	31.02'	02°15'42"	02°15'42"
24+25.00	25.00'	23.44'	26.55'	01°56'08"	04°11'50"
24+50.00	25.00'	23.44'	26.55'	01°56'08"	06°07'59"
24+75.00	25.00'	23.44'	26.55'	01°56'08"	08°04'07"
24+85.06	10.06'	9.44'	10.69'	00°46'45"	08°50'52"

Def/Ft = 4.64560 Min.

CURVE TABLE - C7
 $\Delta = 14'12.36"$ R = 396.00' T = 49.36' L = 98.21' LC = 97.96'
 CURVE DATA BASED ON LEFT FACE OF CURB $\Delta/2 = 07'06'18"$

STATION	ARC	CHORD LENGTH		DEFLECTION	TOTAL DEFLECTION
		8'Off LtCb	8'Off RtCb		
23+70.79	-	-	-	00°00'00"	00°00'00"
24+00.00	29.21'	28.61'	-	02°06'47"	02°06'47"
24+25.00	25.00'	24.49'	-	01°48'31"	03°55'18"
24+50.00	25.00'	24.49'	-	01°48'31"	05°43'49"
24+69.00	19.00'	18.62'	-	01°22'29"	07°06'18"

Def/Ft = 4.34059 Min.

CURVE TABLE - C6
 $\Delta = 21'58'37"$ R = 363.00' T = 70.48' L = 139.24' LC = 138.38'
 CURVE DATA BASED ON RIGHT FACE OF CURB $\Delta/2 = 10'59'19"$

STATION	ARC	CHORD LENGTH		DEFLECTION	TOTAL DEFLECTION
		8'Off LtCb	8'Off RtCb		
23+70.79	-	-	-	00°00'00"	00°00'00"
24+00.00	29.21'	-	29.85'	02°18'19"	02°18'19"
24+25.00	25.00'	-	25.55'	01°58'23"	04°16'42"
24+50.00	25.00'	-	25.55'	01°58'23"	06°15'04"
24+75.00	25.00'	-	25.55'	01°58'23"	08°13'27"
25+00.00	25.00'	-	25.55'	01°58'23"	10°11'50"
25+10.03	10.03'	-	10.25'	00°47'28"	10°59'18"

Def/Ft = 4.73519 Min.

CURVE TABLE - C8
 $\Delta = 21'58'37"$ R = 363.00' T = 70.48' L = 139.24' LC = 138.38'
 CURVE DATA BASED ON RIGHT FACE OF CURB $\Delta/2 = 10'59'19"$

STATION	ARC	CHORD LENGTH		DEFLECTION	TOTAL DEFLECTION
		8'Off LtCb	8'Off RtCb		
23+70.79	-	-	-	00°00'00"	00°00'00"
24+00.00	29.21'	-	29.85'	02°18'19"	02°18'19"
24+25.00	25.00'	-	25.55'	01°58'23"	04°16'42"
24+50.00	25.00'	-	25.55'	01°58'23"	06°15'04"
24+75.00	25.00'	-	25.55'	01°58'23"	08°13'27"
25+00.00	25.00'	-	25.55'	01°58'23"	10°11'50"
25+10.03	10.03'	-	10.25'	00°47'28"	10°59'18"

Def/Ft = 4.73519 Min.

CURVE TABLE - C5
 $\Delta = 03'28'57"$ R = 1090.00' T = 33.14' L = 66.25' LC = 66.24'
 CURVE DATA BASED ON CENTERLINE $\Delta/2 = 01'44'28"$

STATION	ARC	CHORD LENGTH		DEFLECTION	TOTAL DEFLECTION
		8'Off LtCb	8'Off RtCb		
24+85.06	-	-	-	00°00'00"	00°00'00"
25+00.00	14.94'	15.26'	14.82'	00°23'34"	00°23'34"
25+25.00	25.00'	25.53'	24.47'	00°39'25"	01°02'59"
25+50.00	25.00'	25.53'	24.47'	00°39'25"	01°42'24"
25+51.31	1.31'	1.34'	1.28'	00°02'04"	01°44'28"

Def/Ft = 1.57695 Min.

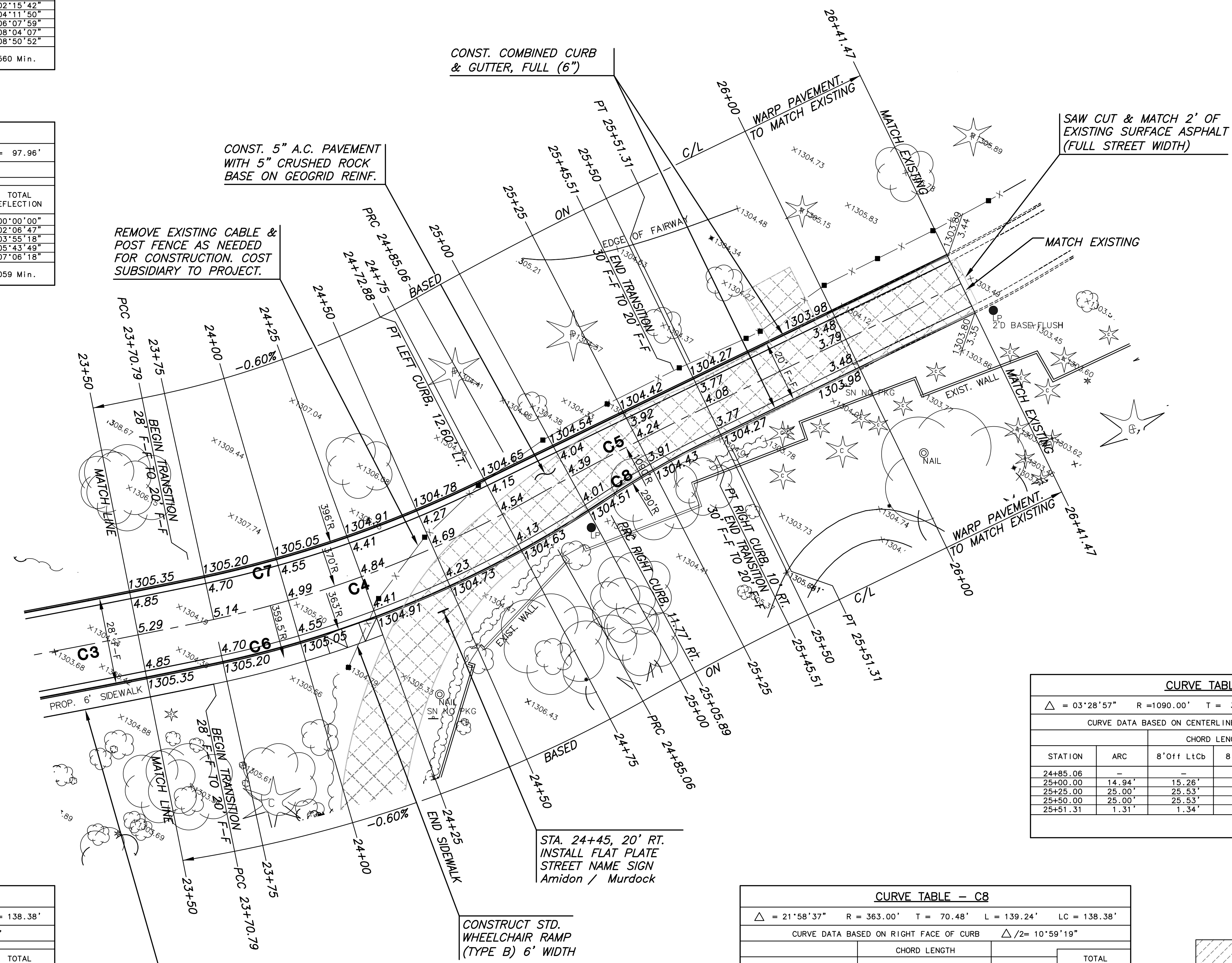

LEGEND

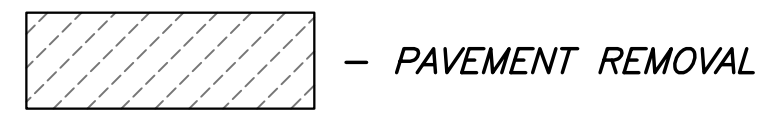

NOTE:
TOP OF CURB ELEVATIONS SHOWN
ARE FOR FULL CURB. CONSTRUCT
CURB AND GUTTER AS NOTED.

PLOTTED: Friday, July 02, 2010 @ 07:07AM

J:\CIVIL\08603\DWG\PAV\08603_E4.DWG