

N-4614.01, E-10539.35,
Sta. 0+16.57, Begin SS Line 1
Core into Existing MH
Seal & Grout as Reqd.
Adjust Existing Rim Elev.
w/ New Ring & Cover
Top Elev. = 1294.92

Abandon Ex. 8" SS
Sweep In Place
(Approx. 67 L.F.)

Remove Ex. Conc. Drive
As Shown Do Not Replace
Construct Approx. 20.6 L.F.
Curb Section
(Match Exstg.)

Install 12.00 L.F. 10" Encasement
Through Existing Brick Arch. See
Note #1.

Saw, Remove, & Replace w/
2" A.C. Pavement on 6" Reinf.
Concrete Pavement on 6" Reinf.
Crushed Rock Base.

Construct Approx. 20.0 L.F.
Curb Section
(Match Exstg.)

CAUTION!
Existing
6" Water
Crossing

ST. FRANCIS LOT SITE BENCHMARK

"g" Cut on the East Side of the Concrete Light Pole Base, Located
On the West Side of St. Francis, Between the Kellogg Bridges.
Elevation = 1296.13 NAVD

N-4592.50, E-10158.46,
Remove Ex. Asphalt. Pmnt. to
Limits Shown.
Remove Ex. Brick Manhole
Construct Std. Shallow Type "P"
(4' Dia.) over 8" Line.
Replace Pmnt. w/ 6" Asphalt Surface Mix.
Top Elev. = 1295.15

SCALE:
1" = 20' HORIZONTAL
1" = 5' VERTICAL

N-4674.82, E-10539.19,
Adjust Existing Rim Elev.
w/ New Ring & Cover
Top Elev. = 1294.70

N-4657.71, E-10489.77,
Sta. 0+49.48, SS Line 1
Remove Ex. Brick Manhole
Construct Std. Type "P" Manhole
(4' Dia.)
Top Elev. = 1295.50

Remove Ex. 8" SS Pipe
(Approx. 220 L.F.)

N-4653.61, E-10319.68,
Sta. 2+19.61, SS Line 1
Remove Ex. Brick Manhole
Construct Std. Shallow Type
"P" Manhole (4' Dia.)
Top Elev. = 1293.16

N-4641.25, E-10319.66,
Sta. 2+31.00, End SS Line 1
Remove Ex. Brick Manhole
Construct Std. Shallow Type
"P" Manhole (4' Dia.)
Top Elev. = 1293.58

CAUTION!
Gas line close
proximity

1. Manhole Opening at SS Crossing through Brick Arch is indicated at asphalt Patch, but not verified. Contractor shall be required to remove and reconstruct portion of brick wall and floor to establish Sewer Flow as designed. Paid as "L.F. of 10" Pipe Encasement."
2. Sand Fill Flush and Vibrate through Paving sections shall be a Measured Quantity.
3. Sewer Service shall not be interrupted throughout the duration of the Project. The Contractor shall be responsible for maintaining continuous sewage flows. Cost for By-pass pumping shall be INCIDENTAL to other items in the Project.

Edge of brick walk

N-4673.64, E-10158.51,
Remove Existing Conc. to
Limits As Shown.
Adjust Ex. Manhole to
Existing Conc. Grade
Install New Ring & Cover
Replace Pmnt. w/ 6" Reinf. Conc.
Match Finish.

Areas of Full Pavement
Removal are Indicated By:

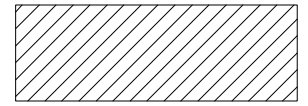
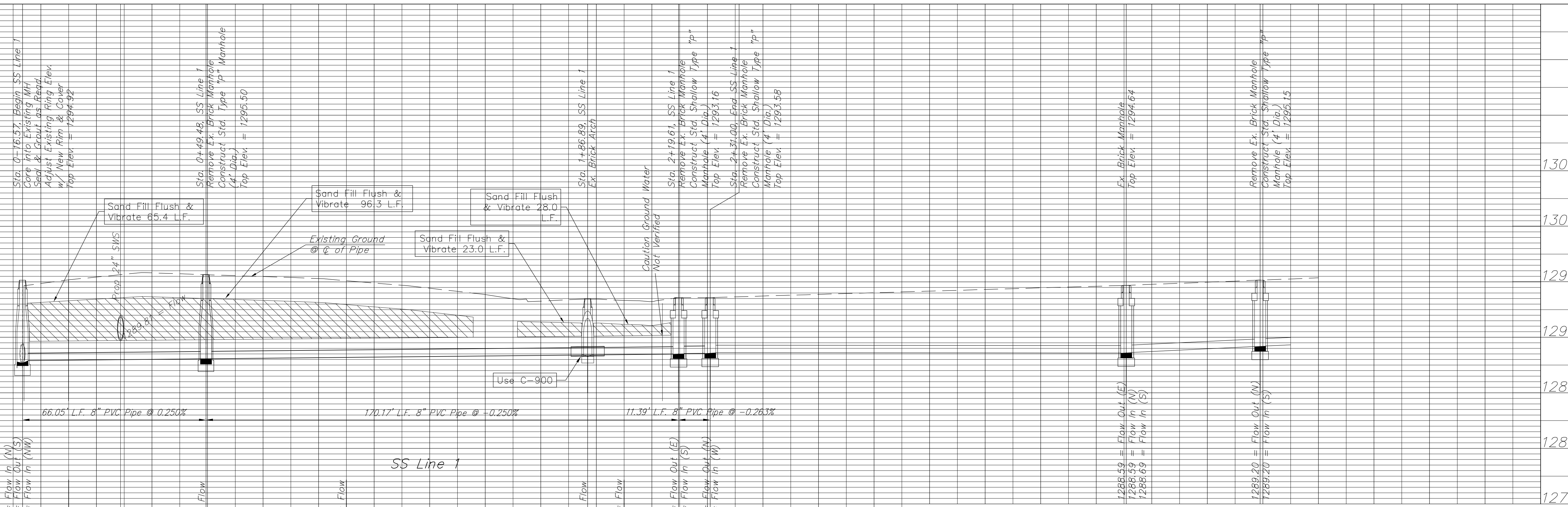
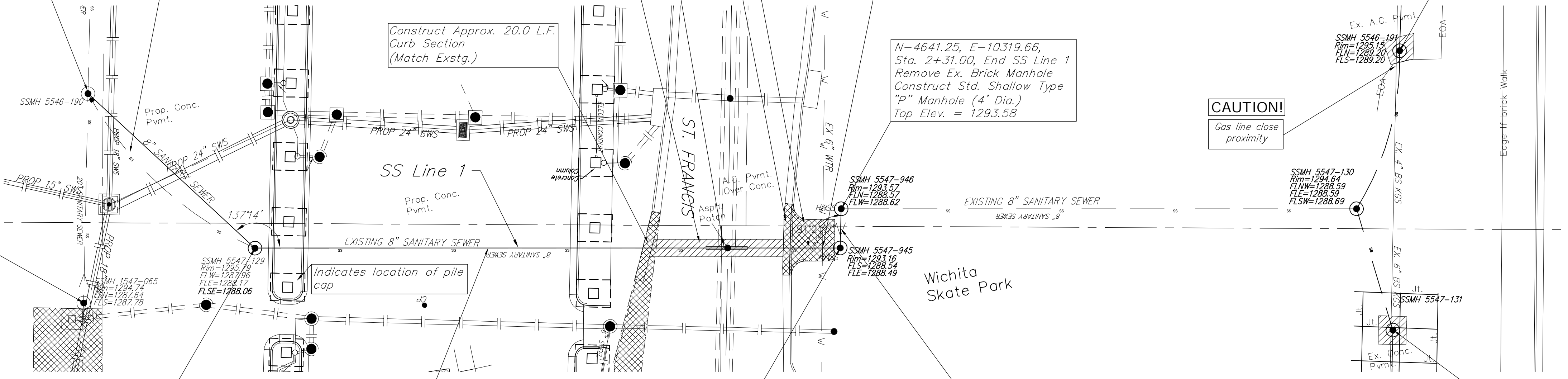
Drawing File: E:\ENG\St.Francis Parking Lot\dwg\SFP SS Plan.dwg (san sewer plan)

Design: TCA
Drawn: TCA
Approved: P/M/JB

Project No. 0904E285

CITY OF WICHITA

SANITARY SEWER REPLACEMENT

ST. FRANCIS PARKING LOT



Baughman Company, P.A.
315 Ellis St. Wichita, KS 67211 P 316-262-7271 F 316-262-0149
ENGINEERING | SURVEYING | PLANNING | LANDSCAPE ARCHITECTURE

July 2009

SHEET
OF 18
31