

BY	DATE

ENTEB
 ARCHITECTS ENGINEERS PLANNERS

This sheet designed by:

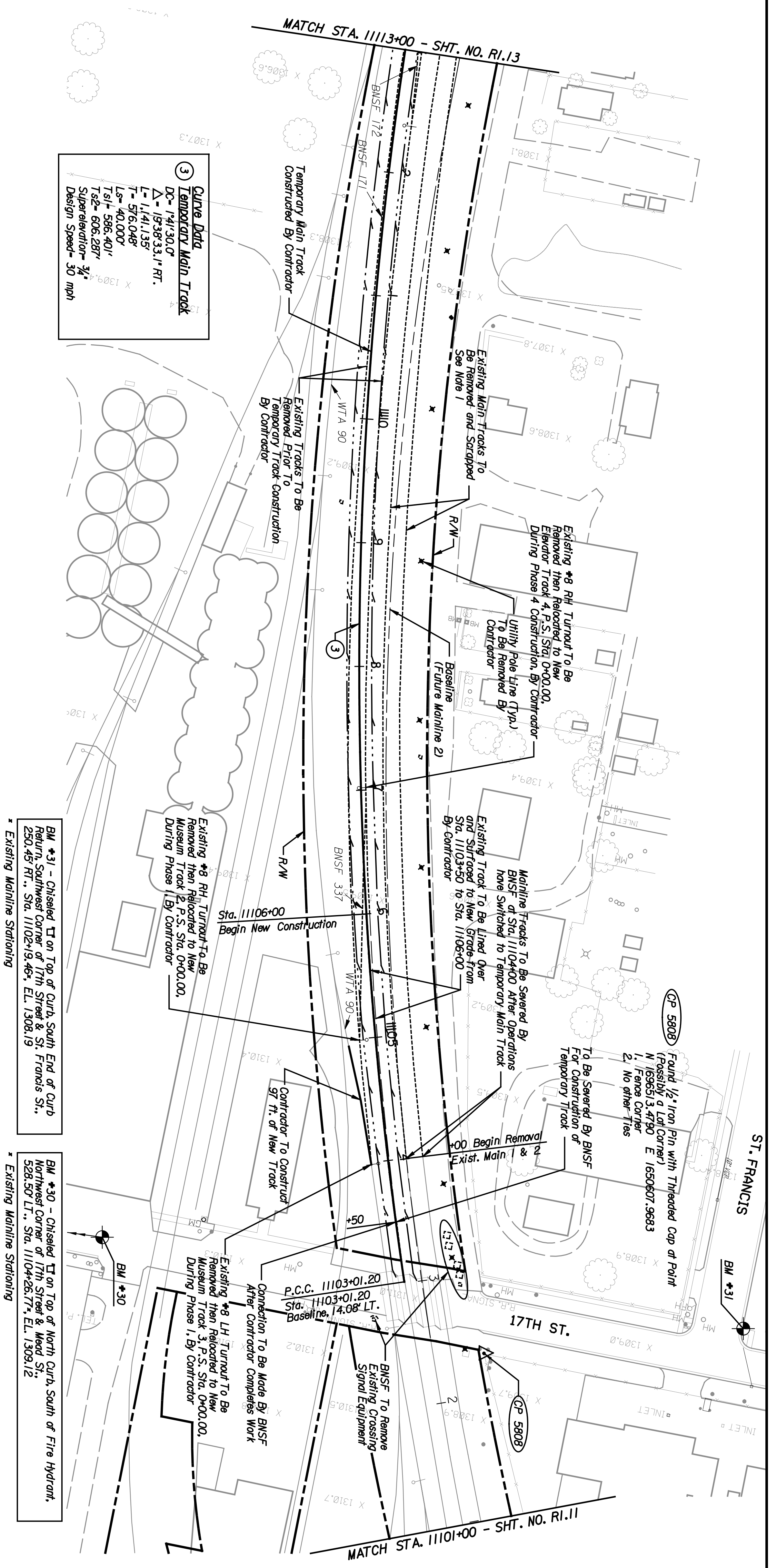
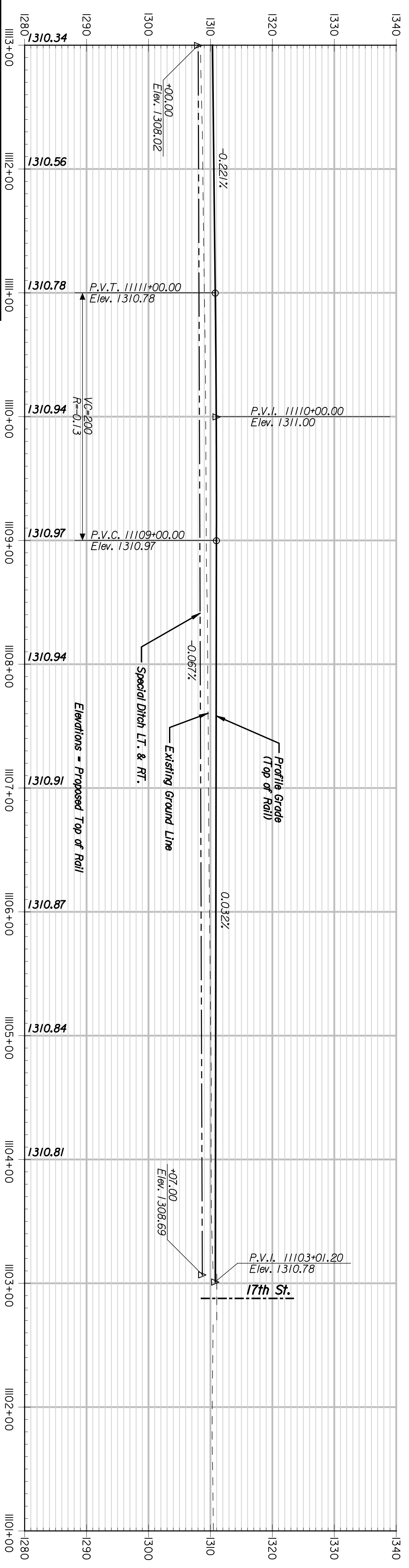

BM *31 - Chiseled \square on Top of Curb, South End of Curb Return, Southwest Corner of 17th Street & St. Francis St., 250.45 RT., Sta. 11102+19.46+ EL. 1308.19
 * Existing Mainline Stationing

BM *30 - Chiseled \square on Top of North Curb, South of Fire Hydrant, Northwest Corner of 17th Street & Mead St., 528.30 LT., Sta. 11104+26.77+ EL. 1309.12
 * Existing Mainline Stationing

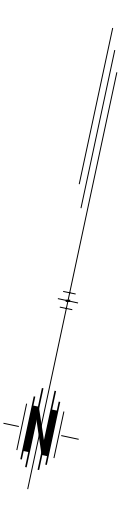

- NOTES:**
1. Removal of Existing Main Tracks to be done by contractor after operations have switched to Temporary Main Track.
 2. Existing RR Signal Equipment to be removed by BNSF.

STATE	PROJECT NO.	YEAR	SHEET NO.	TOTAL SHEETS
KANSAS	472-84071	2005	RI.2	

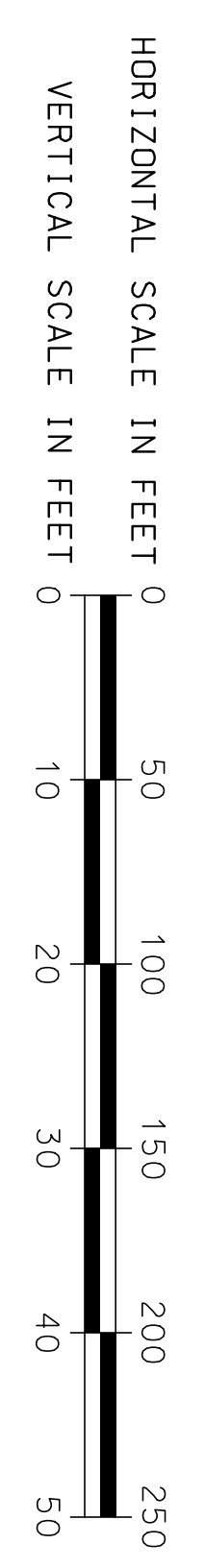

SHEET NO.	OF	SCALE	APPD.
DESIGNED	REP	DETAILED	JDS
DESIGN CR.	RSB	DETAILED CR.	REP

REVISIONS

NO.	DATE	BY	APPD.
1			
2			
3			

CITY OF WICHITA
WICHITA CENTRAL CORRIDOR
PHASE I - TRACK WORK
PLAN AND PROFILE
STA. 1101+00 TO STA. 1113+00