

BY	DATE

ENTR
 ARCHITECTS ENGINEERS PLANNERS

This sheet designed by:

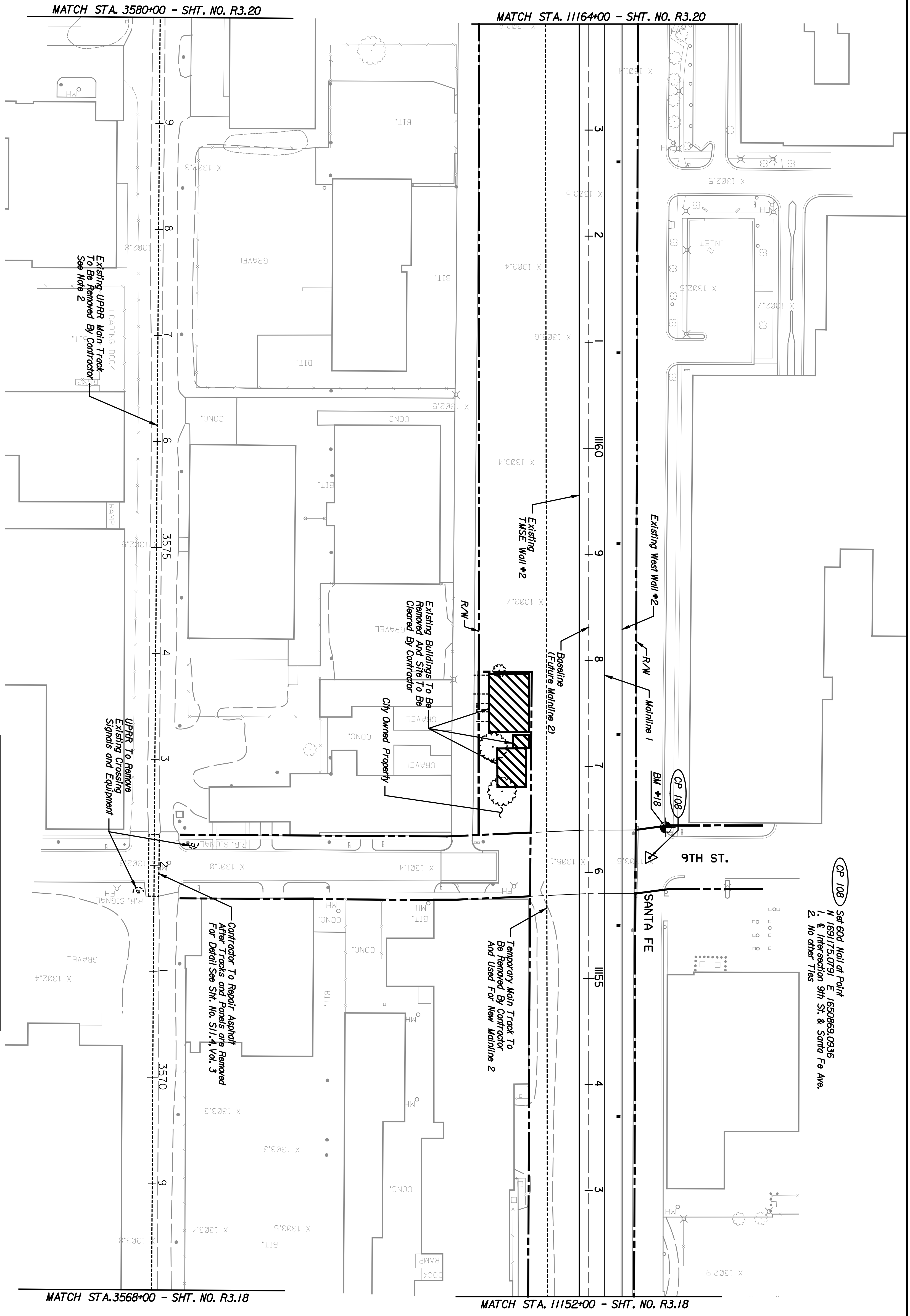

CP 108 Set 804 Nail at Point
 N 1691 / 13,079' E 1650869.0936
 1. E Intersection 9th St. & Santa Fe Ave.
 2. No other Ties

BM #18 - Chisled TI on Northeast Corner of Concrete Sign Base,
 Southwest Corner of Intersection of Santa Fe St. & 9th Street,
 78.29 RT., Sta. 1156+42.69+, EL. 1304.60
 * Existing Mainline Stationing

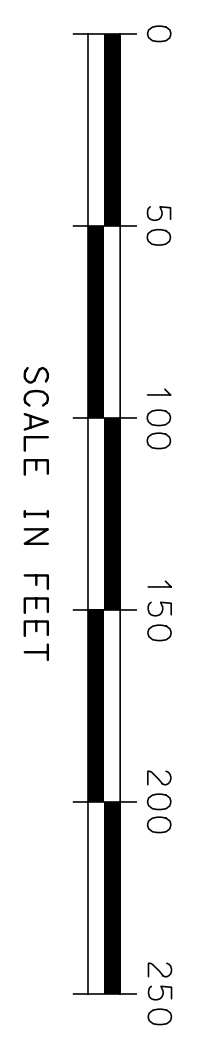

STATE	PROJECT NO.	YEAR	SHEET NO.	TOTAL SHEETS
KANSAS	472-84071	2005	R319	

- NOTES:**
1. Removal of Temporary Main Track to be done by the contractor after operations have switched to New Mainline 1.
 2. Crossing panels on UPRR Main to a site selected by UPRR. This is to be done after operations have switched to New UPRR Main Track.

CITY OF WICHITA		WICHITA CENTRAL CORRIDOR	
PHASE 3 - TRACK WORK		PLAN	
STA. 11152+00 TO STA. 11164+00			
SHEET NO.	DATE	DESIGNED BY	SCALE
1		RSB	AS SHOWN
2			
3			
APPROVED		APPROVED	
DESIGNED BY		CHECKED BY	
DATE		DATE	
NO.		REVISIONS	
		BY	
		APP'D.	