

BY	DATE

PNTEB
 ARCHITECTS ENGINEERS PLANNERS

This sheet designed by:

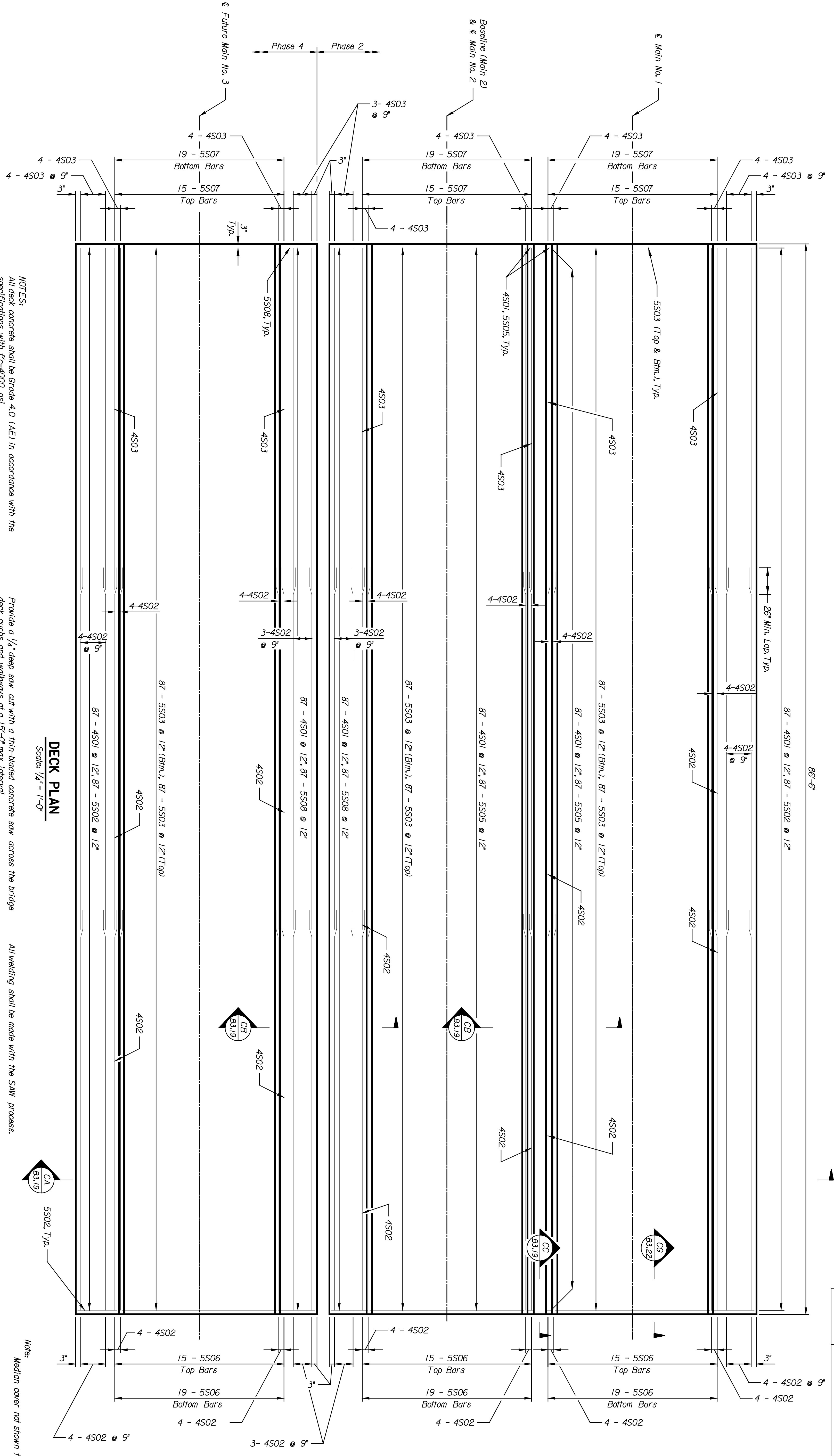

DECK PLAN
 Scale: 1/4" = 1'-0"

NOTES:
 All deck concrete shall be Grade 4.0 (A/E) in accordance with the specifications with $f'c=4000$ psi.
 All reinforcing steel shall conform to ASTM A615, Grade 60.
 All epoxy-coated reinforcing shall conform to ASTM A775.
 All deck, ballast curb and walkway reinforcing shall be epoxy-coated.
 Cast $1/2$ " Dia. holes in walkways for handrail panel connections. See sheet B3.19 & B3.21 for layout & details.
 Exposed concrete edges shall be chamfered $3/4$ ", unless noted otherwise.
 Provide a broom finish on the top surface of the walkway.

Provide a $1/4$ " deep saw cut with a thin-bladed concrete saw across the bridge deck, curbs and walkways at a 15'-0" max. interval.
 Apply an epoxy binder between the deck and walkway support.
 Median covers are subsidiary to deck concrete.
 Steel for median covers shall conform to ASTM A36 or ASTM A709.
 Median covers shall have a raised-diamond pattern and conform to ASTM A786.
 Welding shall conform to the AREMA Manual for Railway Engineering and the Bridge Welding Code, AWS D1.5M/D1.5.

All welding shall be made with the SAW process.
 Median cover plates shall be hot-dipped galvanized in accordance to ASTM A123.
 The bottom surface of median cover plates shall be painted to match the steel girders.
 The bottom of the deck, between girders shall be painted to match the steel girders.
 Concrete surface preparation in accordance with SSPC-SP 3, "Surface Preparation of Concrete"
 Apply two field coats of paint with a water-borne acrylic finish paint, a minimum of 3.0 mils dft/coat.

Notes:
 Median cover not shown for clarity.

SHEET NO.	OF	SCALE	AS NOTED	APP'D.	DESIGNED	C.A.P.	DATE	BY	APP'D.
1	3				DESIGNED	DATE	BY	APP'D.	
<p>CITY OF WICHITA MURDOCK DECK PLAN</p>									

STATE	PROJECT NO.	YEAR	SHEET NO.	TOTAL SHEETS
KANSAS	472-84071	2005	B3.18	