

FHWA REGION NO.	STATE	PROJECT NO.	YEAR	SHEET NO.	TOTAL SHEETS
7	KANSAS	472-84071	2005	S13.2	

**\*\*For Information Only - Bid Item "Pavement Marking" is Paid as Lump Sum.\*\***

Items	Total	Units
Pavement Marking (Thermoplastic) (White) (6")	220	L.F.
Pavement Marking (Thermoplastic) (White) (24")	44	L.F.
Pavement Marking (Thermoplastic) (Yellow) (4")	816	L.F.

**Note:** All existing markings which conflict with the proposed plan shall be removed by grinding or other mechanical means (painting over existing marking will not be allowed.) This work shall be considered Subsidiary to the Bid Item "Street Signage & Marking".

Unless otherwise noted dimensions are from  $\text{\textcircled{C}}$  Stripe to  $\text{\textcircled{C}}$  Stripe.

DATE	
BY	

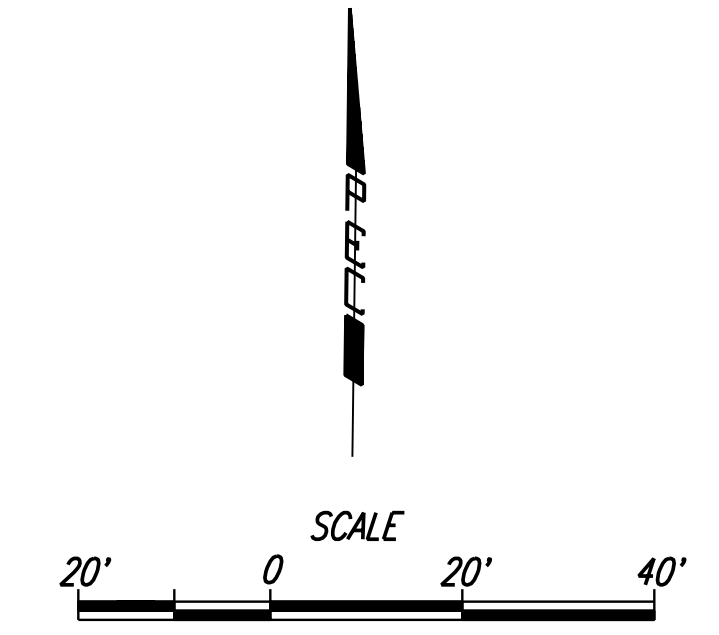

DSNR: RWM OPER: SVB SCALE: 1"=20' 1:/1999/99189/bid set 3/Sheets/S13.2/Plan\_13TH.DGN LAST REV: 4-22-2004 BY: drp

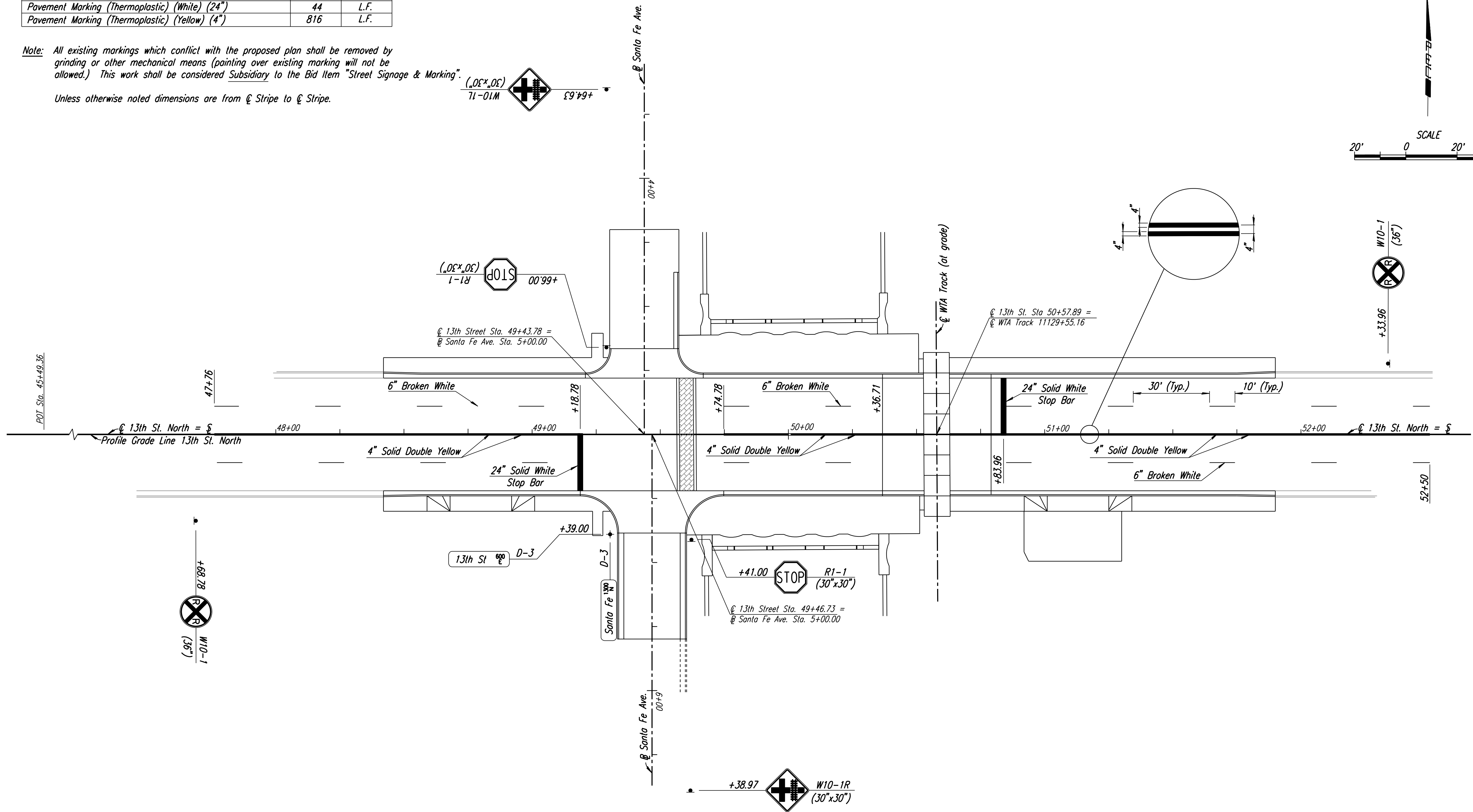

This sheet designed by:

**Professional Engineering Consultants, P.A.**  
 303 S. TOPEKA • WICHITA, KANSAS 67202  
 316-262-2691 • FAX 316-262-3003

3				
2				
1				
NO.	DATE	REVISIONS	BY	APP'D
<b>CITY OF WICHITA</b>				
<b>WICHITA CENTRAL CORRIDOR</b>				
<b>SIGNING &amp; MARKING PLAN</b>				
<b>13TH STREET</b>				
SHEET NO.	SCALE	1"=20'	APP'D	
DESIGNED RWM	DETAILED SVB	QUANTITIES	TRACED	
DESIGN CK.	DETAIL CK.	QUAN. CK.	TRACE CK.	