

	BY	DATE

PNTB
 ARCHITECTS ENGINEERS PLANNERS

This sheet designed by:

- TRAFFIC CONTROL NOTES:**
1. If roadway will be under reduced lane configuration for longer than one week concrete barricades should be used to protect the work zone.
 - 2) All distances are from the Manual for Uniform Traffic Control Devices (MUTCD). The contractor has the ability to propose alternate methods, however they must conform to this manual.
 - 3) These distances are for general layouts and should be considered minimums. Actual placement of signs should be determined in the field to avoid being blocked by other signs or traffic control devices.

NOTE:

The contractor will maintain two lanes in each direction during construction. Temporary closures and reducing traffic to one lane in each direction will be permitted with prior approval from the Engineer.

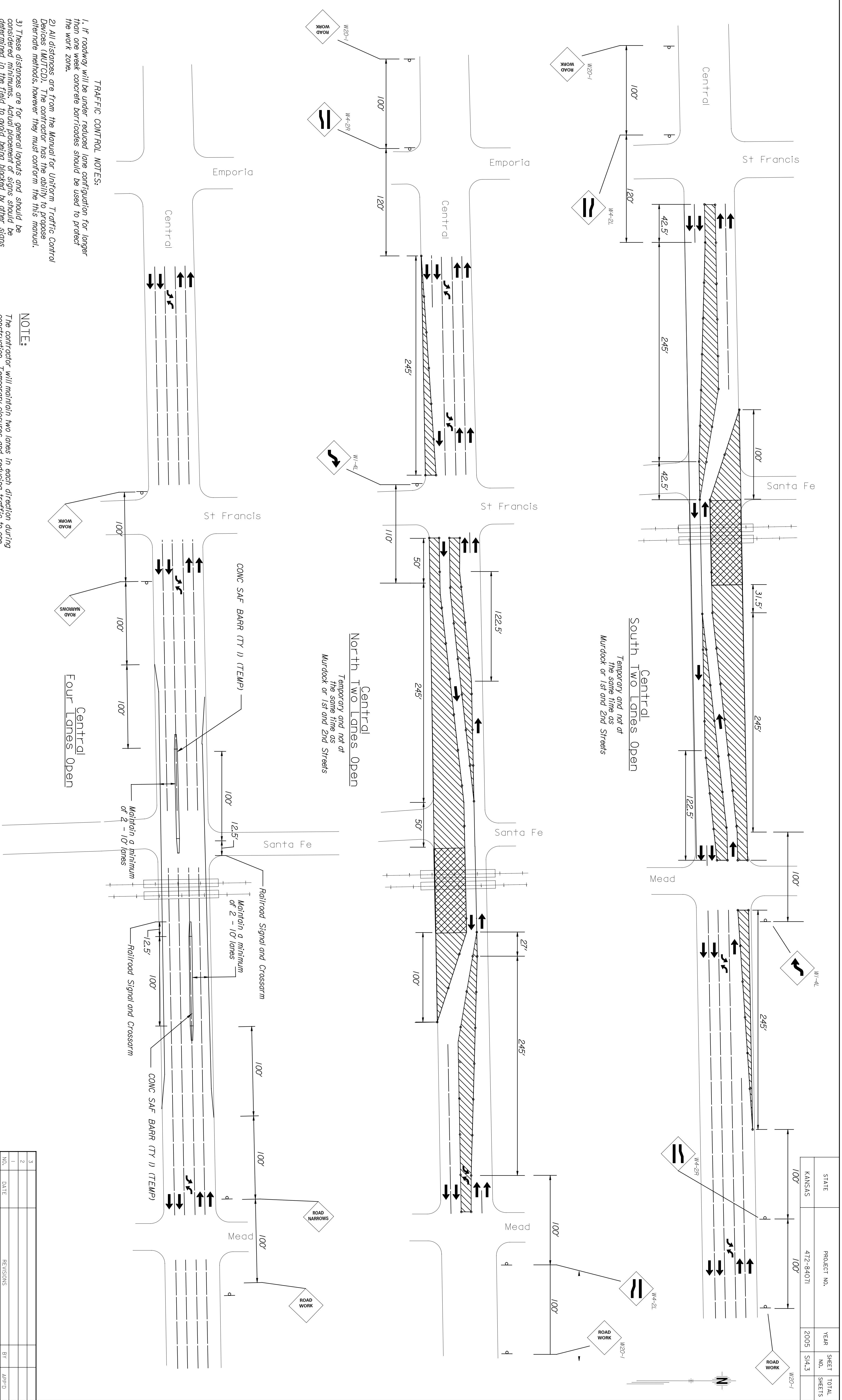

LEGEND

- Work Zone
- Protected Area Channelizers

SHEET NO.	OF	SCALE	APP'D.	TRACED
DESIGNED		DETAILED	QUANTITIES	TRACED
DESIGN CR.		DETAIL CR.	QUANTITIES	TRACED CR.

CITY OF WICHITA	
WICHITA CENTRAL CORRIDOR	
TRAFFIC CONTROL	
CENTRAL	

NO.	DATE	REVISIONS	BY	APP'D.
1				
2				
3				

STATE	PROJECT NO.	YEAR	SHEET NO.	TOTAL SHEETS
KANSAS	472-84071	2005	54.3	