

	BY	DATE

STATE	PROJECT NO.	YEAR	SHEET NO.	TOTAL SHEETS
KANSAS	472-84071	2005	54.5	

TRAFFIC CONTROL NOTES:
 1) If roadway will be under reduced lane configuration for longer than one week concrete barricades should be used to protect the work zone.
 2) All distances are from the Manual for Uniform Traffic Control Devices (MUTCD). The contractor has the ability to propose alternate methods, however they must conform to this manual.
 3) These distances are for general layouts and should be considered minimums. Actual placement of signs should be determined in the field to avoid being blocked by other signs or traffic control devices.

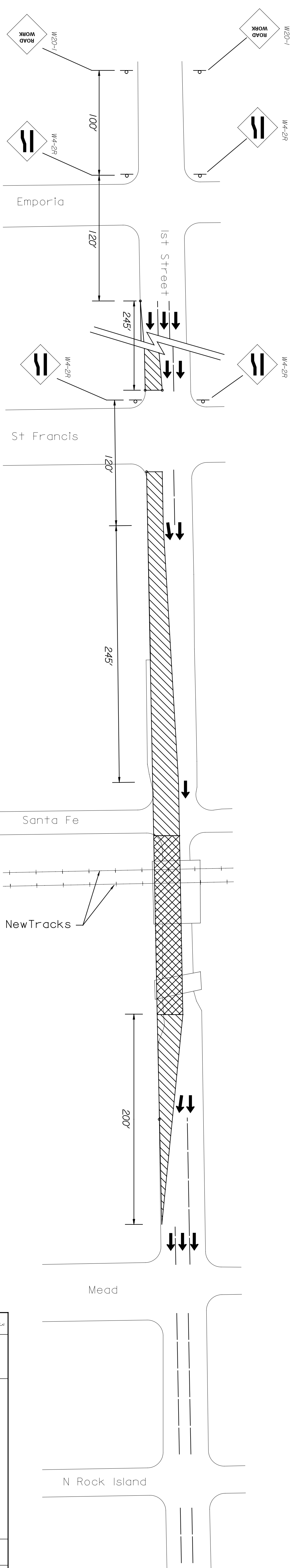
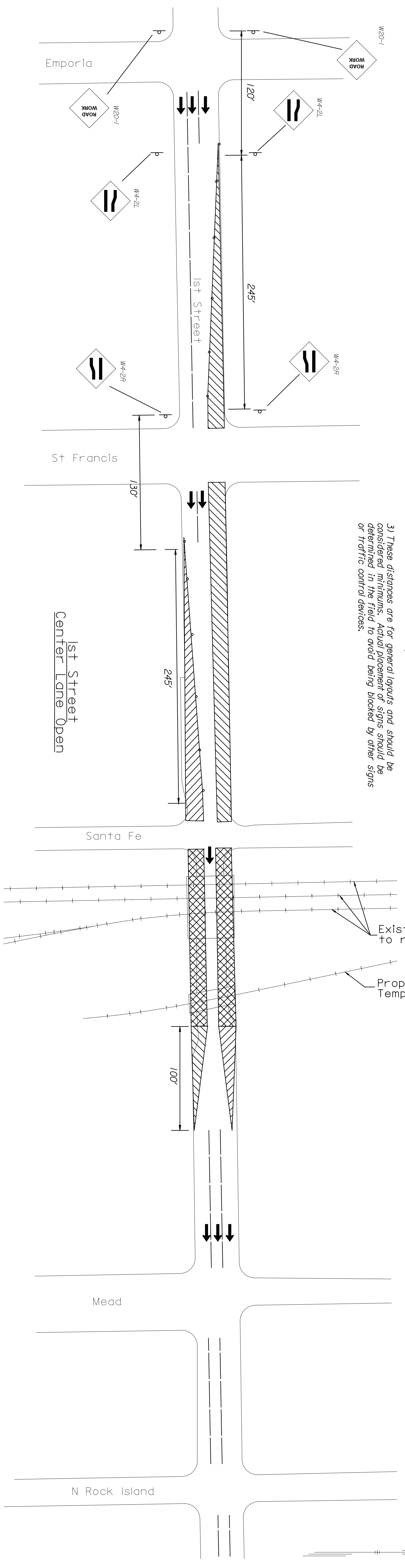

Ist Street
 Outside Lane Open
 Temporary and not at
 the same time as
 Central

LEGEND
 Work Zone
 Protected Area
 Channelizers

PNTB
 ARCHITECTS ENGINEERS PLANNERS

This sheet designed by:

3					
2					
1					
	NO.	DATE	REVISIONS	BY	APPRD.
CITY OF WICHITA					
WICHITA CENTRAL CORRIDOR					
TRAFFIC CONTROL					
1ST STREET					
SHEET NO.	OF	SCALE	APPRD.	QUANTITIES	TRACED
DESIGN CR.		DETAILED		QUANT.	TRACE CR.
DESIGN CR.		DETAILED		QUANT.	TRACE CR.