

FHWA REGION NO.	STATE	PROJECT NO.	YEAR	SHEET NO.	TOTAL SHEETS
7	KANSAS	472-84071	2005	S8.5	

Sta. 0+06.5 SWS Line No. 710  
 Sta. 51+45.00, 30.00' Rt (Bk of Curb)  
 Remove and Reset Curb Inlet  
 Top Elev.=1300.77  
 In=1293.99  
 Install 6.5 L.F. x SWS Pipe RCP 15" (N)  
 Connect to Existing 15" RCP  
 Install Concrete Collar  
 Install 10.0 L.F. x SWS Pipe PVC 8" (NW)  
 Connect to Existing 8" PVC  
 8" PVC In=1294.44 (see note 2)  
 See Sh. No. S6.6 (See Note 1)

JONES ADDITION

CAUTION!  
 Gas Line

CAUTION!  
 24" PCSE  
 Water Line

☉ Murdock Sta. 48+56.34, 30.00' Rt (Bk of Curb)  
 Remove and Reset Inlet  
 Top Elev.=1301.75 (See Note 1)

☉ Murdock Sta. 48+56.32, 30.00' Lt (Bk of Curb)  
 Remove and Reset Inlet  
 Top Elev.=1301.75 (See Note 1)

Notes:

- 1) All material including additional pipe & labor associated with relocating inlets shall be Subsidiary to "Remove and Reset Inlet" bid item.
- 2) All material including additional pipe & labor associated with the connection of the 8" PVC pipe to the inlet and existing pipe shall be Subsidiary to L.F. of "SWS Pipe PVC 8" " bid item.
- 3) For Manhole adjustments, see table on sheet S3.5

DATE	BY

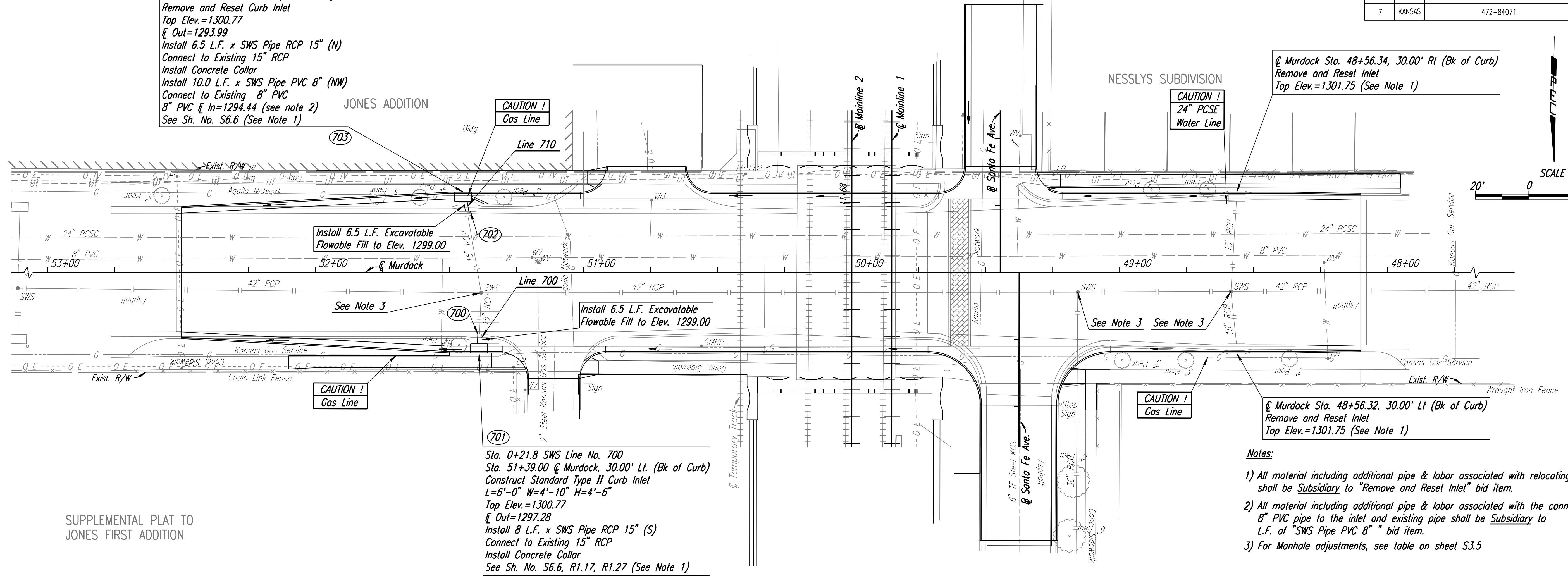

SUPPLEMENTAL PLAT TO  
 JONES FIRST ADDITION

Sta. 0+21.8 SWS Line No. 700  
 Sta. 51+39.00 ☉ Murdock, 30.00' Lt. (Bk of Curb)  
 Construct Standard Type II Curb Inlet  
 L=6'-0" W=4'-10" H=4'-6"  
 Top Elev.=1300.77  
 In=1297.28  
 Install 8 L.F. x SWS Pipe RCP 15" (S)  
 Connect to Existing 15" RCP  
 Install Concrete Collar  
 See Sh. No. S6.6, R1.17, R1.27 (See Note 1)

DSNR: RWM OPER: SDM SCALE: 1:1/1999/99189/bid set 3/SHEETS/S8.5\_SWS\_murdock.DGN LAST REV: 12-10-2003 BY: gdr

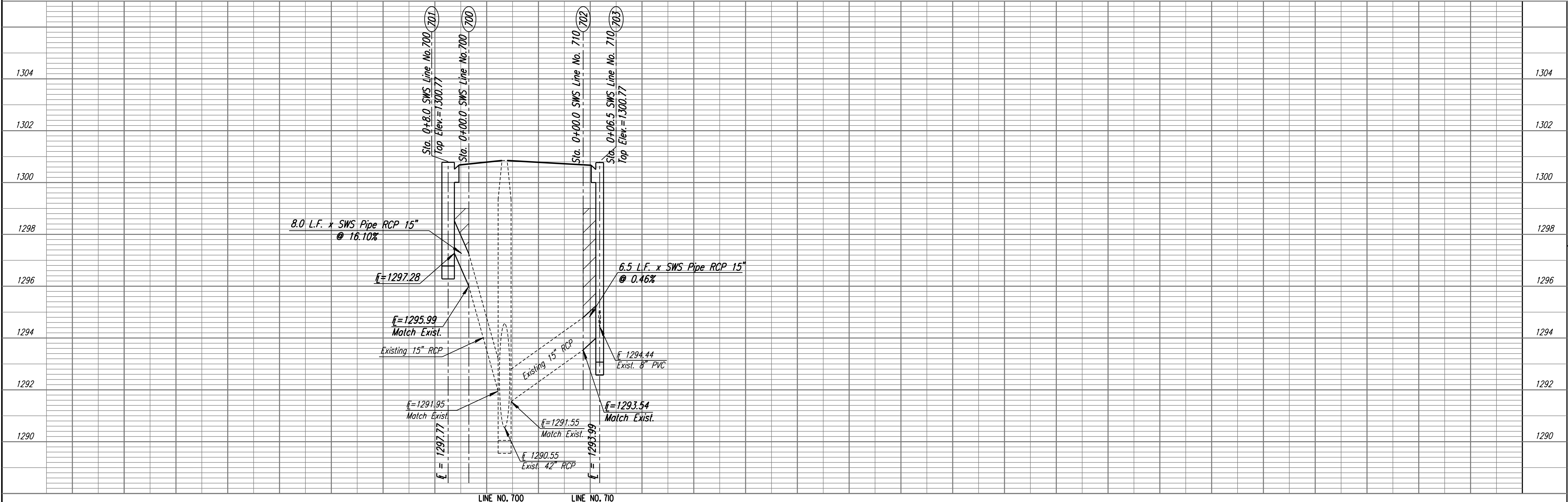

CENTRAL RAIL CORRIDOR  
**STORM SEWER PLAN**  
 MURDOCK STREET  
 LINE NO. 700-710

City of Wichita Project NO. 472-84071

Professional Engineering Consultants, P.A. 303 S. TORBEA • WICHITA, KANSAS 67202 316-262-2661 • FAX 316-262-3003	Job No. 99189
Designed by RWM	Date Oct., 2002
Drawn by SDM	