

DSNR: MDK OPER: DCM SCALE: 1"=400.00
 Q:\1999\99189\004\sewer\Phase 2\SG_2_horiz & vert control 10-22-2003 01:39:34 pm

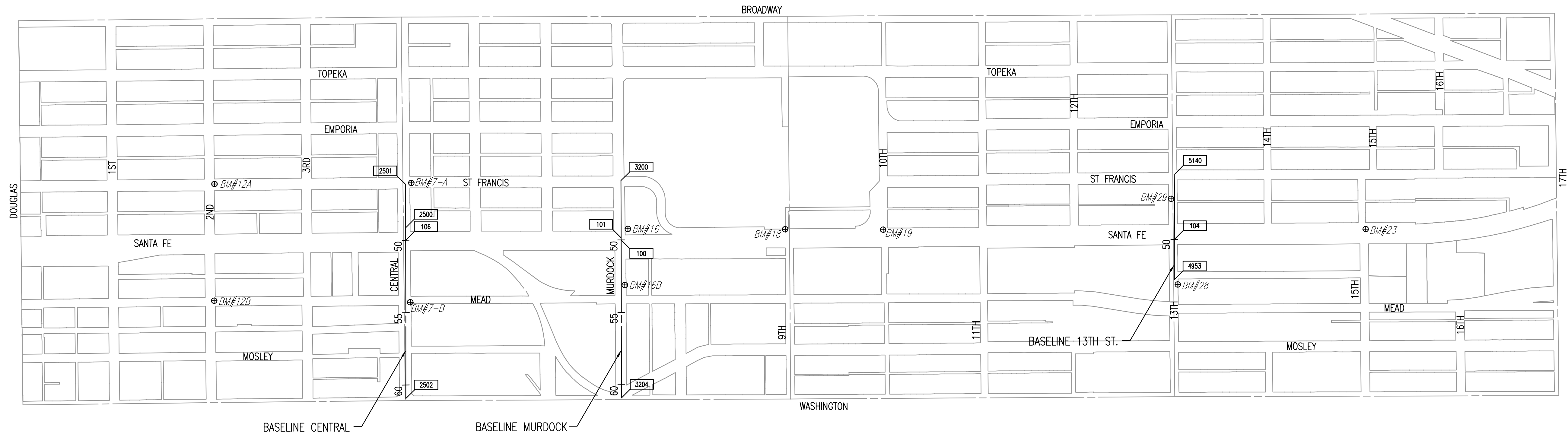

BASELINE CENTRAL

- Pt. No. 2501
 N-1,688,519.6426, E-1,650,589.9145
 @ Central- Sta. 46+13.96
 3/4" Iron Pin in Thimble
 1. @ Central Avenue E-W
 2. East R/W of St. Francis Avenue N-S
 3. No other Ties
- Pt. No. 2500
 N-1,688,525.2636, E-1,650,890.3729
 @ Central- Sta. 49+14.44
 3/4" Iron Pin in Thimble
 1. @ Central Avenue E-W
 2. West R/W of Santa Fe Avenue N-S
 3. No other Ties
- Pt. No. 106
 N-1,688,526.8930, E-1,650,975.9139
 @ Central- Sta. 50+00.00
 1. No Monument Set
- Pt. No. 2502
 N-1,688,547.7085, E-1,652,068.7200
 @ Central- Sta. 60+93.00
 3/4" Iron Pin in Thimble
 1. N 1/4 Corner Sec. 21 T27S R1E E-W
 2. @ Central Avenue E-W
 3. @ Washington Avenue N-S
 4. No other Ties

BASELINE MURDOCK

- Pt. No. 3200
 N-1,690,006.8688, E-1,650,537.2262
 @ Murdock- Sta. 45+89.00
 #5 Bar in Thimble
 1. @ Intersection Murdock & St. Francis E-W
 2. No other Ties N-S
- Pt. No. 101
 N-1,690,014.4827, E-1,650,933.1504
 @ Murdock- Sta. 49+85.00
 1. No Monument Set
- Pt. No. 100
 N-1,690,014.7710, E-1,650,948.1477
 @ Murdock- Sta. 50+00.00
 1. No Monument Set
- Pt. No. 3204
 N-1,690,035.7543, E-1,652,038.8121
 @ Murdock- Sta. 60+90.87
 1/2" Iron Pipe in Thimble
 1. @ Intersection Murdock & Washington Avenues E-W
 2. No other Ties N

BASELINE 13TH ST.

- Pt. No. 5140
 N-1,693,829.0064, E-1,650,426.2598
 @ 13th St.- Sta. 45+49.36
 Iron Pin in Thimble
 1. @ 13th Street E-W
 2. West R/W of St. Francis Avenue N-S
 3. No other Ties
- Pt. No. 104
 N-1,693,834.7117, E-1,650,876.8615
 @ 13th St.- Sta. 50+00.00
 1. No Monument Set
- Pt. No. 4953
 N-1,693,838.2273, E-1,651,154.5202
 @ 13th St.- Sta. 53+38.71
 Iron Pin & Thimble
 1. @ 13th Street E-W
 2. @ Barwise Avenue N
 3. No other Ties

BENCH MARKS

- BM 7-A- "X" Chiseled on Top of the Southeast Bolt of a Traffic Signal Pole Base, Northeast Corner of St. Francis Avenue & Central Avenue. Elev.= 1299.40
- BM #7B- Chiseled "d" on Center of a Storm Drain Curb Inlet, Northeast Corner of Central Avenue & Mead Avenue. Elev.= 1298.53
- BM #12A- Chiseled "d" on East End of Northeast Curb Return, Northeast Corner of 2nd Street & St. Francis Avenue. Elev.= 1298.39
- BM #12B- Chiseled "d" on Top of North Curb on 2nd Street, Northeast Corner of 2nd Street & Mead Avenue. Elev.= 1298.59
- BM #16- Chiseled "d" on Top Curb, North Curb Return of Northwest Corner of Santa Fe & Murdock. Elev.= 1302.46
- BM #16B- Chiseled "d" on Top Center Curb Inlet, North Side of Murdock, 330' East of BNSF RR. Elev.= 1300.04
- BM #18- Chiseled "d" on Northeast Corner of Concrete Sign Base, Southwest Corner of Intersection of Santa Fe Ave. & 9th Street. Elev.= 1304.60
- BM #19- Chiseled "d" on Top of Curb, South Curb Return, Southwest Corner of Intersection of Santa Fe Avenue & 10th Street. Elev.= 1302.83
- BM #23- Chiseled "d" on Top of Curb, West End of Curb Return, Northwest Corner of Santa Fe Avenue & 15th Street. Elev.= 1306.82
- BM #28- Chiseled "d" on East End of Curb Return, Northeast Corner of 13th Street & Barwise Avenue. Elev.= 1303.96
- BM #29- Chiseled "d" on Top of South Curb of 13th Street, 120' East of @ of St. Francis Avenue. Elev.= 1304.71

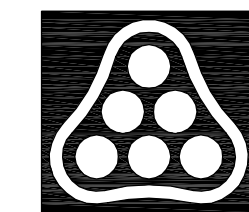

No.	Revision	By	Date
CITY OF WICHITA, KANSAS NEIL D. CABLE, P.E.- CITY ENGINEER CENTRAL RAIL CORRIDOR HORIZONTAL & VERTICAL CONTROL MAP CITY OF WICHITA PROJECT NO. 472-84071 Professional Engineering Consultants, P.A. 303 S. TOPEKA • WICHITA, KANSAS 67202 316-262-2691 • FAX 316-262-3003			
Designed by	MDK	Job No.	34-99189-4
Drawn by	GJR, JLM	Date	September 2002
			Sh. S9.2 of ---