

| | | | | |
|--------|-------------|------|-----------|--------------|
| STATE | PROJECT NO. | YEAR | SHEET NO. | TOTAL SHEETS |
| KANSAS | 472-84071 | 2005 | L19 | |

| ESTIMATE OF SHEET QUANTITIES | | |
|-------------------------------|----------|------|
| ITEM | QUANTITY | UNIT |
| Buffalo Grass 609 | 1016 | SY |
| Riprap (Light Stone) | 28 | SY |
| Poured-in-Place Splash Blocks | 3 | EA |

Legend

- BD - Buffalo Grass 609
- New Poured-In-Place Splash Block
- 10' x 5' Riprap (Light Stone) For Inlet Outfall
- Quantity
- Sod Call Out
- Detail Number
- Detail Sheet

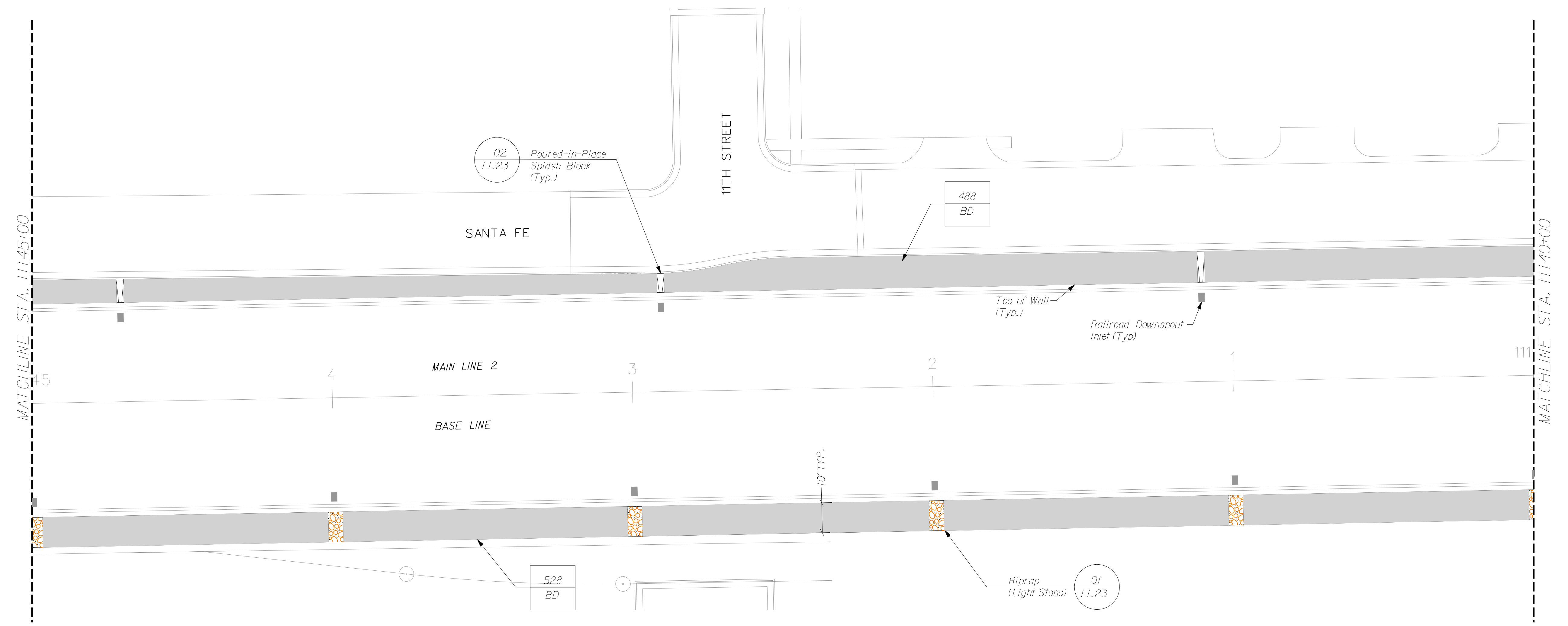

This sheet designed by:

HNTB
ARCHITECTS ENGINEERS PLANNERS

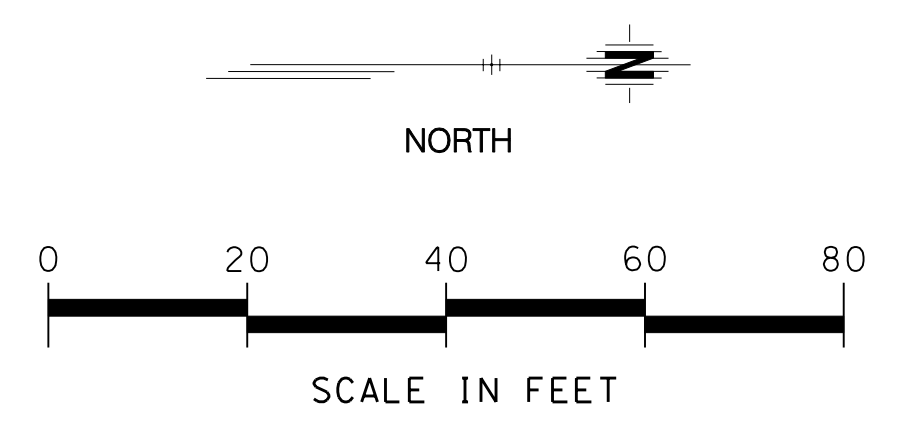

| 3 | | | | |
|--------------------------------------|--------------------|---------------------|------------|-------|
| 2 | | | | |
| 1 | | | | |
| NO. | DATE | REVISIONS | BY | APP'D |
| CITY OF WICHITA | | | | |
| WICHITA CENTRAL CORRIDOR | | | | |
| LANDSCAPE PLAN | | | | |
| STA. 11140+00 - STA. 11145+00 | | | | |
| SHEET NO. 5 OF 20 | SCALE: 1" = 20'-0" | APP'D: | | |
| DESIGNED: JF | DETAILED: JRK, KA | QUANTITIES: JRK, KA | TRACED: | |
| DESIGN CK.: WP | DETAIL CK.: WSN | QUAN. CK.: WP | TRACE CK.: | |