

BY	DATE

**PNTEB**  
 ARCHITECTS ENGINEERS PLANNERS

This sheet designed by:

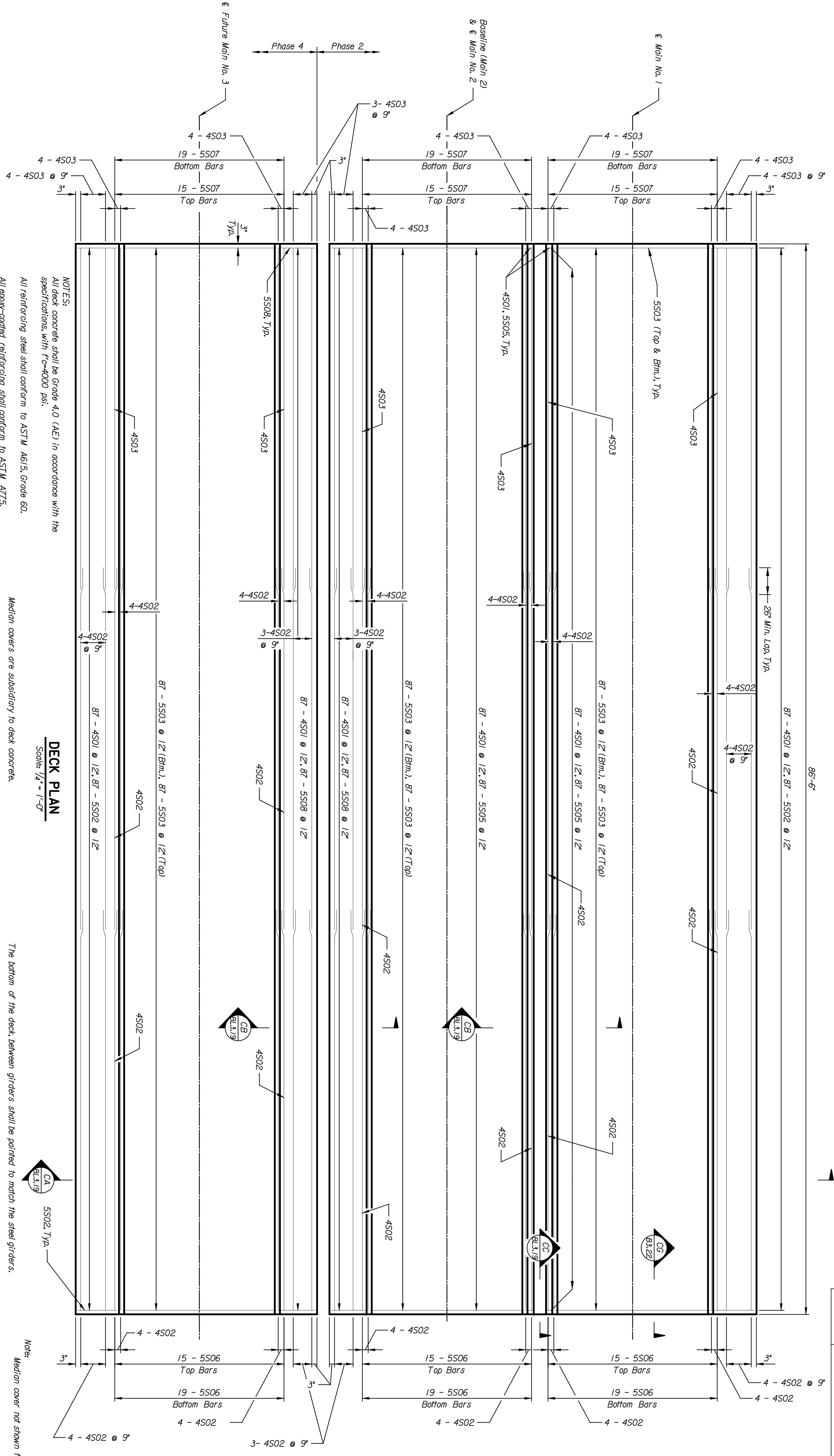

**DECK PLAN**  
 Scale:  $\frac{1}{4}" = 1'-0"$

**NOTES:**  
 All deck concrete shall be Grade 4.0 (AE) in accordance with the specifications with  $f'_c=4000$  psi.  
 All reinforcing steel shall conform to ASTM A615, Grade 60.  
 All epoxy-coated reinforcing shall conform to ASTM A775.  
 All deck, ballast curb and walkway reinforcing shall be epoxy-coated.  
 Cast 1" dia. holes in walkways for handrail panel connection. See sheet BL.3.19 & BL.3.21 for layout & details. Cast embedded plates in walkways for Bridge Handrail Type 1, per layout & details on sheet BL.3.20.  
 Exposed concrete edges shall be chamfered  $\frac{3}{4}$ " unless noted otherwise.  
 Provide a broom finish on the top surface of the walkway.  
 Provide a  $\frac{1}{4}$ " deep saw cut with a thin-bladed concrete saw across the bridge deck, curbs and walkways at a 15'-0" max interval.  
 Apply an epoxy binder between the deck and walkway support.

**DECK PLAN**  
 Scale:  $\frac{1}{4}" = 1'-0"$

Median covers are subsidiary to deck concrete.  
 Steel for median covers shall conform to ASTM A36 or ASTM A709.  
 Median covers shall have a raised-diamond pattern and conform to ASTM A786.  
 Welding shall conform to the AREMA Manual for Railway Engineering and the Bridge Welding Code, AWS D1.5M/D1.5.  
 All weld metal shall be equivalent to the base metal in strength, corrosion resistance and painted appearance.  
 All welding shall be made with the SAW process.  
 Median cover plates shall be hot-dipped galvanized in accordance to ASTM A123.  
 The bottom surface of median cover plates shall be painted to match the steel girders.

NO.	DATE	REVISIONS	BY	APP'D.
1				
2				
3				

**CITY OF WICHITA**  
**WICHITA CENTRAL CORRIDOR**  
**ALTERNATE 5**  
**MURDOCK**  
**DECK PLAN**

DESIGNED	DATE	SCALE	AS NOTED	APP'D.
DRAWN	DATE	BY	QUANTITIES	DATE
CHECKED	DATE	BY	TRACED	DATE
IN CHARGE	DATE	BY	TRACED	DATE

STATE	PROJECT NO.	YEAR	SHEET NO.	TOTAL SHEETS
KANSAS	472-84071	2005	BL.318	