

**CURVE TABLE**

LENGTH	ANGLE	RAD	TAN	P.I. NORTH	P.I. EAST
C6	4°44'21"	61.00	2.92	51317018	510694479
C7	8°13'	192.00	4.07	51316752	51069179
C8	25°42'	23°52'36"	61.00	51316800	51075595
C9	34°79'	16°20'50"	30.50	51314382	51081171
C10	21°56'	53°42'24"	23.00	11.65	51307916
C11	22°04'	54°54'45"	23.00	11.95	51306560

NOTE:  
 ALL NORTHING AND EASTING COORDINATES ARE BASED OFF  
 KDOT'S STANDARD USE OF THE STATE PLANE COORDINATE SYSTEM.

**KDOT PROJ. NO.**  
**54-87 K-8258-01**  
**Sheet No. 163 of 556**

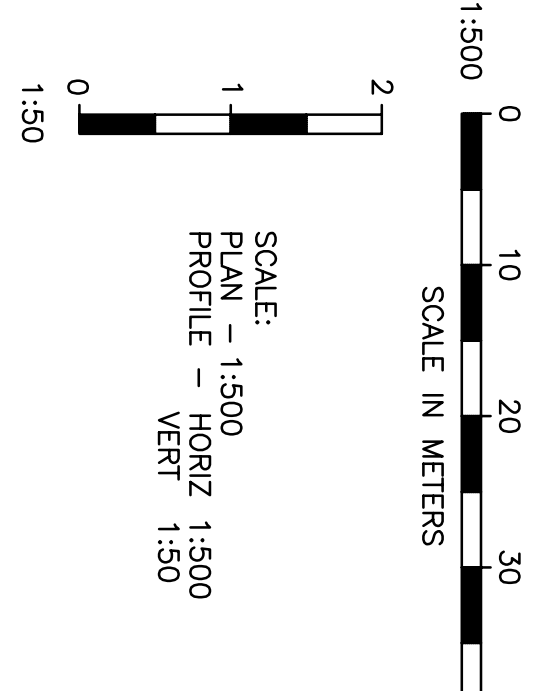

APPROVED FOR  
 CONSTRUCTION

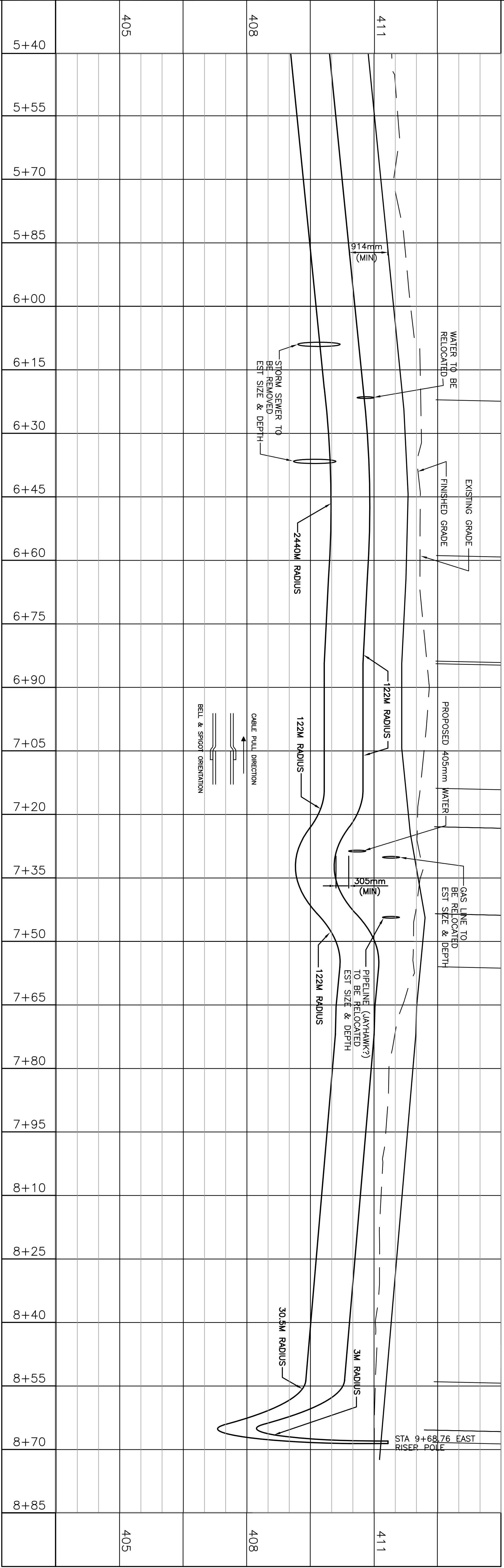

NO	DATE	REVISIONS AND RECORD OF ISSUE
1	03/01/06	ISSUED FOR CONSTRUCTION
0	01/31/05	93% REVIEW ISSUE

PROJECT	DRAWING NUMBER	REV
WESTAR ENERGY COMPANY US HIGHWAY 54/KELLOGG AVENUE PROJECT 69KV UNDERGROUND TRANSMISSION LINE PLAN & PROFILE	136462-WSTR-PP03	1

I HEREBY CERTIFY THAT THIS DOCUMENT WAS  
 PREPARED BY ME OR UNDER MY DIRECT SUPER-  
 VISION AND THAT I AM A DULY REGISTERED PRO-  
 FESSOR IN THE STATE OF KANSAS.

ENGINEER: BLACK & VEATCH  
 CHECKED: FLR DATE: 01/31/05