

- N. 1/4 Cor Sec. 30, T27S, R2E
1. Cross Cut in Top of Light Pole Base 15.859 m S.W.
 2. Cross Cut in Top of Median Curb 15.633 m W.S.W.
 3. Cross Cut in Top of Median Curb 15.619 m E.S.E.
 4. 0.013 m Rebar with Plastic Cap 25.189 m S.S.E.

- Ctr. Cor Sec. 19, T27S, R2E
1. Spike and Washer in Power Pole 15.567 m S.
 2. Cross Cut in Top of Curb 8.028 m N.E.
 3. Cross Cut in Top of Curb 8.701 m S.E.
 4. Cross Cut in Top of Curb 7.007 m S.W.

- Ctr. Cor Sec. 30, T27S, R2E
1. Cross Cut in Top of Sidewalk 21.000 m N.E.
 2. Cross Cut in Top of Curb 12.532 m N.W.
 3. Cross Cut in Cor. of Sidewalk 17.070 m S.W.
 4. Cross Cut in Cor. of Sidewalk 20.962 m S.E.

STATE	PROJECT NO.	YEAR	SHEET NO.	TOTAL SHEETS
KANSAS	54-87 K-8258-01	2007	182	556

SW 1/4 Sec. 19, T27S, R2E

Scale = 1:500
Contour Interval = .5 m

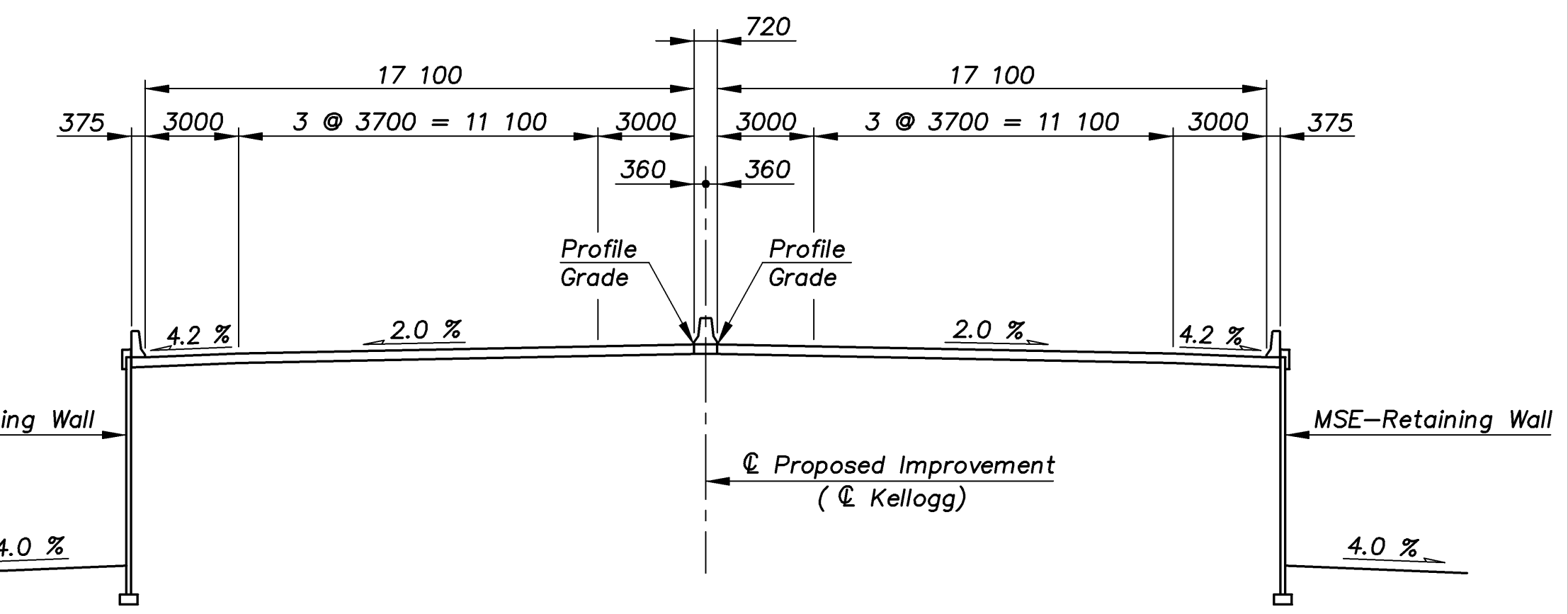
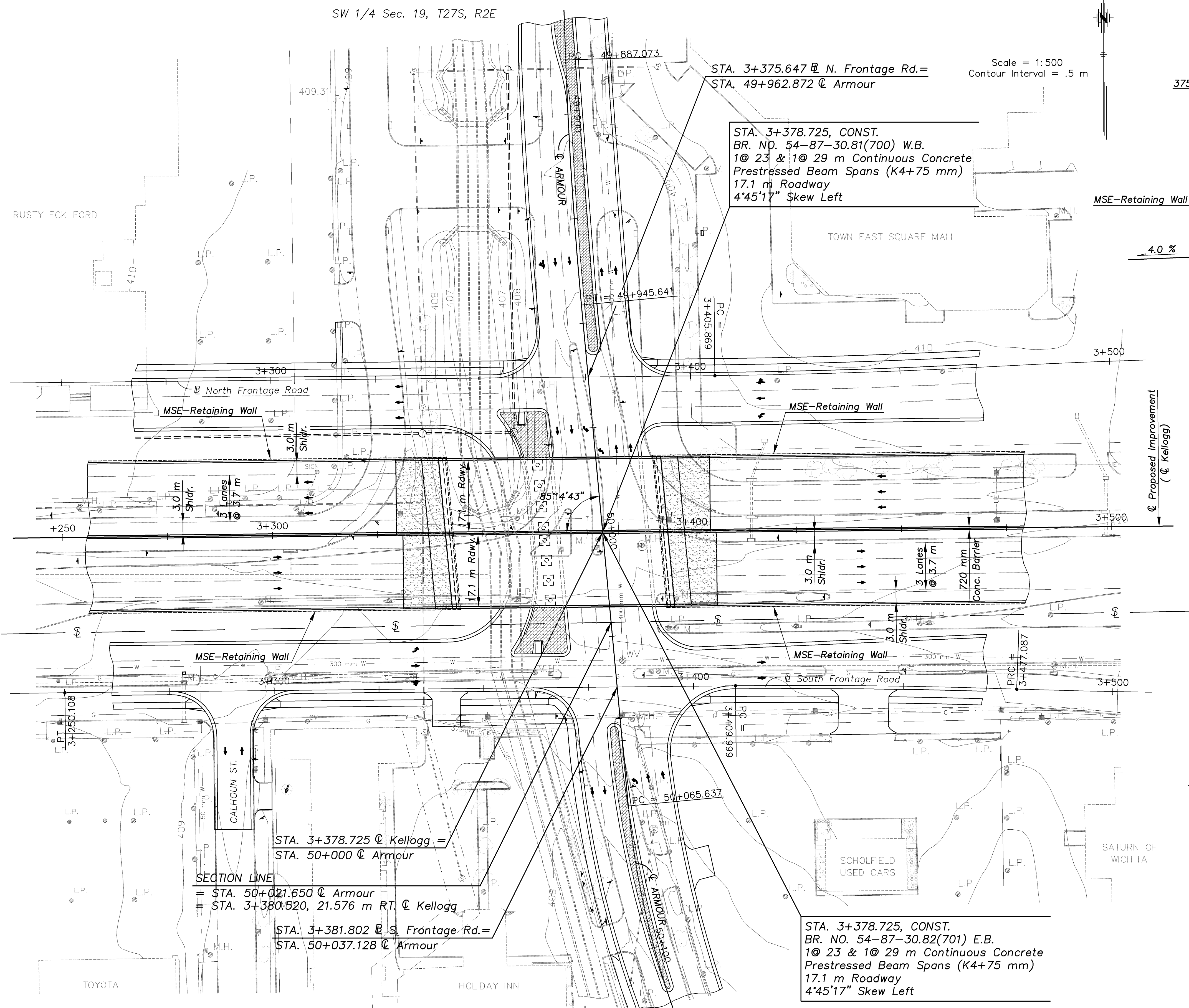

TYPICAL SECTION PROPOSED IMPROVEMENT
(Looking Ahead Station)

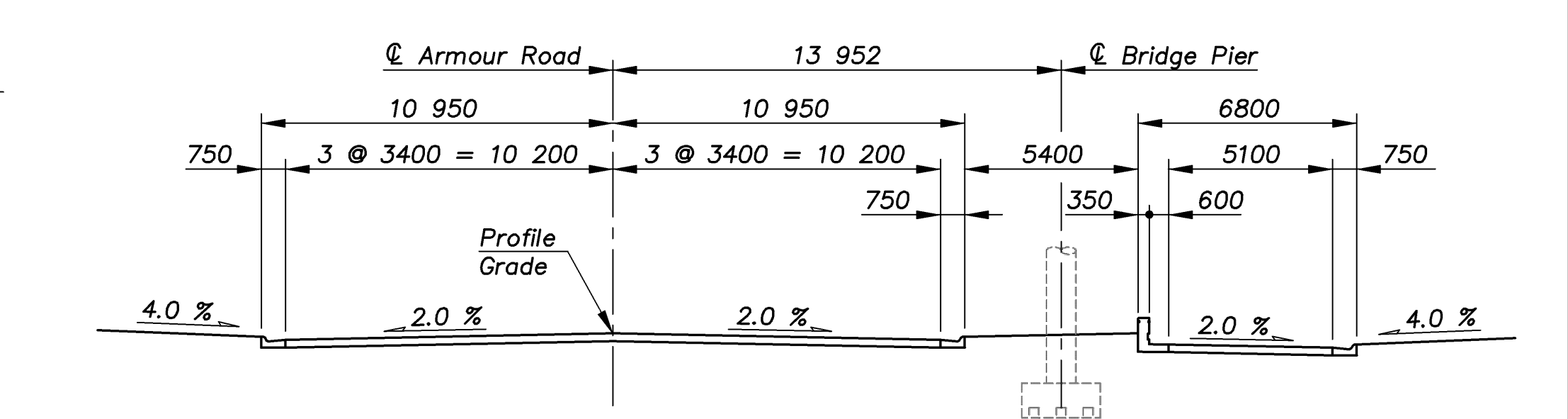

TYPICAL SECTION PROPOSED ARMOUR ROAD
(Looking Ahead Station)

SECTION LINE
 = STA. 50+021.650 $\text{\textcircled{C}}$ Armour
 = STA. 3+380.520, 21.576 m RT. $\text{\textcircled{C}}$ Kellogg
 = STA. 3+378.725 $\text{\textcircled{C}}$ Kellogg =
 STA. 50+000 $\text{\textcircled{C}}$ Armour
 = STA. 3+381.802 $\text{\textcircled{C}}$ S. Frontage Rd.=
 STA. 50+037.128 $\text{\textcircled{C}}$ Armour

STA. 3+378.725, CONST.
 BR. NO. 54-87-30.82(701) E.B.
 1@ 23 & 1@ 29 m Continuous Concrete
 Prestressed Beam Spans (K4+75 mm)
 17.1 m Roadway
 4'45'17" Skew Left

BM #15 - "a" Cut S.W. Cor. Bridge 26.3 m W. & 12.6 m S.
 of $\text{\textcircled{C}}$ of Intersection of Kellogg Avenue and Armour Road
 27.6 m Rt. Armour $\text{\textcircled{C}}$ Sta. 49+925.087 Elev. = 409.006

NW 1/4 Sec. 29, T27S, R2E

BM #16 - "a" Cut Top of Curb on the E. Curb Line of the
 Men's Warehouse, 35.0 m N. of $\text{\textcircled{C}}$ of N. Frontage Road
 42.9 m Lt. $\text{\textcircled{C}}$ Sta. 3+504.400 (Kellogg) Elev. = 410.195

KANSAS DEPARTMENT OF TRANSPORTATION
 BR. NO. 54-87-30.81(700) W.B. STA. 3+378.725
 BR. NO. 54-87-30.82(701) E.B.

CONTOUR MAP
 KELLOGG AVENUE OVER ARMOUR ROAD
 Proj. No. 54-87 K-8258-01 SEDGWICK COUNTY

CFS
 Cook, Flatt & Strobel
 ENGINEERS, P. A.
 DESIGNED R.S.C. SCALE 1:500
 DETAILED T.R.G. DATE
 QUANTITIES T.R.G. SHEET 2 OF 39

ARMOUR/CONTOUR 1:500