

STATE	KDOT PROJECT NUMBER	YEAR	SHEET NUMBER	TOTAL SHEETS
KANSAS	54-87 K-8258-01	2007	313	556
			LS-8	

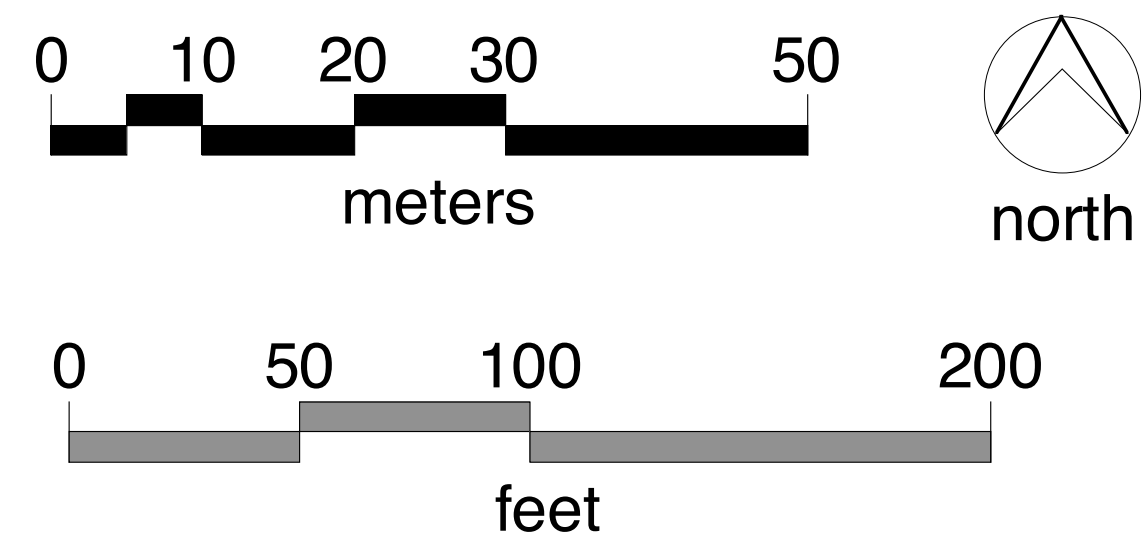

Key

- Steel Plant Bed Edging
- - - Denotes Berm Shape (Note: NOT Contour Line)
- ▨ Decorative Paving
- ▩ Mulch
- ▭ Fescue Sod — Irrigated
- ▨ Fescue Seed — Not Irrigated
- ▨ Bermuda Sod — Not Irrigated
- ▨ Bermuda Sod — Repair Damage

NOTE:
Landscape and irrigation east of Eastern to be developed as part of future project.

CHECKED BY	DATE
DWF	07/24/06
DWF	10/04/06

Match Line to Sheet LS-7
Station Point 4+850

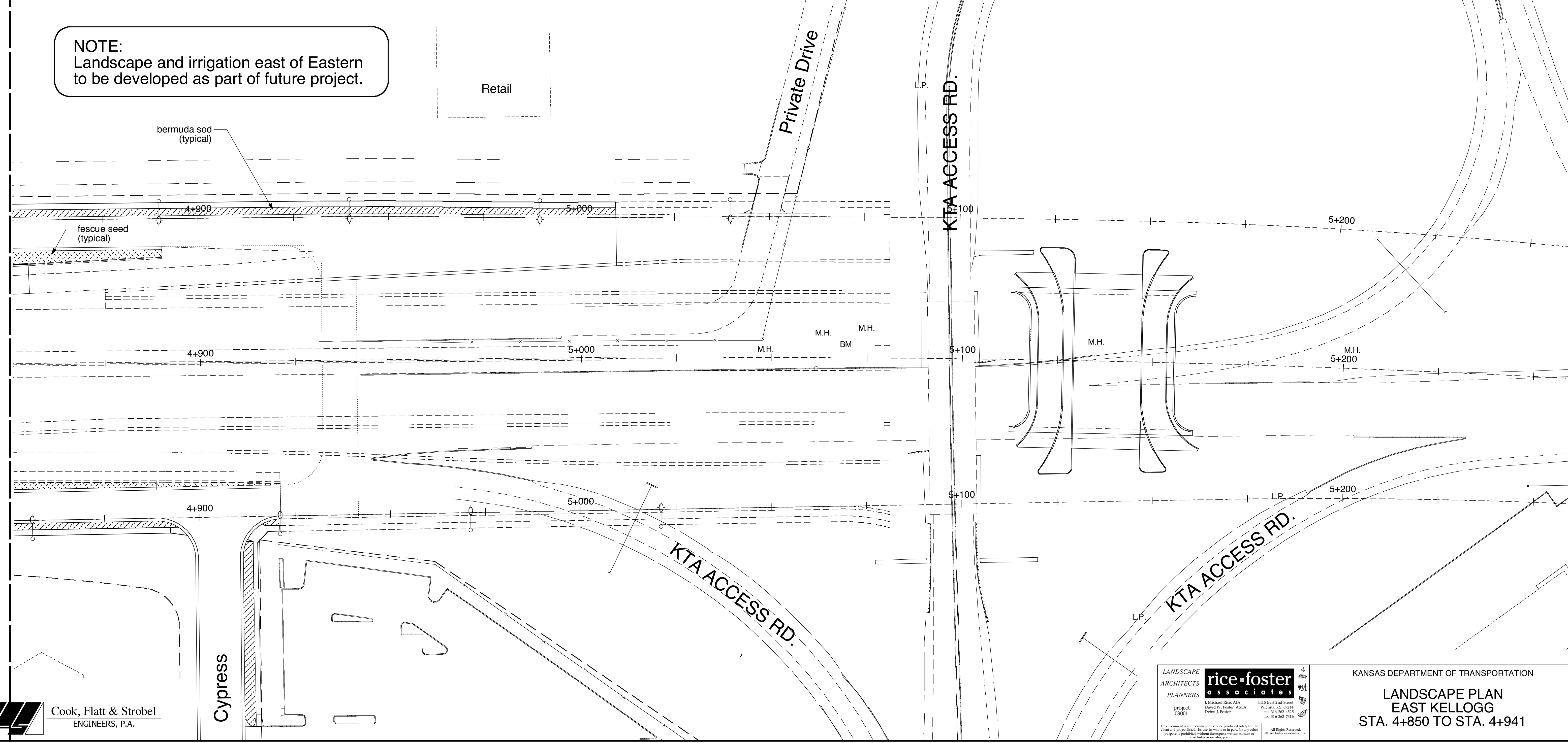

Drawn by: DJF
File: 03001 kelloggrock

Plotted: 10/06/06
SCALE: 1:500

Cook, Flatt & Strobel
ENGINEERS, P.A.

Cypress

LANDSCAPE ARCHITECTS PLANNERS
rice-foster associates
project 03001
1 Michael Rice, AIA
David W. Foster, ASLA
Deline J. Foster
1415 East 2nd Street
Wichita, KS 67214
tel: 316-262-4525
fax: 316-262-7316

KANSAS DEPARTMENT OF TRANSPORTATION
LANDSCAPE PLAN
EAST KELLOGG
STA. 4+850 TO STA. 4+941

This document is an instrument of service produced solely for the client and project named. It is not to be used for any other purpose without the written consent of Rice-Foster Associates, P.A.
All Rights Reserved.
© Rice-Foster Associates, P.A.