

Drainage Improvements Shadybrook Farm Addition

PROJECT NO. 468-84690

OCA # 133117

GENERAL NOTES

- Contractor will be required to provide a minimum advance notice of seventy-two (72) hours to utility companies prior to starting any excavation as follows:

Kansas One-Call 687-2470 or 811

The Contractor must notify the following in case of an emergency:

Cox Communications	262-0661
Kansas Gas Service	888-482-4950
Westar	383-8600
SBC	1-800-286-8313
City of Wichita Water Department	262-6000
City of Wichita Sewer Maintenance	262-6000

- Underground utility service lines and overhead utility pole lines are to be adjusted as necessary by others prior to construction unless the plans specifically call for their adjustment by the Contractor or unless the plans specifically identify a utility to be adjusted by its owner during construction. Existing utilities and their location, as shown on the plans, represent the best information obtainable for design. Location information has been obtained from the various utility companies and is either from company record drawings or company-provided field locations. The Contractor will be required to work around existing utilities within the right-of-way which do not conflict with proposed construction.
- Rubble from the removal of miscellaneous structures and excess excavation which is to be wasted shall be disposed of on sites to be provided by the Contractor. These sites shall be approved by the Engineer as to suitability, appearance and site location. Locations that, in the opinion of the Engineer, will leave an unsightly appearance will not be approved.
- All disposal sites must be approved by the Kansas Department of Health and Environment. Material either stockpiled or disposed of in a flood plain would require a Kansas State Board of Agriculture permit. Any material dumped in waters of the United States or wetlands is subject to U.S. Corps permitting regulations. Any material buried or stockpiled beyond approved of Engineers construction limits would require additional archeological investigations unless buried in a previously approved borrow location.
- The Contractor shall give all property owners and/or tenants of developed property directly abutting the construction of this project a minimum of ten (10) days advance notice prior to start of construction.
- The Contractor shall resod all disturbed areas upon completion of construction.
- All property corners in conflict with construction shall be reset by a Licensed Land Surveyor prior to completion of this project. Cost shall be subsidiary to the bid item for site clearing and restoration.
- Contractor shall repair all sprinkler systems damaged during construction of this project. Cost shall be subsidiary to the bid item for site clearing and restoration.
- The Contractor shall maintain and restore all Right-of-Way disturbed by this project in accordance with City of Wichita Administrative Regulation 6.5.
- All regrading of swales to be subsidiary to the bid item for "Site Clearing and Restoration". All excess dirt from project must be disposed at the Contractor's expense, cost Subsidiary to "Site Clearing and Restoration".
- All areas disturbed by construction shall be re-sodded per the City of Wichita Standard Specifications.

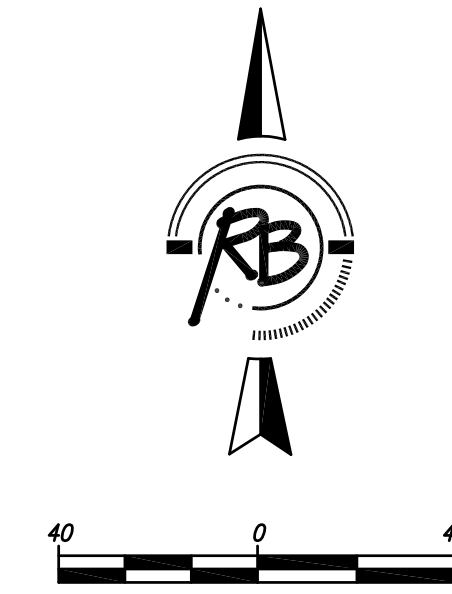
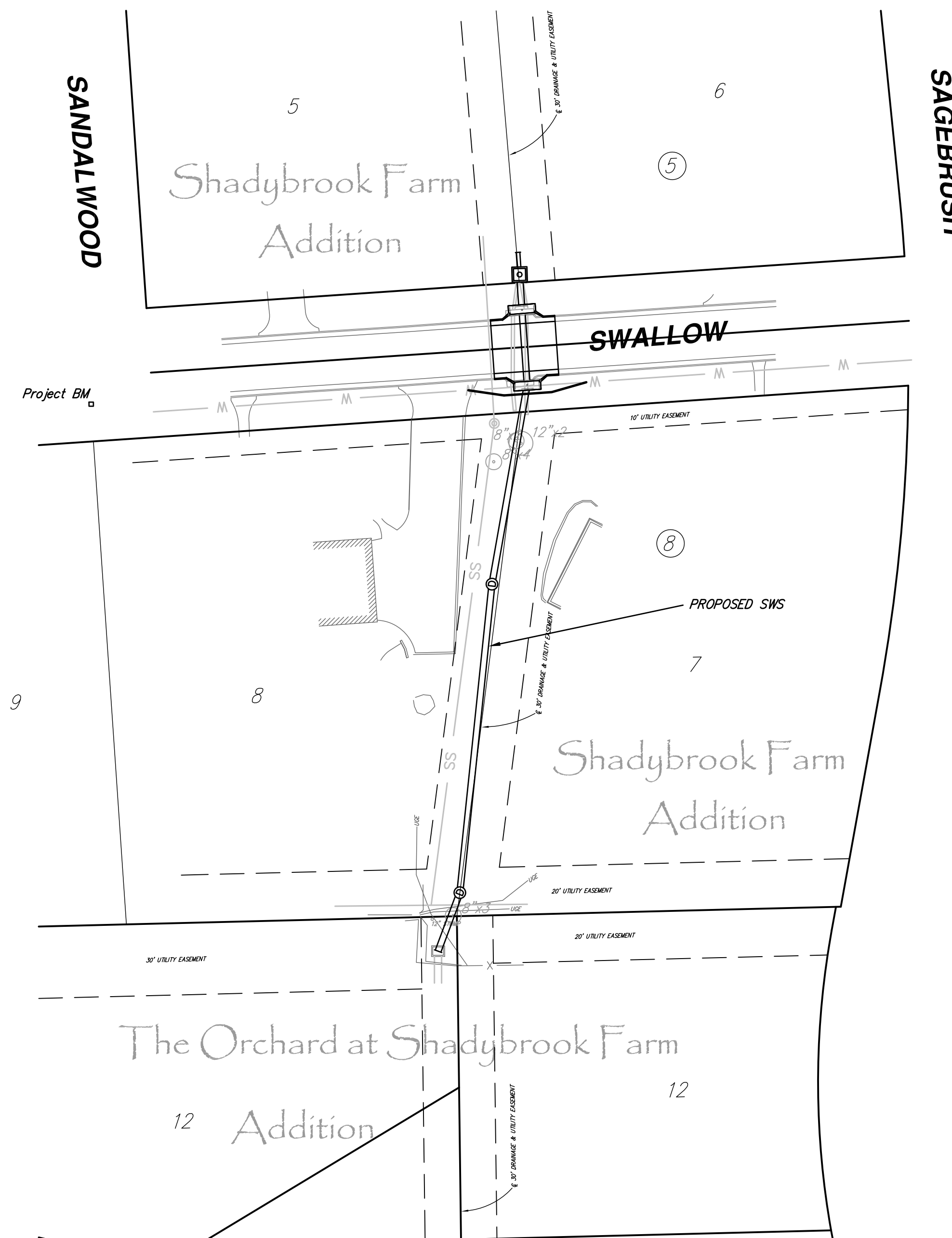

BENCHMARK

BENCH MARK: "□" CUT IN TOP OF CURB AT COMMON LOT LINE, LOTS 8 & 9, BLOCK 8, SHADYBROOK FARM ADDITION

ELEVATION = 1317.43 (NAVD88)

INDEX OF SHEETS

- TITLE SHEET
- STORM SEWER PLAN/PROFILE
- CHANNEL SECTIONS
- TYPE 1A INLET DETAIL
- SHALLOW TYPE P MH W/ BEEHIVE GRATE DETAIL
- TYPE P MANHOLE DETAILS
- INLET MANHOLE SPECIAL DETAILS
- PAVING DETAILS
- EROSION CONTROL PLAN
- 10-11. WATER ASSEMBLY DETAILS
12. WATER ASSEMBLY DETAILS

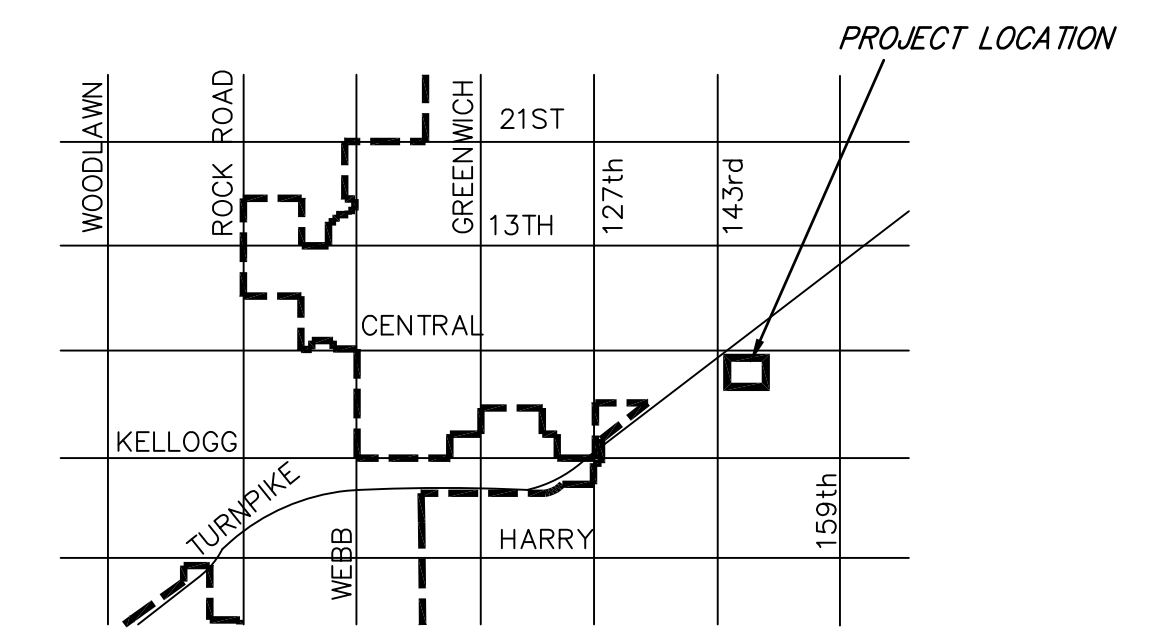

VICINITY MAP



CITY OF WICHITA, KANSAS
JAMES L. ARMOUR, P.E. - CITY ENGINEER

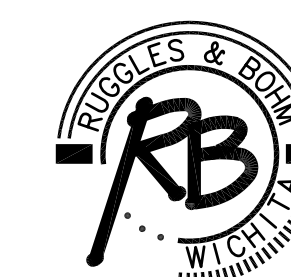

Ruggles & Bohm, P.A.

Engineering, Surveying, Land Planning

924 North Main (316) 264-8008
Wichita, Kansas 67203 (316) 264-4621 fax
www.rbkansas.com E-mail: info@rbkansas.com