

FHWA REGION NO.	STATE	PROJECT NUMBER	FISCAL YEAR	SHEET NUMBER	TOTAL SHEETS
X	KANSAS	X	X		X

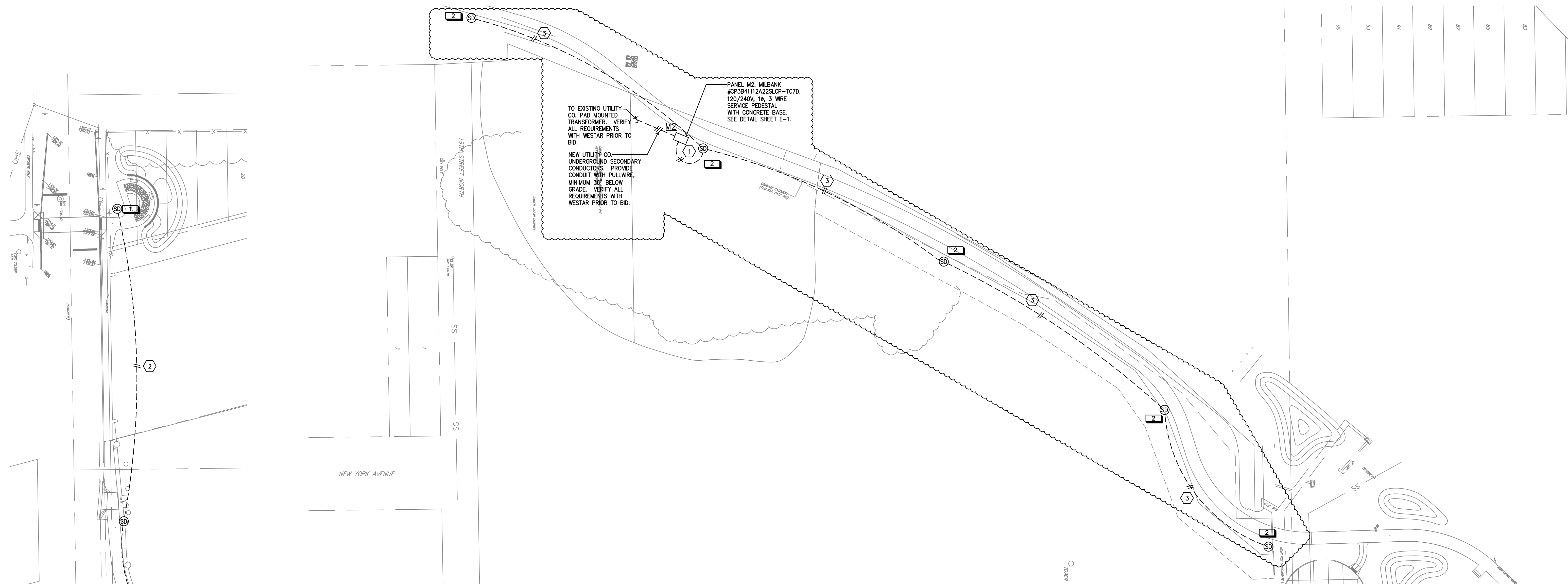

**(B) ELECTRICAL LIGHTING PLAN- 19TH STREET**  
Scale 1"= 40'-0"

PLAN NOTES	
SYMBOL	DESCRIPTION
1	DOUBLE HEADED FIXTURE "SC" IS TO BE MOUNTED BETWEEN NORTH AND SOUTH BOND LANES OF HIGHWAY 135. E.C. IS TO VERIFY MOUNTING REQUIREMENTS WITH THE CITY OF WICHITA PRIOR TO BID.
2	FIXTURES TO BE 3 FEET FROM THE EDGE OF THE BIKE PATH PAVEMENT

FEEDER SCHEDULE					
FEEDER IDENT.	CONDUCTORS		GROUND SIZE	ISOLATED GRD. SIZE	CONDUIT SIZE
	SETS	QUANT. PER SET	PER SET	PER SET	PER SET
1	1		CABLE BY WESTAR		2"
2	1	2	#6	#10	1"
3	1	2	#8	#10	1"

**(A) ELECTRICAL LIGHTING PLAN- 17TH STREET**  
Scale 1"= 40'-0"



**Integrated Consulting Engineers, Inc.**  
10058.00-041  
2604 W 9th St. • Ste. 100 • Wichita, KS 67203  
316-264-3598 • 316-264-3948 • iceng@iceng.com

**ELECTRICAL CUT SHEETS**  
**I-135 NORTH BIKE PATH**  
**WICHITA, KANSAS**

**Ruggles & Bohm, P.A.**  
Engineering, Surveying, Land Planning  
924 North Main  
Wichita, Kansas 67203  
www.rbkansas.com  
(316) 264-8008  
(316) 264-4621 fax  
E-mail: info@rbkansas.com

DESIGN ICE  
DRAWN ICE  
REVIEW ICE  
UTILITY  
DATE OCT 13, 2010

DRAWING FILE PROJECT NUMBER SHEET NO. OF TOTAL SHEETS  
E-4 OF 6