

STORM WATER DRAIN #368

to serve

SILVERTON ADDITION - PHASE IV

CITY OF WICHITA, KANSAS

James L. Armour, P.E. City Engineer

Project Number

468-84681

O.C.A. Number

751490



Scale: 1" = 150'

Sheet Index

Title Sheet	1
Mass Grading Plan	2
Pond Plan	3
Mass Grading Details	4
Erosion Control Plan	5
Erosion Control Details	6-9
Coordinate Sheet	10-11
Pond Cross Sections	12-13
Copy of Plat	14-15

GENERAL NOTES:

- Contractor will be required to provide notice to utility companies a minimum of forty-eight (48) hours prior to any excavation, as follows:
Kansas One-Call 687-2470
The Contractor must notify the following in case of an emergency:
Cox Communications 262-4270
Kansas Gas Service 1-888-482-4950
Westar Energy 383-8650
Aquila Energy 1-800-303-0357
SBC 268-2245
City of Wichita Water Dept. 268-4563
City of Wichita Sewer Maint. 268-4024
City of Wichita Storm Sewer Maint. 268-4090
Conoco Phillips Pipeline Co. 268-4034
Southern Star Pipeline Co. 1-877-267-2290
Kinder-Morgan Pipeline Co. 529-6600
1-888-844-5658
- Utility service lines, poles, valve boxes, meters, and etcetera are to be adjusted as necessary by others prior to construction unless the plans specifically call for their adjustment by the Contractor or unless the plans specifically identify a utility to be adjusted by its owner during construction. Existing utilities and their location, as shown on the plans, represent the best information obtainable for design. The Contractor will be required to work around existing utilities within the right-of-way which do not conflict with proposed construction.
- Rubble from the removal of miscellaneous structures and excess excavation which is to be wasted shall be disposed of on sites to be provided by the Contractor. These sites shall be approved by the Engineer as to suitability, appearance and site location. Locations, in the opinion of the Engineer, that will leave an unsightly appearance will not be approved. All disposal sites must be approved by the Kansas Department of Health and Environment. Material either stockpiled or disposed of in a flood plain would require a Kansas State Board of Agriculture permit. Any material dumped in waters of the United States or wetlands is subject to U.S. Corps. of Engineers permitting regulations. Any material buried or stockpiled beyond approved construction limits would require additional archaeological investigations unless buried in a previously approved borrow location.
- Trees and shrubs in public right-of-way which are in direct conflict with proposed new construction shall be removed by the Contractor with the Engineer's approval. Trees and shrubs which are not in direct conflict with proposed new construction shall be saved and protected from damage.
- The Contractor shall give all property owners and/or tenants of developed property abutting the construction of this project a minimum of ten (10) days notice prior to start of construction.
- The Contractor shall be responsible for preserving property irons. The Contractor will be required to re-establish any property irons which are damaged or destroyed by his construction operations. Such irons shall be re-established by a licensed land surveyor in accordance with state laws.
- All existing and proposed erosion control measures including silt fencing, erosion control mat, straw bales, inlet barriers, and const. entrance shall be maintained throughout construction by the contractor and until project is accepted by the City of Wichita. The on-site engineer shall complete weekly reports on the status of erosion control measures. The contractor shall be required to comply with maintenance and/or replacement of erosion control measures as determined by the on-site engineer until project is accepted by City of Wichita.
- This project is subject to a current Storm Water Pollution Prevention Plan. Contractor shall comply with any requirements as necessary for the site to be in compliance during construction.
- The Contractor shall not start work on the project until the Project Inspector is assigned to the project and is present on the site. Any work done without inspection will be required to be uncovered for inspection.
- All areas disturbed by construction shall be seeded as indicated on Pond Plan. All costs associated with seeding shall be included in bid item "Project Seeding"
- Excess excavation shall remain on site and be spread evenly on lots outside of easements and R/W's.
- At the conclusion of construction, an as-built survey will be completed by the Engineer. The Contractor will be required to finish and smooth grade all locations as necessary that are not within $\pm 0.2'$ of plan grade. The Contractor shall include all costs associated with the regrading and/or remobilization to bring the grades into compliance in the bid for "Mass Grading"
- Earthwork Cross Sections and Earthwork Quantities reflect topography as of May 10, 2010. The Contractor shall satisfy himself with the Earthwork Quantities associated with Bid Items "Unclassified Excavation" and "Mass Grading" prior to bidding. No additional payments or change orders for earthwork will be accepted.
- The Developer for this project is Paul E. Kelsey and may be reached at (316) 722-1077

Benchmarks

135th St. W. & 13th St. N. - City of Wichita Disc at southwest corner of intersection, 30.00'± S. of \angle of 13th St. N. 35.00'± W. of \angle of 135th St. W.
Elev. = 1355.65 MSL (NGVD 29)

"□" Cut in top of curb north side of Westport adjacent to the southeast corner of Lot 30, Block D, Silvertown Addition.
Elev. = 1364.44 MSL (NGVD 29)

"□" Cut in curb inlet top at the west end of Bellick Ct. adjacent to Lot 10 & Lot 11, Block D, Silvertown Addition.
Elev. = 1364.12 MSL (NGVD 29)

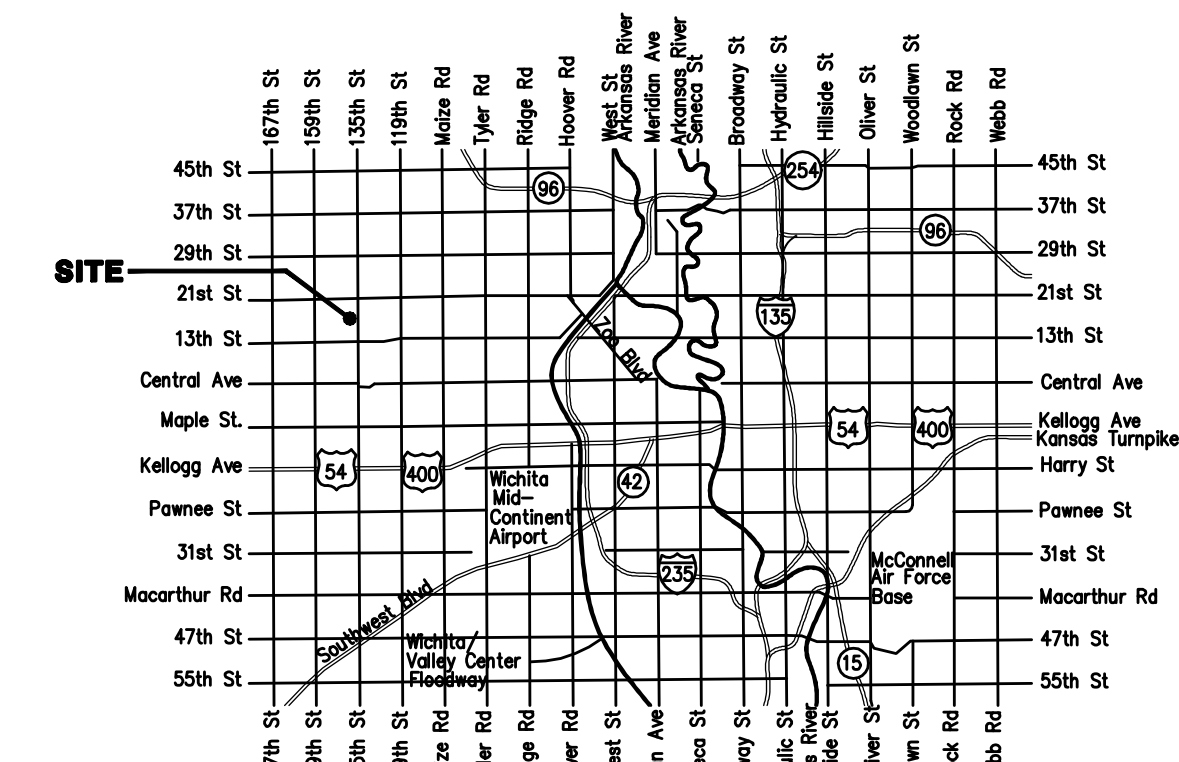
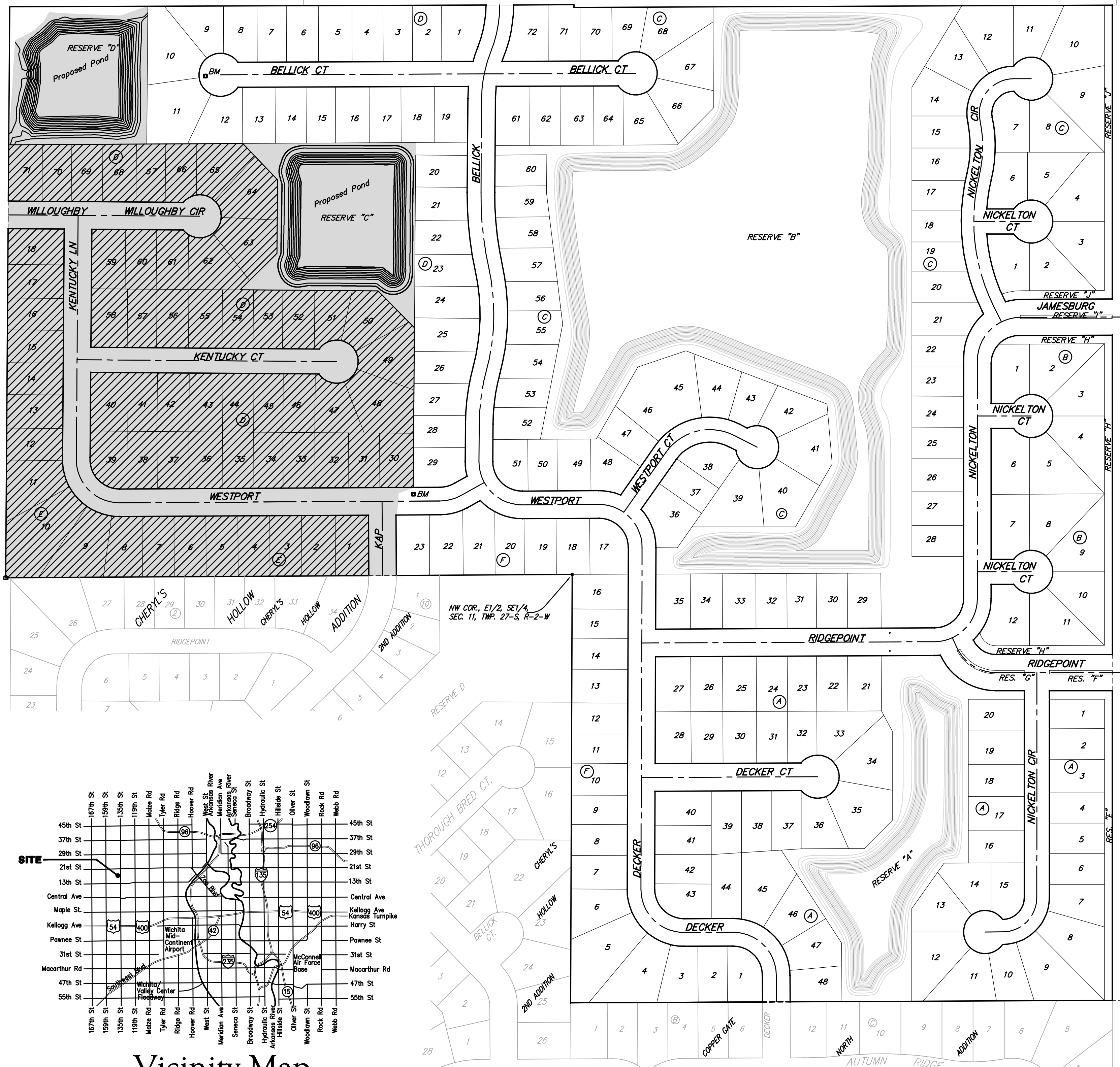

Vicinity Map

Benefit District 
Area to be Graded 

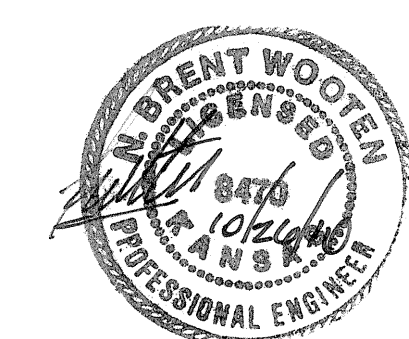

Baughman Company, P.A. 315 Ella St. Wichita, KS 67211 P 316-262-7271 F 316-262-0145
ENGINEERING | SURVEYING | PLANNING | LANDSCAPE ARCHITECTURE