

BENCHMARKS:

BM #1: Cross cut in north edge of concrete walk, approximately 315' east and 75' north of the NW Corner. NW 1/4 Sec. 7, T27S, R1W of the 6th P.M.
Elev. = 1357.63 NGVD29

BM #2: Orange cap Baughman rebar approximately 43' west and 93' south of the NW Corner of NW 1/4 Sec. 7, T27S, R1W of the 6th P.M.
Elev. = 1359.66 NGVD29

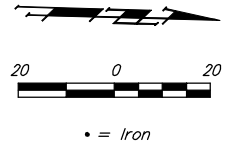

STRIPING DETAIL

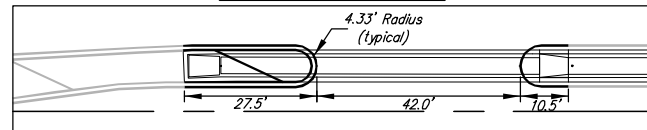

PAVMENT MARKINGS:

All pavement markings shall be thermoplastic (cold plastic). Pavement markings shall be installed per manufacturer's recommendations and shall meet KDOT's 90M-100-R10 specification (City Standard Specifications). Full Traffic may not be restored (and substantial Project Completion achieved) until all pavement markings are in place. Should construction timing be such that restoration of traffic becomes necessary during temperatures prohibiting the installation of thermoplastic markings, the Contractor shall install and maintain temporary markings until such time that thermoplastic markings may be properly installed. Except for material requirement, temporary pavement markings shall be placed equivalent, in every manner (i.e. dimension, frequency, spacing, etc.), to the permanent marking layout.

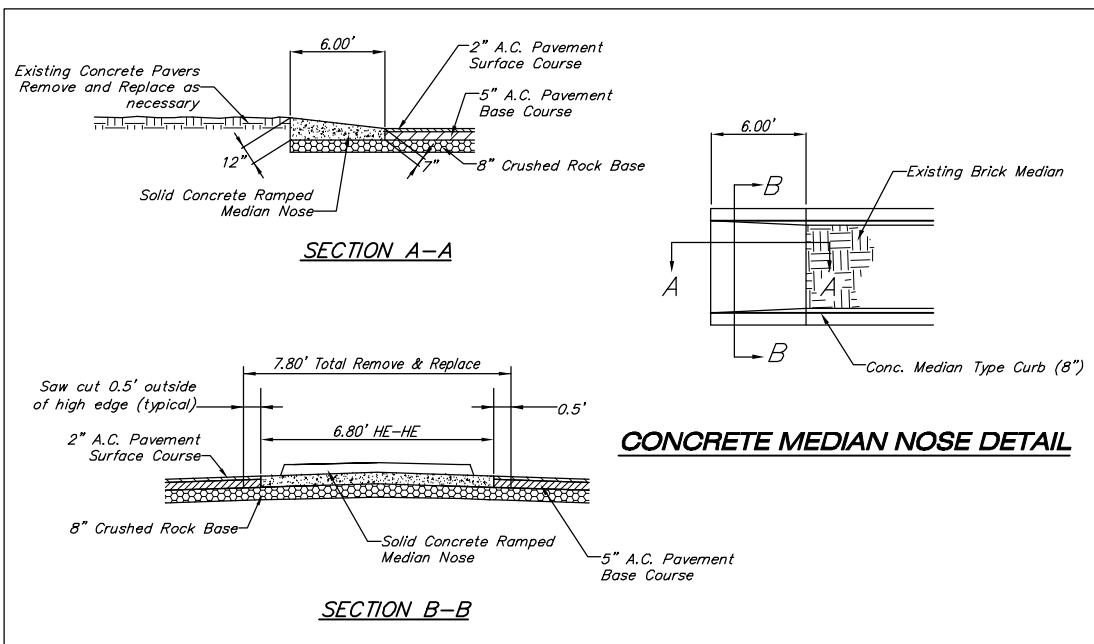
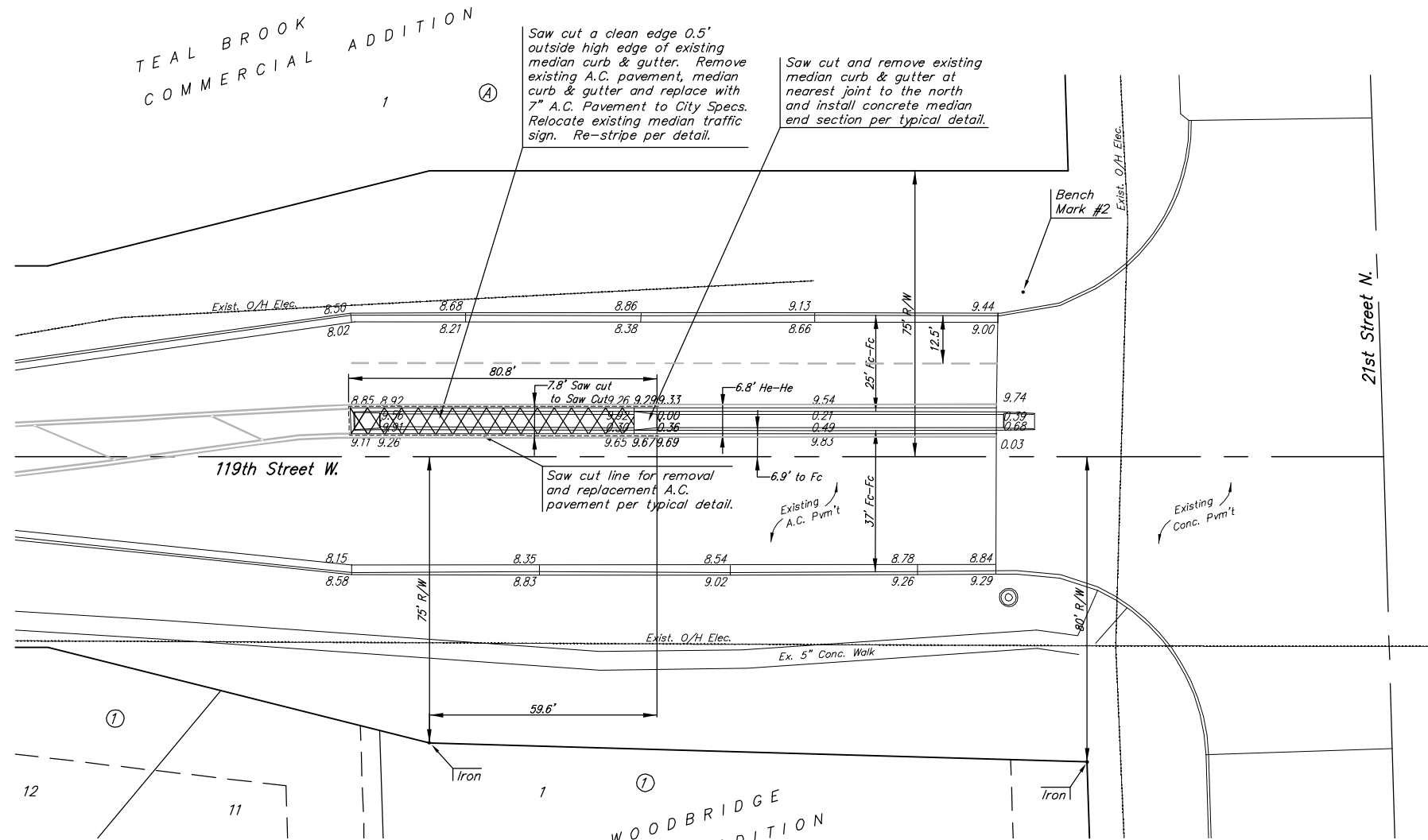

TRAFFIC CONTROL:
During construction traffic shall be limited to two lanes north bound and one lane south bound.

		WOODBRIIDGE 4TH ADDITION 119TH STREET MEDIAN IMPROVEMENTS	
		<small>Baughman Company, P.A. 315 Ellis St. Wichita, KS 67211 F 316-262-7271 F 316-262-0149 ENGINEERING SURVEYING PLANNING LANDSCAPE ARCHITECTURE</small>	
PROJECT NUMBER	DESIGN	TJW	DRAWN
REVISIONS:	APPROVED	TJW	DATE
	NOTED		MARCH 201
	SHEET		
			2 OF 2