

STATE	PROJECT NO.	YEAR	SHEET NO.	TOTAL SHEETS
KANSAS	87 N-0361-01	2011	53	169

MKEC
ENGINEERING
CONSULTANTS, INC.
411 N. WEBB ROAD
WICHITA, KS. 67206
316-684-9600

DRAINAGE DATA

Drainage Area	40,490	Sq. Mi.
Design Frequency	50	Years
Design Discharge (Q50)	25,500	cfs
Design High Water Elevation	1289.80	
Design Backwater	0.5	Ft.
Design Backwater Elevation	1289.38	
Overtopping Elevation (Sta. 7+76.74)	1296.08	
Overtopping Frequency	500+	Years
Discharge at Q100	25,500	cfs
Backwater at Q100	0.4	Ft.
Backwater Elevation at Q100	1289.71	
Historic High Water Elevation	Unknown	
Ordinary High Water Elevation	1284.50	
Total Waterway Provided	4,238	Sq. Ft.
Design Waterway Provided	3,530	Sq. Ft.

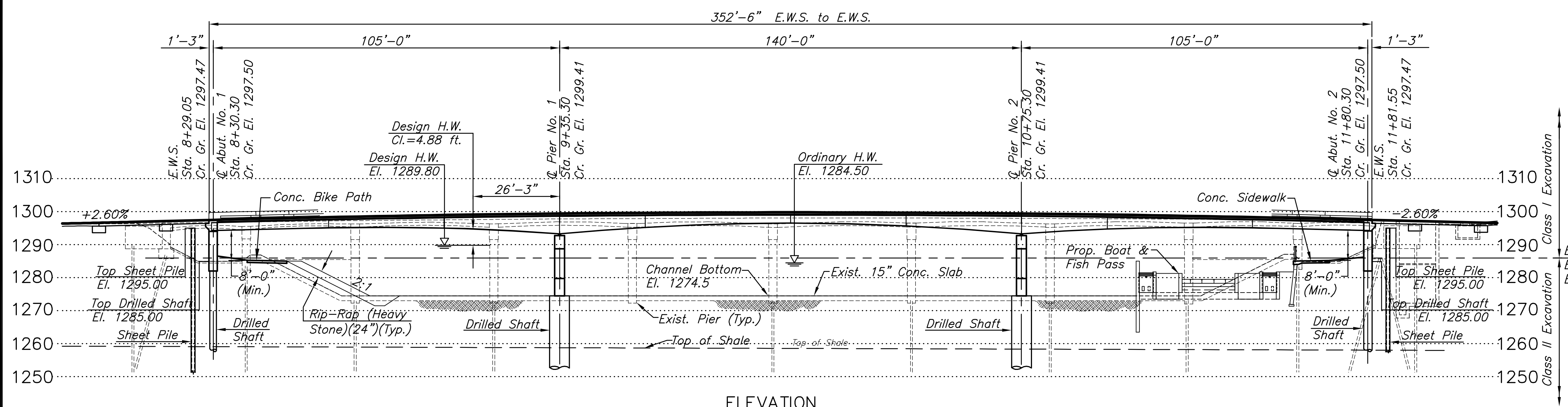

BM#1 C.O.W. Bench Mark disc at S.W. corner bridge,
Lincoln and Arkansas River
Sta. 8+09.10, 47.52' Rt. Elev. 1296.80 (NAVD 88)

105'-140'-105' Parabolic Haunched Weathering Steel Welded Plate Girder,
Drilled Shaft Abutments, Pedestal Type Pier with Drilled Shaft
72'-0" Roadway w/6'-0" Walkway Lt. & Rt.

BM#2 C.O.W. Bench Mark disc at N.W. corner bridge,
Lincoln and Arkansas River (stamped 1296.62)
Sta. 11+63.61, 40.81' Lt. Elev. 1297.02 (NAVD 88)

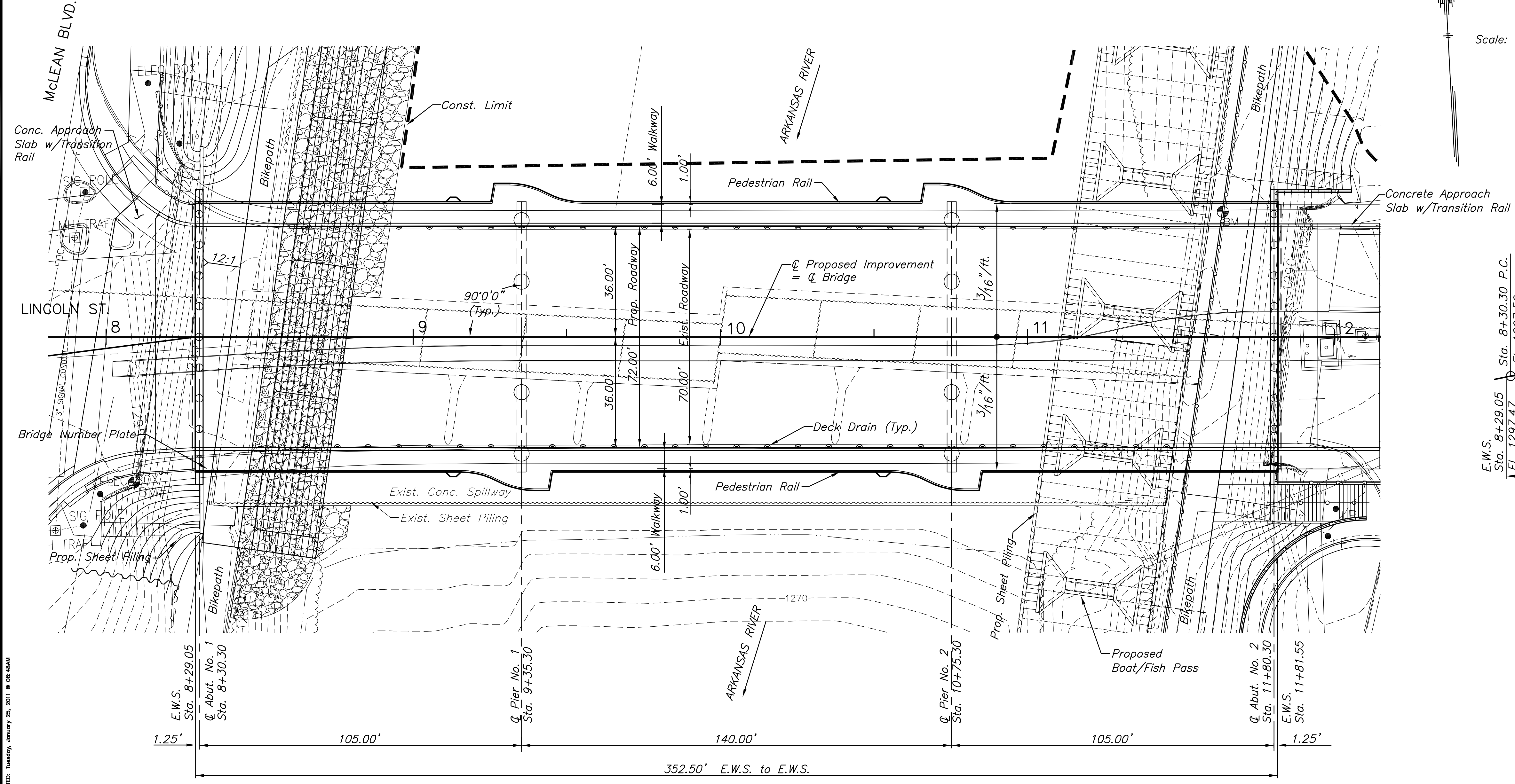

Scale: 1"=20'

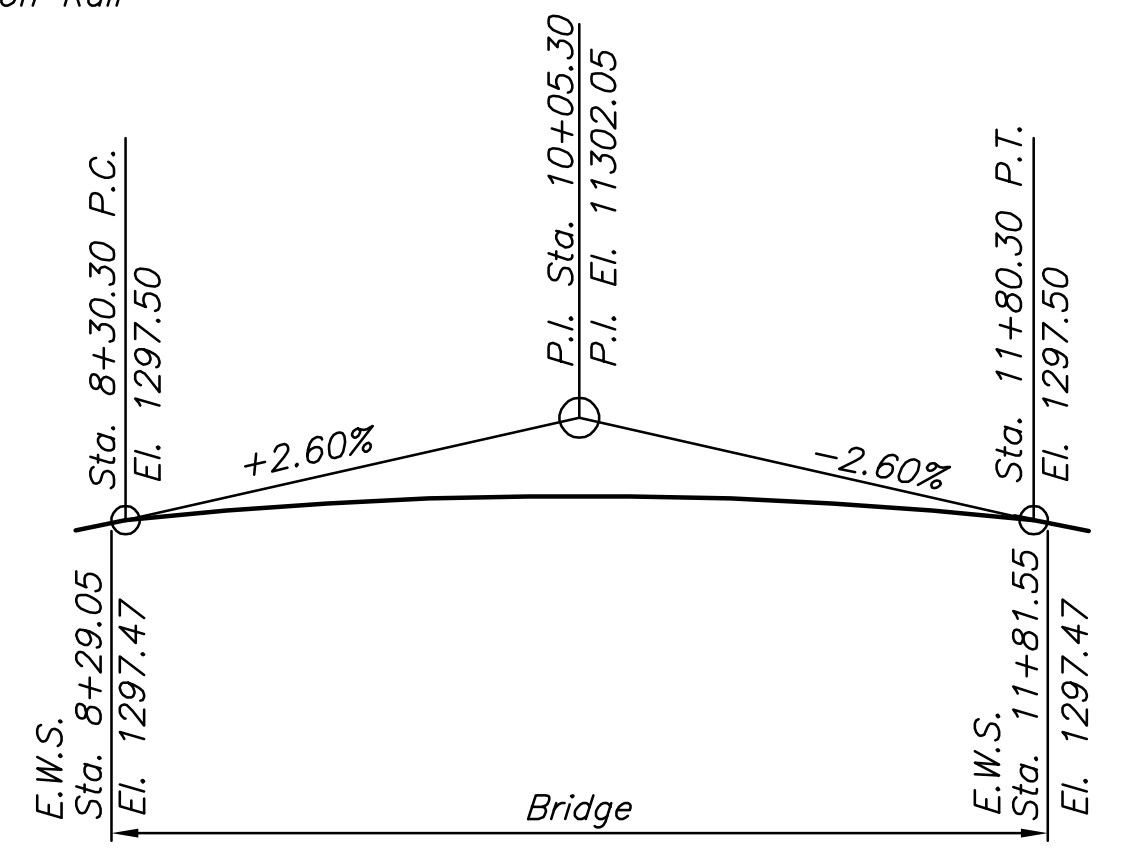

CROWN GRADE PROFILE
350' Vertical Curve

PLAN

**LINCOLN STREET BRIDGE AND
DAM IMPROVEMENTS OVER
ARKANSAS RIVER**

**CONSTRUCTION
LAYOUT**

STA 10+05.30
SHEET TITLE
472-84883
PROJECT NUMBER

JAG
DESIGN BY
DPG
DRAWN BY
KJS
CHECKED BY

ISSUED
1/24/2011
REVISED

SHEET NO.
53 of 169