

**LINCOLN STREET BRIDGE AND
DAM IMPROVEMENTS OVER
ARKANSAS RIVER**

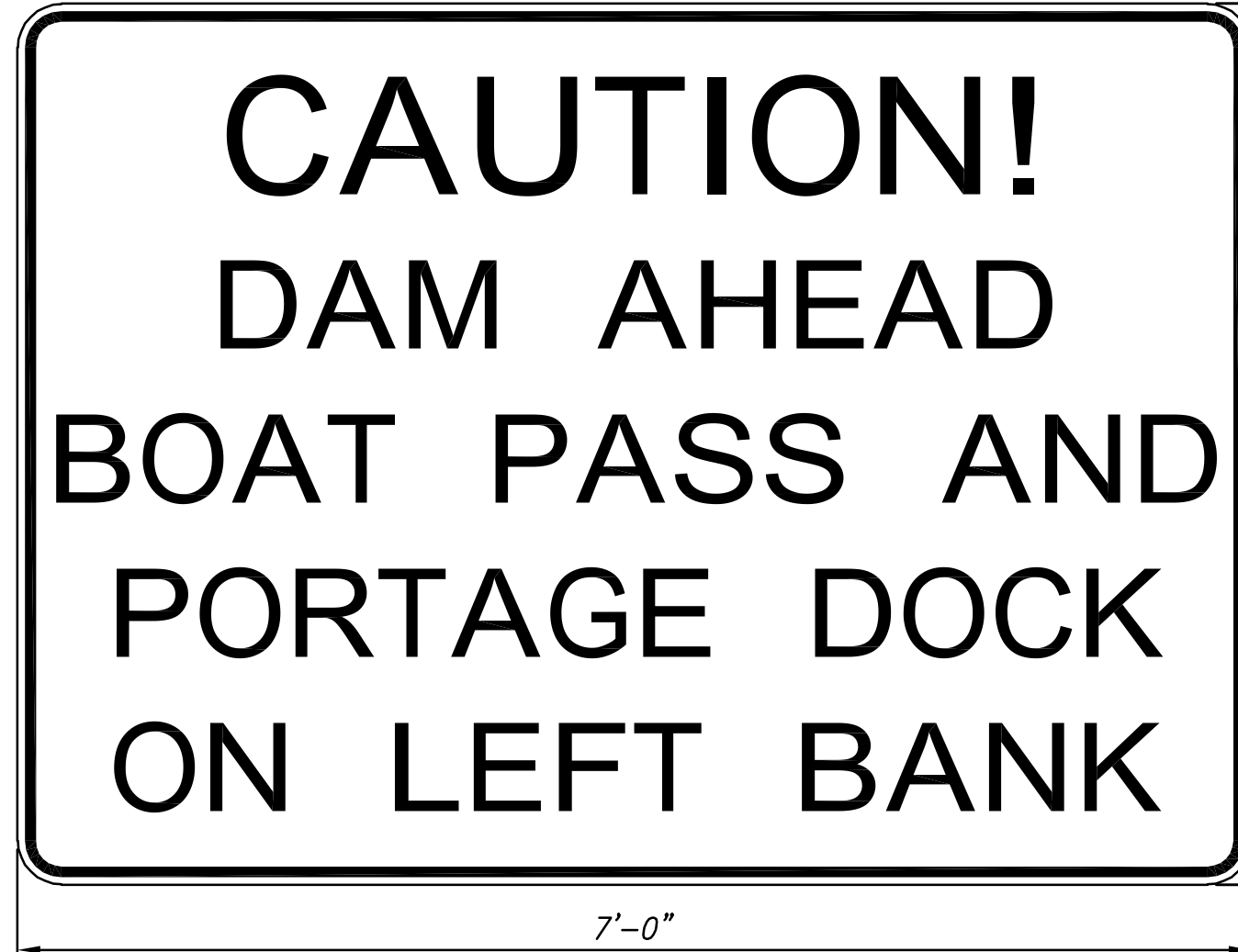

Sign	G20-Special
W x H	7'-0" x 5'-0"
Border Width	3/4"
Corner Radius	3"
Mounting	Ground & Bridge
Background	Type: Reflective
	Color: White
Legend/Border	Type: Non-Reflective
	Color: Black *

* "CAUTION" to be Red

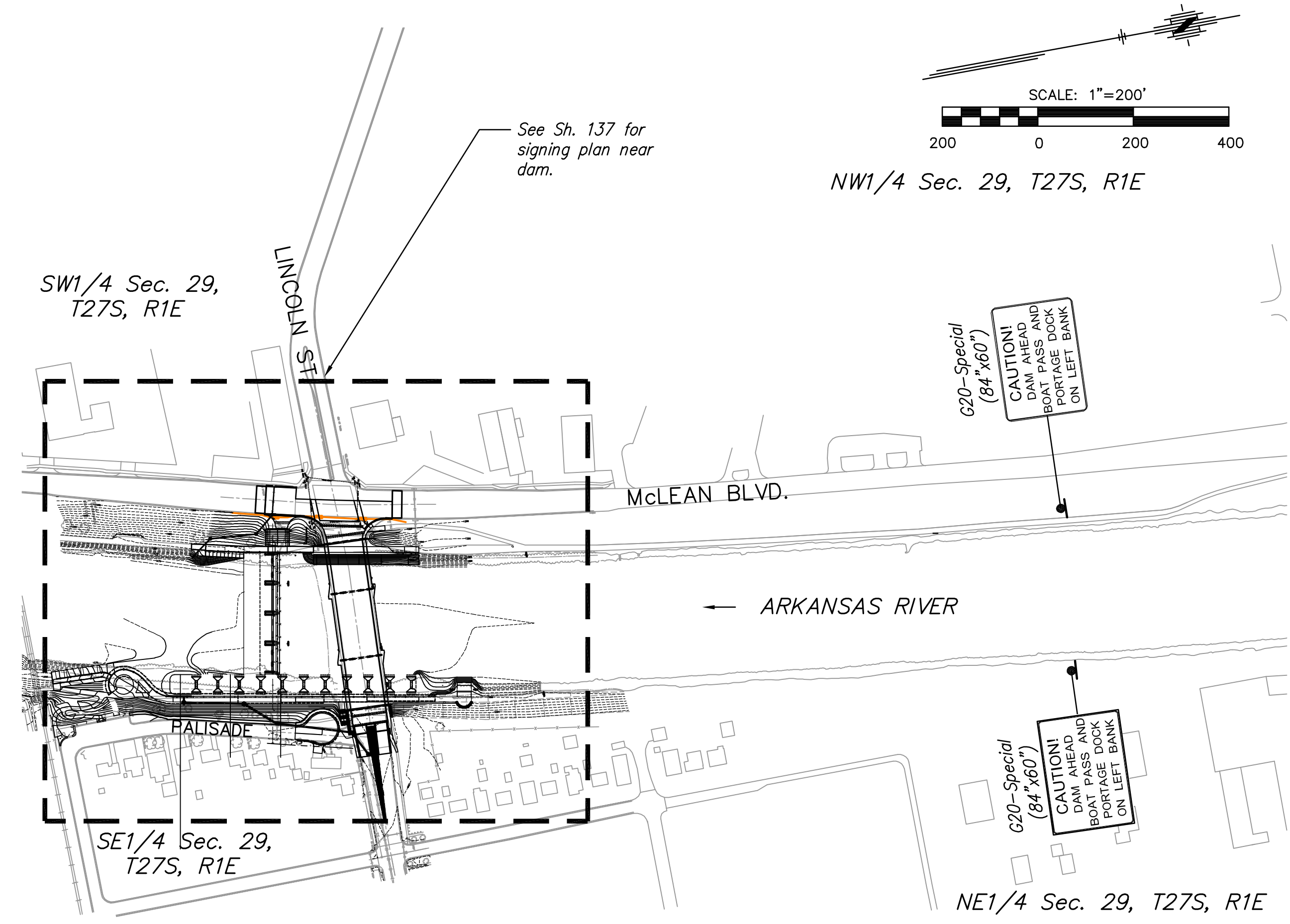

Sign	G20-Special
W x H	7'-0" x 4'-0"
Border Width	3/4"
Corner Radius	3"
Mounting	Bridge
Background	Type: Reflective
	Color: White
Legend/Border	Type: Non-Reflective
	Color: Black

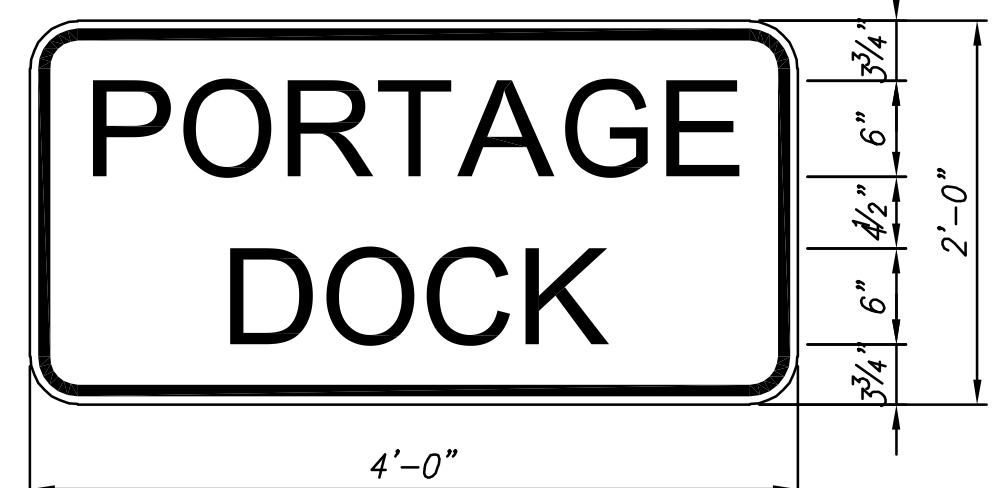

Sign	G20-Special
W x H	4'-0" x 2'-0"
Border Width	3/4"
Corner Radius	2"
Mounting	Ground
Background	Type: Reflective
	Color: White
Legend/Border	Type: Non-Reflective
	Color: Black

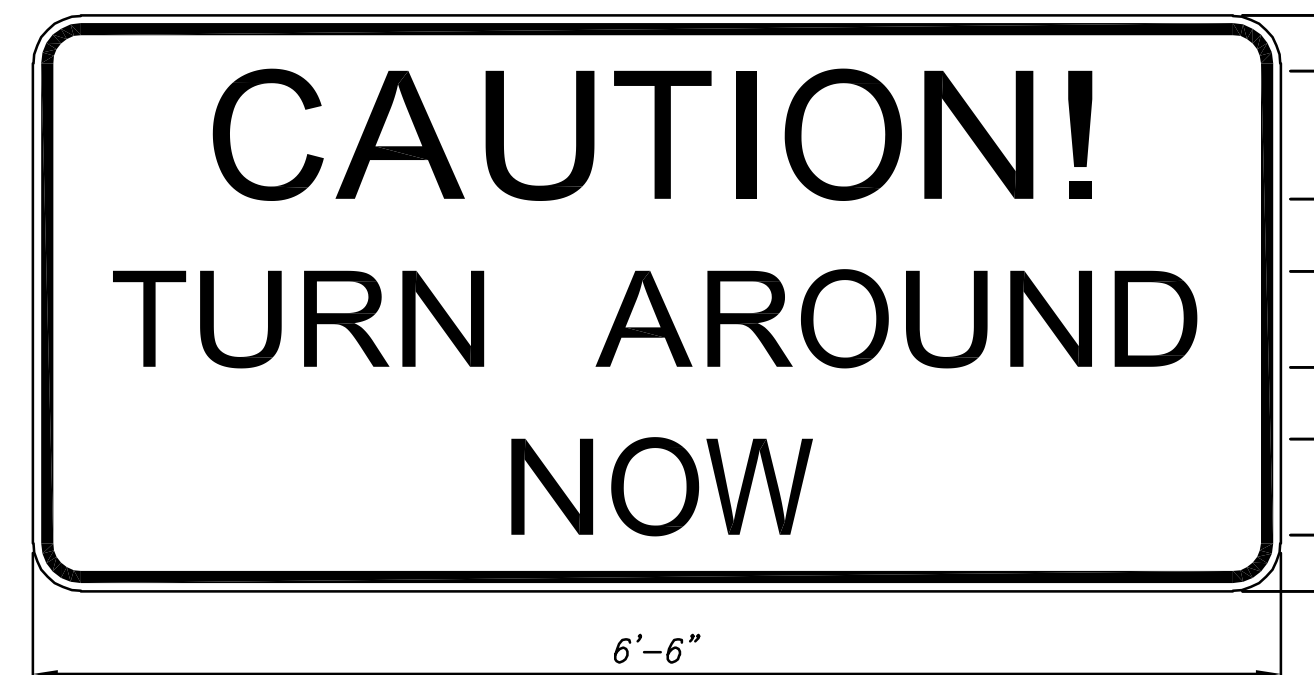

Sign	G20-Special
W x H	6'-6" x 3'-0"
Border Width	3/4"
Corner Radius	2 1/2"
Mounting	Bridge
Background	Type: Reflective
	Color: White
Legend/Border	Type: Non-Reflective
	Color: Black *

* "CAUTION" to be Red

**SAFETY
SIGNING
LAYOUT**
SHEET TITLE
472-84883
PROJECT NUMBER

JRA
DESIGN BY
DPG
DRAWN BY
CHECKED BY

ISSUED
1/24/2011
REVISED

SHEET NO.
138 of 169

SIGN DESCRIPTION			
CLASSIFICATION	TYPE	SIZE	AREA
G20-Special	CAUTION DAM AHEAD	84"x60"	35.0 SQ. FT.
G20-Special	BOAT PASS	84"x48"	28.0 SQ. FT.
G20-Special	CAUTION TURN AROUND	78"x36"	19.5 SQ. FT.
G20-Special	PORTAGE DOCK	48"x24"	8.0 SQ. FT.
M6-2	DIRECTION ARROW	21"x15"	2.19 SQ. FT.
M6-3	DIRECTION ARROW	30"x21"	4.38 SQ. FT.
G20-Special	WARNING KEEP OUT	30"x24"	5.0 SQ. FT.
G20-Special	KEEP OFF	30"x18"	3.75 SQ. FT.

SIGN POST LENGTH SUMMARY	
S4S TREATED WOOD POST	
4"x6"x LENGTH	EACH
16.0' *	12

* Contractor to verify due to unevenness of river bank grades.

RECAPITULATION OF RIVER SIGNING MATERIALS		
ITEMS	TOTAL	UNIT
Sign Face, (High Intensity HA Reflective Sheeting)	314.89	S.F.
4"x6" S4S Treated Wood Post	192.0	L.F.

- Notes:
- Letters shall be "E" Modified Series.
 - Borders shall be 3/4" in width and located 1/2" from the edge of the sign.
 - Contractor shall submit sign layouts for approval prior to manufacturing.
 - Signs having any portion of their width 48" or greater are to be mounted on two wood posts.
 - Mounting hardware for signs to be affixed to Bridges shall be Subsidiary to "River Signing".

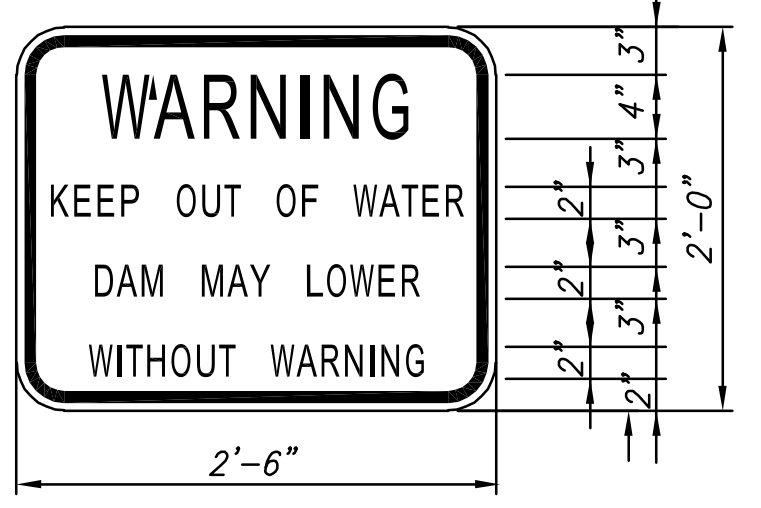

Sign	G20-Special
W x H	2'-6" x 2'-0"
Border Width	3/4"
Corner Radius	2"
Mounting	Ground
Background	Type: Reflective
	Color: White
Legend/Border	Type: Non-Reflective
	Color: Black *

* "WARNING" to be Red

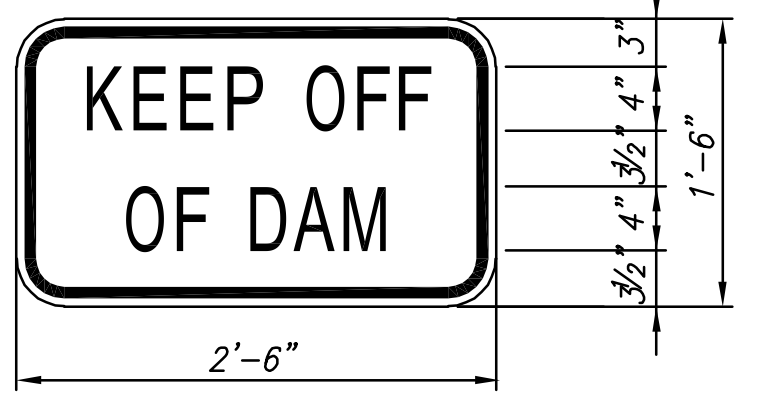

Sign	G20-Special
W x H	2'-6" x 1'-6"
Border Width	3/4"
Corner Radius	2"
Mounting	Ground
Background	Type: Reflective
	Color: White
Legend/Border	Type: Non-Reflective
	Color: Black

SAFETY SIGNING LAYOUT

SCALE: 1"=200'