

STATE	PROJECT NO.	YEAR	SHEET NO.	TOTAL SHEETS
KANSAS	87 N-0361-01	2011	143	169

MKEC
ENGINEERING
CONSULTANTS, INC.
411 N. WEBB ROAD
WICHITA, K.S. 67206
316-684-9600

LEGEND

- ☐ Type III Barricades with lights
- Mount On Type III Barricade
- ⌵ One Post Sign
- ⌵ Two Post Sign
- ➔ Traffic Flow
- ▨ Work Space
- Reflectorized Drum
- Tubular Marker
- △ Mount overhead on signal mast-arm (or temporary spanwire) and as shown where visible to would-be left turning vehicles.

Notes: Implement this traffic control plan during construction of McLean Blvd. and Lincoln St. pavement. See insert for additional information regarding the construction of the West lanes of McLean Blvd.

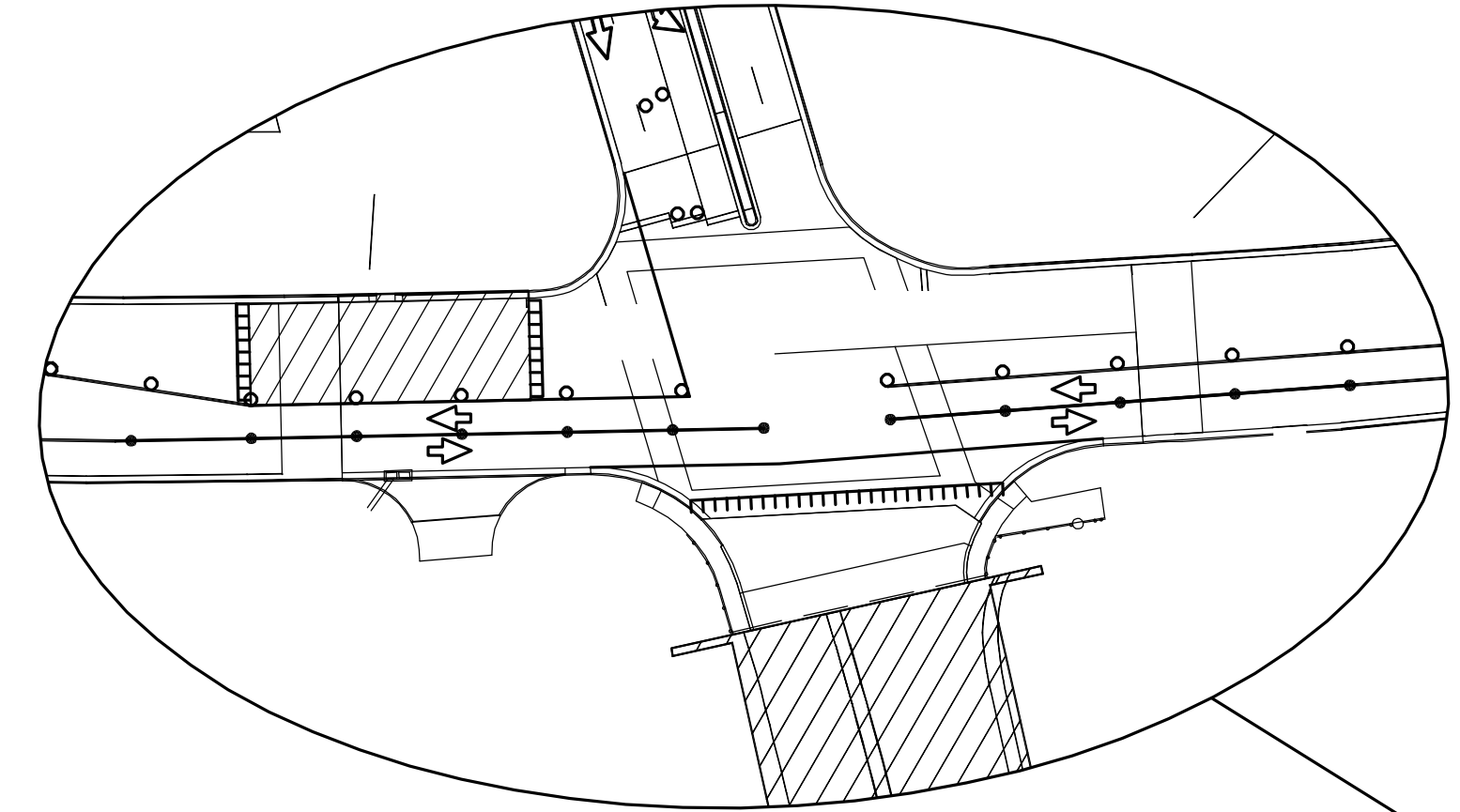

Insert: Utilize similar traffic control for construction of West lanes of McLean Blvd.

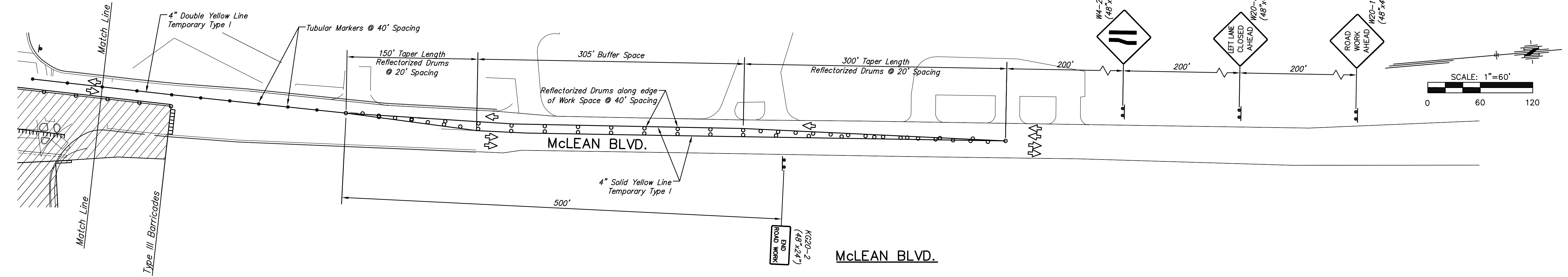
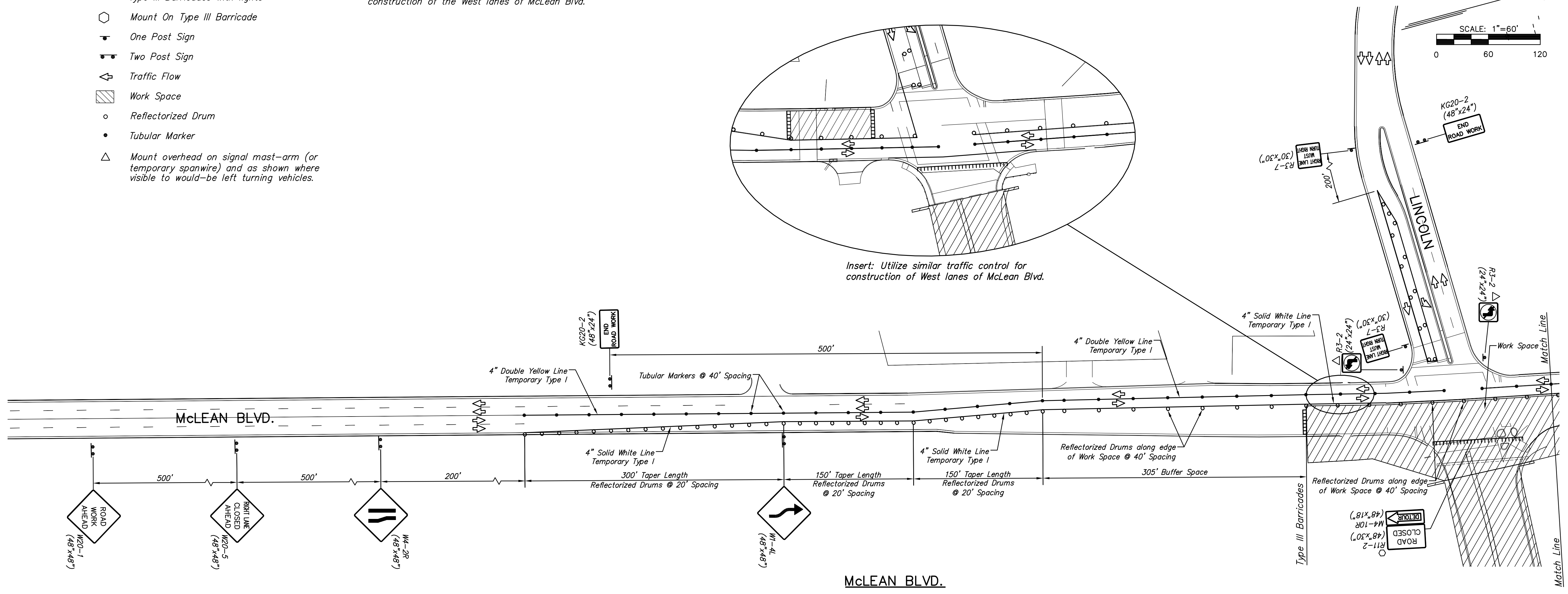

**LINCOLN STREET BRIDGE AND
DAM IMPROVEMENTS OVER
ARKANSAS RIVER**

TRAFFIC CONTROL
McLEAN BLVD
SHEET TITLE
472-84883
PROJECT NUMBER

JRA
DESIGN BY
WNJ
DRAWN BY
KJS
CHECKED BY

ISSUED
1/24/2011
REVISED

SHEET NO.
143 of 169

PLOTTED: Tuesday, January 25, 2011 8:58 AM

J:\CIVIL\07433\DWG\BRIDGE\TRAFFIC\07433 TR01.DWG