

STATE	PROJECT NO.	YEAR	SHEET NO.	TOTAL SHEETS
KANSAS	472 84614	.	188	534

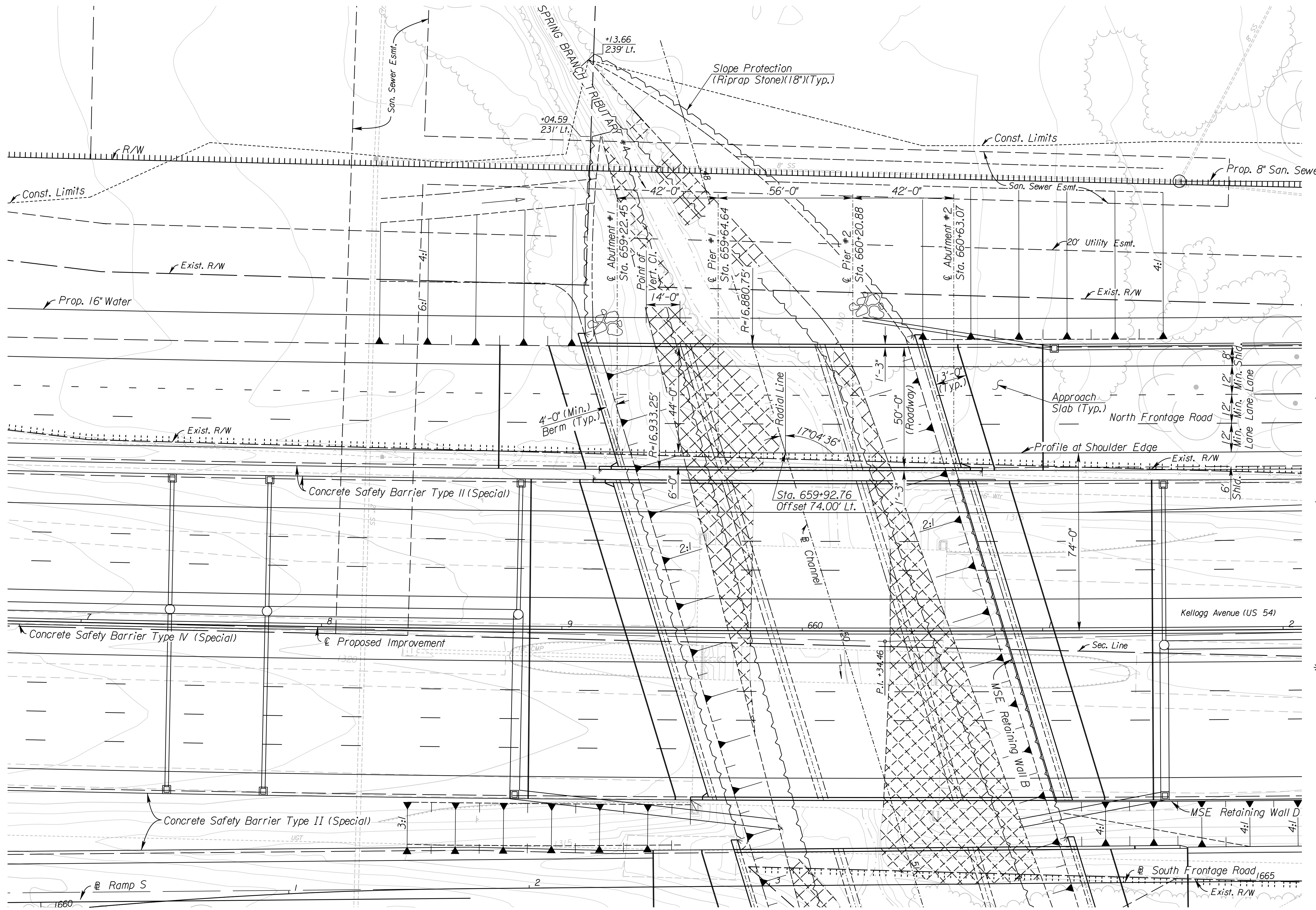
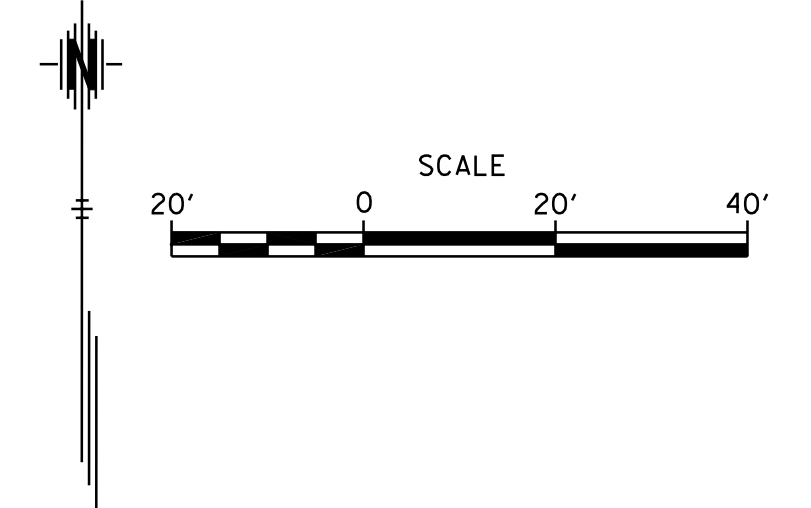

DRAINAGE DATA

* Drainage Area	3.3 Sq. Mi.
Design Frequency	100 Years
** Design Discharge (Q_{100})	3,813 cfs
Design High Water Elevation	1317.09 Ft.
Design Backwater	N/A Ft.
Design Backwater Elevation	1317.71 Ft.
Overtopping Elevation (Sta. N/A)	N/A Ft.
Overtopping Discharge	N/A cfs
Overtopping Frequency	>500 Years
** Discharge at Q_{100}	3,813 cfs
Backwater at Q_{100}	N/A Ft.
Backwater Elevation at Q_{100}	1317.71 Ft.
Historic High Water Elevation	N/A Ft.
Ordinary High Water Elevation	1309.0 Ft.
Total Waterway Provided	823 Sq. Ft.
Design Waterway Provided	219 Sq. Ft.
100 Yr. Floodplain Elev. (FEMA)	
Average Velocity at Q_{des}	3.4 fps
Average Velocity at Q_{100}	3.4 fps
* Drainage Area for Spring Branch Tributary #4	
** Discharge is controlled and published by FEMA	

⊕ PROPOSED IMPROVEMENT CURVE DATA
 P.I. Sta. 660+34.46 Bk. = 660+34.34 Ahd.
 $\Delta = 0^\circ 34' 29''$ (Lt.) $L = 763.93'$
 $R = 17000.00'$ $E = 4.29'$
 $T = 382.03'$

CITY OF WICHITA
NORTH FRONTAGE ROAD OVER
SPRING BRANCH TRIBUTARY #4
CONSTRUCTION LAYOUT I

BR. NO. STA. 659+92.76

PLAN

I:\39+58 AM
 2/9/2011
 T:\35766A\Cadd\Sheets\Structures\Bridges\SBT4\NFR\EX2\SBNFCL01.dgn
 SURV. PLOT CADD DES. TR. CKD. APP.