

PERIMETER ROAD IMPROVEMENTS
BOTANICA - THE WICHITA GARDENS

EROSION CONTROL

SHEET TITLE
472-84976
PROJECT NUMBER

DFL KKL/DM, JRA
DESIGNED DRAWN CHECKED

ISSUED
March 2011

REVISED

SHEET NO.

14 of 21

PERMANENT SEEDING NOTES

- SEEDING AREAS SHALL BE PREPARED FOR PLANTING WITH COMMON AGRICULTURAL TECHNIQUES. ALL AREAS SHALL BE FINE GRADED USING SMALL EQUIPMENT. LOOSEN SOIL TO A DEPTH OF AT LEAST 6 INCHES. GRADE AREAS TO A SMOOTH UNIFORM SURFACE PLANE. ROLL, RAKE, AND REMOVE RIDGES AND FILL DEPRESSIONS. THE SURFACE SHALL BE FREE FROM STICKS, SMALL STONES, AND OTHER EXTRANEIOUS MATERIALS. APPROVE WITH OWNER'S REPRESENTATIVE BEFORE PLANTING.
- ALL SEED SHALL BE DISTRIBUTED WITH AN ACCEPTABLE DRILL INTENDED FOR SUCH OPERATIONS, OR OTHER EQUIPMENT APPROVED BY THE OWNER'S REPRESENTATIVE. SEEDING DEPTH SHALL BE 1/4".
- ALL DISTURBED AREAS SHALL BE SEEDED AND FERTILIZED AS FOLLOWS:
BUFFALO SEED @ 3 LBS./1000 SF
ANNUAL RYE @ 2 LBS./1000 SF
10-20-10 @ 220 LBS./ACRE
- THE SEED SHALL BE WATERED WITH A DEEP SOAKING EVERY TWO WEEKS DURING DRY PERIODS UNTIL A MATURE STAND OF GRASS IS OBTAINED.
- THE CONTRACTOR SHALL BE RESPONSIBLE FOR INSTALLING EROSION CONTROL BLANKET (CUREX 1, OR APPROVED EQUAL) AT THE BACK OF CURB, TO AND INCLUDING THE LIMITS OF ALL SEEDED AREAS.
- ALL COSTS FOR THIS WORK SHALL BE SUBSIDIARY TO THE SEEDING BID ITEM.
- SEED DISTURBED AREAS SOUTH OF THE PROPOSED FENCING TO BE INSTALLED AS PART OF PROJECT 472-84977.
- INSTALL BUFFALO SOD IN MEDIAN ISLAND AS SHOWN.

EROSION CONTROL NOTES

- EROSION CONTROL IS TO MEET ALL FEDERAL, STATE, COUNTY & LOCAL CODE STANDARDS.
- CONTRACTOR SHALL PROVIDE AND PRESERVE EROSION PROTECTION THROUGHOUT PROJECT CONSTRUCTION. THE PLAN PROVIDED HERE IS FOR FINAL PROTECTION, VARIOUS PHASES OF THIS PLAN SHALL BE IMPLEMENTED OR MODIFIED TO CONTROL EROSION. MODIFICATIONS OF THE PLAN SHALL BE APPROVED BY THE OWNERS REPRESENTATIVE.
- CONTRACTOR IS RESPONSIBLE FOR MAINTAINING AND IMPLEMENTING ALL EROSION CONTROL. COST IS SUBSIDIARY TO CHECK DAMS AND STABILIZED CONSTRUCTION ENTRANCE.
- CONTRACTOR SHALL INSTALL AND MAINTAIN A STABILIZED CONSTRUCTION ENTRANCE AT A LOCATION DETERMINED BY THE ENGINEER. THIS ENTRANCE MAY BE UTILIZED BY THE CONTRACTOR FOR PROJECT 422-84977 "PLAZA HARDSCAPE AND FENCE IMPROVEMENTS".

GENERAL GRADING NOTES

- A 6" (MAX. DEPTH) LAYER OF TOPSOIL SHALL BE STRIPPED IN ALL AREAS TO RECEIVE FILL AND SAVED BACK FOR REPLACEMENT IN NON-BUILDING AND NON-PAVED AREAS. ANY EXCESS TOPSOIL SHALL BE SEPARATELY STOCKPILED ON-SITE AT AN OWNER APPROVED LOCATION. EXCESS MATERIAL PLACEMENT SHALL BE SUBSIDIARY TO BID ITEM "EARTHWORK".
- ALL FILL SHALL BE COMPACTED TO 95% STANDARD PROCTOR DENSITY. MAXIMUM LIFT THICKNESS SHALL BE 8". CONTRACTOR TO PROVIDE ADEQUATE COMPACTION TESTING TO CONFIRM COMPACTION.
- CONTRACTOR SHALL NOTIFY UTILITY COMPANIES OF CONSTRUCTION SCHEDULING.
- THE CONTRACTOR SHALL NOT REMOVE ANY EXISTING VEGETATION WITHOUT PRIOR APPROVAL OF THE LANDSCAPE ARCHITECT. THE CONTRACTOR SHALL NOT PERFORM ANY GRADING OPERATIONS WITHIN THE DRILINE OF ANY EXISTING TREES. COORDINATE GRADING WITH MKEC LANDSCAPE ARCHITECT.
- THIS IS DESIGN GRADING. ALL GRADES SHALL BE CONTOURED SMOOTHLY WITH GENTLE ROUNDING/SHAPING OF ALL AFFECTED LAND SURFACES. ABRUPT TRANSITIONS AT THE TOP OF SLOPES WHERE PROPOSED GRADES MEET EXISTING ARE NOT ACCEPTABLE. SURVEY STAKES FOR POND GRADING ARE FOR GENERAL GRADING PURPOSES ONLY. NOT ALL SLOPES ARE CONSTANT AND THEREFORE THE GRADING PLANS SHALL BE REFERRED TO FOR FINAL GRADE SHAPING. ALL BERMS & POND EDGES SHALL BE FINAL GRADED/SHAPED WITH A TRACK DOZER, NOT A BLADE. THE GRADING SHALL BE APPROVED BY MKEC'S LANDSCAPE ARCHITECT PRIOR TO THE ADDITION OF THE TOPSOIL LAYER.
- AS THE PROJECT NEARS COMPLETION, THE CONTRACTOR SHALL RIP (SCARIFY) ALL HAUL ROADS WITH AN AGRICULTURAL IMPLEMENT INTENDED FOR SUCH PURPOSES TO A DEPTH OF 18". MULTIPLE PASSES MAY BE NECESSARY TO THOROUGHLY ALLEVIATE COMPACTION.
- IN THE EVENT THAT OFFSITE TOPSOIL IS NEEDED, IT SHALL BE FERTILE NATURAL TOPSOIL, TYPICAL OF THE LOCALITY, OBTAINED FROM WELL DRAINED AREAS. STOCKPILED TOPSOIL MAY BE USED. IT SHALL BE WITHOUT ADMIXTURE OF SUBSOIL OR SLAG AND SHALL BE FREE OF STONES, LUMPS, STICKS, PLANTS OR THEIR ROOTS, TOXIC SUBSTANCES OR OTHER EXTRANEIOUS MATTER THAT MAY BE HARMFUL TO PLANT GROWTH OR WOULD INTERFERE WITH FUTURE MAINTENANCE. TOPSOIL pH RANGE SHALL BE 5.5 TO 7.0. TOPSOIL SHALL BE APPROVED BY MKEC'S LANDSCAPE ARCHITECT PRIOR TO PLACEMENT.

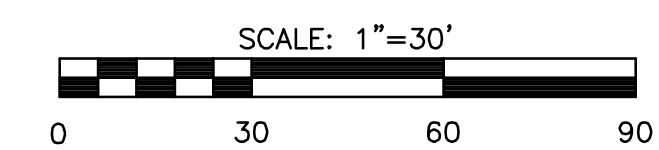
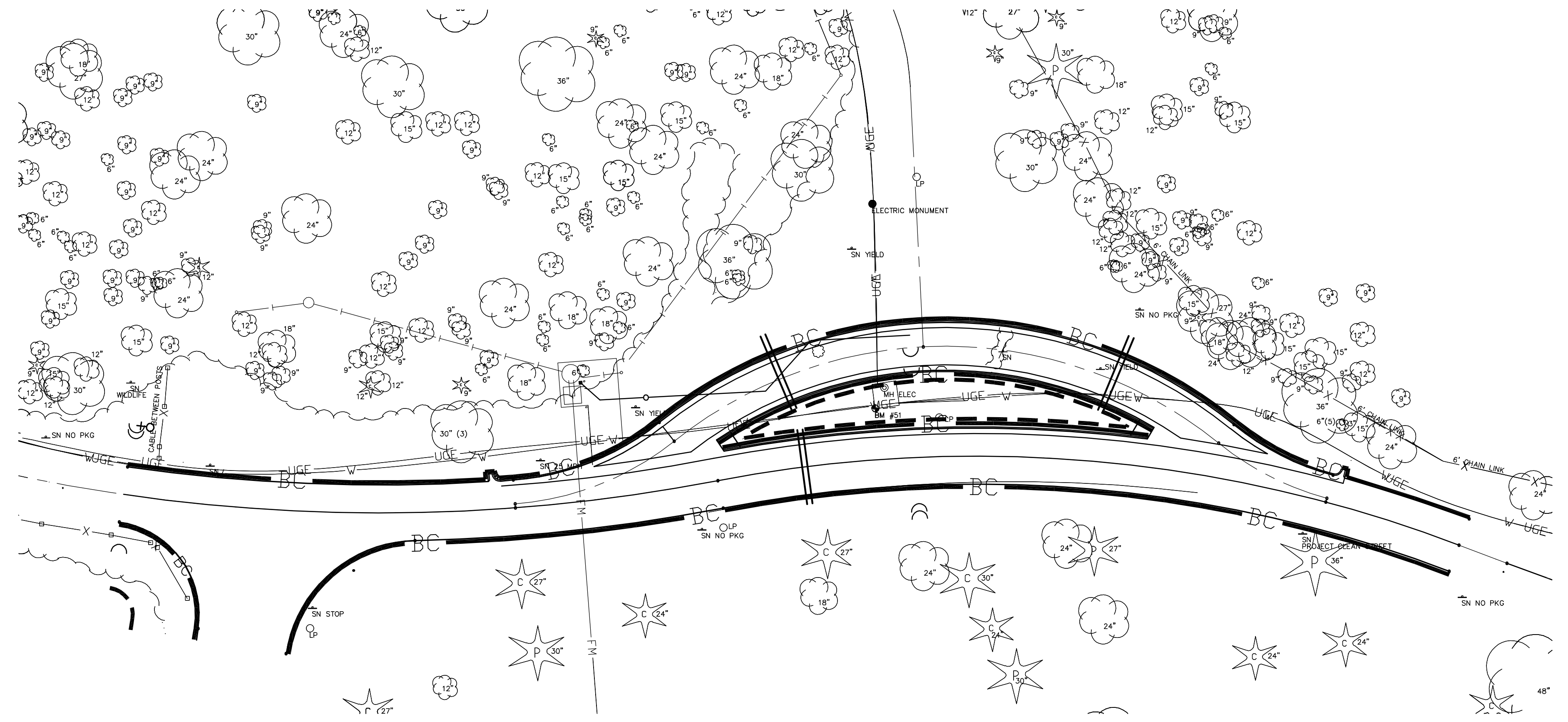
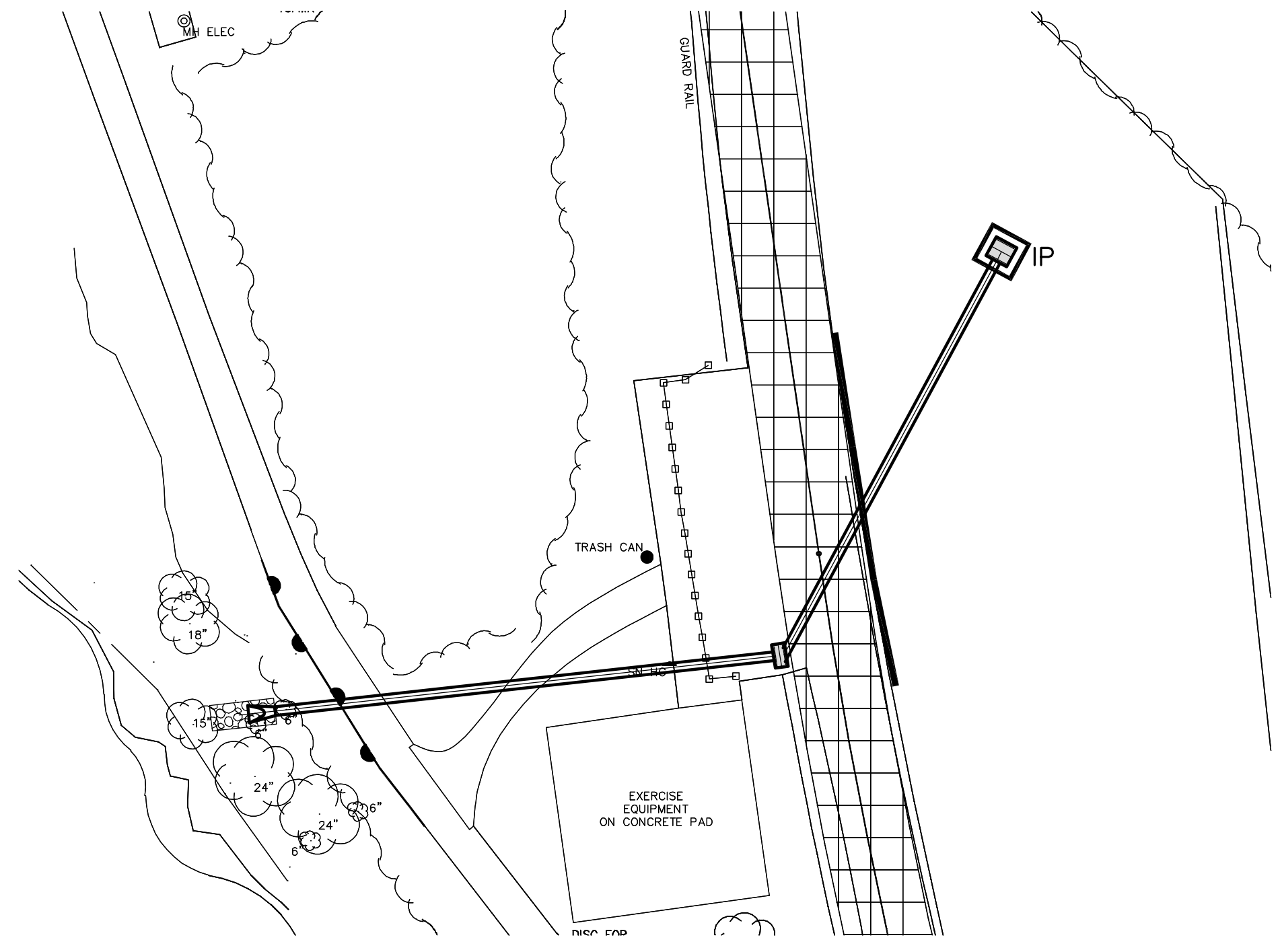

LEGEND

- BC — BACK OF CURB PROTECTION (1,425 LF)
- SFB — SILT FENCE SEDIMENT BARRIER (75 LF)
- SOD — SODDING (2,455 SF)
- IP — INLET PROTECTION