

**IRRIGATION NOTES**

1. SCOPE OF WORK: FURNISH AND INSTALL THE COMPLETE UNDERGROUND IRRIGATION SYSTEM SPECIFIED HEREIN FROM POINT-OF-CONNECTION THROUGHOUT SITE; INCLUDING LABOR, MATERIALS, EQUIPMENT, APPARATUS, AND SERVICES FOR THE TESTING, ADJUSTING, RETESTING AND READJUSTING AS REQUIRED TO PLACE THE SYSTEM IN AN APPROVED OPERATING CONDITION. THE IRRIGATION SYSTEM SHALL INCLUDE THE DESIGN AND INSTALLATION OF THE FOLLOWING:

- A. PIPING
- B. METER & BACKFLOW ASSEMBLY
- C. SPRINKLER HEADS
- D. VALVES AND VALVE BOXES
- E. CONTROL WIRING
- F. FITTINGS
- G. ELECTRICAL CONNECTIONS
- H. QUICK-COUPERS
- I. ALL OTHER NECESSARY ACCESSORIES
- J. SYSTEM MANUALS

2. INSTRUCTIONAL WALK-THROUGH WITH OWNER AND A PRE-CONSTRUCTION MEETING IS NECESSARY.  
A. LIMITS OF WORK: AREA WITHIN PROJECT LIMITS AS DELINEATED ON THE IRRIGATION PLAN.

3. QUALITY ASSURANCE  
A. IRRIGATION CONTRACTOR MUST HAVE TECHNICAL QUALIFICATIONS, EXPERIENCE, TRAINED PERSONNEL AND FACILITIES TO PERFORM THE SPECIFIED WORK AND HAVE BEEN ENGAGED IN SPRINKLER DESIGN AND INSTALLATION, OF SYSTEMS OF SIMILAR SIZE AND SCOPE, FOR AT LEAST FIVE (5) YEARS. IRRIGATION CONTRACTOR SHALL HAVE COMPLETED A PROJECT OF SIMILAR SIZE AND SCOPE WITHIN THE PAST THREE (3) YEARS.

4. QUALITY CONTROL CRITERIA: PROVIDE IRRIGATION PRODUCTS AS DESCRIBED IN THESE NOTES AND ACCORDING TO MANUFACTURER'S SPECIFICATIONS.

5. COMPLY WITH REQUIREMENTS FOR PREVENTION OF BACKFLOW AND BACKSIPHONAGE.

6. COMPLY WITH REQUIREMENTS FOR PLUMBING AND OTHER REGULATIONS AFFECTING SITE IRRIGATION.

7. COMPLY WITH NATIONAL PLUMBING CODE, NATIONAL ELECTRIC CODE, AND APPLICABLE CITY OR STATE CODES.

8. SUBMITTALS  
A. GENERAL: SUBMIT MANUFACTURER'S LITERATURE, TECHNICAL DATA, AND RECOMMENDATIONS FOR THE SYSTEM AS SPECIFIED INCLUDING:  
a. PIPE  
b. FITTINGS  
c. SPRINKLER HEADS  
d. VALVES  
e. BACKFLOW PREVENTER  
f. WIRING  
g. VALVE BOXES

9. SHOP DRAWINGS:  
A. DESIGN AND SUBMIT AN IRRIGATION LAYOUT PLAN BASED ON THE LANDSCAPE PLAN. THE PLAN SHALL INCLUDE THE FOLLOWING INFORMATION:  
a. POINT-OF-CONNECTION TO EXISTING SERVICES.  
b. MAIN AND LATERAL PIPE ROUTING, SIZE AND SLEEVE LOCATIONS AND SIZE UNDER PAVEMENT.  
c. SPRINKLER HEAD LAYOUT, SIZE, RADIUS, AND SPRINKLER HEAD COVERAGE.  
d. ZONE LABELS INDICATING VALVE SIZES, GPM AND LOCATIONS.  
e. COMPONENT, CONTROL SYSTEM AND WIRING DIAGRAM SHOWING ROUTES AND SIZES.  
f. LOCATION AND MOUNTING DETAILS OF CONTROLLER.  
g. IRRIGATION DETAILS.  
h. FRICTION LOSS CALCULATIONS FOR EACH ZONE.

10. SUBMIT FOUR (4) HARDLINE SETS OF SHOP DRAWINGS AND AN ELECTRONIC COPY (AUTOCAD RELEASE 2008 OR NEWER).

11. DO NOT BEGIN CONSTRUCTION WORK UNTIL SHOP DRAWINGS HAVE BEEN APPROVED.

12. CLOSEOUT SUBMITTALS - SUBMIT THE FOLLOWING:  
A. AS-BUILT DRAWINGS: FOLLOWING CONSTRUCTION OF SYSTEM, SUBMIT TWO (2) REPRODUCIBLE HARDLINE SETS OF AS-BUILT DRAWINGS AND AN ELECTRONIC COPY (AUTOCAD RELEASE 2008 OR NEWER).  
B. SUBMIT COLOR-CODED PRINT OF CONTROLLER CHART.

13. EXISTING HUNTER ACC CONTROLLER LOCATED AT THE CHILDREN'S PLAY AREA SHALL BE UTILIZED AS THE CONTROLLER.

14. IRRIGATION HEADS SHALL BE HUNTER 6" I-20 ROTORS AND 6" INDUSTRIAL SPRAYS OR APPROVED EQUAL.

**LEGEND**

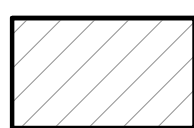
-  6" POP UP HUNTER INSTITUTIONAL SPRAY HEADS
-  6" POP UP HUNTER I-20 ROTOR HEADS

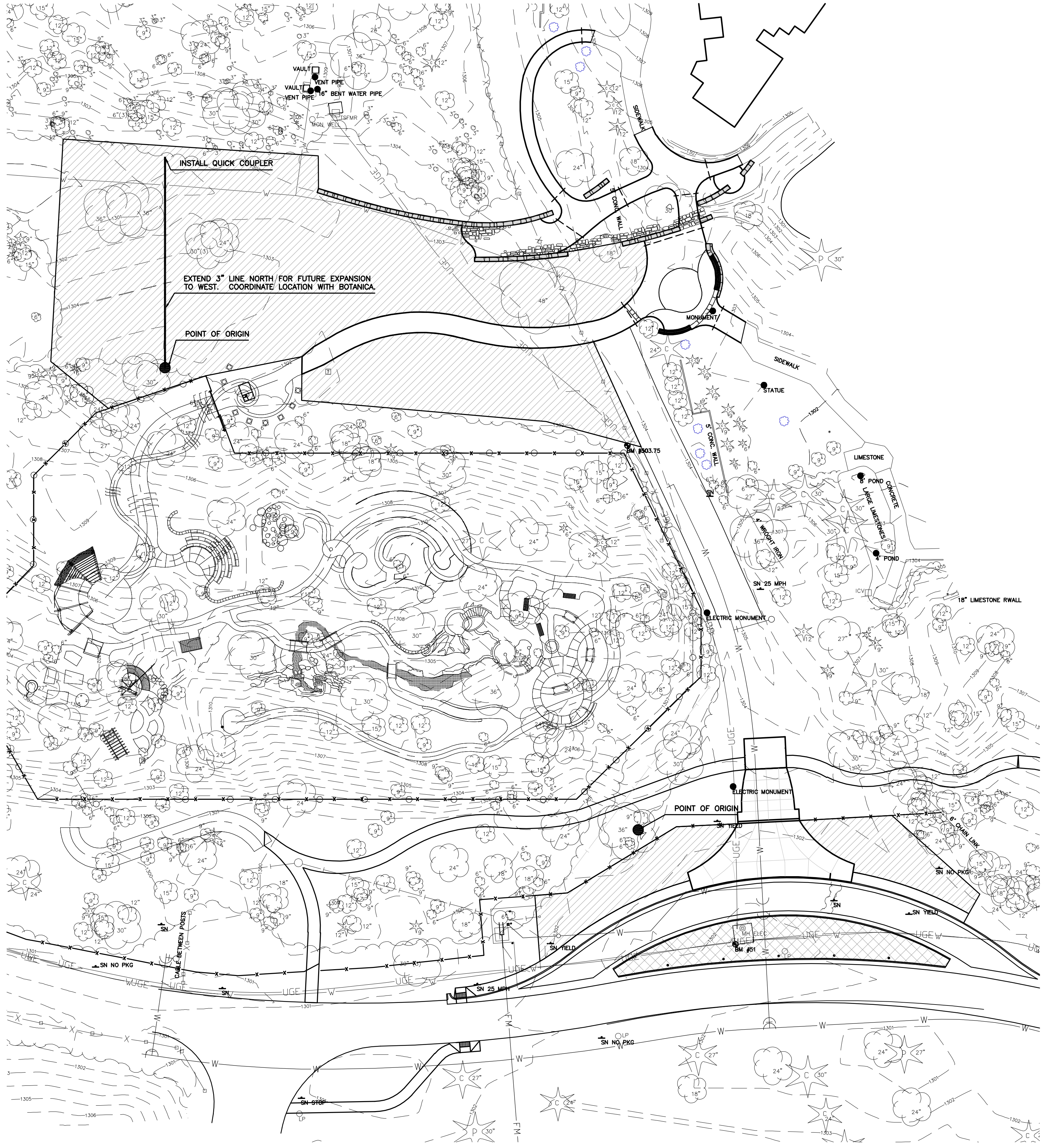
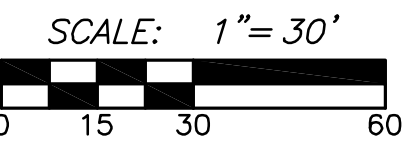
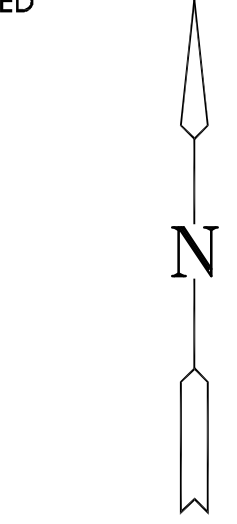

PLOTTED: Tuesday, March 08, 2011 @ 05:43:28M

F:\PROJECTS\2008\08603\CAD\CIVIL\_CD\08603\_IR1.DWG