

PLAN AND PROFILE OF PROPOSED CENTRAL AVENUE ROCK TO WEBB

OCA NO. 707024
CITY OF WICHITA PROJECT NO. 472-84916
CITY OF WICHITA, KANSAS
POPULATION 355,000

SURFACING
TRAFFIC SIGNALIZATION
SIGNING AND PAVEMENT MARKING

GENERAL NOTES

- Utility service lines, poles, valve boxes, meters and etc. are to be adjusted as necessary by others prior to construction unless the plans specifically call for their adjustment by the Contractor. Existing utilities and their location, as shown on the plans, represent the best information obtainable for design. The Contractor will be required to work around existing utilities within the right-of-way which do not conflict with proposed construction.
- All saw cuts shown on the plans shall not be paid for directly, but shall be considered subsidiary to other items of the contract. The Depth of the cut shall be full depth. Sawed joint to facilitate removal within three (3) feet of existing joints will not be permitted and for such instances the limits of removal shall extend to the existing joint. Such saw cuts will not be paid for directly and this cost shall be considered as subsidiary to the project costs.
- Rubble from the removal of miscellaneous structures and excess excavation which is to be wasted shall be disposed of on sites to be provided by the Contractor. These sites shall be approved by the Engineer as to suitability, appearance and site location. Locations that, in the opinion of the Engineer, will leave an unsightly appearance will not be approved.

All suitable excavation shall be wasted on low lying lots within the addition before any material is disposed of off site.

All disposal sites must be approved by the Kansas Department of Health and Environment. Material either stockpiled or disposed of in a flood plain would require a Kansas State Board of Agriculture permit. Any material dumped in waters of the United States or wetlands is subject to U.S. Corps. of Engineers permitting regulations. Any material buried or stockpiled beyond approved construction limits would require additional archaeological investigations unless buried in a previously approved borrow location.
- Trees and shrubs in public right-of-way which are in direct conflict with proposed new construction shall be removed by the Contractor with the Engineer's approval. Trees and shrubs which are not in direct conflict with proposed new construction shall be saved and protected from damage.
- The Contractor shall be responsible for preserving property irons. The Contractor will be required to reestablish any property irons which are damaged or destroyed by his construction operations. Such irons shall be reestablished by a licensed land surveyor in accordance with state laws.
- Contractor shall maintain all existing BMPs on project site during construction. Contractor shall repair or replace any existing BMPs that are damaged (cost subsidiary to site restoration). If BMPs were damaged prior to contractor beginning work on project, notify construction inspector or engineer.
- The Contractor shall notify Westar Energy to coordinate service connection, meter installation and all other activities to complete the traffic signal installation. Fees associated with this work shall be the responsibility of the Contractor.

INDEX OF SHEETS

1	TITLE SHEET
2	TYPICAL SECTIONS
3-6	PLAN SHEETS
7-8	INTERSECTION DETAILS
9-12	PAVEMENT DETAILS
13-15	INLET & MANHOLE DETAILS
16	STORM SEWER PROFILES & SCHEDULE
17-18	SUMMARY OF QUANTITIES
19-28	ERROSION CONTROL
29-33	TRAFFIC SIGNALS
34-40	PAVEMENT MARKING & SIGNING
41	CONSTRUCTION SEQUENCE
42-58	TRAFFIC CONTROL
59-69	CROSS SECTIONS
WL1-WL8	WATERLINE SHEETS
LS1-LS7	LANDSCAPE PLANS

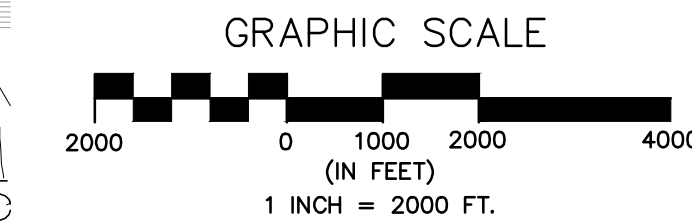
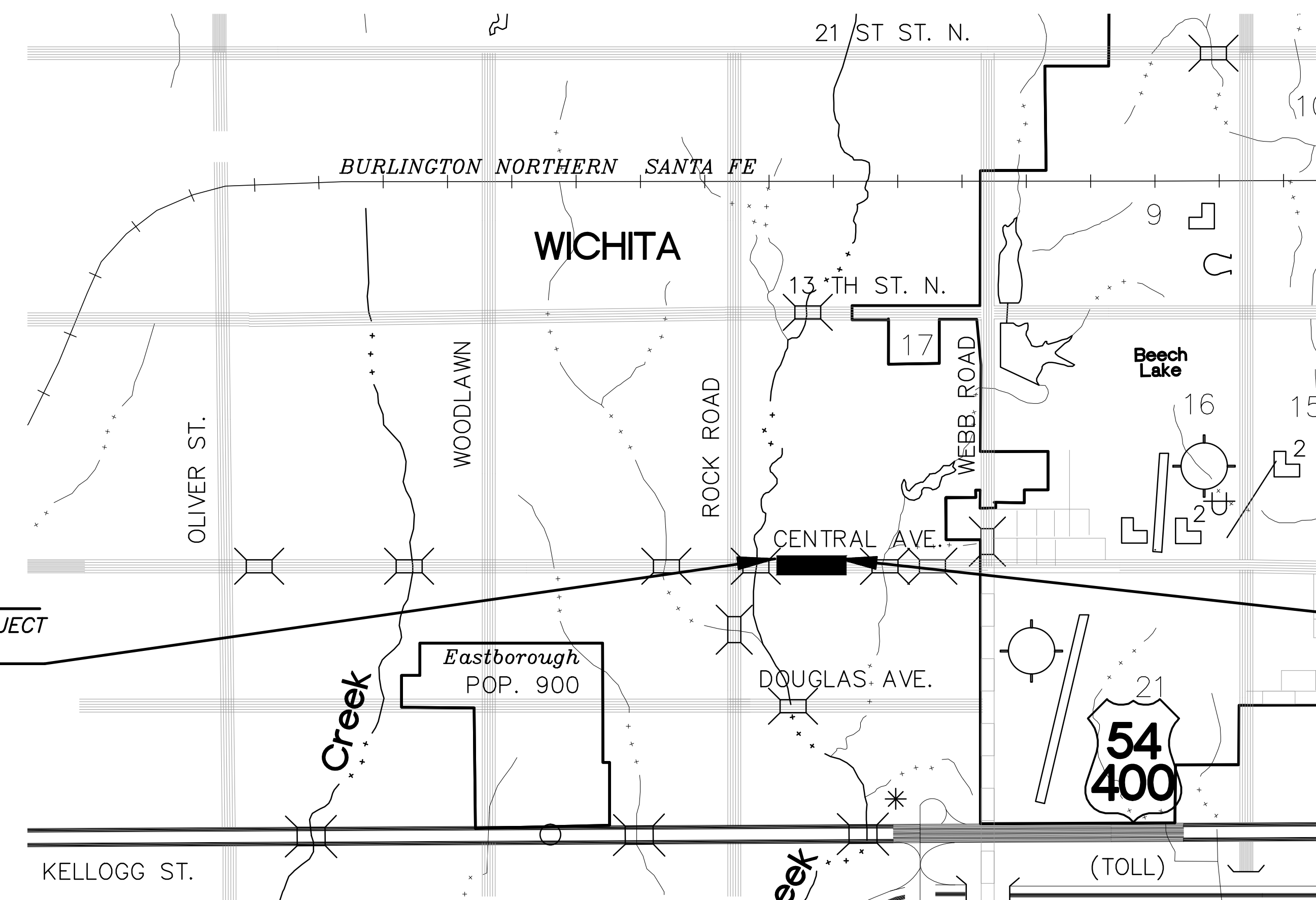

Sta. 100+00.00, BEGIN PROJECT
PROJ: 472-84916

Sta. 119+09.90, END PROJECT
PROJ: 472-84916

BENCHMARKS

BM#1	Opus monument #11 at the SW Corner of Central and Rock Road at Chili's Restaurant Elev.=1356.84 (NAVD 88 Datum)
BM#2	"□" cut at the east curb return at the southeast corner of Central and Tara Elev.=1345.71 (NAVD 88 Datum)
BM#3	"5/8" bar and 1 1/2" aluminum cap 3' north of the sidewalk 150' east of the school cross walk on the north side of Central Avenue at Kapun Mount Carmel High School Elev.=1359.84 (NAVD 88 Datum)
BM#4	Center of "9" in HELMER '09 stamped on the east curb return at the southeast corner of Central and Longford. Elev.=1359.79 (NAVD 88 Datum)
BM#5	City of Wichita benchmark at the southeast corner of Central and West Parkway. Elev.=1355.48 (NAVD 88 Datum)

GROSS LENGTH OF PROJECT	1,909.9 ft
EXCEPTIONS	0.000 ft
NET LENGTH OF PROJECT	1,909.9 ft
NET LENGTH OF BRIDGES	0.000 ft
NET LENGTH OF ROAD	1,909.9 ft

NOTE:
Traffic to be carried
through construction.

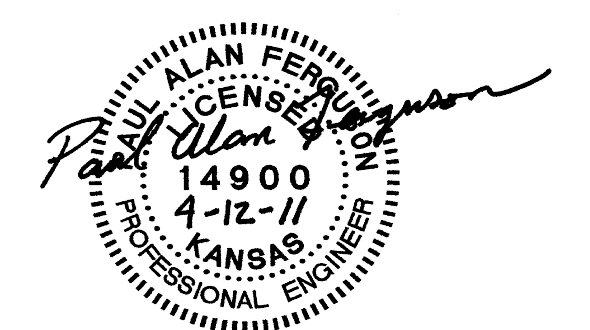

POE & ASSOCIATES, INC.
CONSULTING ENGINEERS
5940 E. Central, Suite 200 Wichita, KS 67208-4242
Phone 316/685-4114 FAX 316/685-4444

APPROVED—DATE

JIM ARMOUR, P.E.
CITY ENGINEER
CITY OF WICHITA, SEDGWICK COUNTY, KANSAS