

**BENCHMARK:**  
 BM #3 - Chiseled "□" on the Top of Curb in the Southwest Parking Lot at the Middle Drive to the Reflection Ridge Retirement Home. Sta. 22+66, 75' Rt. Elev. = 1355.93

SCALE: 1" = 20'  
 0 10 20

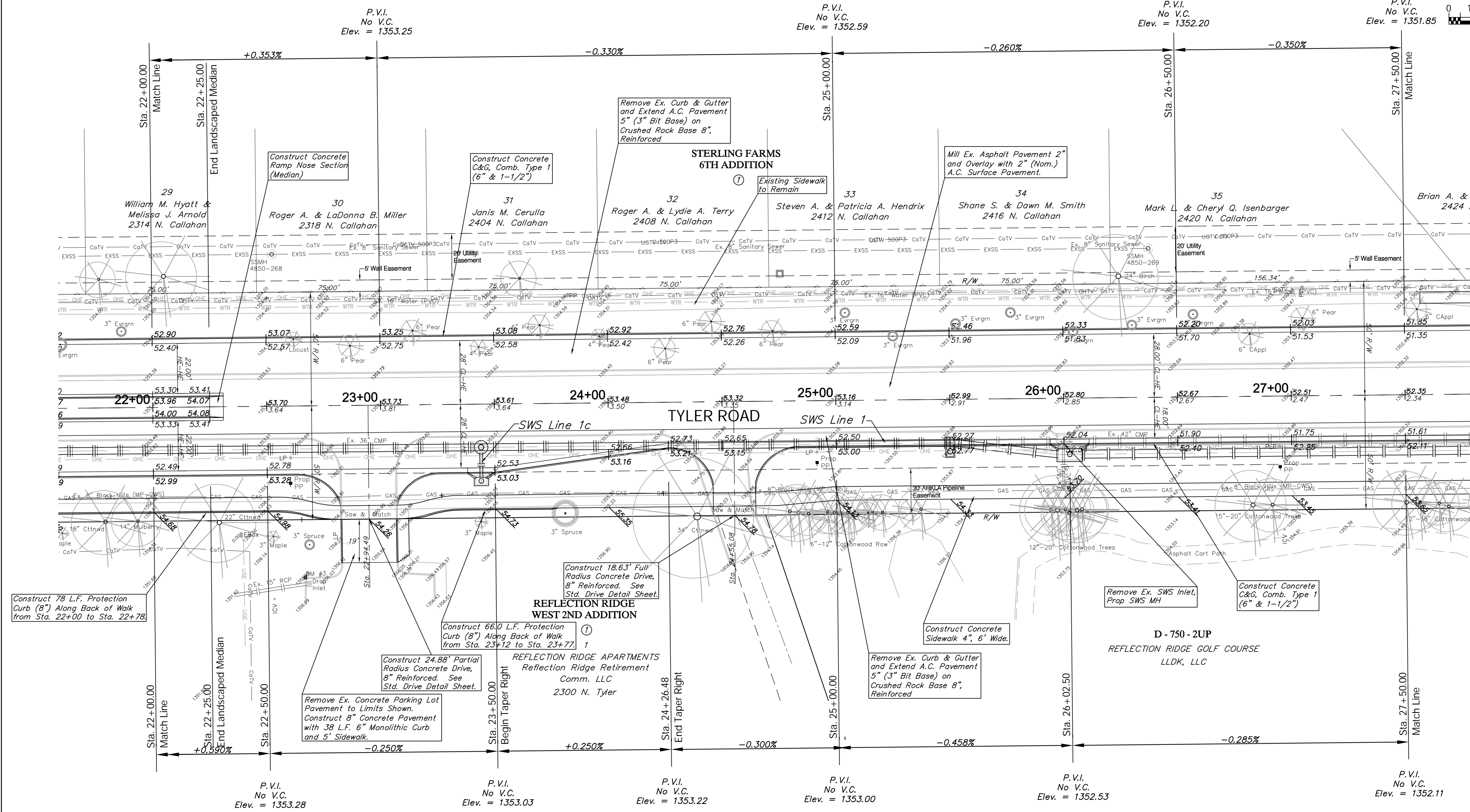

Construct 78 L.F. Protection Curb (8") Along Back of Walk from Sta. 22+00 to Sta. 22+78.

Construct Concrete Ramp Nose Section (Median)

Construct Concrete C&G, Comb. Type 1 (6" & 1-1/2")

Remove Ex. Curb & Gutter and Extend A.C. Pavement 5" (3" Bit Base) on Crushed Rock Base 8", Reinforced

Mill Ex. Asphalt Pavement 2" and Overlay with 2" (Nom.) A.C. Surface Pavement.

Construct 18.63' Full Radius Concrete Drive, 8" Reinforced. See Std. Drive Detail Sheet.

Construct 66.0 L.F. Protection Curb (8") Along Back of Walk from Sta. 23+12 to Sta. 23+77.

Construct 24.88' Partial Radius Concrete Drive, 8" Reinforced. See Std. Drive Detail Sheet.

Remove Ex. Concrete Parking Lot Pavement to Limits Shown. Construct 8" Concrete Pavement with 38 L.F. 6" Monolithic Curb and 5' Sidewalk.

Construct Concrete Sidewalk 4", 6' Wide.

Remove Ex. SWS Inlet, Prop SWS MH

Construct Concrete C&G, Comb. Type 1 (6" & 1-1/2")

Remove Ex. Curb & Gutter and Extend A.C. Pavement 5" (3" Bit Base) on Crushed Rock Base 8", Reinforced

Drawing File: E:\Projects\Tyler - 21st to 29th\Civil 3d\Tyler Base.dwg (Pav03)

Design: TPV  
 Drawn: STAFF  
 Approved: TPV  
 Scale: NOTED

Project No. 1012E575 CAPITAL IMPROVEMENT PROJECT  
**TYLER ROAD PAVING**  
 Sta. 22+00.00 to Sta. 27+50.00  
 TYLER ROAD - 21ST STREET NORTH to 29TH STREET NORTH

**Baughman Company, P.A.**  
 315 Ellis St., Wichita, KS 67211 P 316.262.7271 F 316.262.0149  
 ENGINEERING | SURVEYING | PLANNING | LANDSCAPE ARCHITECTURE

July 2011  
 SHEET 13 OF 100