

Plotted By: svb Date: 7/15/2011 7:46:55 AM  
 FILE: I:\2010\10310\Plan\10310-Plan 2nd St.dgn

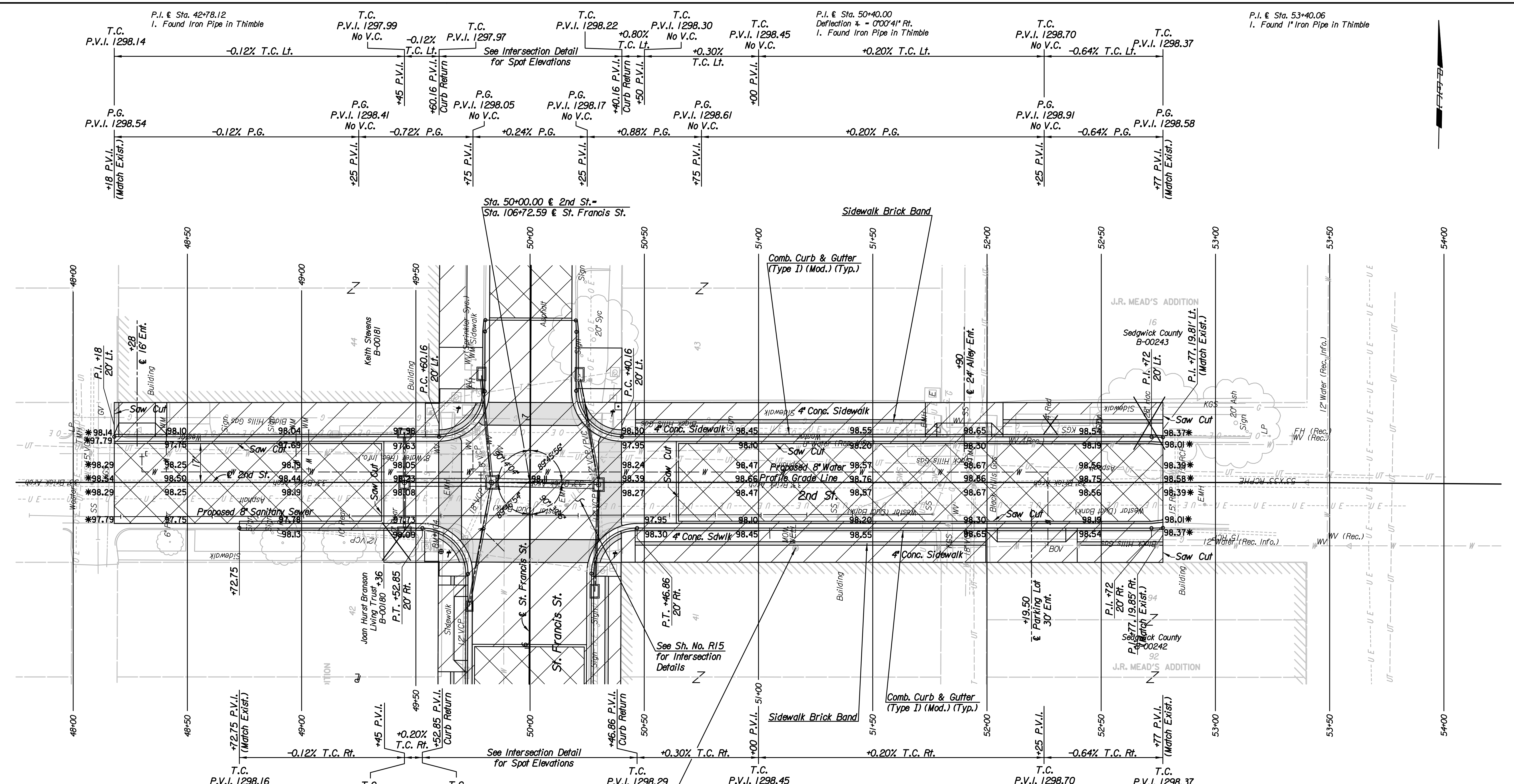

REMOVAL OF EXISTING STRUCTURES *		
STATION	SIDE	ITEM
48+68	Lt.	Sign
48+88	Lt.	Sign
48+96	Rt.	Curb Inlet & 76 L.F. 12" VCP (E)
49+15	Lt.	Curb Inlet & 62 L.F. 8" VCP (E)
49+42	Rt.	10" Tree
50+89	Lt.	Sign
51+81	Lt.	Light Pole
52+28	Lt.	4" Tree
52+51	Lt.	Sign
52+71	Lt.	28" Tree

\* For Information Only

- Utilities**
- Gas Black Hills Energy
  - Gas Kansas Gas Service
  - Power Westar Energy
  - Sanitary Sewer Wichita Water and Sanitary Sewer
  - Telephone AT&T
  - Water Wichita Water and Sanitary Sewer

BM \*104 Chiseled on SE corner of traffic signal base, SW corner of St. Francis and 2nd St. intersection. 30' Rt. & Sta. 49+61 Elev. = 1298.44

Sta. 51+16, 29' Rt.  
 Monitoring Well to be adjusted by others. Contractor to protect from damage. Coordinate with C.O.W. Environmental Services.

**LEGEND**

- Pavement Removal
- Mill/Overlay
- Brick Pavers
- Wheelchair Ramp
- Match Existing
- Tree Removal

See Sh. No. R33 for table of Adjustments of existing Manholes, Water Valve Boxes, Water Meter Boxes, and Fire Hydrants.

NOTE: Proposed top of curb elevations shown are computed based on full height curb. Adjust elevations for 1/2" lip curb locations.

Revision		By	Date
2ND STREET			
<b>PLAN</b>			
<b>STA. 48+00 TO STA. 54+00</b>			
JAMES L. ARMOUR, P.E.-CITY ENGINEER CITY OF WICHITA PROJECT NO. 472-84920			
<b>Professional Engineering Consultants, P.A.</b> 303 S. TOPEKA - WICHITA, KANSAS 67202 316-262-2691 • FAX 316-262-3003			
Designed by	JPS	Job No.	10310
Drawn by	SVB	Date	July, 2011
			Sh. R9 of 101